



## **CLICK & GO INFANT CARRIER LOWER FRAME**

WITH INTEGRATED CLICK AND GO RECEIVERS

FOR STRIDER COMPACT STROLLER & E BRAKE STROLLER  
TO ACCOMMODATE A BRITAX SAFE-N-SOUND  
UNITY INFANT CARRIER WITH INTEGRATED  
CLICK & GO ADAPTERS

INSTRUCTION MANUAL



**IMPORTANT: KEEP THIS BOOKLET IN A SAFE PLACE FOR FUTURE REFERENCE**

Series No. ZA8345

# WARNINGS

---

RETAIN FOR FUTURE REFERENCE.

READ ALL INSTRUCTIONS CAREFULLY BEFORE ASSEMBLY AND USE OF THIS ADAPTER. ALWAYS FOLLOW THE INSTRUCTIONS.

THE CORRECT USE AND MAINTENANCE OF THIS PRODUCT IS ESSENTIAL.



## **WARNINGS:**

- THE CLICK AND GO INFANT CARRIER LOWER FRAME CAN ONLY BE USED TO ACCOMMODATE A SAFE-N-SOUND UNITY INFANT CARRIERS WITH INTEGRATED CLICK & GO ADAPTERS.
- THE CLICK AND GO INFANT CARRIER LOWER FRAME CAN ONLY BE USED ON THE STEELCRAFT STRIDER COMPACT STROLLER SERIES AND THE BRITAX E BRAKE STROLLER SERIES.
- IT IS UNSAFE TO USE ACCESSORIES NOT APPROVED FOR USE WITH THE CLICK AND GO INFANT CARRIER LOWER FRAME.
- THE MAXIMUM WEIGHT OF THE CHILD USING THIS PRODUCT IS NOT TO EXCEED 12KGS.

## **IMPORTANT NOTES**

---

- DO NOT USE THE CLICK & GO INFANT CARRIER LOWER FRAME WITH ANY OTHER MODELS OF STROLLER.
- THE CLICK & GO INFANT CARRIER LOWER FRAME MUST BE CORRECTLY FITTED AND LOCKED ONTO THE STROLLER FRAME.
- THE CLICK & GO INFANT CARRIER LOWER FRAME CAN ONLY BE USED IN THE FORWARD FACING POSITION, CONNECTED TO THE REAR OF THE STROLLER.

# MANUAL HANDLING TECHNIQUES

---

## The **SMART** lifting technique

This technique can be used to pick up small light loads from low levels.

### **Size up the Load**

- Assess the load (size, shape and weight).
- Assess whether the load needs to be moved;
- Where is it going to be placed” Check that there are no obstructions;
- Assess whether mechanical or human assistance is required.

### **Move the Load as close to the body as possible**

- A load is heavier to lift or carry if it is not close to the body.
- The whole hand should be used to ensure a firm grip.

### **Always bend your knees**

- Maintain balance.
- Keep feet apart and in a comfortable position.
- Minimise lower back bending.
- Bend knees preferable at as large an angle as possible but not at a right angle - use a semi squat in preference to a full squat.

### **Raise the load with your legs**

- Achieve the lift smoothly and without jerkiness.
- Maintain the normal curvature of the spine to allow the force of the load to be distributed evenly from the spine to the pelvis.

### **Turn your feet in the direction that you want to move the load.**

- Avoid unnecessary bending, twisting and reaching.
- Change direction by turning your feet and not your back.
- To set the load down, squat down, keep your head up and let
- Let your legs do the work.

**Remember to ‘THINK TALL’ chest lifted, shoulders relaxed, chin tucked in and head level.**

# INFANT CARRIER LOWER FRAME

---

1. INFANT CARRIER LOWER FRAME CONNECTING PINS
2. INFANT CARRIER LOWER FRAME LEG TUBES
3. INFANT CARRIER RELEASE BUTTONS
4. UNITY INFANT CARRIER RECEIVERS
5. INFANT CARRIER LOWER FRAME FOLDING LEVER
6. INFANT CARRIER LOWER FRAME STABILISING BAR
7. STEELCRAFT INFANT CARRIER RECEIVERS



# TO USE THE STEELCRAFT RECEIVERS SUPPLIED WITH THE INFANT CARRIER LOWER FRAME

---

## IMPORTANT NOTE

BRITAX RECOMMEND THE STEELCRAFT RECEIVERS SUPPLIED WITH THE INFANT CARRIER LOWER FRAME BE ATTACHED TO THE STROLLER FRAME BEFORE INSTALLING AND USING THE UNITY INFANT CARRIER ON THE INFANT CARRIER LOWER FRAME.

THE STEELCRAFT RECEIVERS CREATE MORE SPACE BETWEEN THE TOP SEAT AND THE UNITY INFANT CARRIER IN THE LOWER FRAME.

- A Take one Steelcraft receiver at a time and align the receivers with the stroller frame mouldings. The receiver extends towards the front of the stroller and the ribbed section of the mouldings face inwards.
- B Insert the receiver into the stroller mouldings. Push down on the receiver until you hear a 'click' which indicates the receiver has locked into the stroller frame mouldings.
- C Pull up on each receiver to check they are locked on.

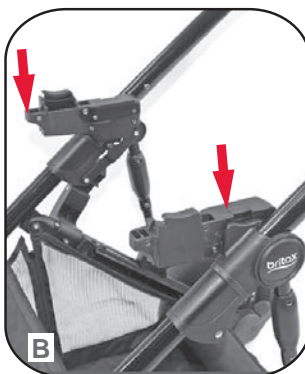

# TO USE THE STEELCRAFT RECEIVERS SUPPLIED WITH THE INFANT CARRIER LOWER FRAME

---

- D Install the stroller seat or Steelcraft infant carrier.

**To install the stroller seat on the Strider Compact stroller using the Steelcraft receivers:** Please refer to Page 63 of the Strider Compact Instruction Manual supplied with the stroller.

**To install the Steelcraft Infant Carrier on the Strider Compact stroller using the Steelcraft receivers:** Please refer to Page 64 of the Strider Compact Instruction Manual supplied with the stroller.

**To install the stroller seat on the E-Brake stroller using the Steelcraft receivers:** Please refer to Page 97 of the E-Brake Instruction Manual supplied with the stroller.

**To install the Steelcraft Infant Carrier on the E-Brake stroller using the Steelcraft receivers:** Please refer to Page 98 of the E-Brake Instruction Manual supplied with the stroller.

- E To remove the receivers, press the button on top of the receiver and pull the receiver up out of the stroller frame mouldings.

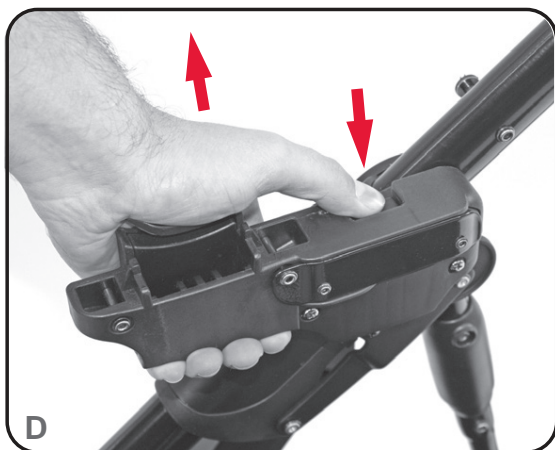

# TO FIT THE INFANT CARRIER LOWER FRAME

## IMPORTANT NOTES

PLEASE REFER TO PAGE 3 FOR LIFTING TECHNIQUES.

- WHEN FITTING THE CLICK & GO INFANT CARRIER LOWER FRAME TO THE STROLLER, BE AWARE OF THE DANGER OF BEING INJURED BY MOVING PARTS AND LOCKING DEVICES DURING THE PROCESS.
- THE CLICK & GO INFANT CARRIER LOWER FRAME MUST BE CORRECTLY FITTED AND LOCKED ONTO THE STROLLER FRAME.
- THE CLICK & GO INFANT CARRIER LOWER FRAME CAN ONLY BE USED IN THE FORWARD FACING POSITION, CONNECTED TO THE REAR OF THE STROLLER. KEEP ALL HANDS AND LIMBS CLEAR OF THESE PARTS.

- A Apply the stroller brake. For easier installation, remove the stroller seat or infant carrier from the upper section of the stroller frame. Remove the accessory bag from the stroller, if fitted. Rotate the pivotal handle up to create more assembly space.
- B The infant carrier lower frame connecting pins (1) need to lock into the lower stroller frame mouldings. Hold the infant carrier lower frame so the leg tubes (2) are underneath and facing the infant carrier lower frame.

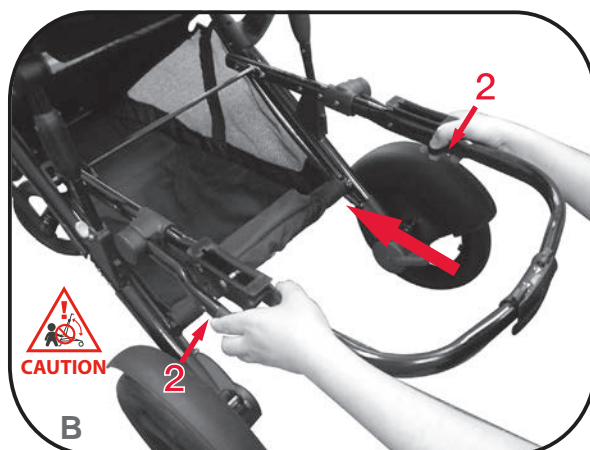

# TO FIT THE INFANT CARRIER LOWER FRAME

- C Then hook the infant carrier lower frame connecting pins (1) into the stroller frame mouldings, then pull downwards.

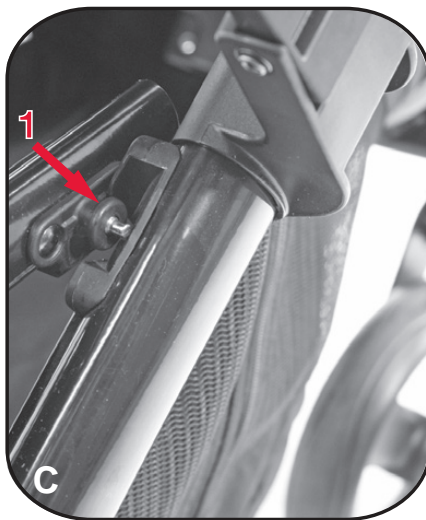

- D Lower the infant carrier frame and push down to lock the leg tubes (2) into the lower stroller frame mouldings. Repeat Step D if the frame doesn't lock into place.

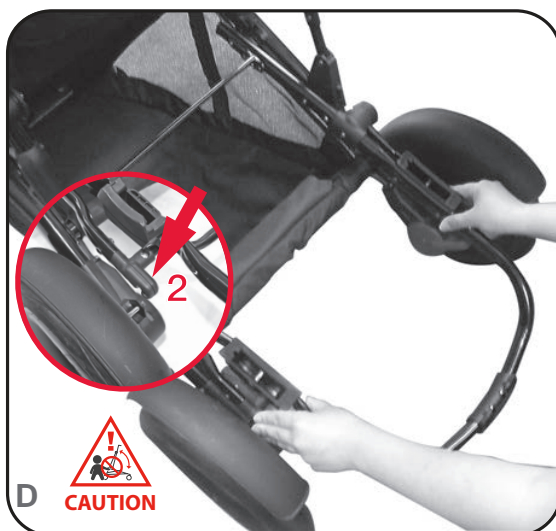

## TO FIT THE INFANT CARRIER LOWER FRAME

---

- E Pull up on the infant carrier lower frame to make sure it is locked onto the stroller frame.
- F Lift the folding lever (5) on the infant carrier lower frame and raise the frame so it slides down the stroller frame and engages into the second lock on the stroller. When locked, the lower adapter frame is locked slightly above horizontal.

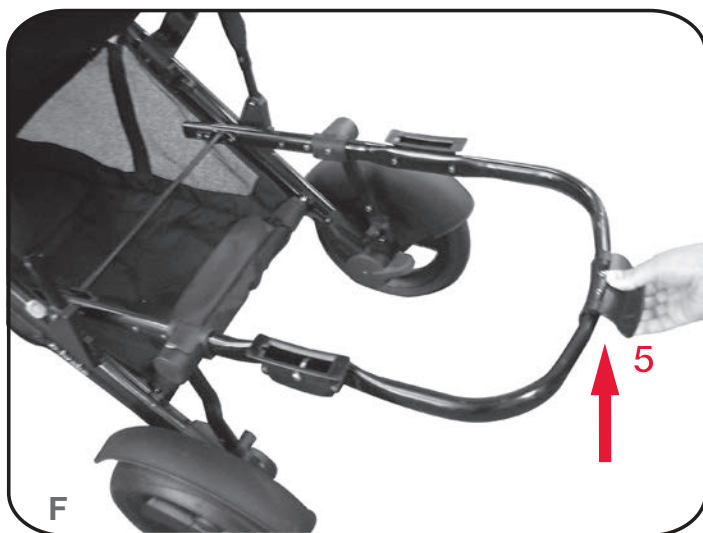

# TO INSTALL THE UNITY INFANT CARRIER INTO THE INFANT CARRIER LOWER FRAME

## IMPORTANT NOTES

PLEASE REFER TO PAGE 3 FOR LIFTING TECHNIQUES.

- THESE INSTRUCTIONS ARE FOR INSTALLING THE BRITAX SAFE-N-SOUND UNITY INFANT CARRIER INTO THE CLICK & GO INFANT CARRIER LOWER FRAME ONLY.

FOR INSTALLING THE INFANT CARRIER IN THE CAR PLEASE FOLLOW THE INSTRUCTION BOOK INCLUDED WITH THE INFANT CARRIER.

- TO SECURE YOUR CHILD IN THE INFANT CARRIER PLEASE FOLLOW THE INSTRUCTION BOOK INCLUDED WITH THE INFANT CARRIER.
- FOR EASIER INSTALLATION, REMOVE THE STROLLER SEAT OR INFANT CARRIER FROM THE UPPER SECTION OF THE STROLLER FRAME AND ROTATE THE STROLLER PIVOTAL HANDLE TO THE MOST UPRIGHT POSITION.

- A Lift the infant carrier above the infant carrier lower frame and locate the infant carrier adapters over the receivers (4) on the infant carrier lower frame and push down until it has locked into the receivers. Pull up on the infant carrier to confirm it has locked into place.



# TO RELEASE THE UNITY INFANT CARRIER FROM THE INFANT CARRIER LOWER FRAME

## IMPORTANT NOTES

PLEASE REFER TO PAGE 3 FOR LIFTING TECHNIQUES.

- THESE INSTRUCTIONS ARE FOR REMOVING THE BRITAX SAFE-N-SOUND UNITY INFANT CARRIER FROM THE CLICK & GO INFANT CARRIER LOWER FRAME ONLY. FOR REMOVING THE INFANT CARRIER FROM THE CAR PLEASE FOLLOW THE INSTRUCTION BOOK INCLUDED WITH THE INFANT CARRIER.

A Use both hands to push the release levers up on the infant carrier adapters which are located on both sides of the infant carrier and then lift the infant carrier away from the frame.



# TO FOLD THE INFANT CARRIER LOWER FRAME

## IMPORTANT NOTES

PLEASE REFER TO PAGE 3 FOR LIFTING TECHNIQUES.

- WHEN FOLDING THE CLICK & GO INFANT CARRIER LOWER FRAME BE AWARE OF THE DANGER OF BEING INJURED BY MOVING PARTS AND LOCKING DEVICES DURING THE PROCESS.
- THE BRITAX SAFE-N-SOUND UNITY CARRIER MUST BE REMOVED FROM THE LOWER FRAME BEFORE REMOVING INFANT CARRIER LOWER FRAME FROM THE STROLLER FRAME.

**NOTE: FOR EASIER REMOVAL, ROTATE THE PIVOTAL HANDLE OF THE STROLLER IN THE MOST UPRIGHT POSITION.**

- A Lift the infant carrier lower frame folding lever (5) up and press the second lock button on the stroller frame and lower the infant carrier frame.

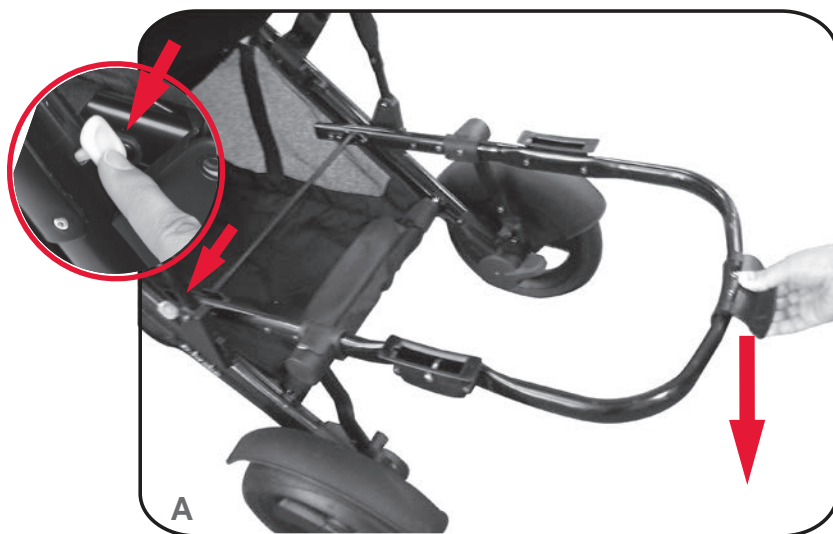

## TO FOLD THE INFANT CARRIER LOWER FRAME

---

- B. The infant carrier lower frame will slide up the stroller frame to the folded position. The infant carrier lower frame can now be folded with stroller. (Refer to the Stroller Instruction book regarding steps on folding the stroller.)

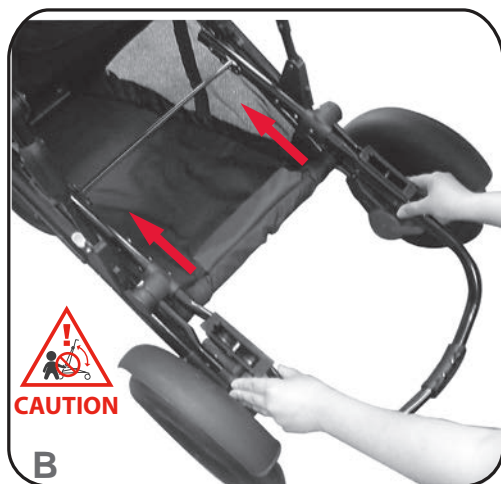

## TO REMOVE THE INFANT CARRIER LOWER FRAME

---

### IMPORTANT NOTES

PLEASE REFER TO PAGE 3 FOR LIFTING TECHNIQUES.

- WHEN REMOVING THE CLICK & GO INFANT CARRIER LOWER FRAME BE AWARE OF THE DANGER OF BEING INJURED BY MOVING PARTS AND LOCKING DEVICES DURING THE PROCESS.
- THE BRITAX SAFE-N-SOUND UNITY CARRIER MUST BE REMOVED FROM THE INFANT CARRIER LOWER FRAME BEFORE REMOVING THE INFANT CARRIER FRAME FROM THE STROLLER FRAME.

# TO REMOVE THE INFANT CARRIER LOWER FRAME

**NOTE: FOR EASIER REMOVAL, ROTATE THE PIVOTAL HANDLE OF THE STROLLER IN THE MOST UPRIGHT POSITION.**

- A Fold the infant carrier lower frame under the stroller frame - See page 12.
- B With the infant carrier lower frame in the folded position, locate the release buttons (3) on both sides of the frame and fully depress the release buttons until you see the adjacent buttons pop out of the mouldings.

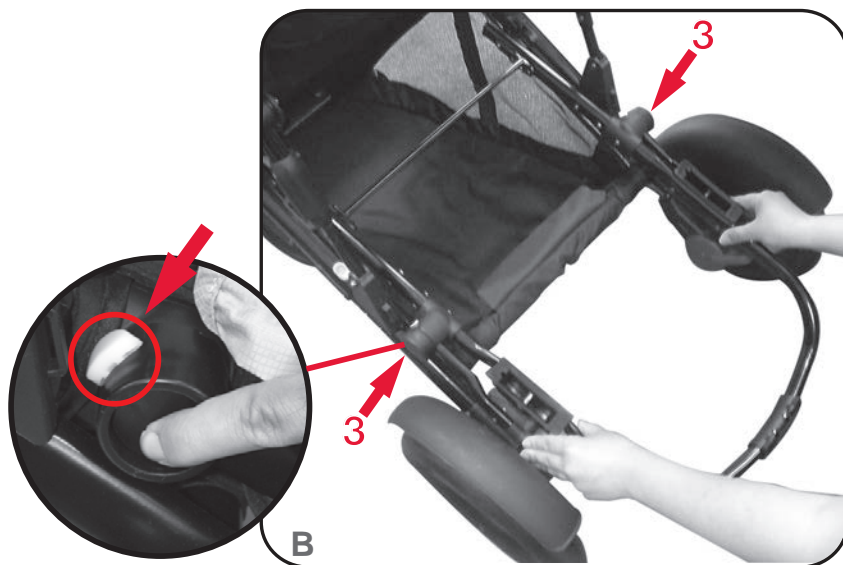

# TO REMOVE THE INFANT CARRIER LOWER FRAME

---

- C A gentle upward, then forward motion (as indicated by the arrow) will be required to release the infant carrier lower frame connecting pins (1) out of the stroller frame mouldings.

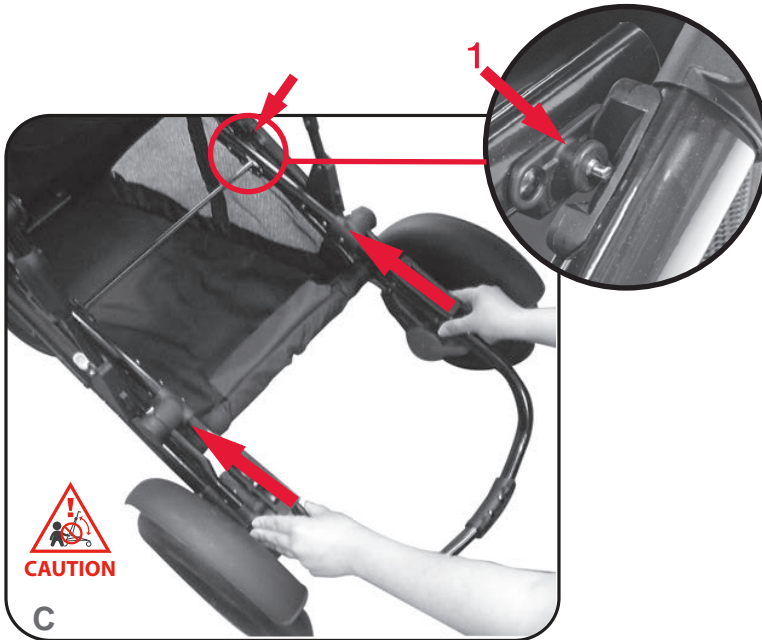

- D Lift the infant carrier lower frame out and away from the stroller frame.

## CARE AND MAINTENANCE

---

- Always check parts regularly for tightness of screws, nuts, and other fasteners - tighten if required. To maintain the safety of your nursery product, seek prompt repairs for bent, torn, worn or broken parts.

**THIS PRODUCT IS NOT INTENDED FOR COMMERCIAL USE.**

**youtube.com/britaxaustralia**



**facebook.com/britaxaustralia**



**twitter.com/britaxaustralia**



**pinterest/britaxaustralia**



**britax.com.au**



**1300 303 330**



BRITAX CHILDCARE PTY. LTD.  
A Britax International Company  
ABN 55 006 773 6000  
99 Derby Road Sunshine  
Victoria 3020 Australia  
Britax Childcare Pty Ltd  
(Customer Service 1300 303 330)  
Britax Childcare (NZ) Ltd  
(Customer Service 0508 688 822)

Due to the variations in style and design of our products, the illustrations used in this instruction booklet are generic. We reserve the right to alter these products without notice. The Britax Trademark is the property of Britax Childcare Holdings Limited - UK.

This product is designed to comply with Australian and New Zealand standard AS/NZS2088:2013 "Prams and Strollers - Safety Requirements."

©2013 Copyright Britax Childcare Pty. Ltd. Australia