



Safe-n-Sound™

Unity™

Infant Carrier

Series No. 40/A/2010

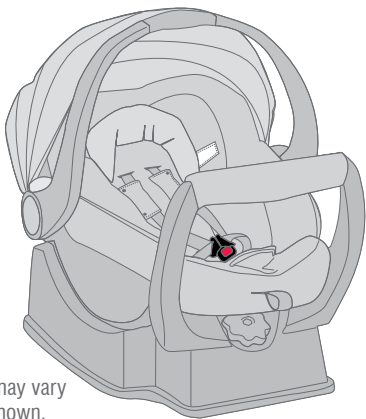

NOTE: Style may vary
from image shown.

Instructions for Installation & Use



IMPORTANT:

KEEP THIS BOOKLET IN THE PLACE PROVIDED ON THE CHILD RESTRAINT.

INDEX

PAGE

3	INTRODUCTION
4	WARNINGS
6	SHOULDER HEIGHT MARKERS AND A GROWING CHILD
8	SPECIAL FEATURES
10	SUITABLE FOR USE
12	HOW TO SET-UP
21	HOW TO INSTALL
26	HOW TO USE
34	SHOULDER HEIGHT MARKERS AND THE NEXT STEP
35	CARE & MAINTENANCE
40	ACCESSORIES
42	TRAVELLING TIPS
44	TRAVEL SYSTEM - INTEGRAL LATCH
48	TRAVEL SYSTEM - BRITAX STROLLER CLICK & GO™ ADAPTOR
53	INSTALLATION OF CAR ANCHOR FITTING
58	ALTERNATIVE INSTALLATION IF SEATBELT LOOSENS
60	IN CASE OF ACCIDENT

INTRODUCTION

To be used only in a rearward-facing position for an infant until their shoulders reach the shoulder height marker (approximately 12 months of age).

Continue to use this infant restraint until the child reaches this limit.

Infants are at risk of serious injury if they face forward too early.

TO BE USED WITH A LAP-SASH OR LAP-ONLY SEATBELT IN THE BACK OF MOST CARS WITH FORWARD FACING SEATS.

CAREFULLY READ ALL THE INSTRUCTIONS FOR INSTALLATION. IN THE EVENT OF DOUBT ABOUT THE METHOD OF INSTALLATION, CONSULT BRITAX CHILDCARE OR AGENT OR A CHILD RESTRAINT FITTING STATION AUTHORISED BY A RELEVANT TRANSPORT AUTHORITY OR, IN NEW ZEALAND, THE AGENT FOR THE CAR.

No child restraint can guarantee absolute protection from injury in every crash. However, to ensure that your child gets all the protection designed into the restraint, PLEASE READ AND FOLLOW THESE INSTRUCTIONS EXACTLY and use only Safe-n-Sound recommended parts and accessories.

THIS RESTRAINT MUST BE ATTACHED TO A CHILD RESTRAINT ANCHORAGE POINT IN THE CAR. REFER TO CAR OWNER'S HANDBOOK FOR LOCATION OF ANCHORAGE POINTS. REFER TO A CHILD RESTRAINT FITTING STATION IF NO ANCHORAGE POINTS ARE IN THE MOTOR CAR.

Britax Childcare Pty. Ltd. continues to provide care for your children when travelling in motor cars with a range of child restraints suitable throughout their childhood.

This instruction book can be stored in the base of the Carrier for future reference.

The Carrier is suitable for fitting to a variety of Britax, Steelcraft and BOB Strollers using one of the adaptor systems. For compatible Strollers refer to www.britax.com.au.

Britax Stroller Click & Go™ Adaptor is required for some strollers and if not fitted then it is available as a separate purchase.



WARNINGS

- Use the restraint exactly as shown in the instructions.
- Fit the restraint firmly to the car seat.
- Fit the harness firmly to the child.
- A loose restraint or harness is dangerous.
- **DO NOT LEAVE CHILDREN UNATTENDED IN THE CAR.**
- Supervision of children is needed because they may be able to undo buckles.
- **DO NOT USE A REAR-FACING CHILD RESTRAINT WHERE AN AIRBAG IS FITTED IN FRONT OF THE SEATING POSITION.** For other airbags, refer to the car owner's handbook for warnings and instructions.
- To ensure baby's back is evenly supported do not put more than one nappy on the baby and make sure the nappy is not thickly folded at the back.
- Do not alter or modify this restraint.
- Repairs must only be done by the manufacturer or agent.
- Do not allow the restraint to come into contact with polishes, oils, bleach and other chemicals.
- Destroy the restraint if it has been in a severe crash, even if no damage is visible.
- **DO NOT USE THIS RESTRAINT WITHOUT THE COVER.**
- Make sure the handle is latched properly every time you pick up the Infant Carrier.
- **THIS RESTRAINT IS NOT SUITABLE FOR USE WHERE THE UPPER ANCHORAGE STRAP MAY FALL INTO A SPLIT IN THE SEAT BACK. (E.G. HATCHBACK OR WAGON).**



WARNINGS

- The restraint is not intended to be a substitute baby cot or bed. It is only designed to enable safe transportation of children in motor vehicles. Do not leave a baby in the restraint for long periods of time.
- Straps may be damaged by unsecured cargo in a collision. Secure or remove hazardous cargo before using this strap. Hatch-back or wagon: Do not use the child restraint where this strap may fall into a split in the seat back.
- Regularly check the restraint components, straps and other fitments for correct function & condition. Seek prompt repair.
- Protect all webbing from abrasion and cutting by sharp corners and edges.
- Upper Anchorage Straps and extension straps may be damaged by unsecured cargo in a collision. Secure or remove hazardous cargo before using this restraint.
- The restraint should not be purchased or sold as a second hand item. It is recommended not to use child restraints older than 10 years as the protection in an accident may be reduced.
- Do not store in areas that may get hot, like in car boots, roof space, beside shed walls which get hot in summer. Do not place heavy items on top of the seat as this may distort the plastic.



WARNING:

DO NOT LEAVE CHILDREN UNATTENDED IN THE CAR.

SHOULDER HEIGHT MARKERS AND A GROWING CHILD

New Baby

Shoulders below the Shoulder Height Marker.

Maximum Shoulder Height Marker

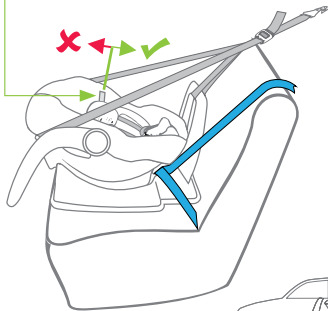

Older Baby

Shoulders in line with the Shoulder Height Marker- then you will need to move to the next child restraint.

Maximum Shoulder Height Marker.

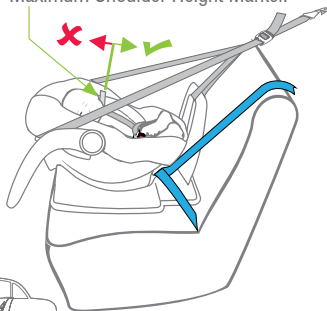

FRONT OF VEHICLE



The Infant Carrier is not suitable for your child when their shoulders are above the shoulder height marker.

If the babies neck muscles are unable to support their head then the child should remain rear facing, choose a child restraint that will take larger babies in rear facing.

DO NOT MOVE TO THE NEXT RESTRAINT UNTIL SHOULDERS REACHES THE SHOULDER HEIGHT MARKER.

SHOULDER HEIGHT MARKERS AND A GROWING CHILD

 **IMPORTANT: Follow this advice.**

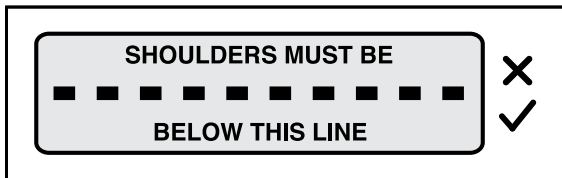

DO NOT MOVE TO THE NEXT RESTRAINT UNTIL SHOULDER REACHES THE SHOULDER MARKER.

When the child's shoulders reach this marker, the child is now too big for the child restraint. It is now time to move to the next child restraint, see page 34.

SPECIAL FEATURES

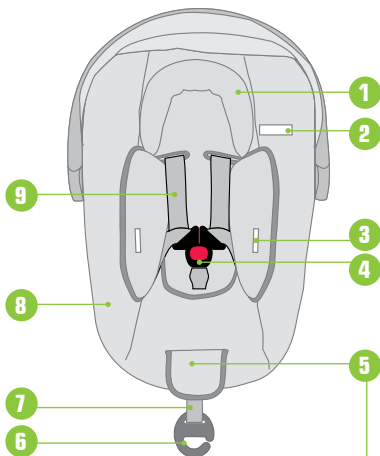

1. Padded Insert
2. Shoulder Height marker
3. Buckle Tongue Holders (if fitted) (holders are on both sides of the Padded Insert or the sides of the cover)
4. Harness Buckle
5. Harness Adjuster (under flap)
6. Harness adjustment strap hook (disconnected)
7. Harness adjustment strap
8. Cover
9. Harness

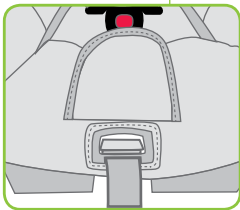

SPECIAL FEATURES

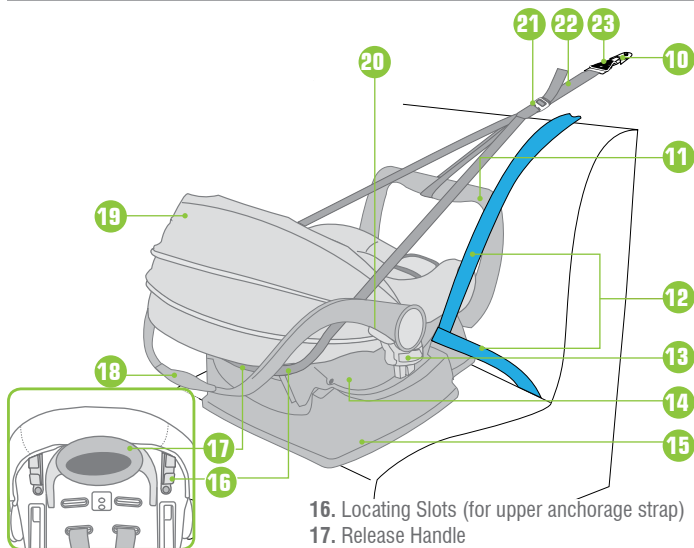

10. Anchor Fitting

11. Stabilising Bar

12. Car Seat belt

13. Britax Stroller Click & Go™
Adaptor (if fitted)

14. Infant Carrier

15. Base

16. Locating Slots (for upper anchorage strap)

17. Release Handle
(Located at the back of the Infant Carrier)

18. Carry Handle

19. Canopy

20. Carry Handle release latch

21. Adjuster

22. Upper anchorage strap

23. Attachment Clip

SUITABLE FOR USE

TO BE USED WITH A LAP-SASH OR LAP ONLY SEAT BELT IN THE BACK OF MOST CARS WITH FORWARD-FACING SEATS.

To be used only in a rearward-facing position for an infant until their shoulder's reach the shoulder height marker (approximately 12 months of age).

Continue to use this infant restraint until child reaches this limit.

Infants are at risk of serious injury if they face forward too early.

If the baby's neck muscles are unable to support their head, then the child should remain rear-facing, choose a restraint that will take larger babies in rear-facing.

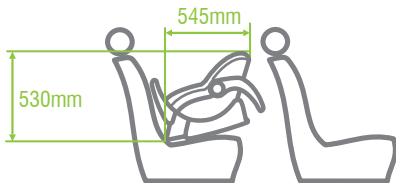

Seat Width 465mm

To ensure that the space is sufficient, the purchaser should check the measurements between the vehicle's rear and front seats in which the child restraint is intended to be used.

SUITABLE FOR USE



WARNING

THE TETHER STRAP MUST ALWAYS BE FITTED WHEN THE CHILD RESTRAINT IS USED IN A VEHICLE.

Do not use the restraint without the Upper Anchorage Strap correctly attached. The upper anchorage strap must be attached to an anchorage point using an extension strap if necessary.

The Infant Carrier can just touch the front seat, but must not in such a way that the installation angle is affected.

Do not recline the seat excessively, it must be installed at the correct angle (see pages 21 and 22).

Do not allow the front seat to alter the installed position of the restraint. It is permissible to allow the restraint to touch the seat in front of it.



Regional Road Rules restrict the use of child restraints, like this Infant Carrier, in the front seat of the car. Check your local Road Rules.

Do not use on any car seat which faces sideways or rearwards.

DO NOT USE A REAR-FACING CHILD RESTRAINT WHERE AN AIRBAG IS FITTED IN FRONT OF THE SEATING POSITION. For other airbags, refer to the car owner's handbook for warnings and instructions.

Seat belt extenders should not be used if the seat belt is not long enough to secure the child restraint. If they are used then the buckle must sit above the Base moulding.

HOW TO SET-UP

REMOVING INFANT CARRIER FROM BASE

- A.** Grasp the handle with one hand. With the other hand, lift the catch located at the front of the Infant Carrier.

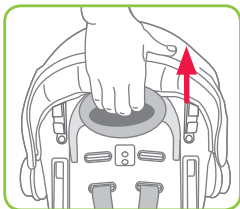

- B.** With the catch still lifted raise the Infant Carrier clear of the base.

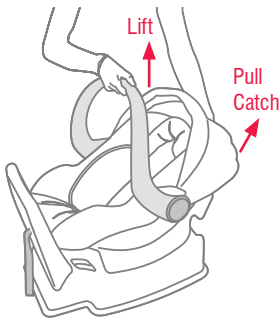

HOW TO SET-UP

ADJUSTMENT OF HANDLE POSITION

The Unity™ Travel System Infant Carrier features a sturdy carry handle which can be used in conjunction with the curved base to convert it to a rocker. At the base of the handle there are two large buttons which control the three positions of the handle. These positions are the "carry (or travel) position" ①, the "rocking position" ②, and the "non-rocking position" ③.

- A.** To convert from carry to "rocking position" ②, depress the large buttons on each side and rotate the handle towards the front of the Infant Carrier. When you have started rotating the handle release the buttons and continue rotating the handle round until it locks into position.
- B.** Ensure the handle is locked in position securely. The "rocking position" ② enables the Infant Carrier to rock without the possibility of the Infant Carrier tipping over.
- C.** To convert to a "non-rocking" ③ position depress both buttons and rotate the handle to the fixed position. Ensure the handle is locked in position securely.

① Carry Position



② Rocking Position

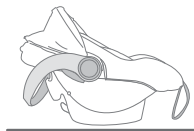

③ Non-rocking Position

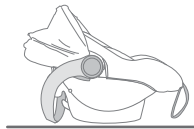

IMPORTANT :

Do not place the Infant Carrier on a table or a work-top where it could fall off.

HOW TO SET-UP

ADJUSTMENT OF HANDLE POSITION WITH BRITAX STROLLER CLICK & GO™ ADAPTOR

A. Squeeze the carry handle release latch on each side of the handle and rotate to the first position-“rocking position” ②.



B. Squeeze the latch again and start to rotate the handle then remove both hands from the latches and use one hand at the top of the handle to rotate down further until the handle latches in the second or “non-rocking position” ③. The carrier is now locked to the stroller.

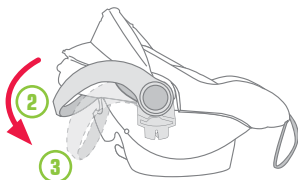
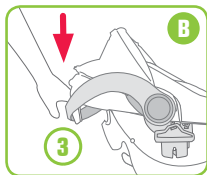

Push down until it clicks into place.



To avoid pinching your fingers follow the steps above.

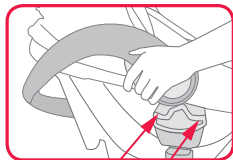

HOW TO SET-UP

TO FIT CANOPY

- A. With the viewing window flap on the outside, grasp the Canopy ensuring the two plastic frame sections at both sides are aligned.
- B. Push the two plastic frame sections at both sides onto the Infant Carrier at the inside of the handle pivot point.
- C. Refit the elastic Canopy strap to the dedicated elastic trim strap on each side of the Infant Carrier.

NOTE: Elastic Canopy loops must always be fitted when Canopy is in use.

- D. The Canopy can be rotated to cover the baby or opened by rotating to the desired position.

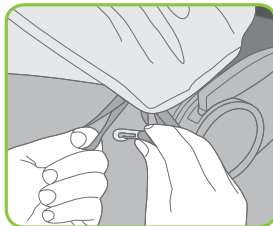
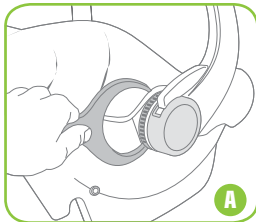

TO REMOVE CANOPY

- A. Ensure Canopy is in the collapsed position. Unclip the elastic Canopy straps which are secured by plastic hooks under each handle attachment point.
- B. Grasp the Canopy and pull it away from the Infant Carrier ensuring the straps are clear of catching any objects.

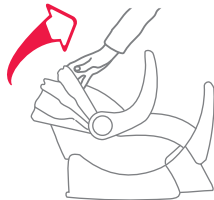

HOW TO SET-UP

SETTING UP THE HARNESS

The Infant Carrier is fitted with three shoulder strap positions. As the baby grows the shoulder straps must be moved to higher slots. Refer to page 17 - 20 for correct fitment of the harness shoulder straps.

- A.** Sit the Infant Carrier on a flat ground with the handle rotated fully back to prevent rocking.
- B.** Release the buckle and lengthen the Harness Straps by pressing Harness Adjuster (under the flap) while grasping both Shoulder Harness Straps and pulling out desired amount of slack.
- C.** Move the two harness tongues to the sides of the infant carrier and store in the Buckle Tongue Holder (if fitted) (holders are on both sides of the Padded Insert or the sides of the cover). Move the harness buckle towards the Harness Adjuster.
- D.** Place baby into Infant Carrier lying on its back so that the buckle is between the baby's legs.
- E.** This section covers the setting up of the harness to fit the height of the child and fitting of the harness is not required. Securing of the child is covered later in the instructions.

Lift the Harness Adjuster and pull the Harness Straps to slacken.

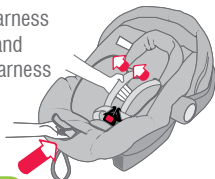

Buckle Tongue Holder (if fitted)

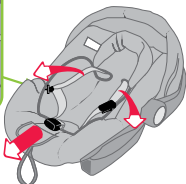

HOW TO SET-UP

- F.** The Infant Carrier is fitted with three shoulder strap positions.
As the baby grows, the shoulder straps must be moved to higher slots.

The shoulder straps must be in the slots which are nearest to the child's shoulders, but not lower than the child's shoulders.

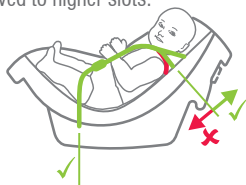

1. Outer crotch strap slot
2. Inner crotch strap slot
3. Lap strap slot
4. Harness tongues & buckle
5. Shoulder harness strap
6. Lower shoulder strap slots
7. Medium shoulder strap slots
8. Upper shoulder strap slots
9. Maximum shoulder height marker.
10. Harness Adjuster (under cover flap)

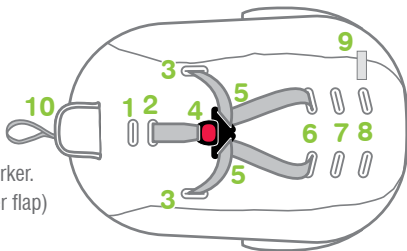

If the baby is newborn you will need to use either slot 6 or 7 and crotch strap position 2. With the baby in the carrier, check that the slot is just above the baby's shoulder. If the strap is not in that slot then change the slot as described on pages 18 to 20. If the slot is just above the shoulders then go to page 21.

HOW TO SET-UP

CROTCH STRAP

The Infant Carrier is fitted with two crotch strap positions. Correct location of crotch strap will securely position the baby correctly in Infant Carrier and will prevent baby from slipping further into Infant Carrier.

As baby grows the crotch strap must be moved to the outer slot.

ADJUSTMENT OF CROTCH STRAP

- A. Remove the Infant Carrier from car as instructed on page 32.
- B. Lift Infant Carrier cover to reveal crotch strap slot.
- C. From the top side of Infant Carrier turn the crotch 3-bar slide and push through each slot as shown right until the Crotch strap assembly is free from the Infant Carrier.
- D. Insert Crotch strap through restraint slot which will position Crotch strap level with the baby's crotch and feed back through other slot as shown right.



IMPORTANT :

When replacing cover, ensure none of the harness straps are twisted and that all straps are secure by pulling each harness strap.

SMALLER BABY

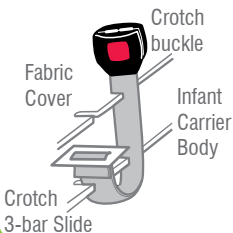

LARGER BABY

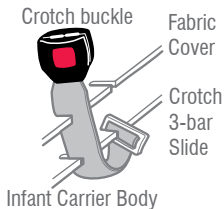

HOW TO SET-UP

ADJUSTING THE SHOULDER HARNESS

- A.** At the rear of the Infant Carrier, remove one of the harness shoulder straps from metal Strap Connector by slipping strap through open slot. The Metal Strap Connector is shown in diagram right.

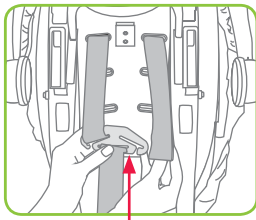

Metal Strap Connector

- B.** Pull the shoulder strap through slot.
- C.** Insert the shoulder strap through the Infant Carrier slot which will position the shoulder strap level with or above the baby's shoulder (see page 17). Ensure that the shoulder strap passes through matching slots in the cover and seat shell.

If a Padded Insert is used then that will need to be re-positioned and the strap re-inserted when changing the slot position.

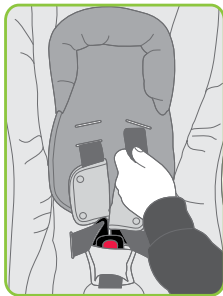

HOW TO SET-UP

- D. Ensure there are no twists in the straps.
- E. Connect it to the Metal Strap Connector at rear of Infant Carrier.
- F. Repeat for the other shoulder strap. It is better to change one strap at a time so that the other strap will be a guide for re-assembly.



IMPORTANT :

Do not use the carrier with the harness shoulder straps set at different heights or fed through mismatching slots. Ensure the harness straps are not twisted and that all straps are secured by pulling each harness strap.

FOR SMALL BABY

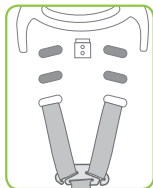

FOR GROWING BABY

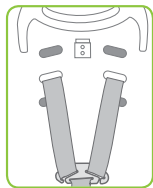

FOR LARGER BABY

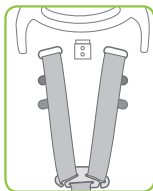

HOW TO INSTALL

Consult the car owner's handbook for location of anchor fittings or anchorage points. Some vehicle manufacturers recently have an anchor fitting fitted in the car.

If there is no child restraint anchor fitting or child restraint anchor point refer to pages 53-57 for the installation of the anchor fitting as well as the use of extension straps.

An anchor fitting is required to attach the upper anchorage strap to fully install the Carrier to the car. The upper anchorage strap must be used with this infant carrier when used in the car.

For installing the Base to the car, select a seating position with a child restraint anchor fitting directly behind the seating position.

INSTALLING THE BASE TO THE CAR

A. Place the base and Infant Carrier on vehicle seat in a seating position where a child restraint anchor fitting is installed. The Level Indicator Line needs to be level with the road, (i.e. parallel with the road surface). Check and adjust the Levelling knob of the base if necessary.

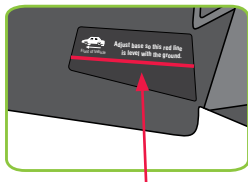

Level Indicator Line on both sides of base.

B. If your car's seat is contoured then you may need to adjust the angle of the base so your baby is not too upright.

The angle may be altered by turning the base levelling knob located at the rebound bar end which will cause the levelling foot to extend from the under side of the base.

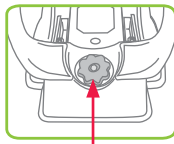

Levelling Knob

HOW TO INSTALL

Always leave a rearward slope angle of approximately 10° to 15°

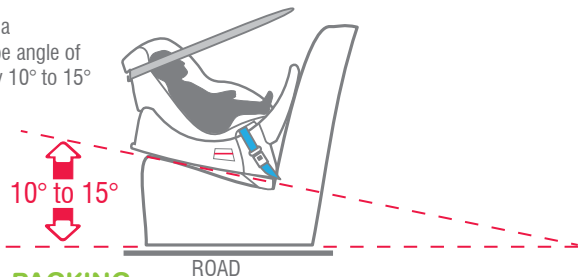

MANUAL PACKING

The angle may also be altered by placing a firm packing between the seat and the underside of the base (packing can be a firmly rolled up towel or nappy). For some vehicles with flat seats some packaging may be required at the front edge of the base to get some recline. The stabilising bar does not need to touch the car's seat back but should be close.

Always leave a rearward slope angle of approximately 10° to 15°

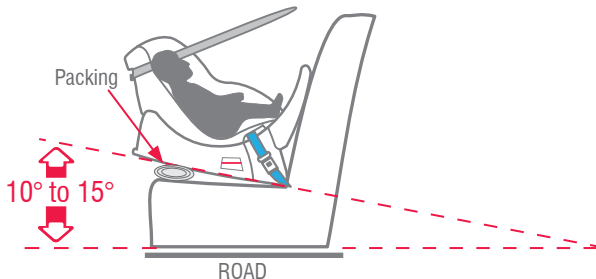

HOW TO INSTALL

C. Place the base into the car in the selected seating position with the Stabilising bar beside the car's seat back as shown.

D. Extend the seat belt to maximum length. For a lap-sash seat belt, position the tongue in the middle of the fully extended belt. Feed the seat belt through the blue REAR-FACING SEATBELT PATH labels on each side through the Belt Guide Hooks.

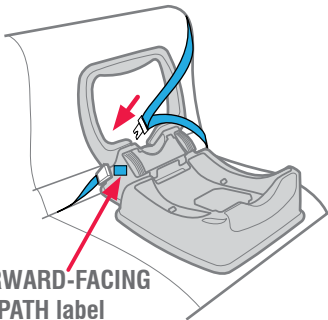

**Blue REARWARD-FACING
BELT PATH label**

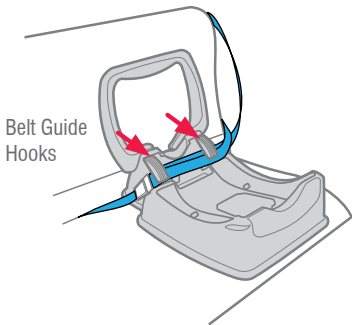

HOW TO INSTALL

- D. Engage the seat belt tongue to the buckle.
- E. Pull the slack out of the seat belt and ensure the base is held firm against the seat back. If a lap-sash seat belt is used then allow the excess sash belt to feed back in to the retractor.

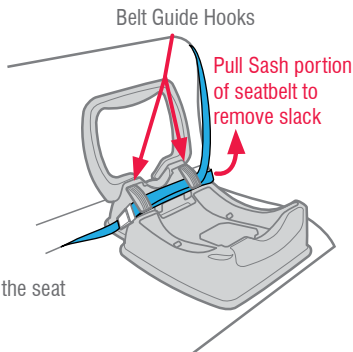

To remove the base from the car, release the seat belt, pull the seat belt out.

NOTE: Seat belt extenders should not be used if the seat belt is not long enough to secure the child restraint. If they are used then the buckle must not contact the Belt Guide Hooks.

If the seat belt will not stay tight in every day use, then fit a 3-bar gated buckle to the lap-sash belt to prevent loosening. See pages 58 to 59. (Not supplied with seat).

HOW TO INSTALL

INSTALLING UPPER ANCHORAGE STRAP

- A.** Locate the child restraint anchor fitting in the car that is directly behind the seat location in the rear seat you have chosen. Refer to the car owner's manual for the location (If there is no anchorage fitting then refer to pages 53 - 57 for instructions in adding an anchor fitting). Connect the Upper Anchorage Strap Attachment Clip to the Anchor Fitting.

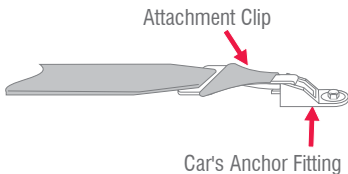

Lengthen the strap by pressing the adjuster button (1) and pull the strap (2) so that the strap is ready to attach to the Carrier.

Fully press Adjuster Button (1) while pulling Upper Anchorage Strap (2) to lengthen.

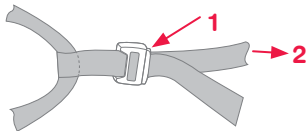

THIS UPPER ANCHORAGE STRAP MUST ALWAYS BE FITTED WHEN THE INFANT CARRIER IS USED IN THE CAR.

- B.** While the Infant Carrier is out of the car, store the upper anchorage strap between the stabilising bar and the car seat back so that it will be ready for use when the Infant Carrier is put back in the car.



WARNINGS

Always attach hook and remove slack.

HOW TO USE

PLACING BABY IN INFANT CARRIER

When positioning baby into Infant Carrier make sure baby's back is fully supported onto the flat section and the baby's nappy area (bottom) is resting in the bottom curvature as shown. It is recommended that bulky nappies are not used when baby is travelling in the Infant Carrier as they can cause incorrect positioning of the baby's back in the Infant Carrier.

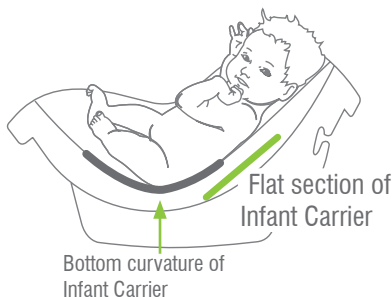

- A.** Loosen Harness Straps by pressing the Harness Adjuster while grasping both the Shoulder Harness Straps and pulling out the desired amount of slack.

Press the Harness Adjuster and pull Harness Straps to loosen.

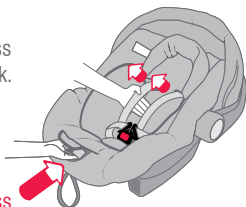

HOW TO USE

- B.** Move the two harness tongues to the outer extents of the infant carrier, into the Buckle Tongue Holder (if fitted). Move the harness buckle towards the Harness Adjuster.

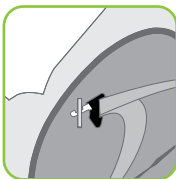

Buckle Tongue Holder (if fitted)

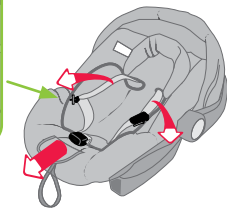

- C.** Place baby into Infant Carrier lying on its back so that the buckle is between the baby's legs. Ensure that baby's arms and legs are free. Make sure baby is dressed to allow the Harness Buckle to be pulled up between baby's legs e.g. a jump suit. **Never wrap the baby in a blanket before placing in the Infant Carrier, fit the blanket after the harness is fitted.**



NOTE:

1. Discontinue using the Padded Insert if the Pad causes over heating, discomfort or you need more room for baby to grow.
2. Correct fitment of the harness is very important as it restrains the baby in the Infant Carrier. The harness must fit firmly around upper torso of the baby and be positioned so as to leave the baby's arms and legs free.
3. This Infant Carrier needs to be used until the baby reaches the shoulder height marker. It is acceptable for the legs to be bent to fit.

HOW TO USE

SECURING BABY IN INFANT CARRIER

- A. Place each arm through each shoulder strap of the harness. Position the buckle of the crotch strap as shown right.
- B. Fit either harness tongue into the Harness buckle followed by the other tongue until a click is heard. If the second tongue does not engage - press the red button and re-insert the tongues. Check secure engagement by pulling harness straps.

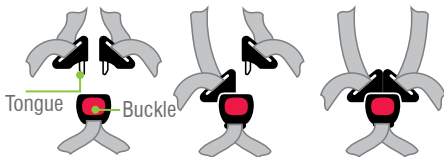
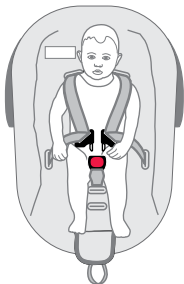

CAUTION:

The end of the harness adjustment strap is connected to the cover to avoid tripping over the end. Ensure the harness adjustment strap hook is attached when carrying the carrier (see page 29).



HOW TO USE

- C. Ensure slack is removed from the lap straps by pulling the shoulder harness straps through the buckle tongues, then pull the Harness Adjustment Strap to take up the slack in the harness, adjusting to a firm but comfortable fit. Make sure that the baby's arms and legs are free and the crotch strap is between the legs. Check that the slack in straps is minimal. Do not use the restraint if straps do not tighten and contact your local authorised service agent for repair.

Pull Harness Straps through the buckle in direction of arrows

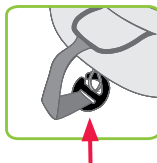

Hook the Adjuster Strap on to the loop to prevent tripping over the strap.

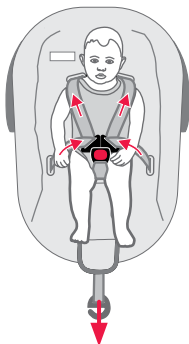

Pull Harness Adjustment Strap to remove slack.



CAUTION: A LOOSE HARNESS IS DANGEROUS

Ensure the end of the harness Adjustment Strap is connected to the cover to avoid tripping on the end. Ensure the Harness adjustment strap hook is attached when carrying the carrier (see above).

HOW TO USE

PLACING BABY & INFANT CARRIER IN BASE

- A. Position the Infant Carrier over the top of the base. Make sure the Harness Adjustment Strap is not caught between Infant Carrier and Base then lower the Infant Carrier into position.

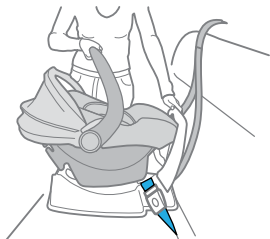

- B. Push down on the Infant Carrier until an audible click is heard. Pull on the Infant Carrier to ensure it is correctly locked into position.

 **IMPORTANT:**
Lift again to check engagement.

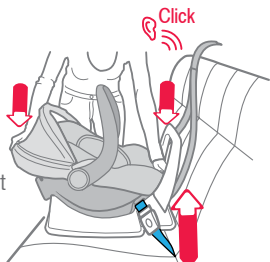

- C. The handle may be rotated into other positions if needed although this may be difficult with the seat in front.

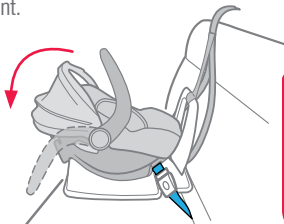

 **CAUTION:**
If fitted with the Britax Stroller Click & Go™ Adaptor, ensure to operate the handle as per pages 13 and 14 to prevent pinching fingers.

HOW TO USE

- D. Ensure the upper anchorage strap attachment clip have been fitted to the car's anchor fitting. If not already connected, refer to page 25.

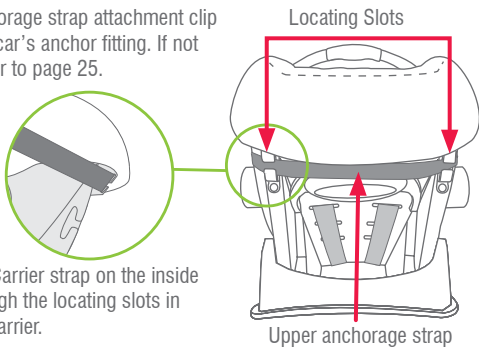

- E. Feed the Upper Infant Carrier strap on the inside of the handle and through the locating slots in the front of the Infant Carrier.

- F. Adjust the Upper Anchorage Strap by pulling as shown below to remove any slack in the straps. Do not over tighten.

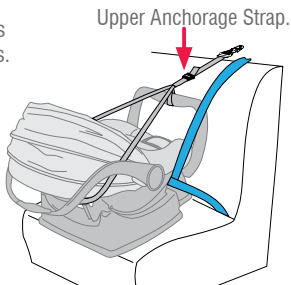
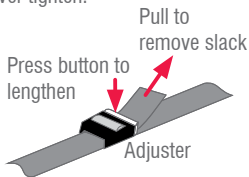

IMPORTANT :

The Upper anchorage strap must be fitted at all times when the baby is in the car.

HOW TO USE

REMOVING BABY & INFANT CARRIER FROM BASE

- A. Loosen the upper anchorage strap. Ensure that the adjuster does not fall on the baby.
- B. Remove the upper anchorage strap from the locating slots in the Infant Carrier.
- C. Store the anchorage strap between the rebound bar and the car seat back so that it will not fall behind the seat or get trapped in the door. This will keep the upper anchorage strap visible and ready for use when the Infant Carrier is put back in the car.
- D. Rotate the Carry Handle to the “carry position” ① location (page 13).
- E. Grasp the handle with one hand lifting the Infant Carrier release catch with the other hand. With the catch lifted raise the Infant Carrier clear of the base.

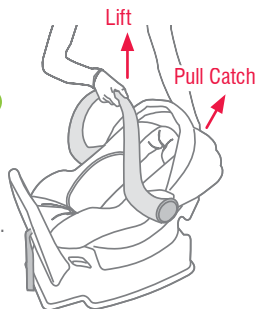

Always ensure the handle is locked in position before lifting.

- F. When the Infant Carrier is clear of the base, carefully remove it from the car.

Ensure the Adjustment Strap hook is connected to the cover, See page 29.

HOW TO USE

REMOVAL OF BABY FROM INFANT CARRIER

- A. Rotate the carry handle to either the access or "non-rocking position" ③ and ensure the Canopy is fully open.
- B. Press the Harness Adjuster while pulling shoulder straps to loosen the harness.
- C. Press the red button on Harness Buckle then both Harness Tongues will be released. Place Buckle tongues through Buckle Tongue Holder's (if fitted) on each side of the cover or Padded Insert.
- D. Feed the baby's arms through each side of the Harness and place the straps on each side of the carrier clear of the baby. Lift the baby out of the carrier.

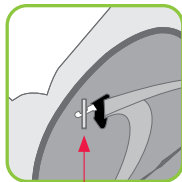

Buckle Tongue Holder (if fitted)

NOTE: Once the baby gets heavier you may wish to leave the carrier in the car. In this case you will need to disconnect or loosen the upper anchorage strap before removing the baby.

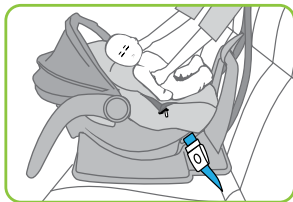
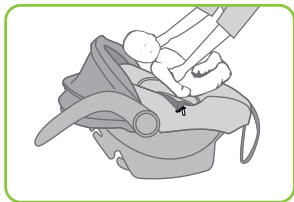

SHOULDER HEIGHT MARKERS AND THE NEXT STEP

FOR THE NEXT CHILD RESTRAINT CHOOSE FROM:

- Convertible Child Seat, If the convertible seat is suitable for approximately 12 months then continue to keep your child rear facing until they reach the shoulders reach the lowest marker. Then turn to forward facing until the child reaches the top marker - approximately 4 years of age.

OR

- Dedicated forward facing seat with in-built harness- for children who have outgrown their baby carrier up to approximately 4 years of age.

OR

- Convertible booster seat with in-built harness that faces forward- for children who have outgrown their rear facing seat. This can be used up to approximately 4 years of age which can then be converted to a booster seat up to approximately 8 years of age.



Convertible
Child Seat



Forward-Facing
Seat



Convertible
Booster Seat

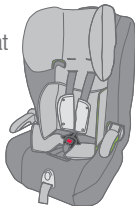

CARE & MAINTENANCE

REGULAR CARE OF THIS RESTRAINT:

Please check the following items regularly to ensure the safety of your child:

- A.** Check the webbing for fraying.
- B.** Ensure the inside of the buckle is free of foreign matter, food or feeding liquids. Check that the buckle clicks and is not sluggish or sticky in operation. If sluggish, wash the buckle as shown on page 39.
- C.** Ensure there are no cracks in moulding or the plastic moulding.
- D.** Check the harness adjuster is operating and is clamping the webbing.
- E.** If any part of the Infant Carrier is cracked or broken, seek repair immediately or replace the Infant Carrier.
- F.** Check that the Infant Carrier catch retains the Infant Carrier to the base. Check screws and rivets are firmly in place. If not seek repair.

CLEANING

Use only mild soap and water with a damp cloth to clean all straps, metal and plastic parts of the restraint. Do not use chemicals or cleaning agents.

CARE & MAINTENANCE

COVER

For baby's comfort and health the Infant Carrier cover is removable for cleaning. Cleaning instructions are on the care label attached to the liner. Washing the cover prior to use will remove excess fluff and dye's.

TO REMOVE THE COVER

- A.** Remove the Canopy and Baby insert pad (if supplied) as described on page 15. Unclip the two infant carrier cover straps which are secured by plastic hooks under the handle attachment point.
- B.** Disconnect the shoulder harness straps from the Metal Strap Connector and feed through shoulder slots in both infant carrier and cover. Refer to page 19.
- C.** Feed the shoulder harness straps and tongues through lap strap slots in the Cover only. There is no need to remove the harness straps from the Infant Carrier.
- D.** Lift the cover around the rim of the infant carrier at the harness adjuster end, feed the crotch buckle through the slot in cover and pull the harness adjuster strap out of the slots.
- E.** Remove the cover for cleaning.

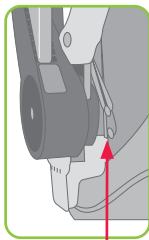

Unhook clips on either side of cover under the handle then remove cover

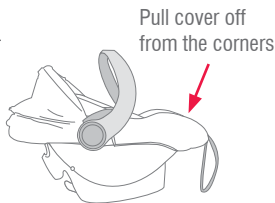

CARE & MAINTENANCE

TO REPLACE THE COVER

- A. Place the cover over the infant carrier ensuring all slots in cover line up with slots in infant carrier.
- B. Ensure that there are no twists in all straps underneath the Infant Carrier.
- C. Feed the shoulder harness straps through lap strap slots in cover.
- D. Feed the shoulder harness straps through the shoulder strap slots in cover and then in through the Infant Carrier. Refer to page 17 for correct shoulder harness position for your baby. Attach the shoulder harness straps to the strap connector.
- E. Feed the crotch buckle as well as the harness adjuster strap through the slots in the cover.
- F. Refit plastic hooks on cover to Infant Carrier as shown right.
- G. Engage shoulder harness tongues and crotch buckle. Pull to check harness is attached.
- H. Ensure the straps are not twisted.

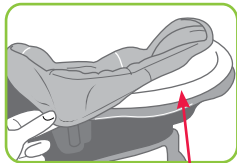

Pull elastic cover over
Infant Carrier

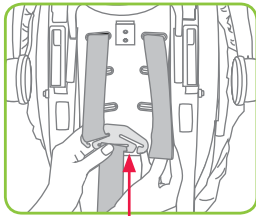

Metal Strap Connector

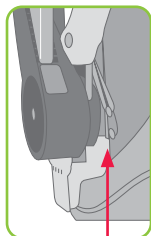

Plastic Hooks

CARE & MAINTENANCE

COVER (style may vary)

The cover has been designed to protect your child when seated in the restraint. Care should be taken if children either eat or drink while in the restraint as some products may cause damage or marking to the cover.



IMPORTANT:

Do not pull sticky items from covers as the cover may be damaged - soak in water and gently remove. The seat cover and accessories must not be replaced with any other than the one recommended by Safe-n-Sound, because the cover is an integral part of the child restraint and how it performs. The child restraint must not be used without the cover and the padding provided.



VERY IMPORTANT:

Only use this child restraint with the cover supplied or a manufacturer-authorised replacement cover with identical shoulder height markers.

CARE & MAINTENANCE

BUCKLE OPERATION

To ensure the buckle remains operational the inside of the buckle must be kept free of liquids, sand, dirt, fluff, food or similar substances. If the buckle is not operating or does not have the click when second tongue is inserted then the buckle needs to be washed or replaced. Contact our Customer Service Department for assistance.

TO CLEAN HARNESS BUCKLE:

If sticky liquids such as baby formula, fruit juice, etc. get inside your Harness Buckle, it may become sluggish. An indication of a sluggish Harness Buckle is that you cannot hear a click when engaging the Harness Tongues. To restore the Harness Buckle to good working order it needs to be cleaned as follows:

- A. From the underside of the restraint pull each crotch 3-bar slide then turn 3-bar slide and push through each slot to remove the Harness Buckle from the restraint.
- B. Place the Harness Buckle under warm (max. 40 degrees Celsius) running water as shown below. Let the water run through the mouth of the buckle for five minutes.
- C. Engage and disengage the Harness Tongues and Buckles several times until a strong audible click is heard.
- D. If you still cannot hear a strong audible click after engaging the last Harness Tongues into Buckle, then repeat cleaning several times. If the Harness Buckle cannot be returned to its original working condition then contact Britax Childcare Customer Service.
- E. Refit the harness buckle to the restraint with the red button facing out & feeding each 3-bar slide through appropriate slot (see page 18).



ACCESSORIES

The following instructions apply to accessories that may be supplied with this restraint at point of purchase. If not, a variety of accessories are available from various retailers of Safe-n-Sound products.

TO REMOVE PADDED INSERT - Style may vary

The Padded insert is only required for supporting the smaller baby and must be removed once baby's shoulders reach the upper shoulder height marker to allow longer use of the Carrier.

- A.** Disengage the harness buckle and feed the buckle out through buckle slot in the Padded insert.
- B.** Remove the insert pad from the shoulder harness straps. Installation is the reverse of removal procedure.
- C.** Discontinue use of the Padded insert if it causes discomfort or cramps the space available for baby within the Infant Carrier.

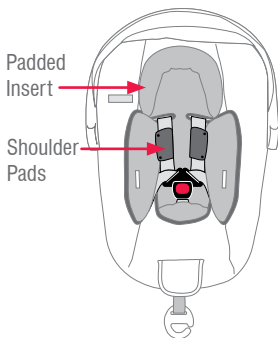

SHOULDER PADS

The shoulder pads may require release by press studs. If fully fitted to the shoulder strap then you will need to disconnect the shoulder strap as described on page 18.

ACCESSORIES

EXTRA BASE

An Extra Base is available as a separate purchase for a second car. These bases can mean that the Carrier can be easily and quickly switched between cars. An extra upper anchorage strap is supplied with the Base.

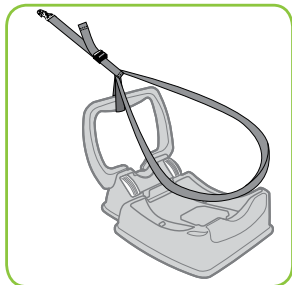

OTHER ACCESSORIES

Only use accessories designed and recommended by Britax Childcare Pty Ltd for this product.

TRAVELLING TIPS

SAFETY

Never hold a baby in arms when riding in a motor vehicle. In this position the baby could be thrown against the dashboard, windscreen or other occupant and suffer serious injury or death.

When riding in a motor vehicle never nurse a baby and use the same seat belt for both of you. In this position the baby or child could be crushed.

Children must be secured in appropriate restraints at all times when the car is in motion. Children travelling unrestrained and standing up in the car are in danger of serious injury or death. Traffic regulations in all states require children to be secured in child restraints or adult seat belts where available.

Plan your trip with frequent comfort stops to reduce stress on babies, young children and driver. Keep the car well ventilated to reduce heat stress. Two car windows should be kept open to maintain a good flow of fresh air if air conditioning is not used.

Never leave babies or toddlers in a stationary car in the sun because of the risk of heat exhaustion.

Ensure babies and toddlers are adequately shaded from direct sunlight through side or rear windows.

Be on guard against carbon monoxide poisoning which can occur through only a slight leak in the exhaust system while travelling in a closed car.

Securely stow all heavy objects, feeding bottles, etc. that could become missiles during an accident and cause injury to any occupant.

TRAVELLING TIPS

CLOTHING/BATHING

Take several changes of clothing and bibs for possible car sickness. Disposable nappies and liners are very handy while travelling. Since it is often warmer in the car, dress the baby in light clothing. When cooler, it is easier to place a blanket over the baby than it is to remove the baby from the restraint and change clothes.

Take a pack containing baby soap, oil, powder, cotton wool, small towel and wet washer in a plastic bag.

FEEDING

Never breast feed a baby while car is in motion. Babies will require extra feeding if travelling in the heat. For bottle fed babies, make up the bottles and refrigerate before leaving home for a day trip. Place in a cool bag and reheat as needed with hot water from a thermos.

Alternatively, bring boiled water in a thermos and pre-measured amounts of baby formula in small containers. Use the water from the thermos to mix with the formula when required. Regardless which method is used, it is always a good plan to carry some boiled water in a sterile container or bottle.

Do not attempt to carry warm milk because germs multiply rapidly in warm milk.

TRAVEL SYSTEM

This Infant Carrier is designed to be connected to compatible strollers. The following pages provide a general instructions about using the Infant Carrier with a stroller which may differ slightly for some strollers. Preferably use the attachment instructions provided with your stroller. Use the stroller in accordance with the instructions supplied with the stroller. This Infant Carrier will not fit all strollers.

There are two systems to connect to the Infant Carrier to the stroller. Check with the stroller instructions or promotional literature to see which system applies.

- Integral latch which fits to the arm bar or tray, or
- Britax Stroller CLICK & GO™ Adaptor that fits to the receivers on the stroller side armrests.



WARNINGS

DO NOT LEAVE THE CHILD IN THE INFANT CARRIER FOR EXTENDED PERIODS.

THE TRAVEL SYSTEM INFANT CARRIER IS DESIGNED TO PROVIDE MOBILITY OUTSIDE OF THE CAR BUT IT SHOULD NOT BE USED IN PLACE OF AN APPROPRIATE COT.

THE INFANT CARRIER MUST ONLY BE USED WITH A SAFE-N-SOUND AND STEELCRAFT STROLLERS WITH COMPATIBLE ATTACHMENTS. DO NOT USE WITH ANY OTHER STROLLER.

IF IN DOUBT ABOUT THE METHOD OF INSTALLATION, CONTACT BRITAX CHILDCARE CUSTOMER SERVICE ON 1300 303 330.

TRAVEL SYSTEM - INTEGRAL LATCH

INSTALLATION INSTRUCTIONS PREPARING THE INFANT CARRIER - LATCH METHOD

- A. Remove Infant Carrier with the Baby from the Base by loosening the upper anchorage strap and disengaging the upper restraint strap from the guides on the back of the Infant Carrier.
- B. Rotate handle into "carry position" ① then lift the release catch with the other hand.
- C. With the release catch depressed lift the Infant Carrier.
- D. When Infant Carrier clears the base hooks, raise Infant Carrier further and remove from the car.

PREPARING THE STROLLER

- A. Ensure the Stroller has been assembled correctly before fitting the Infant Carrier.
- B. Open the Stroller, apply the brakes and lower the backrest to the fully reclined position.
- C. Remove the arm bar cover and store in the basket pocket.

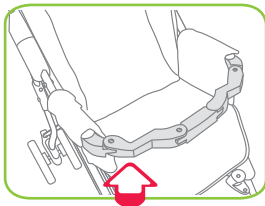

Arm Bar cover removed

* Refer to page 13 for handle position

TRAVEL SYSTEM - INTEGRAL LATCH

INSTALLING THE INFANT CARRIER INTO THE STROLLER - LATCH METHOD

- A. Ensure that the arm bar (or tray) is fully locked in position on both sides of the armrests.
- B. Position the Infant Carrier over the Stroller with the baby's head end of the Infant Carrier over the Stroller arm bar (or tray).
- C. Lower the Infant Carrier and ensure that it locates onto the Arm Bar, (or tray) and the latches engage.

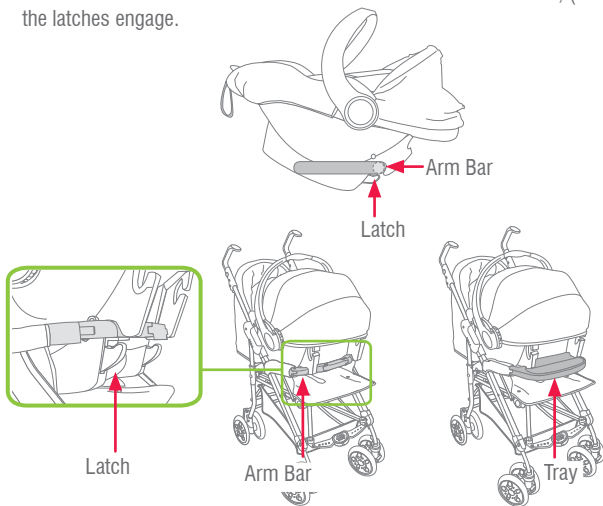

TRAVEL SYSTEM - INTEGRAL LATCH

- D. Then lower the foot end of the Infant Carrier until it rests on the seating surface of the stroller.
- E. Fold the Infant Carrier handle down if required, then check the Infant Carrier is securely fixed to the stroller before use.
- F. Refer to the Stroller instruction book for other instructions.

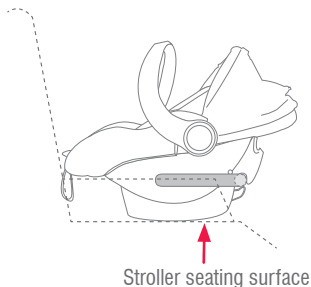

REMOVING THE INFANT CARRIER FROM THE STROLLER

- A. Fold the Infant Carrier handle up to the "carry position" ① and grip firmly in one hand.
- B. Raise the Infant Carrier release catch located on the rear of the Infant Carrier.
- C. Lift the Infant Carrier clear of the stroller.

ENSURE THE BABY IS SECURED IN THE INFANT CARRIER WITH THE HARNESS AT ALL TIMES. THE INFANT CARRIER IS FITTED WITH A CANOPY WHICH CAN BE USED WHEN THE CARRIER IS CONNECTED TO THE STROLLER. THE CANOPY CAN ALSO BE USED IN THE CAR.

* Refer to page 13 for handle position

TRAVEL SYSTEM - BRITAX STROLLER CLICK & GO™ ADAPTOR

TO FIT INFANT CARRIER INTO STROLLER - BRITAX STROLLER CLICK & GO™ ADAPTOR METHOD

If the Infant Carrier is fitted with Britax Stroller Click & Go™ Adaptor, then fit as follows:



IMPORTANT : Only use Infant Carrier with compatible Britax/Steelcraft Stroller.

- A. Where applicable, remove the stroller seat or bassinet from the stroller frame (refer to stroller instructions). With the Infant Carrier handle in the “carry position” ①, place the Click & Go™ Stroller Adaptor on each side directly over the stroller frame mouldings and push down.
- B. To secure the Carrier to the stroller rotate the handle to the third position the “non-rocking position” ③, To do this:
- Squeeze the carry handle release latch on each side of the handle and rotate to the first position-“rocking position” ②.
 - Squeeze the latch again and start to rotate the handle then remove both hands from the latches and use one hand at the top of the handle to rotate down further until the handle latches in the second or “non-rocking position” ③. The carrier is now locked to the stroller.

* Refer to page 13 for handle position

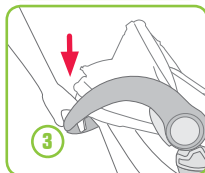
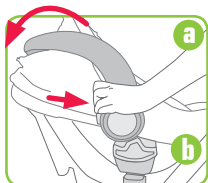
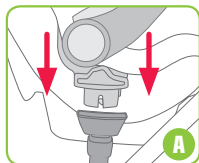

TRAVEL SYSTEM - BRITAX STROLLER CLICK & GO™ ADAPTOR



To avoid pinching your fingers follow the steps on page 48.

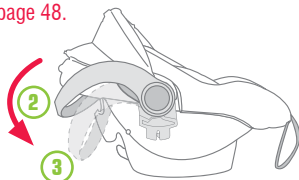

Push down until it clicks into place.



VERY IMPORTANT:

Always lock the Infant Carrier to the stroller frame by rotating the handle.



IMPORTANT:

Pull up Carrier to ensure it is locked in position.

- C. If the baby is not already in the Infant Carrier then secure your baby into the Infant Carrier by the harness (see page 26)

* Refer to page 13 for handle position

TRAVEL SYSTEM - BRITAX STROLLER CLICK & GO™ ADAPTOR

TO RELEASE INFANT CARRIER FROM STROLLER WITH BRITAX STROLLER CLICK & GO™ ADAPTOR

- A. Squeeze both carry handle release latches to release the handle and rotate upwards.
- B. Rotate the handle upwards, towards the “carry position” ① to unlock the carrier from the stroller.
- C. Once handle is locked in the “carry position” ① lift and remove the Infant Carrier away from the stroller frame.

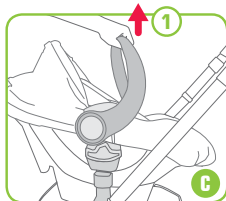
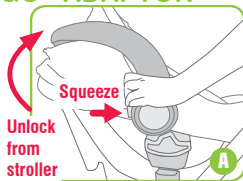

FITTING OF THE BRITAX STROLLER CLICK & GO™ ADAPTOR

If you wish to upgrade this Infant Carrier to use the Britax Stroller Click & Go™ Adaptor system the you will need to fit the adaptors .

The Britax Stroller Click & Go™ Adaptors is available at most Nursery Stores.

To attach the Britax Stroller Click & Go™ Adaptors to the Carrier ensure the Carrier's Handle is in "Rocking position" ② and trim is placed aside to align the holes.

* Refer to page 13 for handle position

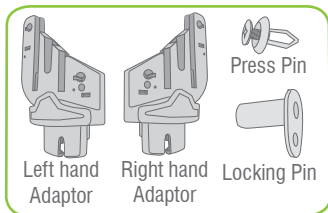

TRAVEL SYSTEM - BRITAX STROLLER CLICK & GO™ ADAPTOR

- A.** To attach the Britax Stroller Click & Go™ Adaptor to the Infant Carrier ensure the Carrier's Handle is in "Rocking position" **2**, disconnect the elastic under the handle boss and pull the trim away from the side of the carrier and trim is placed aside to align the holes.
- B.** Align the Adaptor in the recess under the handle boss, push up and click into place.

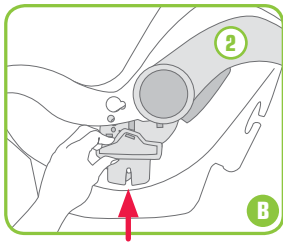

Push in under handle

- C.** Insert Locking Pin into hole. Align both top and bottom holes.

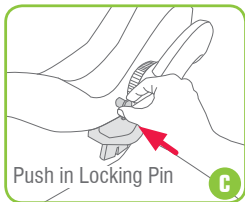

Push in Locking Pin

* Refer to page 13 for handle position

TRAVEL SYSTEM - BRITAX STROLLER CLICK & GO™ ADAPTOR

D. Then push the Press Pin in the bottom hole and push into place.

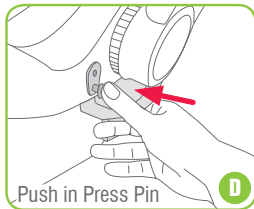

E. Now replace the trim pull elastic underneath the adaptor and hook. Place elastic in groove shown below.

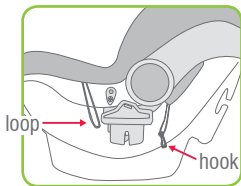

Hook elastic behind the adaptor and place in groove

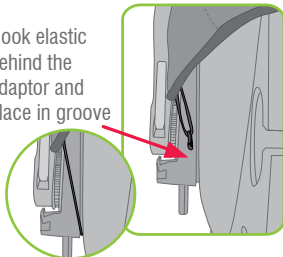

HOW TO REMOVE THE BRITAX STROLLER ADAPTOR

If you need to remove the Britax Stroller Click & Go™ Adaptor ensure cover is moved aside and handle is in “rocking position” ②. First unscrew the Press Pin half way and then pull out. Pull out the locking pin and gently remove the adaptor away from carry handle. Store for future use with these instructions.

The Stroller instruction book will also provide full instructions for use on a Stroller.

* Refer to page 13 for handle position

INSTALLATION OF CAR ANCHOR FITTING

Consult the vehicle owner's handbook for location of anchorage fittings or anchorage points and the possible use of spacers. Some vehicles may have an anchor fitting fitted by the vehicle manufacturer. If anchorage points cannot be found refer to car manufacturer or local child restraint fitting station or traffic authority for optimum position of anchorage point and the use of spacers.

UPPER ANCHORAGE STRAP



IMPORTANT:

THE ATTACHMENT CLIP COVER MUST ALWAYS BE USED AS IT PREVENTS THE RISK OF INCORRECT FITMENT OF THE ATTACHMENT CLIP TO THE ANCHOR FITTING. ALWAYS ENSURE THAT THE ATTACHMENT CLIP IS CORRECTLY ENGAGED TO THE ANCHOR FITTING AND NOT HOOKED OR FITTED TO ANY OTHER OBJECT BEFORE EACH USE OF THE RESTRAINT. THIS IS ESPECIALLY IMPORTANT IN VEHICLES SUCH AS STATION WAGONS, VANS, HATCH BACKS OR VEHICLES WITHOUT A FIXED PARCEL SHELF, SINCE THE ANCHOR POINT IS USUALLY NOT VISIBLE.

IMPORTANT INSTALLATION NOTE:

In some vehicles the anchor fitting in the rear vertical panel can only be installed in one way. Please refer to vehicle owner's handbook or a child restraint fitting station for correct method.

INSTALLATION OF CAR ANCHOR FITTING

Extension Strap distance to be measured.

Length 300mm (Use Safe-n-Sound part 0035 or equivalent).

Length 600mm (Use Safe-n-Sound part 0036 or equivalent).

Available from all major child restraint retailers.

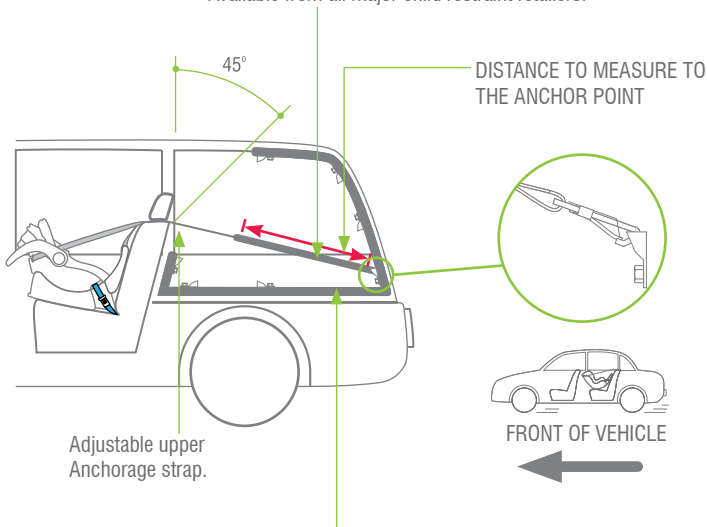

The shaded areas of this diagram illustrate the possible locations of the anchor fitting. Within each shaded area is an anchor fitting showing the correct way to install the fitting. Ensure the anchor fitting is aligned as illustrated unless stated otherwise in the vehicle owner's handbook.

INSTALLATION OF CAR ANCHOR FITTING

IF THE CAR IS FITTED WITH CHILD RESTRAINT ANCHORAGE POINT

Locate the anchorage point behind the rear seating position. (consult the car owners handbook for the location of the anchorage point). The anchorage point should be directly behind and central to the restraint. Remove thread plug from the parcel shelf/floor/roof, etc. and install anchor bolt and fitting as shown in Fig 1.

CAUTION: DO NOT OVERTIGHTEN ANCHOR BOLT. OVERTIGHTENING MAY FRACTURE OR BREAK BOLT. MAXIMUM TORQUE IS 20 Nm (14.75 ft.lb.)

Note: Minimum of five full turns of anchor bolt is required before tightening force is applied.

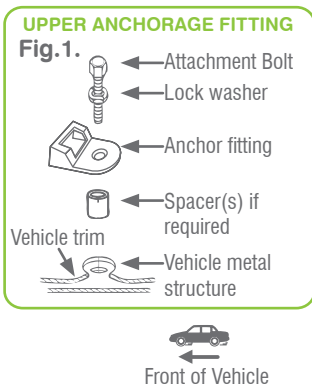

INSTALLATION OF CAR ANCHOR FITTING

IF THE CAR IS NOT FITTED WITH CHILD RESTRAINT ANCHORAGE POINTS

For Sedans only - Drill 9mm diameter hole in the parcel shelf on the centre line of the seating position as shown in Fig 3. Before drilling the hole, check the underside for accessibility. Install the anchor bolt as shown in Fig 2.

For vehicles other than Sedans - In Australia, consult your nearest child restraint fitting station or traffic authority for vehicle inspection to find the best, correct position for the placement of the anchorage point, and for the correct attachment bolt length and use of spacers. In New Zealand, consult the agent for the vehicle.

Note to Queensland purchasers: The installation of anchorage points must be approved by authorised officers appointed by Queensland Transport. Authorised officers can be sourced from all Queensland Transport Customer Service and Queensland Ambulance Service Centres.

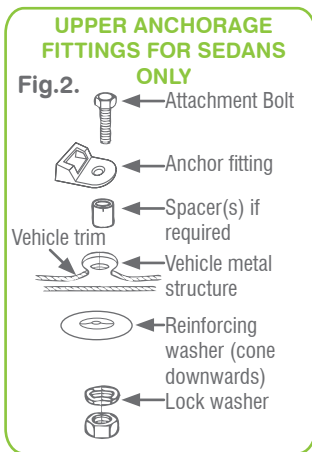

INSTALLATION OF CAR ANCHOR FITTING

ONLY USE A 5/16 UNC GRADE 5 BOLT. IF THE BOLT IS NOT THE CORRECT LENGTH THE CAR MANUFACTURER'S HAND BOOK CAN PROVIDE ADVICE ON THE CORRECT LENGTH BOLT.



WARNING

CHILD RESTRAINTS MUST NOT BE ATTACHED TO UNSOUND METAL OR TO WOOD, OR SYNTHETIC STRUCTURES. WHEN DRILLING 9 MM HOLE DO NOT DRILL THROUGH FUEL LINES, FUEL TANKS, ELECTRICAL WIRING, OR RADIO SPEAKERS. WEBBING STRAPS MUST BE PROTECTED FROM SHARP CORNERS AND EDGES. THE ANCHOR FITTING MUST BE USED ONLY AS DESCRIBED ABOVE. IT MUST NOT BE HOOKED ONTO ANY OTHER OBJECT.

CAR INSTALLATION ACCESSORIES

(From retailers of Safe-n-Sound products)

EXTRA ANCHOR KITS: Available for using the restraint in additional cars.

Re-order no: 0038

EXTENSION STRAPS: May be required for cars without a fixed parcel shelf.

Re-order no: 0035 (length 300mm) or

0036 (length 600mm)

GATED 3-BAR SLIDE (Locking clip): For converting lap-sash seat belt to lap belt, and to obtain a better fit to the car where the fitted lock-off may not be suitable. Most cars will not need this.

Re-order no: 0215.



Note: Marking on the top of a Grade 5 Bolt.



Front of Vehicle

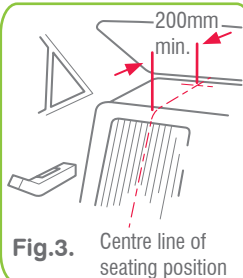

Fig.3.

Centre line of seating position

ALTERNATIVE INSTALLATION IF SEATBELT LOOSENS

LAP-SASH SEAT BELT

If a seat belt will not stay tight, then a Gated 3-Bar Slide may be used to prevent loosening.

There may be two types of Gated Slides available, Curved and Flat.

Before installing the restraint, join the lap-sash seat belt by using the Gated 3-Bar Slide stored under the carrier.

- A.** Hold the lap and sash straps together and fold as shown. Slide the inner strap into the Gated 3-Bar Slide followed by the outer strap.

- B.** The two straps should slide freely in the Gated 3-Bar Slide slot.

- C.** Repeat previous step A for the other slot in the Gated 3-Bar Slide.

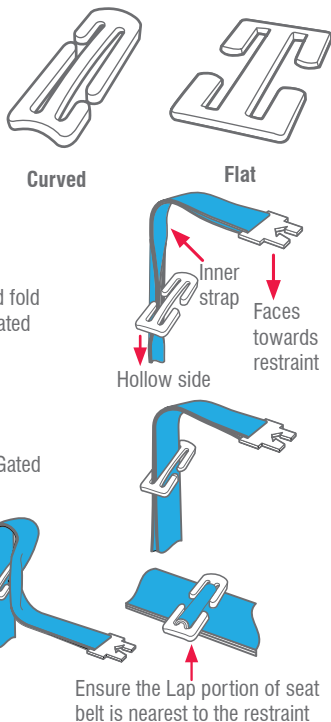

ALTERNATIVE INSTALLATION IF SEATBELT LOOSENS

- D. Feed the straps through the Gated 3-Bar Slide to remove any slack.

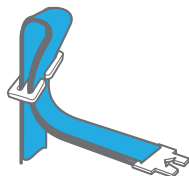

When fitting the Curved Gated Slide, the seat belt route can only go one way, as shown above.

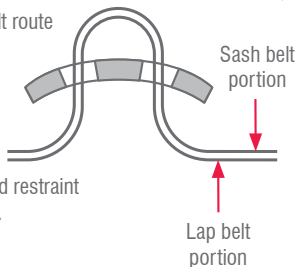

Use this seat belt configuration to install the child restraint according to the instructions on pages 23 to 24.



IMPORTANT:

Remove the gated 3 bar slide from the seat belt as soon as the child restraint is removed so that an adult can use the seat belt as a lap-sash seatbelt.

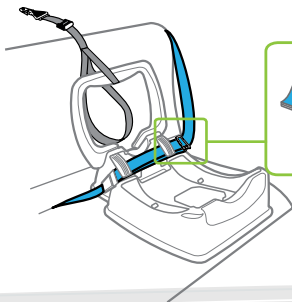

IN CASE OF ACCIDENT

If your restraint has been involved in a severe crash, you should destroy the restraint even if no damage is obvious. Some insurance companies offer vehicle insurance which covers or partially covers the replacement of your child restraint. Contact your insurance company for further details. Your insurance company may require you to keep the child restraint for assessment, **but do not use the child restraint after a severe crash**. To assist you in making an accident insurance claim cut the following statement and include it with your claim.

NOTICE TO INSURANCE COMPANY CHILD RESTRAINT INVOLVED IN AN ACCIDENT

All Safe-n-Sound child restraints are manufactured to Australian/New Zealand Standards AS/NZS1754-2010 which requires us to advise users of child restraints to "Destroy the entire restraint if it has been in use in a severe crash, even if no damage is obvious". The joint Australian/New Zealand Standards committee CS/85, advise that this statement applies whether a child was in the child restraint or not. We consider a "server crash" as being one where the main body structure of the vehicle is distorted.

There is no method of determining if the restraint has been damaged and we concur with the Australian/New Zealand Standards in recommending destruction of the child restraint. This notice is to advise you of the requirements of the Australian/New Zealand Standards and our obligation in complying with the standards.

Please assist the owner of this restraint in their claim.

Britax Childcare Pty. Ltd.

(Incorporated in Victoria)

A.B.N 55 006 773 600

Head office and registered address:

99 Derby Road Sunshine Victoria 3020

PO Box 147 Sunshine Victoria 3020

Telephone: 1300 303 330

www.britax.com.au

New Zealand Office

Britax Childcare NZ Limited.

Telephone: 0508 688 822

www.britax.co.nz



IN CASE OF ACCIDENT

CRASH EXCHANGE

We would never want you to experience an accident, but unfortunately accidents do happen.

If you experience an accident you may be eligible for a free replacement.

The Safe-n-Sound Crash Exchange Program is a voluntary program designed to ensure that our children are safe and that any seat that may have experienced a severe crash is taken out of the market.

There is no method of determining if the restraint has been damaged in a severe crash, so the restraint should be destroyed as the crash may reduce the child restraints ability to perform.

Since its inception in 2006, the Crash Exchange program has helped 100's of families ensure that their children have new restraints and that the restraints are not sold second hand placing others at risk.

Our Crash Exchange Terms and Application form are accessible on our website. Please visit www.britax.com.au for further information.



NOTES

NOTES



AUSTRALIA

Britax Childcare Pty. Ltd.
A.B.N 55 006 773 600

Head office and registered address

99 Derby Road, Sunshine, Victoria 3020.
PO Box 147 Sunshine, Victoria 3020.

Customer Service 1300 303 330

Email au-custserv@britax.com

www.britax.com.au

NEW ZEALAND

Britax Childcare (NZ) Ltd.

Customer Service 0508 688 822

Email nz-custserv@britax.com

www.britax.co.nz

INTERNATIONAL ENQUIRIES

Contact your local Distributor.

The Safe-n-Sound trademark is the property of Britax Childcare Pty. Ltd. (Australia).
The Britax and Click & Go trademark are the property of Britax Excelsior Limited (UK).

We reserve the right to alter this product without notice.

© 2002-2012 Britax Childcare Pty. Ltd. Patent Pending.