

Steelcraft

Warranty

THIS WARRANTY IS VALID IN AUSTRALIA AND NEW ZEALAND ONLY.

Each Steelcraft unit is thoroughly inspected in our Quality Assurance department prior to delivery. In the unlikely case that you find any material or workmanship that effects the units normal operation, we will repair the unit free of charge within 12 months of purchase. You are required to present your receipt as proof of purchase. For all concerns with your product please contact our Customer Service Team.

CUSTOMER SERVICE

1300 303 330 - Australia

0508 688 822 - New Zealand

Please read all the information carefully before using this product. This warranty does not apply to failure due to improper care, or normal wear and tear caused by product use. We reserve the right to inspect the unit. You may be charged for repairs if the product has been damaged accidentally.

This warranty does not apply to a high chair used for commercial purposes.

Your new product has been manufactured to comply with the Australian Standard AS 4684-2009.

Distributed by:

AUSTRALIA
BRITAX CHILDCARE PTY.LTD.
A Britax International company.
(Incorporated in Victoria)
A.B.N. 55 006 773 600
99 Derby Road, Sunshine,
Victoria 3020, Australia
Phone: (03) 9288 7288
Fax: (03) 9311 5798

Due to our continuing program of development, Britax reserves the right to alter the specifications, colour or design without any further notice.

The Steelcraft trademark is the property of Britax Childcare Pty. Ltd-Australia.
Visit the Britax website at: www.britax.com.au or email us at au-custserv@britax.com

Due to the variations in the style and design of our products the illustrations used in this instruction booklet are generic.

©2010 Copyright Britax Childcare Pty. Ltd. Australia

INSTRUCTION MANUAL

Ryder Flat fold high chair

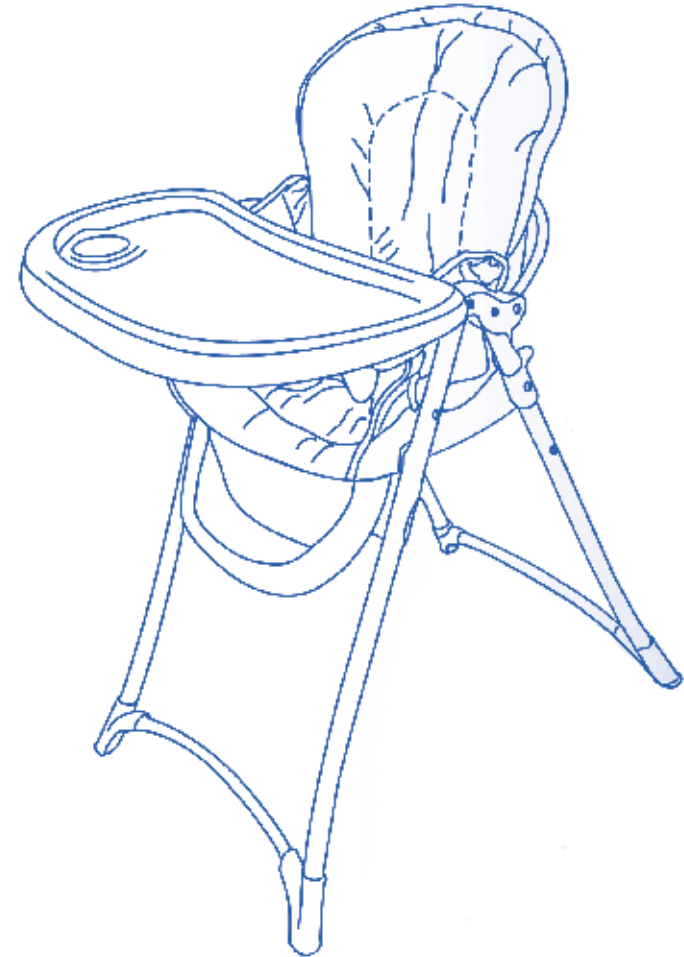

KEEP INSTRUCTIONS IN A SAFE PLACE FOR FUTURE REFERENCE

READ THESE INSTRUCTIONS CAREFULLY AND KEEP THEM FOR FUTURE REFERENCE. THE CORRECT USE AND MAINTENANCE OF THIS PRODUCT IS ESSENTIAL.

WARNING THE CHILD SHOULD BE SECURED IN THE HIGH CHAIR AT ALL TIMES BY THE HARNESS, EITHER IN THE RECLINING OR UPRIGHT POSITION. THE TRAY IS NOT DESIGNED TO HOLD THE CHILD IN THE CHAIR. IT IS RECOMMENDED THAT THE HIGH CHAIR BE USED IN THE UPRIGHT POSITION ONLY BY CHILDREN CAPABLE OF RELIABLY AND CONSISTENTLY SITTING UPRIGHT UNASSISTED.

WARNING PREVENT SERIOUS INJURY OR DEATH FROM FALLS OR SLIDING OUT.

WARNINGS

- FOLLOW THE MANUFACTURER'S INSTRUCTIONS.
- DO NOT LEAVE CHILDREN UNATTENDED.
- THE HARNESS MUST ALWAYS BE USED AND CORRECTLY FITTED.- MOST INJURIES FROM THE HIGH CHAIRS ARE CAUSED BY FALLS.
- POSITION THE HIGH CHAIR AWAY FROM SOLID STRUCTURES AND BENCHES TO AVOID INJURIES CAUSED BY FALLS AND ACCESS TO DANGEROUS ITEMS.
- Double check assembly before placing child into high chair.
- The weight of the child using this product is not exceed 15kg.
- Always keep your child in view whilst using the high chair.
- Always apply the brakes when not moving the high chair.
- Use on a flat, even and horizontal floor and never use near stairs.
- Do not elevate the high chair on any structure or table.
- Do not allow child to stand on the seat.
- Never carry the high chair with the child in it.
- Do not use the high chair without the tray and always ensure the tray is secure on the armrests. The tray is not designed to hold the child in the chair.
- When making adjustments to the high chair, ensure that you and your child's body, fingers and toes are clear of any moving parts on the high chair, otherwise they may be injured.
- Position the high chair away from furniture, walls, hot surfaces and liquids, window covering cords, and electrical cords and position the high chair away from furniture when the chair is not being used at a table.

THIS PRODUCT IS NOT INTENDED FOR COMMERCIAL USE.

CARE AND MAINTENANCE

- To prolong the life of your nursery product keep it clean and do not leave it in the direct sunlight for extended periods of time.
- Trims may be cleaned using warm water with a household soap or mild detergent. Allow it to dry fully, preferably away from the direct sunlight.
- In some climates the trims may be affected by mould and mildew. To help prevent this occurring, do not fold or store the product if it is damp or wet. Always store the product in a well ventilated area.
- To maintain the safety of your of your nursery product, check regularly and seek prompt repairs for bent, torn, worn or broken parts.

Always check parts regularly for tightness of screws and other fasteners - tighten if required.

If the high chair is not working correctly stop using the high chair and seek repair.



PARTS LIST

- A 1 x Seat
- B 1 x Tray
- C 2 x Leg Tubes

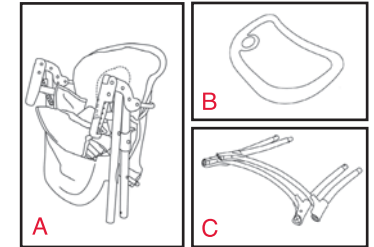

1. ASSEMBLY

- A To open the high chair hold the leg tube and pull outward until the rear legs lock, you will hear a click.
- B Insert the front leg tube into the frame until the press buttons lock. Repeat on rear leg.

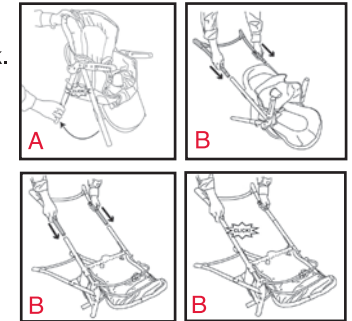

2. TO SECURE YOUR CHILD

WARNING: Use this harness at all times.

A five-point harness is provided to restrain your child. To secure the child in the harness, push buckle (A) and (B) into the buckle housing (C) until the buckle prongs snap into position. Carefully adjust the harness by pulling the slider (D) until the desired snug fit is achieved in the lap, shoulder and crotch straps. Always adjust the harness when changing the seating position of the child. To release the buckle, squeeze the top and bottom prongs.

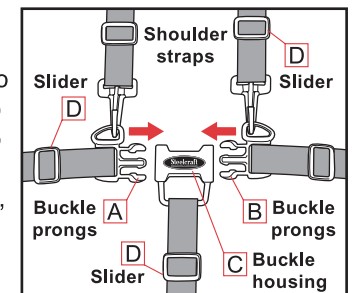

3. TO ATTACH TRAY

- A Pull both left and right release latches located under tray.
- B Align the tray with arm rests and slide to the desired position. Release latches ensuring it has locked into position. The position of the tray can be adjusted by releasing latches and sliding the tray. To remove release latches and pull tray away from seat.

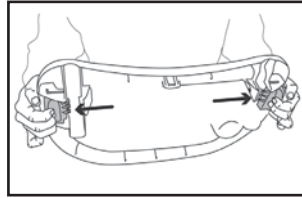

WARNING DO NOT FORCE THE TRAY AGAINST THE CHILD. USE THE THREE ADJUSTABLE POSITIONS. BE SURE BOTH ADJUSTMENT FINGERS ARE ENGAGED TO THE ARMREST.

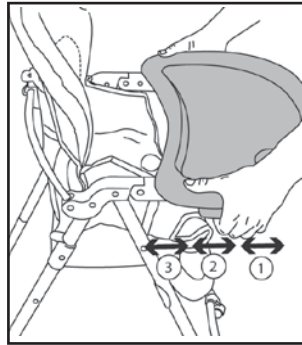

4. TO RECLINE CHAIR

WARNING! DO NOT ADJUST WITH THE CHILD IN THE CHAIR.

- A Squeeze back-rest trigger together to adjust back-rest downwards. To elevate squeeze back-rest trigger together and push seat upwards.

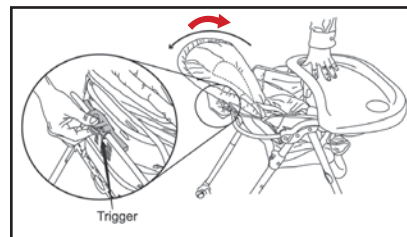

5. TO REMOVE THE CHILD FROM HIGHCHAIR

- A Release tray and remove.
- B Release harness (see section 2) and remove child.

6. TO PLACE CHILD IN HIGHCHAIR

- A Release tray and remove.
- B Place child in seat and secure with harness (see section 2).
- C Slide tray onto armrests.

7. TO FOLD THE HIGH CHAIR

WARNING! DO NOT ADJUST WITH THE CHILD IN THE CHAIR.

- A Pull up on the rear leg release latches. Lift rear of frame and fold forward.

