

# one2<sup>v2</sup>

## Lightweight Tandem Travel System

Suitable for use with **Britax Safe-n-Sound Unity Baby Capsules**  
and the **One 2<sup>v2</sup> Second Seat**.

*(All products are sold separately)*



### 0 - 20kg

*(newborn - 4 years approx.)*

**IMPORTANT** KEEP THIS BOOKLET IN A SAFE  
PLACE FOR FUTURE REFERENCE

SERIES TK321-T | [britax.com.au](http://britax.com.au)

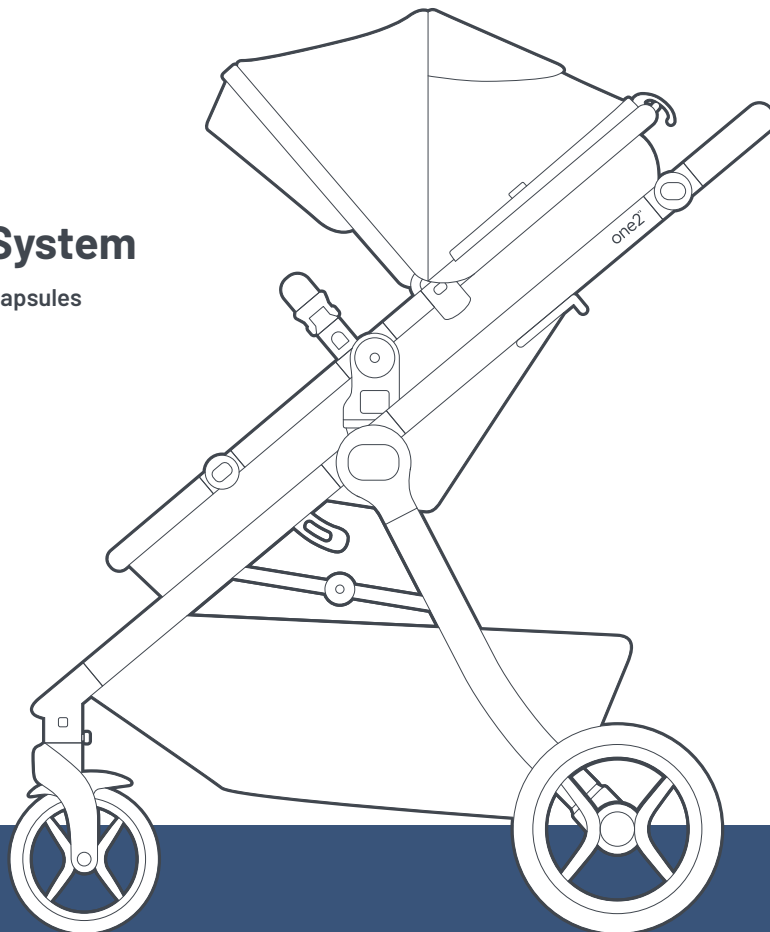

 **Steelcraft**

# Contents

## **Stroller Section**

Stroller Warnings and Important Notes	04
Lift & Carry Correctly	06
What's in the Box: Parts	07
What's in the Box: Accessories	08
Optional Accessories & Compatibility	08
Stroller Features	09
Stroller Configurations: Single	11
Stroller Configurations: Double	12

## **Stroller Assembly**

Opening the Stroller Frame	13
Attaching or Removing the Rear Wheels	14
Attaching or Removing the Front Wheels	14
Attaching the Stroller Seat	15
Attaching the Canopy	16
Attaching the Arm Bar	17
Attaching the Shoulder Harness Pads	18
Attaching the Boot Cover	18
Installing the Newborn Comfort Insert	19
Attaching the Cup / Bottle holder	21

Installing the Sun Shade	21
Installing the Rain Cover	22

## **Stroller Operation**

Using the Brakes	23
Using the Front Swivel Lock	23
Adjusting the Backrest	24
Adjusting the Leg Rest	25
Adjusting the Pivotal Handle	25
Securing Your Child Harness	26
Adjusting the Harness	27
Opening the Harness	27
Adjusting the Shoulder Harness Height	28
Using the Storage Basket	28
Using the Tether Strap	29
Removing & Reversing the Stroller Seat	30

## **Bassinet**

Converting Stroller to Bassinet	31
Fitting the Bassinet Liner	32

## **Stroller Operation**

Using the Stroller	33
Folding the Stroller	34
Lifting and Carrying the Stroller	35

## **Second Seat**

Second Seat Warnings & Important Notes	36
Attaching the Wheel Guards	37
Attaching & Removing the Seat Extension Adaptors	37
Attaching the Second Seat to the Stroller Frame	38
Removing the Second Seat from the Stroller Frame	39

## **Baby Capsule**

Baby Capsule Warnings & Important Notes	40
Installing & Removing the Click & Go™ Adaptors	41
Attaching the Britax Unity Baby Capsule	42
Removing the Britax Unity Baby Capsule	43
Attaching & Removing Britax B-Safe 35 (for NZ market)	44

<b>Care &amp; Maintenance</b>	45
-------------------------------	----

<b>Warranty</b>	48
-----------------	----

<b>Notes</b>	51
--------------	----

**Always** follow the manufacturer's instructions. Read all instructions carefully before assembly and use of this pram/stroller.

**The correct use and maintenance of this product is essential.**



## **WARNINGS** TO AVOID INJURY OR DEATH:

**ALWAYS APPLY THE BRAKES WHENEVER THE PRAM/STROLLER IS STATIONARY.**

- DO NOT LEAVE CHILDREN UNATTENDED.
- SECURE THE CHILD IN THE HARNESS AT ALL TIMES.
- DO NOT CARRY EXTRA CHILDREN OR BAGS ON THIS PRAM/STROLLER.
- MAKE SURE CHILDREN ARE CLEAR OF ANY MOVING PARTS IF YOU ADJUST THE PRAM/STROLLER.
- DO NOT USE ANY ACCESSORIES OTHER THAN THOSE APPROVED FOR USE WITH THIS PRAM/STROLLER BY BRITAX.
- IT IS UNSAFE TO USE ACCESSORIES NOT APPROVED FOR USE WITH THIS PRAM/STROLLER.

- THE MAXIMUM WEIGHT OF THE CHILD IS NOT TO EXCEED:  
PRAM/STROLLER: 20KG  
MOTHER FACING BABY MODE: 15KG  
BRITAX UNITY BABY CAPSULE: 12KG\*  
BRITAX B SAFE 35 CAR SEAT: 15.8KG\*  
MAXI COSI MICO AP: 9KG\*  
NUNA KLIK PLUS: 11KG\*  
SECOND SEAT: 15KG\*  
(\* SOLD SEPARATELY)

### **FOR IMPORTANT NOTES AND WARNINGS ON ACCESSORIES**

- REFER TO THEIR INDIVIDUAL SECTIONS IN THIS BOOK OR THE INSTRUCTION MANUAL INCLUDED WITH THE INDIVIDUAL PRODUCTS. THE MAXIMUM WEIGHT VARIES FOR EACH ACCESSORY.

## IMPORTANT NOTES:

- Use great care when using the stroller on stairs, escalators, travelators or other moving surfaces.
- It is recommended to remove the child from the stroller before going up or down stairs or escalators.
- Do not lift the stroller by the arm bar (supplied) because it may disengage.
- Do not allow children to stand on the seat.
- Do not hang bags unless they are supplied or goods from the handle as this could cause the stroller to tip over.
- Do not leave the stroller and its accessories near an open fire or exposed flame.
- Do not place more than 12kg in the basket at single mode or 4kg at tandem mode, 1kg in the cup/bottle holder or 1.5kg in the organiser bag if supplied or purchased.



### CAUTION

This **CAUTION** symbol is shown at certain steps in this instruction manual to highlight the danger of being injured by moving parts.

## Lift & Carry Correctly

**The SMART lifting technique:** This technique can be used to pick up small light loads from low levels.

### Size up the load

- Assess the load (size, shape, and weight).
- Assess whether the load needs to be moved;
- Where is it going to be placed? Check that there are no obstructions;
- Assess whether mechanical or human assistance is required.

### Move the load as close to the body as possible

- A load is heavier to lift or carry if it is not close to the body.
- The whole hand should be used to ensure a firm grip.

### Always bend your knees

- Maintain balance.
- Keep feet apart and in a comfortable position.
- Minimise lower back bending.
- Bend knees preferable at as large an angle as possible but not at a right angle - use a semi-squat in preference to a full squat.

### Raise the load with your legs

- Achieve the lift smoothly and without jerkiness.
- Maintain the normal curvature of the spine to allow the force of the load to be distributed evenly from the spine to the pelvis.

### Turn your feet in the direction that you want to move the load.

- Avoid unnecessary bending, twisting, and reaching.
- Change direction by turning your feet and not your back.
- To set the load down, squat down, keep your head up and let your legs do the work.

Remember to **THINK TALL** - chest lifted, shoulders relaxed, chin tucked in, and head level.

# What's in the Box: Parts

1 x Stroller Frame & Basket

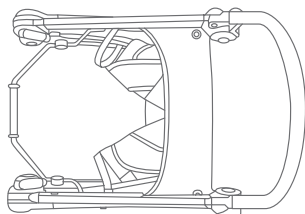

1 x Stroller Seat

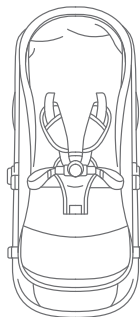

1 x Canopy

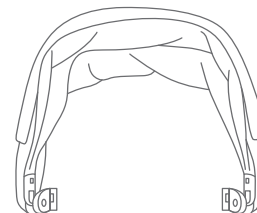

2 x Front Wheels

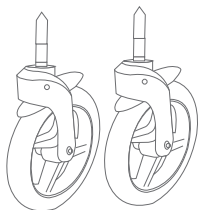

2 x Rear Wheels



1 x Arm Bar

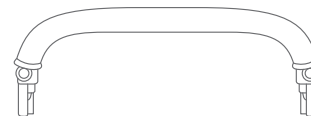

## What's in the Box: Accessories

1 x Bassinet Liner

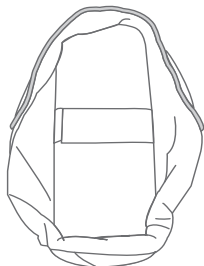

1 x Click & Go™ Adaptors for One 2 V2

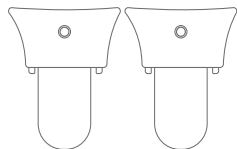

## Optional Accessories

- Click & Go™ Baby Capsule Adaptors for Maxi Cosi Mico and Nuna Klik Plus
- Click & Go™ Adaptors for One 2 V2
- Steelcraft Cup Holder
- Steelcraft Rain Cover
- Steelcraft Shade Cover
- Newborn & Toddler Comfort Pack

## Compatible with:

- Click & Go Signature Bassinet (with Click & Go™ Adaptors)
- One 2 Second Seat (with Extension Adaptors)
- Britax Safe-n-Sound Unity Neos Baby Capsule (with Click & Go™ Adaptors)
- Britax Safe-n-Sound Unity Baby Capsule Isofix Compatible (with Click & Go™ Adaptors)
- Britax B-Safe 35 (for NZ market) (with Click & Go™ Adaptors)
- Maxi Cosi Mico Baby Capsule\* (with Click & Go™ Baby capsule adaptors for Maxi Cosi Mico & Nuna Klik plus)
- Nuna Klik Plus Baby Capsule\* (with Click & Go™ Baby capsule adaptors for Maxi Cosi Mico & Nuna Klik plus)

\* refer to Maxi Cosi Adaptor Instruction manual for attaching and removing baby capsule.



## Stroller Features

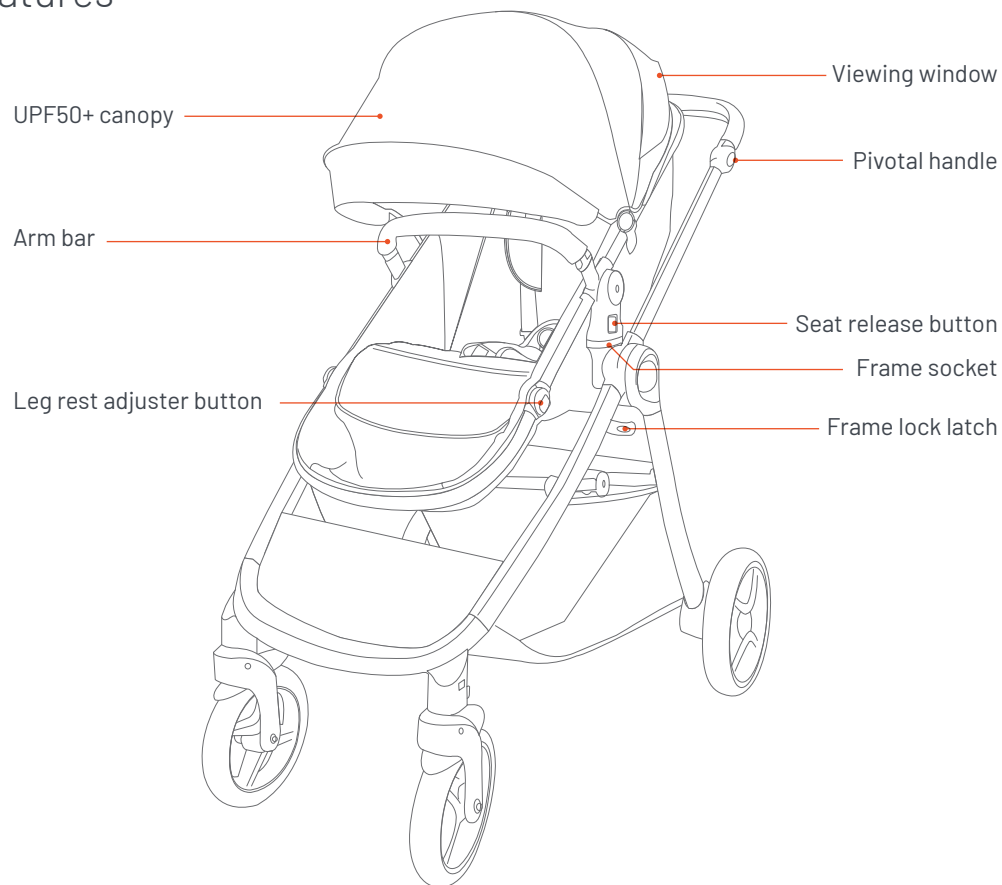

# Stroller Features

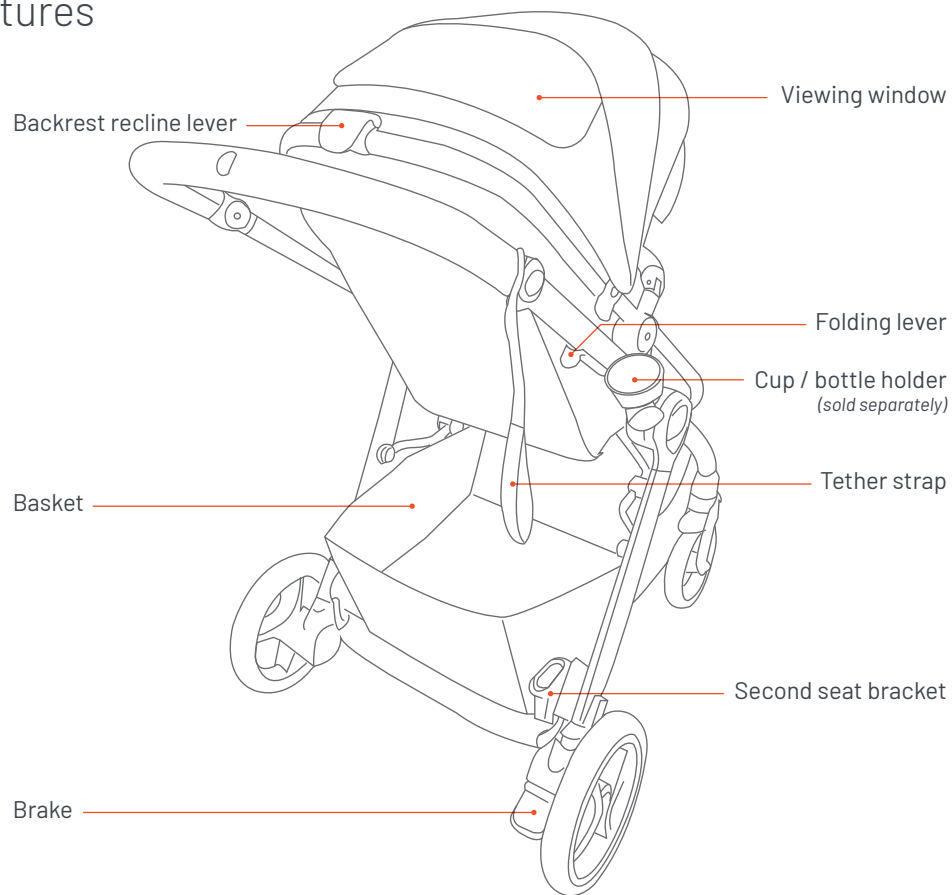

## Stroller Configurations: Single

**PLEASE NOTE:** Shown with optional accessories (*sold separately*).

**DO NOT** exceed maximum weight limits defined in the **Baby Capsules** or **Accessory instruction manuals**.

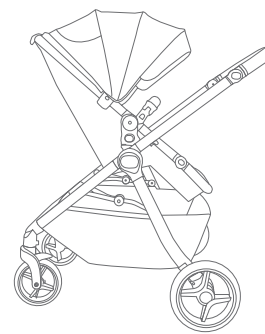
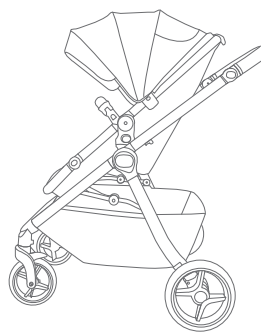
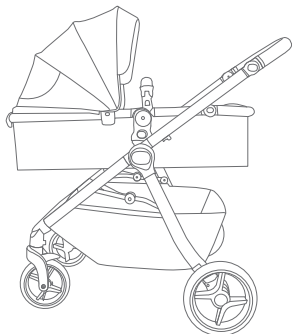
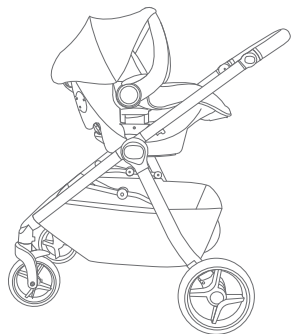

## Stroller Configurations: Tandem

**PLEASE NOTE:** Shown with optional accessories (*sold separately*).

**DO NOT** exceed maximum weight limits defined in the **Baby Capsules** or **Accessory instruction manuals**.

It is recommended to use the extension adaptors (**supplied with the Second Seat**). Do not use the positions shown here if there is not enough space for the lower child.

● Lower position not suitable for Britax B-Safe 35, Maxi Cosi Mico & Nuna Klik Plus

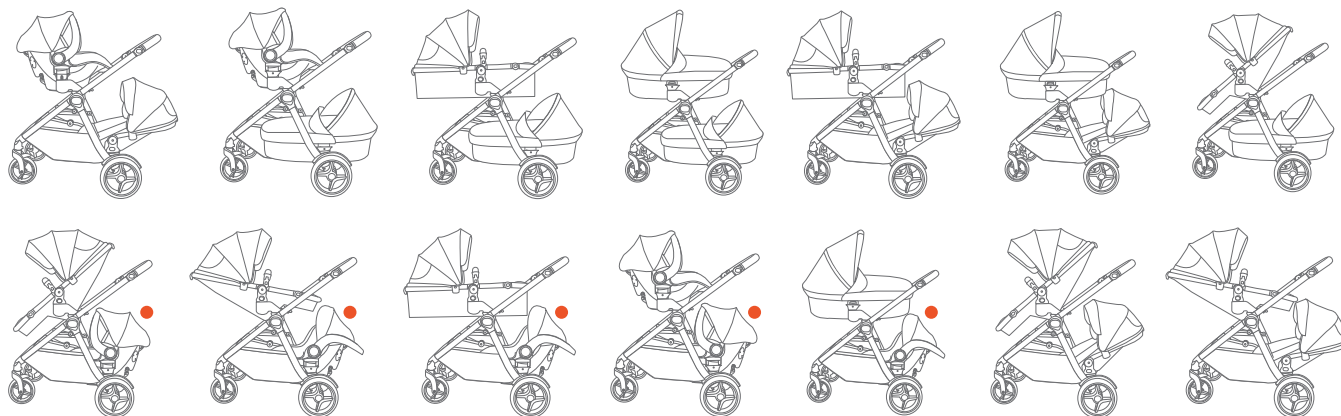

## Stroller Assembly

### IMPORTANT NOTES:

PLEASE REFER TO PAGE 6 FOR  
SMART LIFTING TECHNIQUES.

- Release the storage latch with due care and open the frame.
- When opening the stroller, be aware of the danger of being injured by moving parts and locking devices during the process. Keep all hands and limbs clear of these parts.
- There is potential for fingers or parts of the body to be injured when the stroller is being unfolded, due care should be exercised.
- Keep children clear of the stroller when unfolding the stroller.
- Open the stroller slowly and be careful where you place your hands. Keeping your hands on the handle is the best way to unfold the stroller.

### Opening the Stroller Frame

**A**

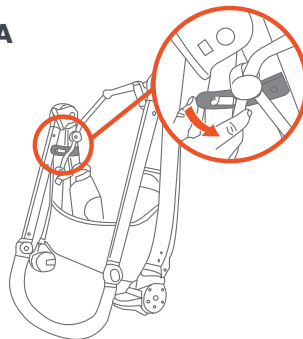

**A** Open the frame lock latches inside the frame. The lower part of the stroller will be open.

**B**

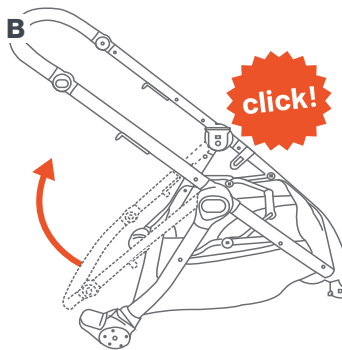

**B** Lift the handle upwards until the frame is fully open and locked.

## Stroller Assembly

### Attaching or Removing the Rear Wheels

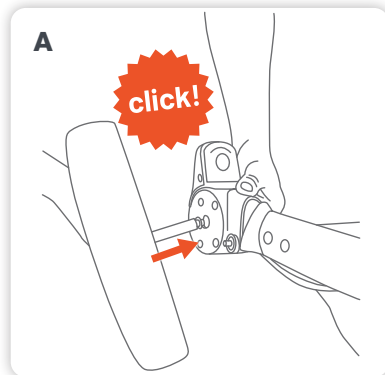

**A** Insert wheel axle into the moulding and push in until you hear a 'click'. Pull on each wheel to make sure it is securely attached. Repeat the process if not locked in.

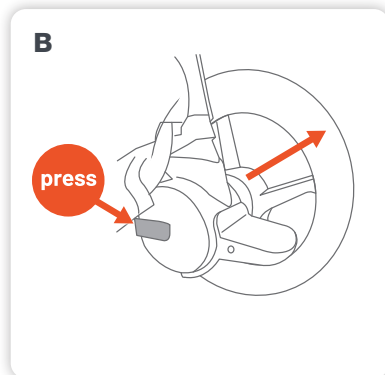

**B** To remove the rear wheels, press and hold the release button in the wheel housing and pull away.

### Attaching or Removing the Front Wheels

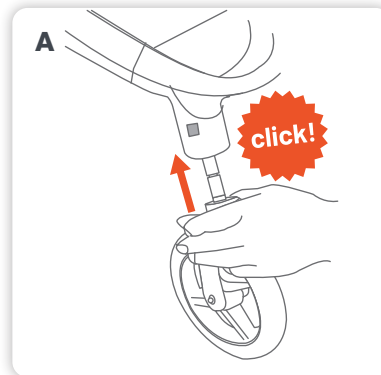

**A** Insert each front swivel wheel assembly into the wheel moulding and push in until you hear a 'click'. Pull on each wheel to make sure it is securely attached. Repeat the process if not locked in.

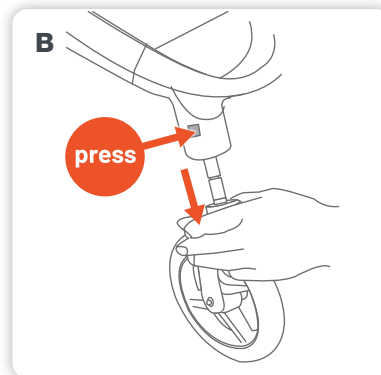

**B** To remove the front wheels, push the release button on wheel moulding.

# Stroller Assembly

## Attaching the Stroller Seat

### IMPORTANT NOTES:

- Always remove your child from the stroller seat before installing, removing or changing the seat direction.

✓ **TIP:** The seat is reversible so it can be attached to the frame in the forward facing position or the rearward facing position.

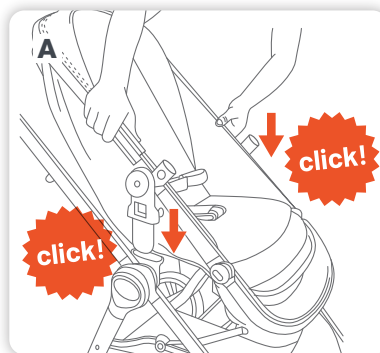

**A** Hold the stroller seat over the frame and align the seat connectors with frame sockets. Push down on the seat until both stroller seat connectors have locked into the frame sockets.

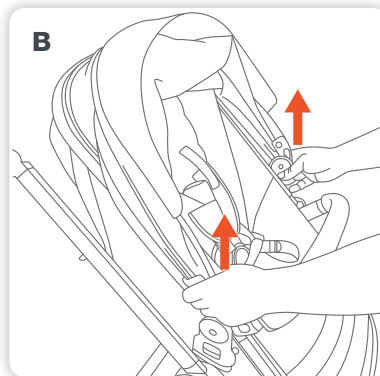

**B** Pull up on both sides of the seat to ensure the seat is locked.

## Stroller Assembly

### Attaching the Canopy

**IMPORTANT NOTE:** The sun is very strong. **DO NOT LEAVE YOUR CHILD EXPOSED TO THE SUN.** The canopy or hood on this product will not give your child total protection from the harmful rays of the sun.

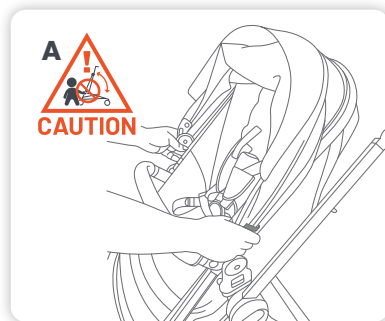

**A** Place the canopy on the stroller seat and push the clips on the sides of the canopy onto the stroller seat until they snap into place.

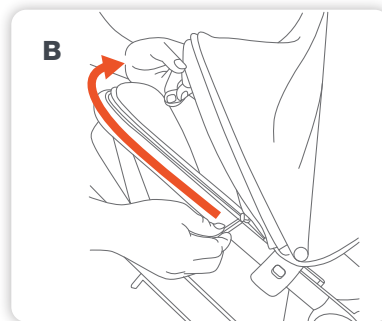

**B** Attach the canopy to the seat unit with the zipper. There is peek a boo window with magnetic closer for viewing and ventilation.

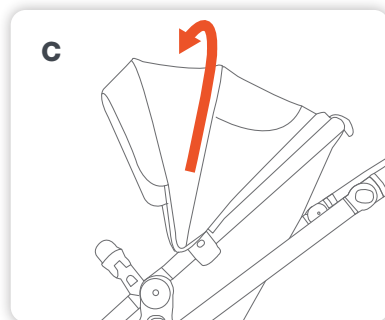

**C** To expand the canopy unzip the centre section of the canopy.

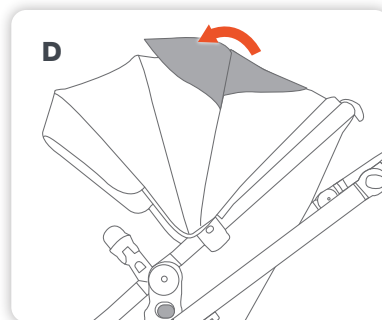

**D** There is a viewing window for ventilation and observation.



# Stroller Assembly

## Attaching the Arm Bar

**WHEN A CHILD IS IN THE STROLLER, KEEP THE ARM BAR ATTACHED AT ALL TIMES.**

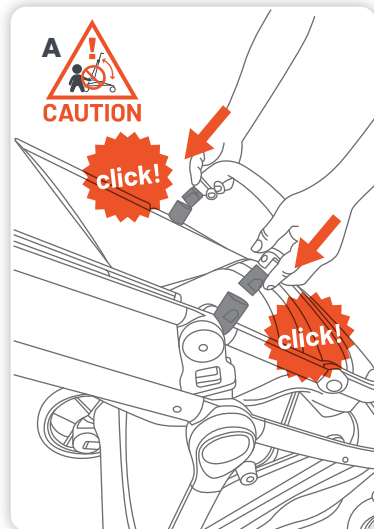

**A** Insert the arm bar mouldings into the sockets on each side of the stroller frame and push down on the arm bar until a 'click'.

To assist with putting a child in the stroller, you can release the arm bar on one side. Press the button on the side of the arm bar moulding and pull the arm bar up and out of the socket. Rotate the arm bar clear of the stroller.

Reattach the arm bar after fastening the child in the harness.

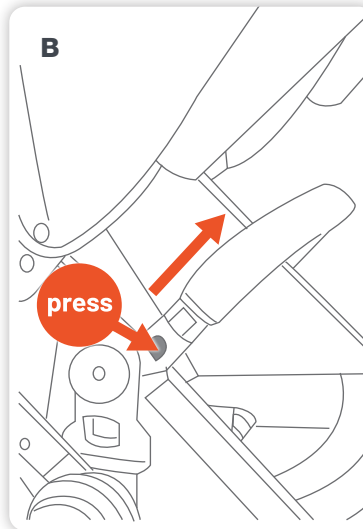

**B** To remove the arm bar, press the button on each side of the arm bar moulding and pull arm bar up and out of the sockets.

## Stroller Assembly

### Attaching the Shoulder Harness Pads

**IMPORTANT NOTE:** Ensure that the shoulder straps are fitted through the appropriate harness slots to suit your child's seated shoulder height. (Refer to Page 24)

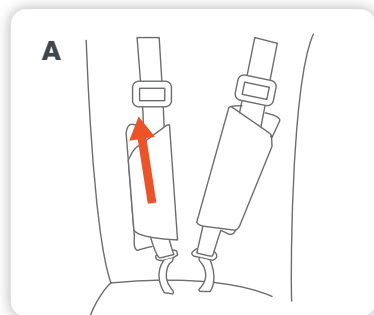

**A** Slide the shoulder pads through the shoulder harness straps and adjust to the position which fits comfortably on the child.

### Attaching the Boot Cover

Sold Separately

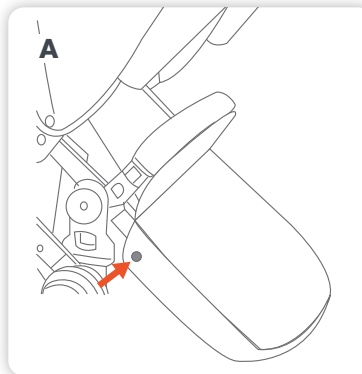

**A** Fit the boot cover over the leg rest and close the snap fastener on both sides of the boot cover.

# Stroller Assembly

## Installing the Newborn Comfort Insert

Sold Separately

### IMPORTANT NOTES:

- Do not use newborn back support wedge in bassinet mode.
- The newborn back support wedge has been designed to help improve and provide a more supportive seating position for newborn or lower birth weight babies.
- The stroller seat should be used in the fully reclined position with the newborn back support wedge.
- The newborn back support wedge should be removed as your baby grows.
- While using this product regularly check to ensure that the harness straps remain tight.
- Ensure that the shoulder straps are fitted through the appropriate harness slots to suit your child's seated shoulder height.

**A**

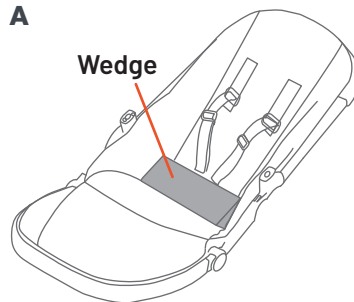

**A** To use the newborn back support wedge, place the newborn back support wedge firmly in the seat.

**B**

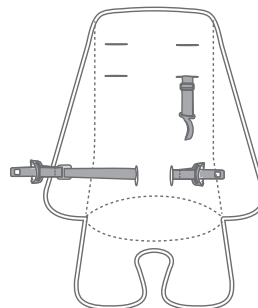

**B** Place the insert on the stroller seat and thread the waist and shoulder harness straps through the buttonholes in the back of the seat insert.

# Stroller Assembly

## Installing the Newborn Comfort Insert

Sold Separately

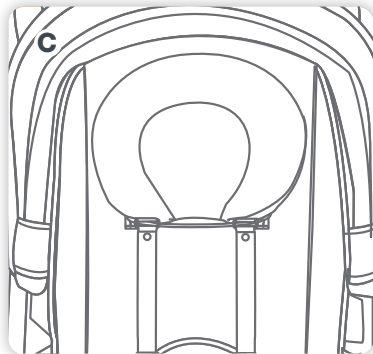

**C** To use the head pillow, place the head pillow elastic behind the shoulder harness strap.

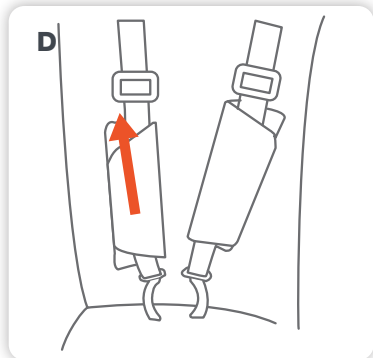

**D** Slide the shoulder pads through the shoulder harness straps and adjust to the position which fits comfortably on the child.

## Stroller Operation

### Attaching the Cup / Bottle Holder

Sold Separately

#### IMPORTANT NOTES:

- Do not place over 1 kg in the cup / bottle holder.
- Do not place hot drinks in the cup / bottle holder.
- Remove contents from the cup / bottle holder before folding the stroller.

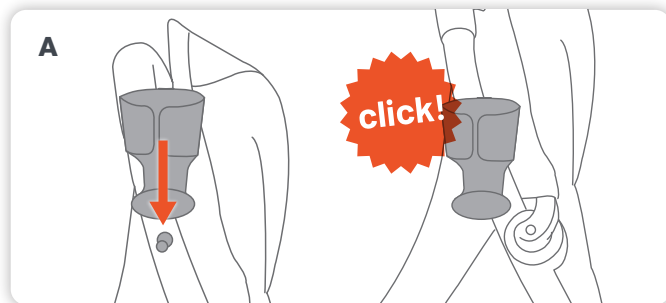

**A** The cup / bottle holder can only fit on the right-hand side of the frame. Push the cup / bottle holder attachment to the connector on the frame.

## Stroller Assembly

### Installing the Sun Shade

Sold Separately

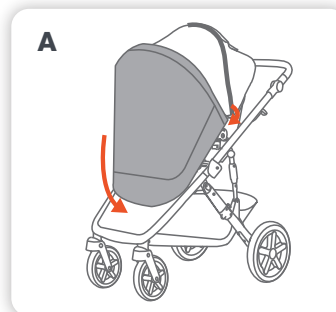

**A** Fit the sun shade over the canopy front and secure the toggle and elastic loop around the canopy frame then pull to the front and secure with the elasticised end.

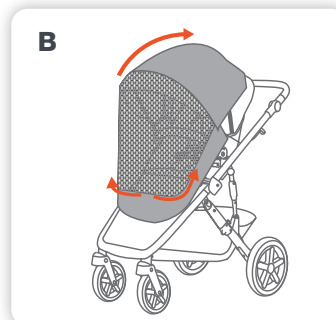

**B** Lift the sun shade cover flap to use mesh panel for ventilation and open zipper to access the baby.

# Stroller Assembly

## Installing the Rain Cover

Sold Separately

### IMPORTANT NOTES:

- Ensure rain cover is kept away from the child's face.
- Refit rain cover if required to ensure child is safe.

✓ **TIP:** The rain cover can be used in both single and tandem modes. An extension panel is also provided which is easily secured to the single mode rain cover with a zip.

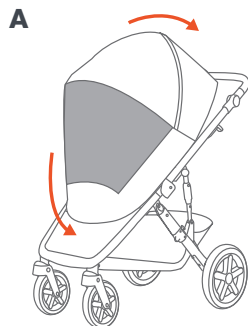

**A** Pull the front elastic section of rain cover over the leg rest. Ensure the rain cover fits snugly over the canopy and is securely fitted to stroller seat.

### Using the Tandem Extension:

**A**

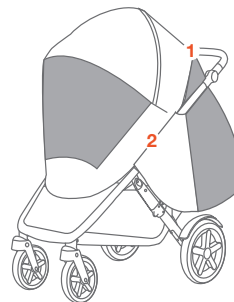

**A** Attach the rain cover extension as required and secure to the rain cover with the zipper (1) and hook & loop (2) attachments.

### Accessing your child:

**A**

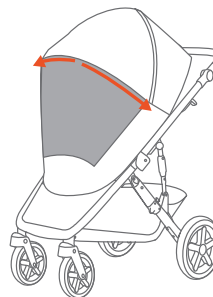

**A** Open zipper (dashed orange line) to access the baby.

# Stroller Operation

## Using the Brakes

**⚠️ WARNINGS:** ALWAYS APPLY THE BRAKES WHEN THE STROLLER IS STATIONARY.

**A**

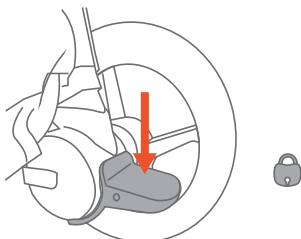

**A** Push down the brake pedal to engage the brake.

**B**

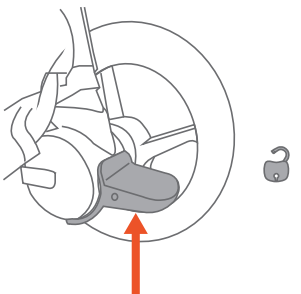

**B** Push the brake pedal upward until the brake is disengaged.

## Using the Front Wheel Swivel Lock

✔️ **TIP:** Always lock the swivel wheels when using the stroller on rough surfaces as this will minimise wheel wobble. The swivel wheels should only be locked when the wheels are in the trailing position (wheels under frame).

**A**

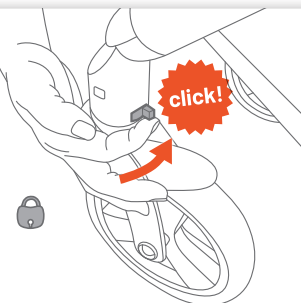

**A** To lock the front wheels into the fixed position, slide the swivel wheel locking clip towards the inside of the frame until you hear a 'click'.

**B**

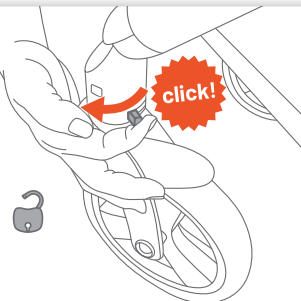

**B** To allow the wheels to swivel, slide the black swivel wheel locking clip towards the outside of the frame until you hear a 'click'.

## Adjusting the Backrest

### **WARNINGS:**

- THE UPRIGHT POSITIONS ARE NOT SUITABLE FOR USE WITH CHILDREN LESS THAN 6 MONTHS OLD.
- THE LOWEST RECLINE POSITION SHOULD BE USED TO TRANSPORT BABIES. THE BACKREST CAN BE ADJUSTED TO A MORE UPRIGHT POSITION AS THE CHILD GROWS OLDER AND IS ABLE TO SUPPORT ITS HEAD WITHOUT ASSISTANCE.

 **TIP:** If the child is sitting in the seat, support the backrest as it reclines. If you have difficulty adjusting the backrest you may need to remove the child from the seat to allow you to raise or lower the backrest with ease.

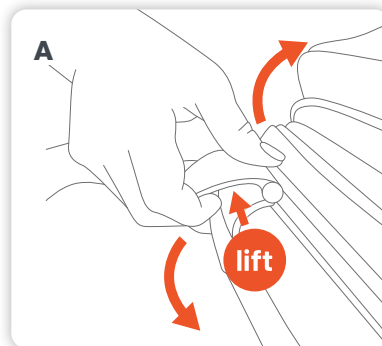

**A** Lift the recline lever on the back of the seat and hold while raising or lowering the backrest to the desired position.

**PLEASE NOTE:**

There are four backrest positions.



## Stroller Operation

### Adjusting the Leg Rest

#### IMPORTANT NOTES:

- The leg rest feature is provided for your child's comfort.
- The leg rest is not designed to support extra weight.
- Do not allow children to stand or sit on the leg rest, it will disengage if extra weight is applied.

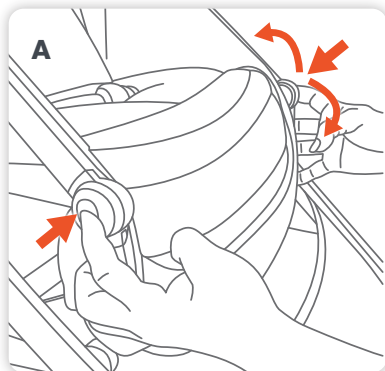

**A** Press the two release buttons on both sides of the leg rest hinge and hold while raising or lowering the leg rest to the desired position.

### Adjusting the Pivoting Handle

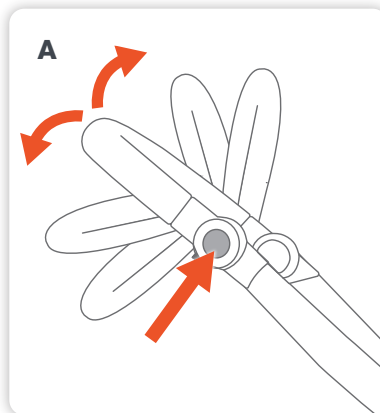

**A** Press the two release buttons on the outside of the handle and hold while raising or lowering the handle to the desired position.

When the desired height has been achieved let go of both release buttons.

# Stroller Operation

## Securing Your Child Harness

### **WARNINGS:**

- ENSURE YOUR CHILD IS SECURED WITH A CORRECTLY ADJUSTED HARNESS.
- THE ADJUSTED HARNESS SHOULD CLOSELY FIT THE CHILD.
- NEVER LEAVE THE HARNESS BUCKLED WHEN NOT FITTED TO A CHILD IN THE STROLLER, BECAUSE THE HARNESS CAN FORM LOOPS WHICH MAY POSE A STRANGULATION HAZARD.
- WHEN HARNESS IS NOT IN USE, DISCONNECT SHOULDER STRAPS FROM THE WAIST STRAPS AND BUCKLE TO PREVENT STRANGULATION.
- A five point harness is provided to restrain your child.
- Buckle tongues separate for added safety.
- To reconnect buckle tongues and to secure the child in the harness please follow the steps below carefully.

**PLEASE NOTE:** Each waist buckle tongue has a raised rib on one side and can only be locked into the buckle assembly with the raised rib facing up. Ensure the harness straps are not twisted as they may become uncomfortable for the child.

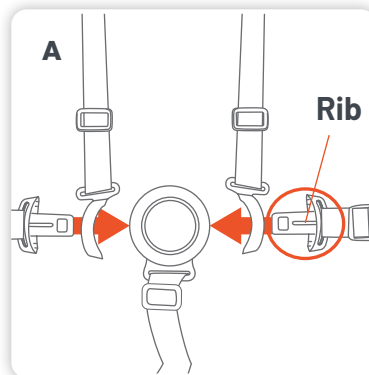

**A** Always apply the brakes before placing child in stroller seat.

Position the shoulder strap near the child's shoulder and position crotch strap between legs.

Thread the waist strap buckle tongues through the shoulder straps tongue guides.



**B** Hold the centre button in on the crotch buckle and insert the waist buckle tongues into the crotch strap buckle until you hear a 'click'.

Repeat the procedure on the other side.

Please ensure it is locked.

# Stroller Operation

## Adjusting the Harness

**CAUTION:** DO NOT SLIDE 3 BAR SLIDER OVER THE SEWN TAB ON SHOULDER HARNESS.

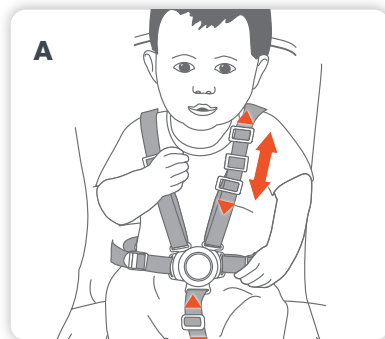

**A** Tighten or loosen the shoulder straps and crotch strap by sliding the 3 bar harness adjuster up or down. The crotch strap should be adjusted to a snug fit.

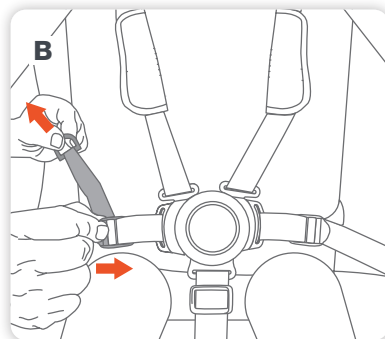

**B** Tighten or loosen the waist straps, hold and lift the 4 bar harness adjuster and pull the harness strap to adjust to the desired fit. The waist strap needs to fit firmly around the child.

## Opening the Harness

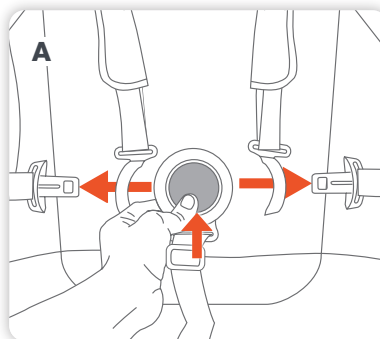

**A** Release the harness by pressing the centre button in on the crotch buckle while pulling the waist tongues out of the crotch buckle.

## Stroller Operation

### Adjusting the Shoulder Harness Height

#### IMPORTANT NOTE:

- The harness can be adjusted to three different heights to accommodate the child. The shoulder straps must be positioned near the child's shoulders.

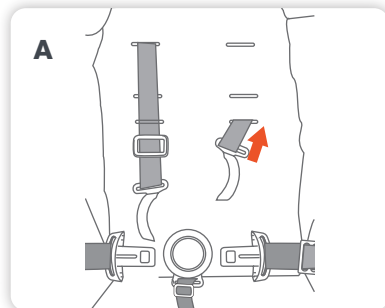

**A** To change the shoulder harness height, push the shoulder harness tongue out of the current harness slot and through the back of the seat.

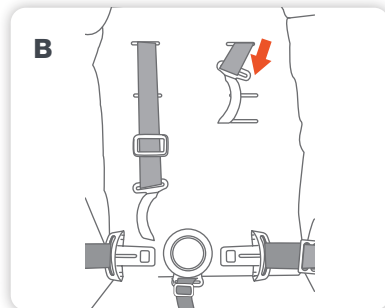

**B** Select the appropriate shoulder harness height and pull each shoulder harness tongue through the harness slot.

### Using the Storage Basket

#### IMPORTANT NOTE:

- Do not place more than 12 kg in the basket at single mode or 4 kg at tandem mode.

## Stroller Operation

### Using the Tether Strap

#### **WARNINGS:**

- **USE THE TETHER STRAP TO STOP THE STROLLER ROLLING AWAY.**
- **THE STROLLER IS DESIGNED FOR USE ON FLAT OR GENTLY SLOPING SURFACES, AND MAY BE UNSTABLE ON HIGHER SLOPING AND UNEVEN SURFACES AND USERS SHOULD BE AWARE OF THE POSSIBILITY OF THE STROLLER ROLLING AWAY OR TIPPING OVER.**
- **NEVER LET GO OF THE STROLLER WHEN PARKED ON AN INCLINE OR SLOPING SURFACE BECAUSE IT MAY SLIDE OR TIP OVER. ALWAYS PARK ON A FLAT SURFACE AND APPLY THE BRAKES.**
- **ALWAYS APPLY THE BRAKES WHENEVER THE STROLLER IS STATIONARY.**

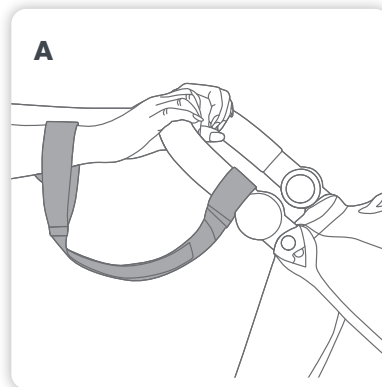

**A** A wrist tether strap is provided on the handle grip. Slide your hand through the tether strap loop whenever you use the stroller. Only remove your hand from the tether strap loop when the brakes have been applied to the stroller wheels.

## Stroller Operation

### Removing & Reversing the Stroller Seat

#### IMPORTANT NOTE:

- Always remove your child from the stroller seat before installing, removing or changing the seat direction.
- The maximum weight of the child using this stroller in rearward facing position (mother facing baby position) is 15kg.

✔ **TIP:** The seat is reversible so it can be attached to the frame in the forward facing position or the rearward facing position.

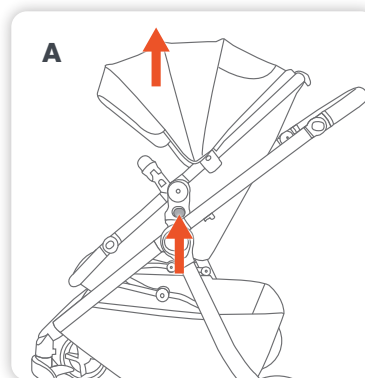

**A** Lift both release levers on the seat connectors at the same time and lift the seat up and away from the stroller frame.

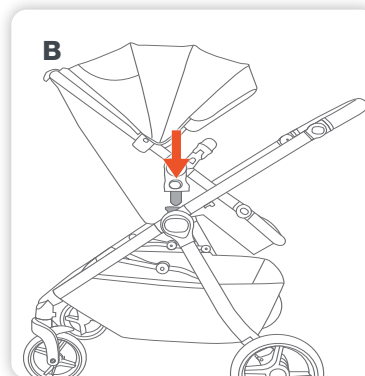

**B** Turn the seat facing opposite direction and then attach the stroller seat to the frame in the rearward facing position.

## Bassinet

### Converting Stroller to Bassinet

#### **WARNINGS:**

- DO NOT USE THIS BASSINET ONCE THE CHILD CAN SIT UP UNAIDED.
- THIS BASSINET IS ONLY USED ON THE FRAME AND CAN'T BE USED AS STAND ALONE BASSINET

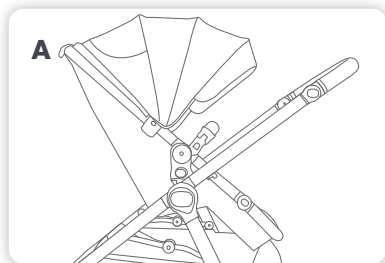

**A** Put the stroller seat into reverse facing position.

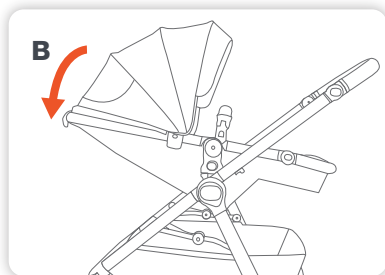

**B** Put the backrest to lowest position.

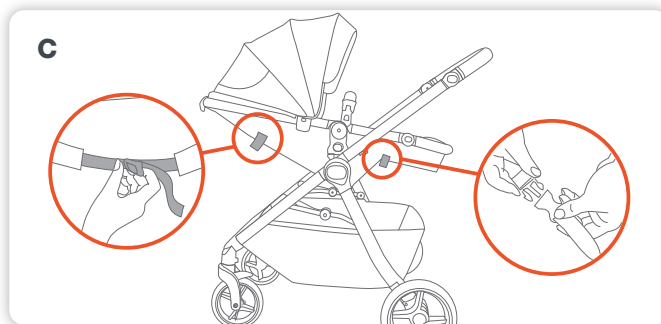

**C** Pull the backrest clip to extend the strap all the way and push down the backrest. Unbuckle the clip under leg rest and push down the leg rest.

# Bassinet

## Fitting the Bassinet Liner

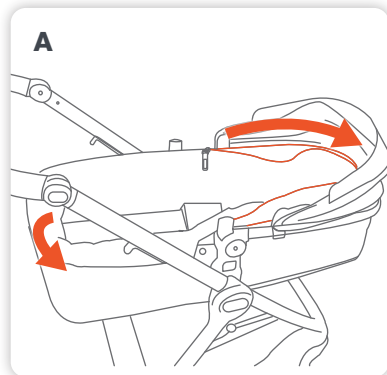

**A** The bassinet must face the stroller handle.

Place bassinet liner over the bassinet and zip the top half of the liner to attach to seat. Pull the bottom half of the bassinet liner over the frame.

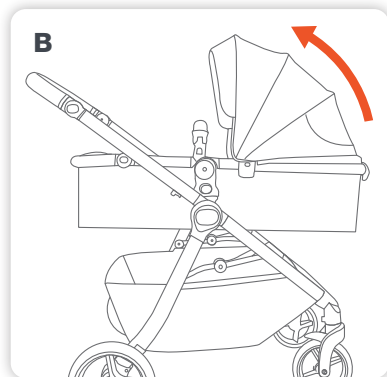

**B** Pull the canopy up for protection. For attaching and using of canopy, please refer to page 16.



# Stroller Operation

## Using the Stroller

PLEASE REFER TO PAGE 6 FOR SMART LIFTING TECHNIQUES.

- **Always ensure you bend your knees where appropriate and take due care when lifting the frame.**
- **With your hand through the wrist tether strap loop, push the stroller holding the handle.**
- **The stroller can be steered in the desired direction - allowing the front wheels to swivel will make this easier.**
- **The front wheels may wobble or oscillate when walking fast, locking the front swivel wheels will stop this.**
- **The stroller can be taken up kerbs by either pressing down on the handles and raising the front wheels or turning the stroller around and pulling the stroller up the kerb.**
- **Caution is required when pushing the stroller on a steep slope as the stroller may become unstable. Always hold the handle firmly.**
- **Do not run with the stroller.**
- **Whenever you stop, always apply the brakes before you leave the stroller.**
- **Do not hang bags or goods unless it is supplied from the handle. Use the storage basket.**

## Stroller Operation

### Folding the Stroller

#### IMPORTANT NOTE:

PLEASE REFER TO PAGE 6 FOR SMART LIFTING TECHNIQUES.

- **Remove the child from the stroller before commencing any folding operation.**
- **Baby capsule, second seat and rain cover MUST be removed prior to folding.**
- **Fold the stroller slowly and be careful where you place your hands.**
- **When folding the stroller, be aware of the danger of being injured by moving parts and locking devices during the process. Keep all hands and limbs clear of these parts.**
- **There is potential for fingers or parts of the body to be injured when the stroller is being folded, due care should be exercised.**
- **Keep children clear during folding the stroller.**
- **Make sure the seat is in upright position before folding if you fold the stroller with seat attached.**

✓ **TIP:** The stroller seat and wheels can be removed to reduce the total folded size.

#### FOLDING TIPS:

**01** For easier handling, it is recommended to remove the stroller seat from the frame (Refer to Page 26) before folding.

Then fold the frame and put both the seat and frame in the car.

**02** For smaller cars it may be convenient to simply remove the rear wheels.

# Stroller Operation

## Folding the Stroller

**A**

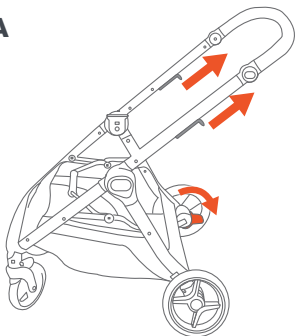

**A** Engage the brake. Pull the latches on the handle tube upwards and drop down the handle all the way.

**B**

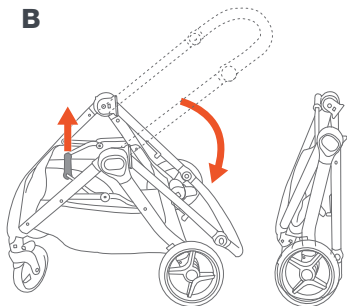

**B** Pull the handle under the stroller seat upwards until you hear a 'click' and the frame is fully folded and the frame lock latch is locked in properly.

## Lifting and Carrying the Stroller

### IMPORTANT NOTE:

PLEASE REFER TO PAGE 6 FOR SMART LIFTING TECHNIQUES.

- To avoid injury: bend you knees when opening, lifting, carrying, folding, unfolding or adjusting the stroller or any accessories.
- To avoid damage, do not place heavy objects on top of the folded stroller.
- Ensure that the storage latch is engaged when lifting or carrying the vehicle.

## Second Seat

Sold Separately

**PLEASE NOTE:** These instructions are for installing and removing the second seat on the stroller only. For proper use of the second seat, please follow the instructions manual provided with the second seat.



### **WARNINGS:**

- SECURE THE CHILD IN THE HARNESS AT ALL TIMES.
- DO NOT USE ANY ACCESSORIES OTHER THAN THOSE APPROVED FOR USE WITH THIS STROLLER BY BRITAX.
- IT IS UNSAFE TO USE ACCESSORIES NOT APPROVED FOR USE WITH THIS STROLLER.
- THE MAXIMUM WEIGHT OF THE CHILD USING THIS SECOND SEAT IS NOT TO EXCEED 15KG.

### **IMPORTANT NOTES:**

- Do not use this second seat with any other models of stroller.
- The second seat must be correctly fitted and locked onto the stroller frame.
- The second seat can only be used in the forward facing position, connected to the rear of the stroller.
- Do not overload the stroller. overloading will cause the stroller to tip backwards.

## Second Seat

Sold Separately

### Attaching the Wheel Guards

**SAFETY WARNING:** Before using the second seat, the wheel guards must be installed:

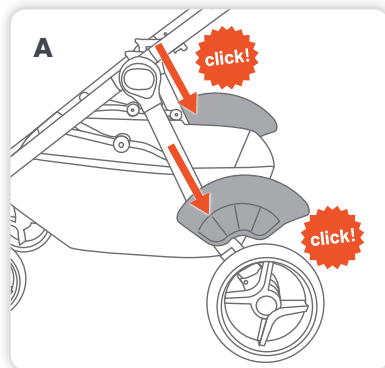

**A** Slide each guard onto the mounting bracket above each rear wheel housing and push down until it locks into place. There is left and right wheel guard. Please ensure it is locked.

### Installing and Removing the Seat Extension Adaptors

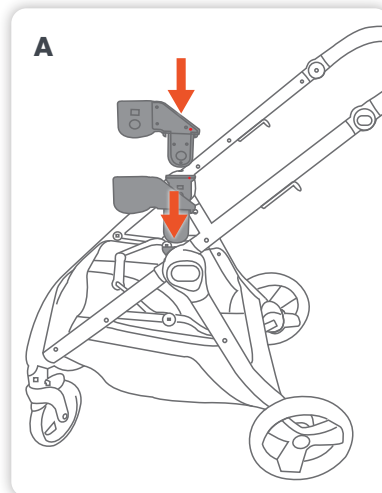

**A** Select the extension adaptor that has a coloured dot and align with the coloured dot on the frame socket. Note: Coloured dots are only on one side of the frame socket. Firmly press down on the Extension adaptor until you hear a 'click' and a green indicator can be seen through a window in the frame socket. Repeat on the other side with the receiver with no coloured dot. To ensure the receiver is engaged pull upwards.

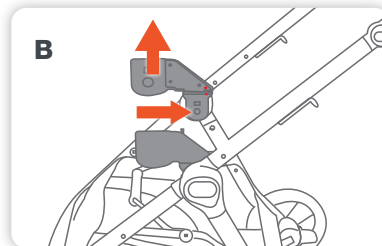

**B** To remove the extension adaptors, press in and hold the button on the inside of the receiver and pull up the extension adaptors out of the frame sockets.

## Second Seat

Sold Separately

### Attaching the Second Seat to the Stroller Frame

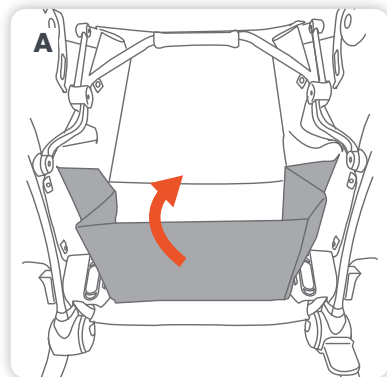

**A** Before attaching the second seat to the stroller frame push down the back of the basket to the base of the basket.

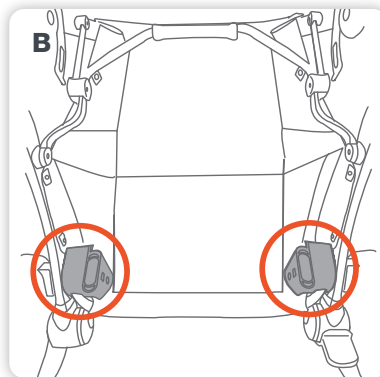

**B** Line up the second seat connectors to the second seat frame socket inside of the stroller frame (located on inside of the rear wheel housing).



**C** Push down the second seat until it locks. Pull up on both sides of the seat to ensure the seat is locked.

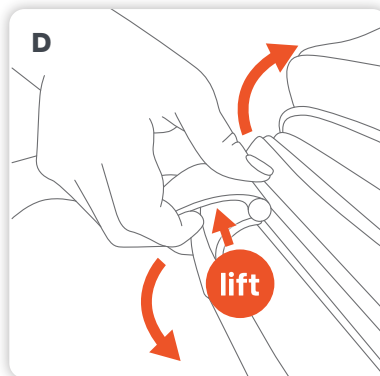

**D** Adjust the backrest to desired position.

## Second Seat

Sold Separately

### Removing the Second Seat from the Stroller Frame

#### IMPORTANT NOTE:

- Always remove your child from the second seat before removing the second seat.
- Always remove the second seat before folding.

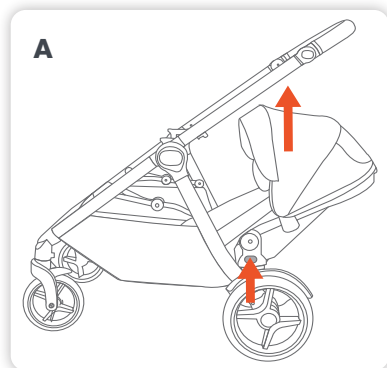

**A** Lift both release levers on the seat connectors at the same time and lift the seat up and away from the stroller frame.

## Baby Capsule

Sold Separately



### **WARNINGS:**

- IT IS UNSAFE TO USE ACCESSORIES NOT APPROVED FOR USE WITH THIS STROLLER
- DO NOT USE ANY ACCESSORIES OTHER THAN THOSE APPROVED FOR USE WITH THIS STROLLER BY BRITAX.
- THE MAXIMUM WEIGHT OF THE CHILD USING THE BRITAX SAFE-N-SOUND UNITY NEOS BABY CAPSULE OR BRITAX SAFE-N-SOUND UNITY BABY CAPSULE ISOFIX COMPATIBLE IS NOT TO EXCEED 12kg.

### **IMPORTANT NOTES:**

- The Britax Safe-n-Sound Unity Neos Baby Capsule or Britax Safe-n-Sound Unity Baby Capsule Isofix compatible are the only compatible baby capsules designed to fit the One 2 stroller, the Unity Baby Capsule to be used with Click & Go™ adaptors.
- Remove the stroller seat or bassinet from the stroller frame before installing the baby capsule.
- The baby capsule must be correctly fitted and locked onto the frame.
- On top seat position the baby capsule must only be used in the rearward facing position (baby facing parent), fitted facing toward the stroller handle.
- On second seat position the baby capsule must only be used in the forward facing position, fitted facing toward the front of the stroller.
- Secure the child using the baby capsule harness at all times.
- Do not leave the child in the baby capsule for extended periods.
- The baby capsule is designed to provide mobility outside of the car but it should not be used instead of an appropriate cot.
- The baby capsule must be removed from the stroller frame or the second seat frame before folding.
- The sun is very strong. Do not leave your child exposed to the sun. The canopy or hood on this product will not give your child total protection from the harmful rays of the sun.



## Baby Capsule

Sold Separately

### Installing & Removing the Click & Go™ Adaptors

#### **WARNINGS:**

**THE ONE 2 CLICK & GO™ ADAPTORS MUST BE ATTACHED TO THE STROLLER FRAME BEFORE INSTALL THE BRITAX SAFE-N-SOUND UNITY NEOS BABY CAPSULE OR THE BRITAX SAFE-N-SOUND UNITY BABY CAPSULE ISOFIX COMPATIBLE.**

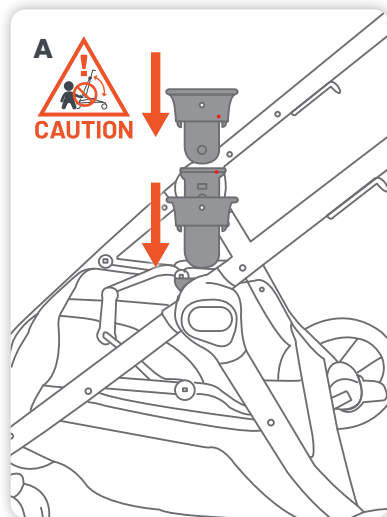

**A** Select the Click & Go™ adaptors that has a coloured dot and align with the coloured dot on the frame socket. Note: Coloured dots are only on one side of the frame socket. Firmly press down on the Click & Go™ adaptors until you hear a 'click' and a green indicator can be seen through a window in the frame socket. Repeat on the other side with the adaptors with no coloured dot. To ensure the adaptors is engaged before placing the baby capsule.

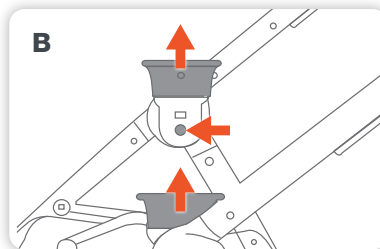

**B** To remove the Click & Go™ adaptors, press in and hold the button on the top of the adaptors and pull up the adaptors out of the frame sockets.

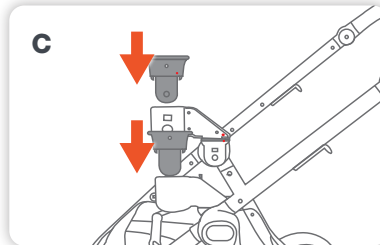

**C** You can use the Click & Go™ adaptors with extension adaptors. Just follow step A.

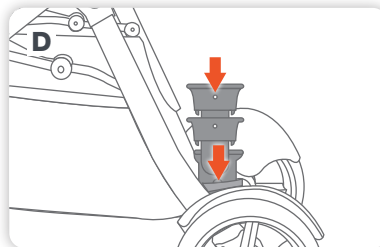

**D** You can use the Click & Go™ adaptors at the Second Seat sockets if you wish to attach Unity baby capsule at the Second Seat position. Just follow step A.

## Baby Capsule

Sold Separately

### Attaching the Britax Unity Baby Capsule

**PLEASE NOTE:** These instructions are for installing and removing the baby capsule on the stroller only. For installing and proper use of the baby capsule in the car, please follow the instructions manual provided with the baby capsule.

Ensure the baby is secured in the baby capsule with the harness at all times. Refer to the baby capsule instruction manual regarding placing and securing your baby in the baby capsule.

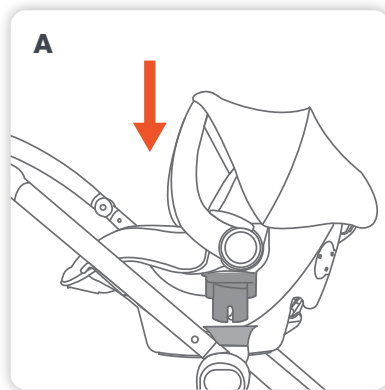

**A** Engage the stroller brake. Align the Unity baby capsule with the Click & Go™ adaptors. The baby capsule must be facing the handle.



**B** Press firmly down on the Click & Go™ adaptors until you hear a 'click'. Pull up the baby capsule to ensure they are locked into the stroller frame.

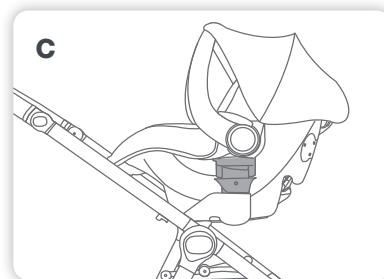

**C** With extension adaptors, the baby capsule fits the same way.

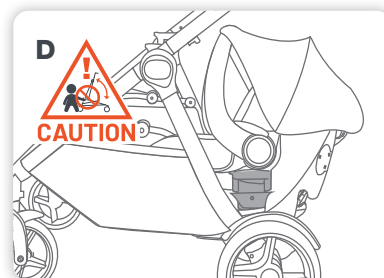

**D** On second seat position, align the Unity baby capsule with the Click & Go™ adaptors. The baby capsule must be facing front of the stroller.

## Baby Capsule

Sold Separately

### Removing the Britax Unity Baby Capsule

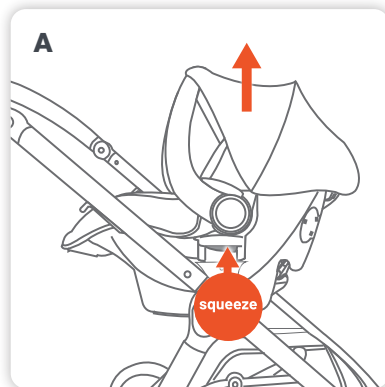

**A** Before removing the baby capsule, lock the stroller brake first.

Squeeze both release levers on the Click & Go™ connectors at the same time and support the weight of the baby capsule. Lift and remove the baby capsule from the stroller frame.

## Baby Capsule

Sold Separately

### Attaching & Removing Britax B-Safe 35 (for NZ market)

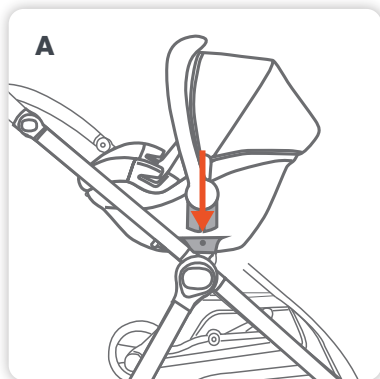

**A** Engage the brake. Align the B Safe capsule with the Click & Go™ adaptors. The baby capsule must be facing the handle.

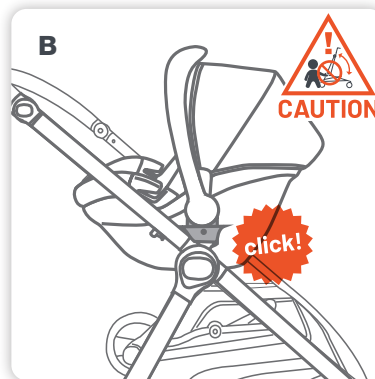

**B** Press firmly down on the Click & Go™ adaptors until you hear a 'click' which indicates the baby capsule has locked into position. Pull up the baby capsule to ensure it is locked into the stroller frame.

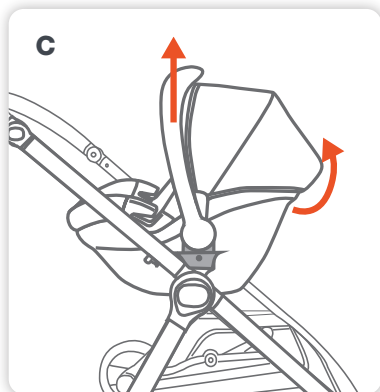

**C** Pull and hold the release lever on the back of the car seat and lift up to remove from the stroller.

**PLEASE NOTE:** These instructions are for installing and removing the baby capsule on the stroller only.

- For installing and proper use of the baby capsule in the car, please follow the instructions manual provided with the baby capsule.
- Ensure the baby is secured in the baby capsule with the harness at all times. Refer to the baby capsule instruction manual regarding placing and securing your baby in the baby capsule.

# Care & Maintenance

## General Maintenance & Repair

- Ensure all safety devices, locks, harness, and brakes are in working order.
- Ensure all joints and folding areas move freely as intended.
- Should any moving or locking parts become stiff or hard to operate, ensure these are free from tension, or dirt by wiping clean with a damp cloth to remove any dirt, sand, or debris. Allow to dry and lightly spray with a dry silicon lubricant. Please carefully read the lubricant instructions prior to use.
- Ensure wheels are regularly cleaned with a damp cloth by removing dirt, sand, or debris. Allow to dry and lightly spray the wheel pivot pin with a dry silicon lubricant to keep the wheels moving smoothly. Please carefully read the lubricant instructions prior to use.
- Regularly spray all moving parts with a dry silicon lubricant. Please carefully read the lubricant instructions prior to use.
- Ensure all connecting rivets and screws are secure. Tighten if required.
- If there are compression marks on the tyres, use a domestic hair dryer to gently warm (DO NOT OVERHEAT) the tyre and the compression marks should slowly disappear.
- To maintain the safety and longevity of the stroller, seek prompt repairs or replacement for bent, torn, worn, or broken parts. Do not continue to use the stroller if unsafe.

- All repairs should only be carried out by an authorised Britax/Steelcraft repairer. Only Britax/Steelcraft replacement parts should be used with the stroller. It may be unsafe to use parts supplied from another manufacturer.

### General Tips

**Do not store the stroller in your car** for prolonged periods of time during summer as it may lead to damage to some of the plastics components.

**Do not leave the stroller in direct sunlight** for extended periods of time, as colours of some fabrics may fade, and tyres may deteriorate.

**Do not fold or store the stroller if damp or wet**, as fabric may develop mould or mildew. Always store the stroller inside in a dry, well-ventilated area.

**Do not place heavy objects on top of the stroller** as it may alter the shape.

Should you have any further questions on care & maintenance of the stroller, please contact our Consumer Service Team at: [au-support@britax.com](mailto:au-support@britax.com)

# Care & Maintenance

## Cleaning

### Fabrics

- Removable fabrics may be cleaned using lukewarm water and soap or mild detergent. Rinse thoroughly and allow to dry away from direct sunlight.
- Non-removable fabrics can be spot cleaned using a damp sponge and soap or mild detergent. Allow to dry completely before re-use or storage.
- Never use bleach, or abrasive cleaning products.
- **DO NOT** iron or dry clean.

**NOTE:** **DO NOT** place any of the stroller fabrics in the dryer. Allow to dry naturally, away from direct sunlight.

### Frame

- Remove dirt and dust away from any moving mechanism.
- Clean frame with a soft damp cloth and soap or mild detergent and allow to dry thoroughly.
- **DO NOT** use abrasive cleaning products as it may cause stains, discolouration or scratches to the frame.
- **DO NOT** soak or submerge frame in water.
- **DO NOT** remove, dismantle or alter any part of the stroller mechanism or brakes.

### Leatherette

- Spot clean with a damp soft cloth.
- **DO NOT** use a dripping wet cloth or wet the leatherette excessively.

### Wheels

- Remove wheels from stroller.
- Clean with damp cloth and soap or mild detergent. Use brush to remove dirt and mud build up around the tyre. Allow to dry thoroughly before placing wheels back on the frame.
- If necessary lubricate wheel shaft with a small amount of lubricant before placing into the stroller.
- Ensure the stroller is cleaned thoroughly after using it on the beach as sand and salt can damage stroller mechanism, wheel assembly, causing premature wear and corrosion.

### PLEASE NOTE:

Our product warranty does not cover any rust to the rivets or screws, if you are caught in the rain or at the beach always thoroughly dry the frame to avoid any rust damage.

## Care & Maintenance

Just like servicing your car or bicycle, prams and strollers also need **regular maintenance checks**. These checks can improve product performance, extend the life of your stroller and help to provide you and your children a safe and smooth journey.



We recommend servicing your stroller every 6 months and completing an inspection once a month. To prolong the life of your stroller, a regular maintenance should be performed.

### 5 STEP CHECK LIST

- 01 INSPECT SAFETY DEVICES** tether strap, frame lock, harness, buckle and brakes, and ensure all are in working order and free from dirt, sand, and debris.
- 02 INSPECT** all connecting rivets and screws are secure.
- 03 MAKE SURE FOLDING JOINTS** are free of dirt, dust, and debris by cleaning with a damp cloth, allow to dry and lightly spray with a dry silicon lubricant. Please carefully read the lubricant instructions prior to use.
- 04 REMOVE WHEELS** and wipe clean with a damp cloth to remove any dirt, sand or debris. Allow to dry and lightly spray the wheel pivot pin with a dry silicon lubricant to keep the wheels moving smoothly. Please carefully read the lubricant instructions prior to use.
- 05 ENSURE WHEN FOLDING AND STORING** to wipe down your stroller frame and allow to dry before storing in a dry place without direct sunlight.

# Warranty

## Did you know?

Registering your product online simplifies proof of purchase in the event of a warranty claim.

Head to our website to fill out the product registration form: **[britax.com.au](http://britax.com.au)**



## Making A Warranty Claim

Your rights under a **Britax** company warranty are separate from and independent of your rights under the statutory consumer guarantees. What you need to do to enforce your rights under a statutory consumer guarantee is set out in the **Australian Competition and Consumer Commission's Consumer Guarantees - A Guide for Consumers**.

To make a claim under a **Britax** company warranty, please contact our customer service team on:

**Australia:** 1300 303 330 / **New Zealand:** 0508 688 822 *or alternatively by email at:*

**Australia:** [au-support@britax.com](mailto:au-support@britax.com) / **New Zealand:** [nzoffice@britax.com](mailto:nzoffice@britax.com)

### You will be required to :

- Return the product to the place of purchase or to a designated repair agent;
- Present your receipt as proof of purchase;
- Identify the defect in the product; and
- Present the product to **Britax** for inspection on request.

**Britax** will advise you whether the product is covered by the **Britax** company warranty. **Britax's** decision of whether a product is covered by a **Britax** company warranty is final. **Britax** will act reasonably when determining whether a product is covered by a company warranty.



# Warranty

## Australian Consumer Law

On all of our goods, you have the benefit of a statutory consumer guarantee. In summary, goods are guaranteed to be of “acceptable quality” (fit for purpose), goods are guaranteed to match any sample against which they are sold. These consumer guarantees are provided for by the Australian Consumer Law and, if you believe any one of these guarantees is not satisfied by a Britax product, you have rights under the Australian Consumer law to enforce that guarantee.

Your rights under the statutory consumer guarantees are set out in the **Australian Competition and Consumer Commission’s Consumer Guarantees – A Guide for Consumers**.

In addition to the statutory consumer guarantees, **Britax** offers its own company warranty on all of its products. You therefore have the option of seeking redress for defective or faulty product either under the **Britax** company warranty or the statutory guarantees.

After the **Britax** company warranty expires, you still have your rights under the statutory consumer guarantees.

Depending on the product involved, the **Britax** company warranty on the following page applies:

# Warranty

## Steelcraft Warranty

**Steelcraft** products are covered by this company warranty against faulty materials and workmanship (normal wear and tear excluded) that affects the normal operation of your **Steelcraft** product. In the unlikely event that you find that your **Steelcraft** product does not satisfy this warranty, **Britax** will (at its option) repair or replace that product within a reasonable period of you making a claim in accordance with this policy.

In the event that a replacement product is no longer available, **Britax** reserves the right to provide what it considers to be a suitable alternative.

For this company warranty to apply, you must make an application before the expiration of the following periods from date of purchase\*.



2 years on **Steelcraft** strollers and **Steelcraft** stroller accessories.\*

This company warranty does not apply to second hand or after market goods or goods used for rental, hire or other commercial purposes or to any claim where the damage or fault is, in whole or part, the result of incorrect installation, mistreatment, intentional damage, any use other than use in normal conditions or any use otherwise than in accordance with the instruction manual for that product.

Please read your instruction manual carefully before using any of our products.

### INTERNATIONAL WARRANTY

**Britax** products are available through a network of retailers in Australia and New Zealand. If you are an international customer we do not offer a warranty service outside of these regions.

**THIS PRODUCT IS NOT INTENDED FOR COMMERCIAL USE**





Art No. 4002322\_B

## **Britax Childcare Pty. Ltd.**

A.B.N. 55 006 773 600

Level 4, 650 Lorimer Street, Port Melbourne, Victoria 3207, Australia

**Phone:** (03) 9288 7288 **Fax:** (03) 9311 5798

## **Customer Service**

**Australia:** 1300 303 330 / **New Zealand:** 0508 688 822

Due to our continuing program of development, Britax reserves the right to alter the specifications, color or design without any further notice.

The **Steelcraft** trademark is the property of Britax Childcare Pty.Ltd - Australia.

The **Britax** trademark is the property of Britax Childcare Holdings Limited - UK.

Visit the **Britax** website at: [www.britax.com.au](http://www.britax.com.au) or email us at [au-support@britax.com](mailto:au-support@britax.com)

Due to the variations in the style and design of our products the illustrations used in this instruction booklet are generic.

This product is designed to comply with Australian and New Zealand standard **AS/NZS 2088:2013** "Prams and Strollers - Safety Requirements"

Copyright © 2021 Britax Childcare Pty. Ltd. Australia