

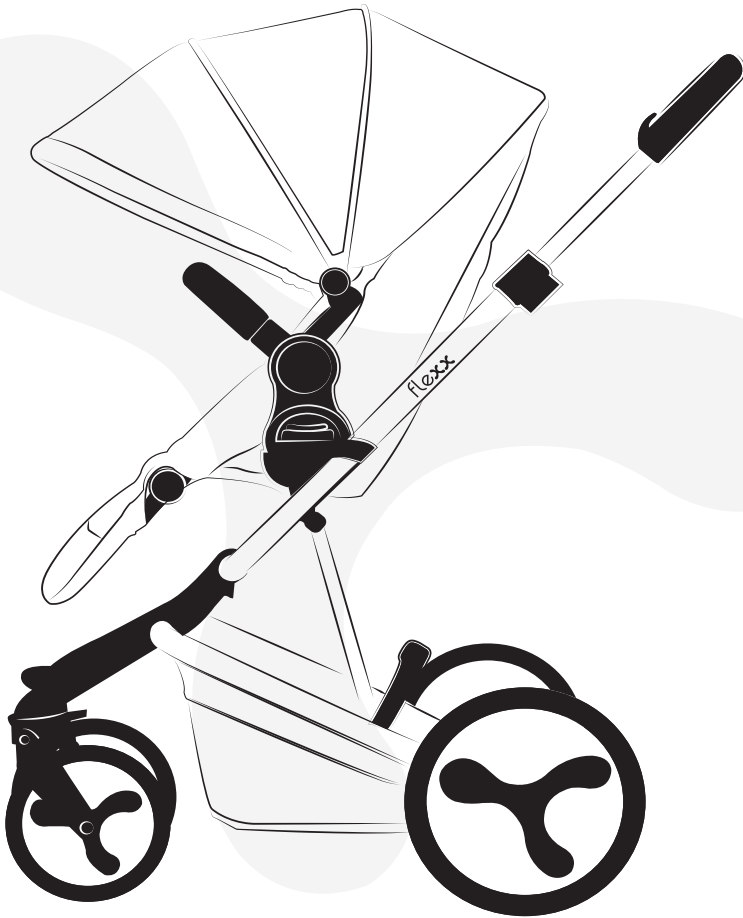

FlexxTM

Travel System Stroller

Instruction Manual



Note: Second Seat, Bassinet, Britax Safe N Sound Unity Neos Baby Capsule or Britax Safe N Sound Unity Baby Capsule ISOFIX compatible are all sold separately.

IMPORTANT: KEEP THIS BOOKLET IN A SAFE PLACE FOR FUTURE REFERENCE.

Series No. S3401

CONTENTS

STROLLER SECTION

Stroller Warnings & Important Notes.....	05
Manual Handling Techniques.....	07
Stroller Parts List.....	08
Single Stroller Configurations.....	11
Tandem Configurations.....	12

STROLLER ASSEMBLY

Opening the stroller frame.....	13
Installing & removing the single stroller axle.....	14
Installing the front wheels.....	15
Removing the front wheels.....	15
Installing the rear wheels.....	16
Removing the rear wheels.....	16
Attaching the storage basket.....	17
Attaching the stroller seat.....	18
Removing the stroller seat.....	19
Attaching the canopy.....	20
Removing the canopy.....	22
Attaching the arm bar.....	22
Removing the arm bar.....	23
Attaching the shoulder harness pads.....	24
Attaching the boot cover.....	24
Attaching the rain cover.....	25

STROLLER OPERATION

Using the brakes.....	25
Using the front wheel swivel lock.....	27
Adjusting the handle height.....	27
Adjusting the leg rest.....	28
Adjusting the backrest.....	29
Securing your child in the harness.....	30
Adjusting the harness.....	31
Opening the harness.....	32
Adjusting the shoulder harness height.....	32
Using the tether strap.....	33

CONTENTS

STROLLER OPERATION

Using the stroller.....34

Folding the stroller..... 35

Lifting and carrying the stroller.....37

TANDEM PACK SECTION

Second Seat Warnings & Important Notes.....39

Tandem Pack Parts List..... 40

TANDEM PACK ASSEMBLY

Installing and removing the tandem axle..... 41

Attaching the storage basket..... 42

Attaching the second seat to the tandem axle.....43

Removing the second seat from the tandem axle..... 44

Installing and removing the height adaptors..... 45

BASSINET SECTION

Bassinet Warnings & Important Notes.....47

Bassinet Parts List..... 48

BASSINET ASSEMBLY

Assembling the bassinet.....48

BASSINET OPERATION

Attaching the bassinet to the stroller frame..... 49

Attaching the boot cover..... 51

Removing the bassinet from the stroller frame..... 51

Adjusting the canopy..... 52

Attaching the bassinet to the tandem axle.....53

Removing the bassinet from the tandem axle.....53

BABY CAPSULE SECTION

Baby capsule Warnings & Important Notes..... 55

BABY CAPSULE OPERATION

Installing and removing the Baby capsule adaptors..... 57

Attaching the Unity Click & Go Baby capsule to the stroller frame..... 58

CONTENTS

BABY CAPSULE OPERATION
Removing the Unity Click & Go Baby capsule from the stroller frame.....59

CARE AND MAINTENANCE60

NOTES61

WARNINGS

ALWAYS FOLLOW THE MANUFACTURERS INSTRUCTIONS.

READ ALL INSTRUCTIONS CAREFULLY BEFORE ASSEMBLY AND USE OF THIS STROLLER.

THE CORRECT USE AND MAINTENANCE OF THIS PRODUCT IS ESSENTIAL.

WARNINGS: TO AVOID INJURY OR DEATH:

ALWAYS APPLY THE BRAKES WHENEVER THE STROLLER IS STATIONARY.

- **DO NOT LEAVE CHILDREN UNATTENDED.**
- **SECURE THE CHILD IN THE HARNESS AT ALL TIMES.**
- **DO NOT CARRY EXTRA CHILDREN OR BAGS ON THIS STROLLER.**
- **MAKE SURE CHILDREN ARE CLEAR OF ANY MOVING PARTS IF YOU ADJUST THE STROLLER.**
- **DO NOT USE ANY ACCESSORIES OTHER THAN THOSE APPROVED FOR USE WITH THIS STROLLER BY BRITAX.**
- **IT IS UNSAFE TO USE ACCESSORIES NOT APPROVED FOR USE WITH THIS STROLLER.**
- **THE MAXIMUM WEIGHT OF THE CHILD USING THIS STROLLER IS NOT TO EXCEED 20 KG, 9KG FOR THE BASSINET, 12KG FOR THE SAFE-N-SOUND UNITY NEOS OR SAFE-N-SOUND UNITY BABY CAPSULE ISOFIX COMPATIBLE CLICK & GO BABY CAPSULE OR 17KG FOR THE SECOND SEAT.**

FOR IMPORTANT NOTES AND WARNINGS ON ACCESSORIES - REFER TO THEIR INDIVIDUAL SECTIONS IN THIS BOOK. THE MAXIMUM WEIGHT VARIES FOR EACH ACCESSORY.



CAUTION

This **CAUTION** Symbol is shown at certain steps in this Instruction Manual to highlight the danger of being injured by moving parts.

IMPORTANT NOTES

- **USE GREAT CARE WHEN USING THE STROLLER ON STAIRS, ESCALATORS, TRAVELATORS OR OTHER MOVING SURFACES.**
- **IT IS RECOMMENDED TO REMOVE THE CHILD FROM THE STROLLER BEFORE GOING UP OR DOWN STAIRS OR ESCALATORS.**
- **DO NOT LIFT THE STROLLER BY THE ARM BAR (SUPPLIED) BECAUSE IT MAY DISENGAGE.**
- **DO NOT ALLOW CHILDREN TO STAND ON THE SEAT.**
- **DO NOT HANG BAGS OR GOODS MORE THAN 1.5 KG (TOTAL WEIGHT : BAG AND CONTENTS) FROM THE HANDLE (HOOKS SUPPLIED) AS THIS COULD CAUSE THE STROLLER TO TIP OVER.**
TO PREVENT THE STROLLER FROM TIPPING OVER ENSURE THAT A SEAT, CAPSULE OR BASSINET ARE ENGAGED IN THE TOP POSITION OF THE STROLLER BEFORE PLACING OR REMOVING THE BAG FROM THE HANDLE.
- **DO NOT LEAVE THE STROLLER AND ITS ACCESSORIES NEAR AN OPEN FIRE OR EXPOSED FLAME.**
- **DO NOT PLACE MORE THAN 4 KG IN THE BASKET, OR 1KG IN THE CANOPY POCKET (IF SUPPLIED).**

MANUAL HANDLING TECHNIQUES

The **SMART** lifting technique

This technique can be used to pick up small light loads from low levels.

Size up the Load

- Assess the load (size, shape and weight).
- Assess whether the load needs to be moved;
- Where is it going to be placed” Check that there are no obstructions;
- Assess whether mechanical or human assistance is required.

Move the Load as close to the body as possible

- A load is heavier to lift or carry if it is not close to the body.
- The whole hand should be used to ensure a firm grip.

Always bend your knees

- Maintain balance.
- Keep feet apart and in a comfortable position.
- Minimise lower back bending.
- Bend knees preferable at as large an angle as possible but not at a right angle - use a semi squat in preference to a full squat.

Raise the load with your legs

- Achieve the lift smoothly and without jerkiness.
- Maintain the normal curvature of the spine to allow the force of the load to be distributed evenly from the spine to the pelvis.

Turn your feet in the direction that you want to move the load.

- Avoid unnecessary bending, twisting and reaching.
- Change direction by turning your feet and not your back.
- To set the load down, squat down, keep your head up and let
- Let your legs do the work.

Remember to ‘THINK TALL’ chest lifted, shoulders relaxed, chin tucked in and head level.

PARTS LIST

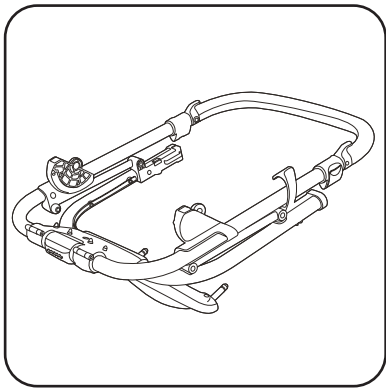

1 x Stroller frame

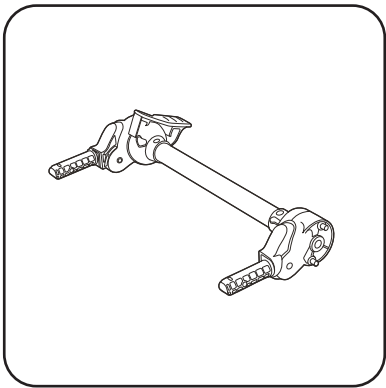

1 x Stroller axle

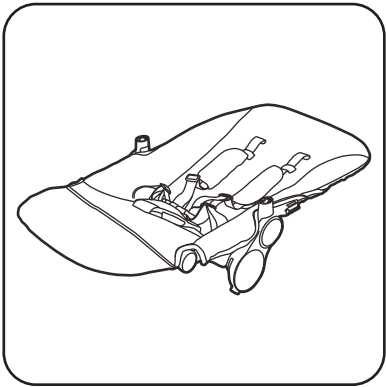

1 x Stroller seat

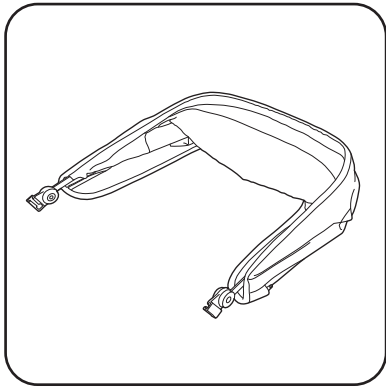

1 x Canopy

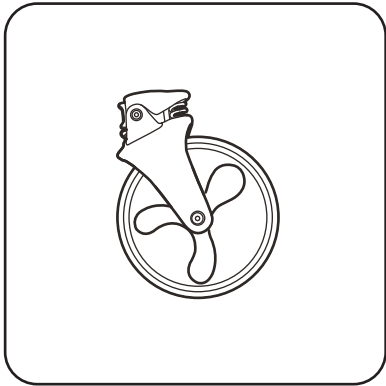

2 x Front wheels

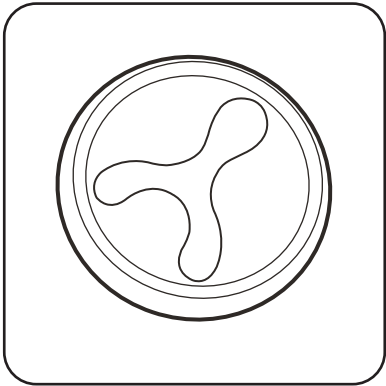

2 x Rear wheels

PARTS LIST

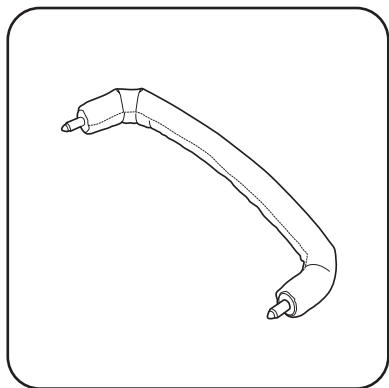

1 x Arm bar

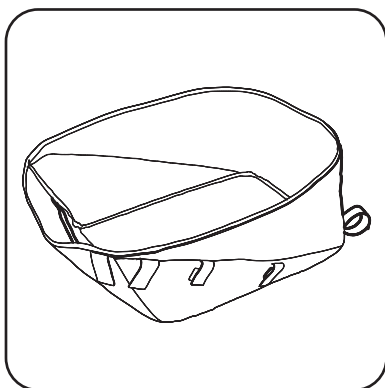

1 x Single Storage basket

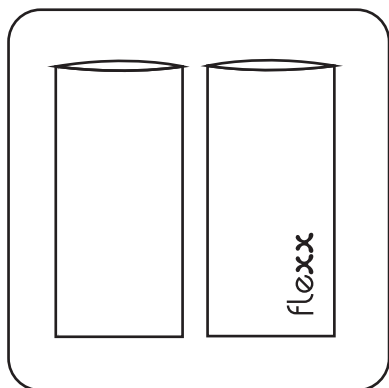

1 x Set of shoulder harness pads



1 x Boot cover



1 x Rain Cover

SINGLE STROLLER CONFIGURATIONS

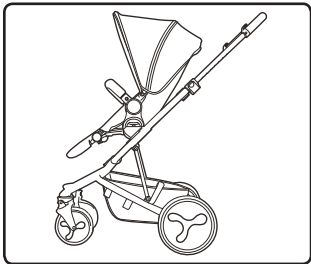

Stroller seat forward-facing

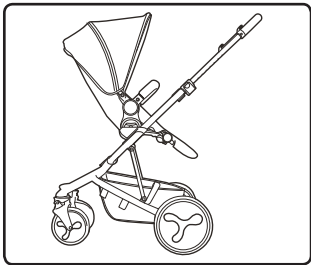

Stroller seat rearward-facing

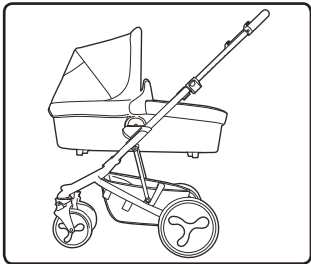

Bassinet rearward-facing

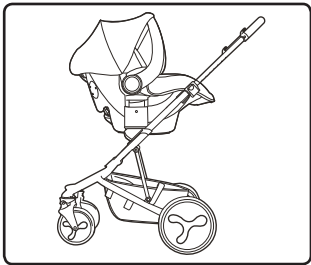

Baby Capsule rearward-facing

TANDEM CONFIGURATIONS



WARNING: DO NOT USE THE FLEXX STROLLER OR FLEXX ACCESSORIES IN ANY TANDEM CONFIGURATION NOT SPECIFIED IN THIS INSTRUCTION MANUAL.

IMPORTANT NOTE:

HEIGHT ADAPTORS ARE SUPPLIED WITH THE TANDEM PACK.
THE HEIGHT ADAPTORS ARE USED TO CREATE MORE SPACE BETWEEN THE UPPER & LOWER POSITIONS (IF REQUIRED) OF THE STROLLER.
DO NOT USE THE HEIGHT ADAPTORS IN SINGLE STROLLER MODE.

PLEASE NOTE: Shown with optional Accessories (**sold separately**).

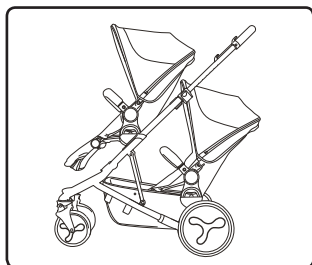

The stroller seat and second seat can be used in all 4 recline positions.

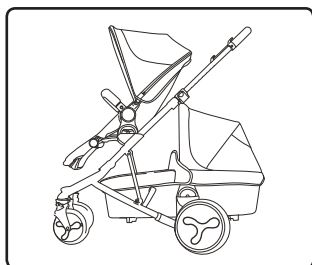

The stroller seat can be used in all 4 recline positions. The canopy on the bassinet will need to be adjusted to accommodate the lower recline positions of the stroller seat.

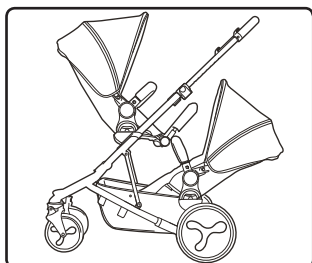

The stroller seat and second seat can be used in all 4 recline positions. The leg rest on the stroller seat will need to be adjusted to allow for the recline position of the second seat.

TANDEM CONFIGURATIONS

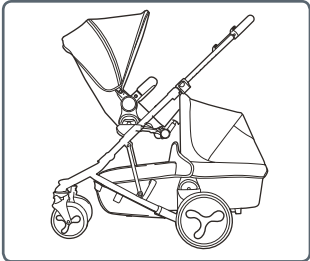

The stroller seat can be used in all 4 recline positions. The leg rest on the stroller seat will need to be adjusted to accommodate the bassinet. The canopy on the bassinet will need to be adjusted to allow for the recline positions of the stroller seat.

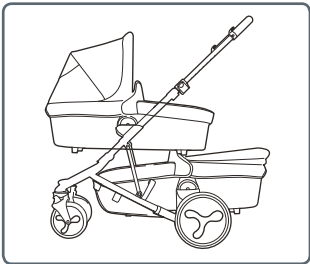

Please Note: The bassinet in the lower position cannot have the canopy fully extended.

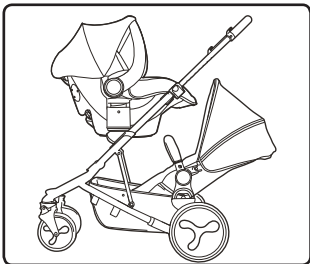
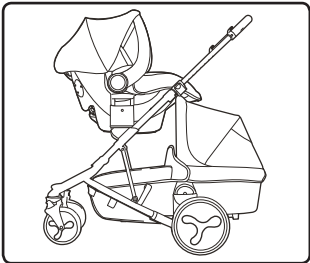

The second seat can be used in all 4 recline positions.

STROLLER ASSEMBLY

IMPORTANT NOTES:

PLEASE REFER TO PAGE 7 FOR SMART LIFTING TECHNIQUES.

- RELEASE THE STORAGE LATCH WITH DUE CARE AND OPEN THE FRAME.
- WHEN OPENING THE STROLLER, BE AWARE OF THE DANGER OF BEING INJURED BY MOVING PARTS AND LOCKING DEVICES DURING THE PROCESS. KEEP ALL HANDS AND LIMBS CLEAR OF THESE PARTS.
- THERE IS POTENTIAL FOR FINGERS OR PARTS OF THE BODY TO BE INJURED WHEN THE STROLLER IS BEING UNFOLDED, DUE CARE SHOULD BE EXERCISED.
- KEEP CHILDREN CLEAR OF THE STROLLER WHEN UNFOLDING THE STROLLER FRAME.
- OPEN THE STROLLER SLOWLY AND BE CAREFUL WHERE YOU PLACE YOUR HANDS. KEEPING YOUR HANDS ON THE HANDLE IS THE BEST WAY TO UNFOLD THE STROLLER.

OPENING THE STROLLER FRAME

A Release the frame lock (1) and open the frame (2).

B Lift the handle as shown by the arrow until you hear a clicking sound which indicates the frame is fully opened and locked.

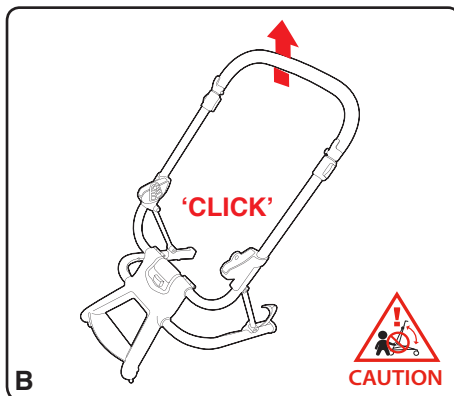
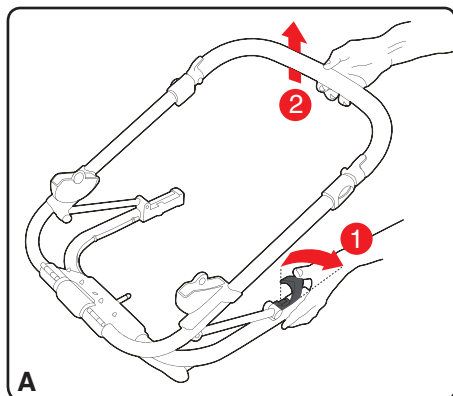

STROLLER ASSEMBLY

INSTALLING AND REMOVING THE STROLLER AXLE

- A** Slide both sides of the axle into the axle attachment housings on the stroller frame until you hear a 'click'. Pull on the axle to ensure it is locked into position.

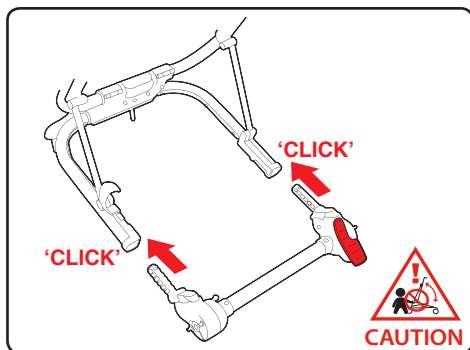

- B** To remove the axle, press down on the axle release buttons (left and right) **(1)** and pull the axle away from the stroller frame **(2)**.

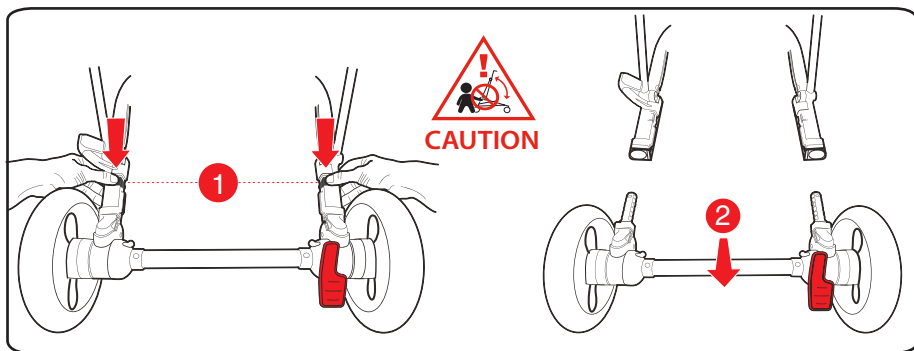

STROLLER ASSEMBLY

INSTALLING THE FRONT WHEELS

- A** Slide each front wheel mounting pin into the housings on the frame until you hear a 'click' which indicates they have locked into place.
- B** Pull on both front wheels to ensure they are locked into the frame housings.

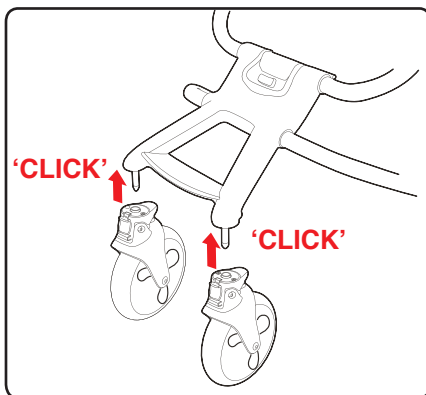

REMOVING THE FRONT WHEELS

- A** Press and hold the release button on the front of the wheel housing (1) and pull each wheel out of the housing (2).

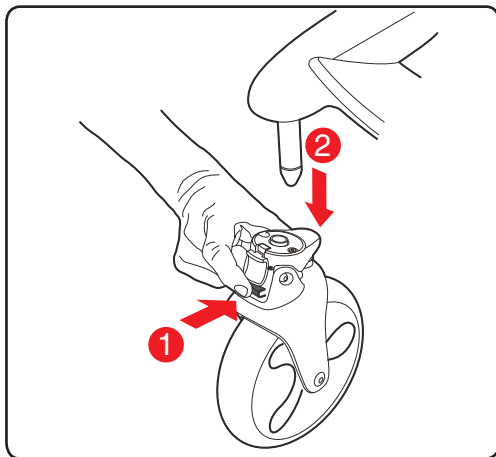

STROLLER ASSEMBLY

INSTALLING THE REAR WHEELS

- A** Slide the rear wheel axle into the rear wheel housing and push in until you hear a 'click' which indicates the wheel is locked into place.
- B** Pull on both rear wheels to ensure they are locked into the frame housings.

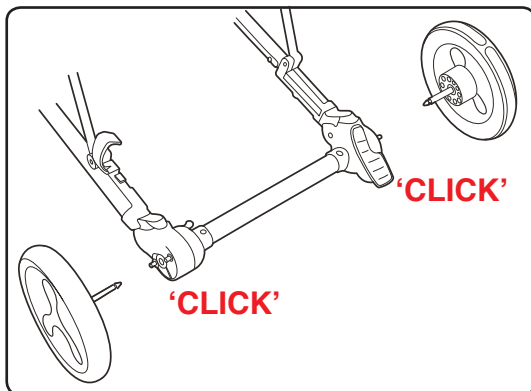

REMOVING THE REAR WHEELS

- A** Locate the rear wheel release button found on the brake bar (1). Hold the button down and pull the rear wheel out of the wheel housing (2).

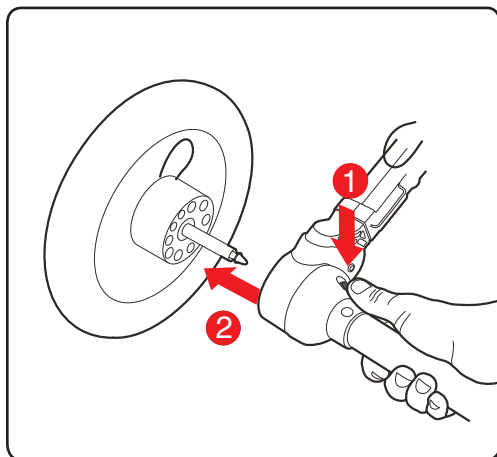

STROLLER ASSEMBLY

ATTACHING THE STORAGE BASKET

- A** Position the storage basket into the area under the seat. Slide the hook tabs at the front of the basket (**No. 1**) behind the metal bar and attach to the loop tabs on the basket to secure. Slide the hook tabs on the side of the basket (**No's. 2 & 3**) behind the metal bar and attach to the loop tabs on the basket to secure. Slide the hook tab (**No. 4**) through the brackets on the inside of the frame and attach to the loop tabs on the basket to secure.

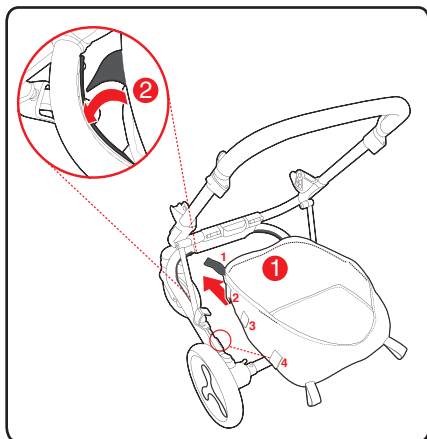

- B** Wrap the hook tabs on the rear of the storage basket around the axle and attach to the loop tab to secure.

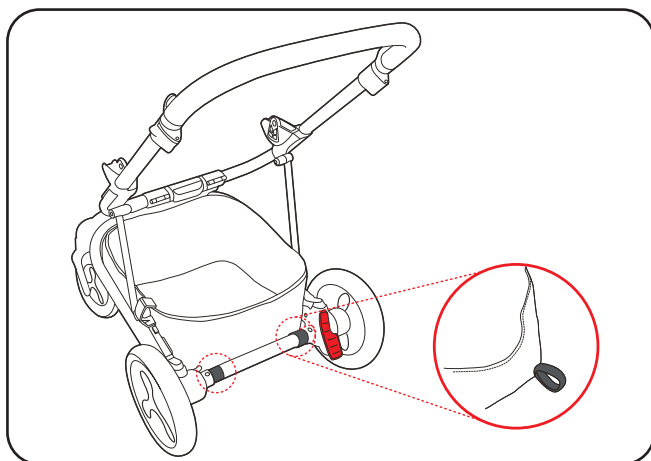

STROLLER ASSEMBLY

ATTACHING THE STROLLER SEAT

IMPORTANT NOTE:

ALWAYS REMOVE YOUR CHILD FROM THE STROLLER SEAT BEFORE INSTALLING, REMOVING OR CHANGING THE SEAT DIRECTION.

PLEASE NOTE: The seat is reversible so it can be attached to the frame in the forward facing position or the rearward facing position when used alone in the upper position on the stroller frame.

- A** Press down on the lower section of the brake pedal to engage the brake. Insert the seat connectors on the seat unit into the housings on the stroller frame.
- B** Push down on the seat until a 'click' is heard which indicates the seat connectors have locked into the housings. Pull up on both sides of the seat to ensure that it is locked into place correctly.

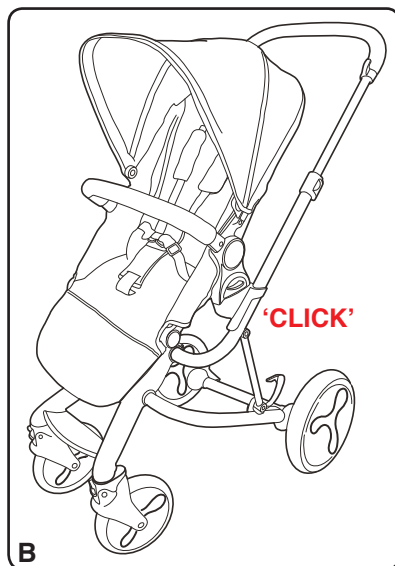
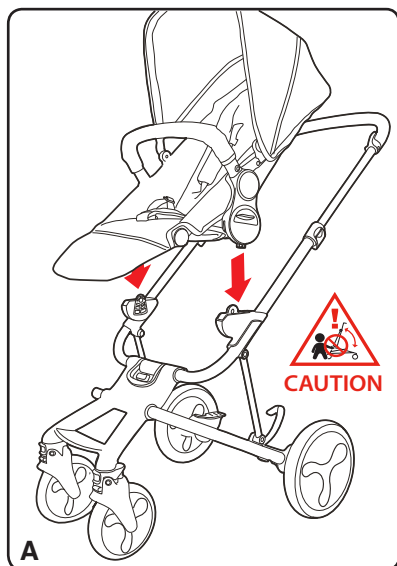

STROLLER ASSEMBLY

REMOVING THE STROLLER SEAT

IMPORTANT NOTE:

ALWAYS REMOVE YOUR CHILD FROM THE STROLLER SEAT BEFORE INSTALLING, REMOVING OR CHANGING THE SEAT DIRECTION.

- A** Lift both release levers on the seat connectors at the same time to release the seat from the housings on the stroller frame.
- B** Lift the seat up and away from the stroller frame.

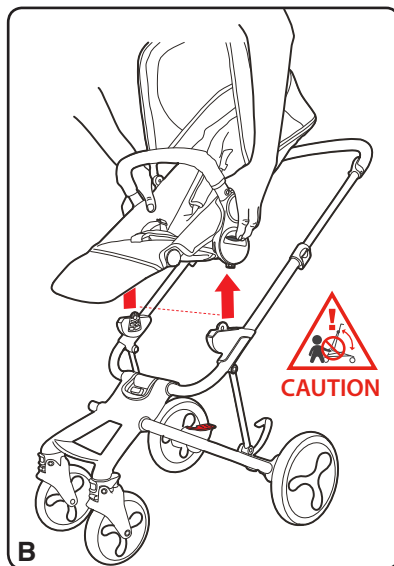
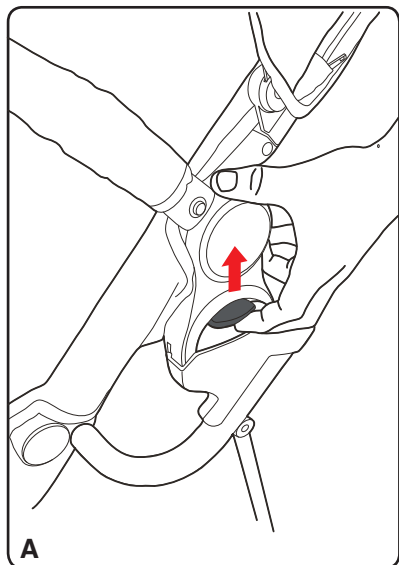

STROLLER ASSEMBLY

ATTACHING THE CANOPY

IMPORTANT NOTE:

The sun is very strong. **DO NOT LEAVE YOUR CHILD EXPOSED TO THE SUN.** The canopy or hood on this product will not give your child total protection from the harmful rays of the sun.

- A** Slide the canopy runners on each side of the canopy into the canopy attachments located on either side of the seat frame.
- B** Attach the canopy to the seat with the zipper to secure the canopy to the seat frame.
- C** To adjust the canopy, open the canopy by pulling forward or close by pushing the canopy backward.

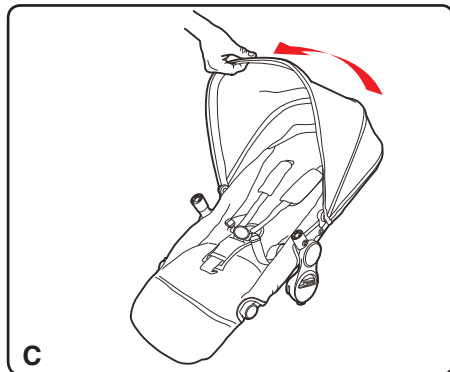
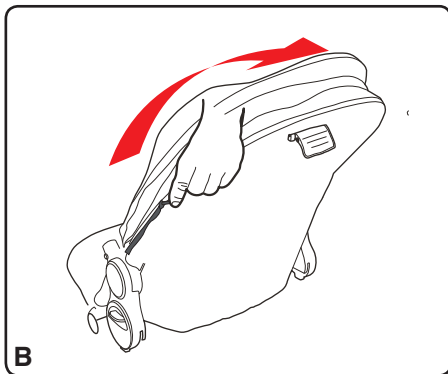
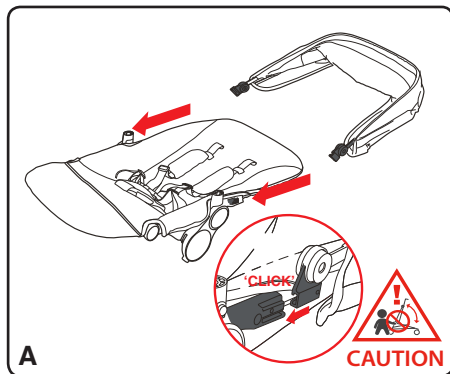

STROLLER ASSEMBLY

ATTACHING THE CANOPY

- D** To expose the mesh section of the canopy, fully unzip the centre section of the canopy and fold the fabric panel in the centre section over the front section of the canopy.
- E** For extra protection from the sun, pull the sun visor out from under the front of the canopy.
- F** To cover the mesh section of the canopy, pull the fabric panel back over the mesh.

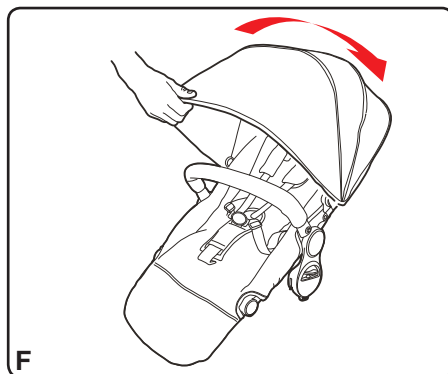
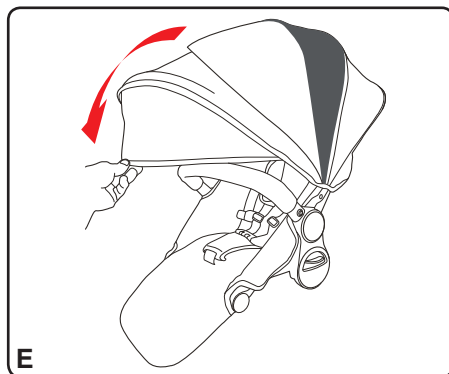
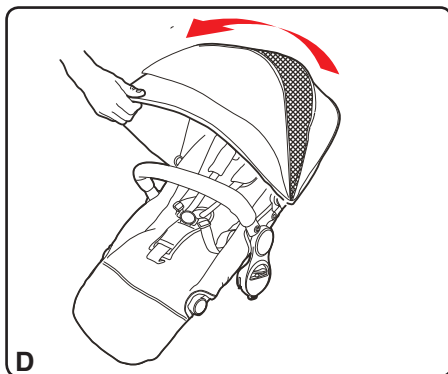
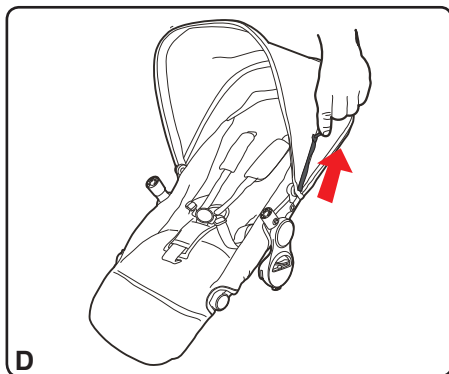

STROLLER ASSEMBLY

REMOVING THE CANOPY

- A** Fully unzip the canopy from the seat.
- B** Slide the canopy runners out of the canopy attachments located on either side of the seat frame.

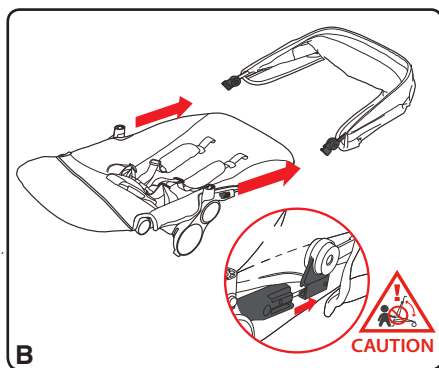
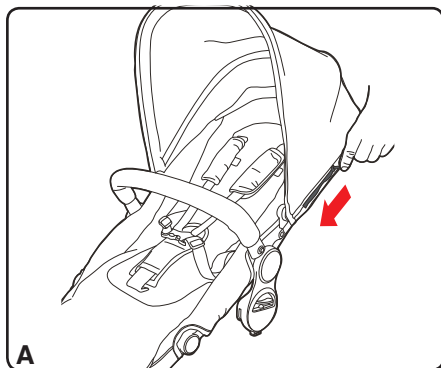

ATTACHING THE ARM BAR

IMPORTANT NOTE:

WHEN A CHILD IS IN THE STROLLER, KEEP THE ARM BAR ATTACHED TO THE STROLLER SEAT At ALL TIMES.

- A** Align the pins on each side of the arm bar with the sockets on the seat and slide the arm bar pins into the sockets until a 'click' is heard which indicates the pins have locked in.
- B** Pull up on the arm bar to ensure that it is locked into place correctly.

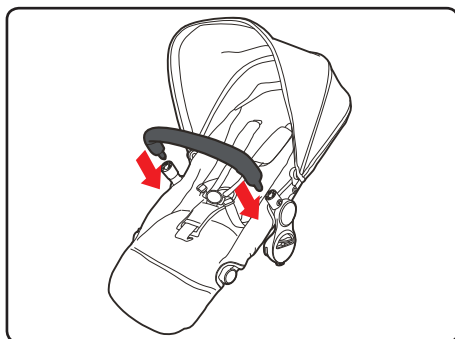

STROLLER ASSEMBLY

REMOVING THE ARM BAR

IMPORTANT NOTE:

THE ARM BAR CAN BE OPENED FROM EITHER SIDE OF THE SEAT WITH OUT REMOVING IT FROM THE STROLLER SEAT.

- A** Press the release buttons in on the side of the arm bar socket on both sides of the stroller seat and pull the arm bar out of the sockets to remove.

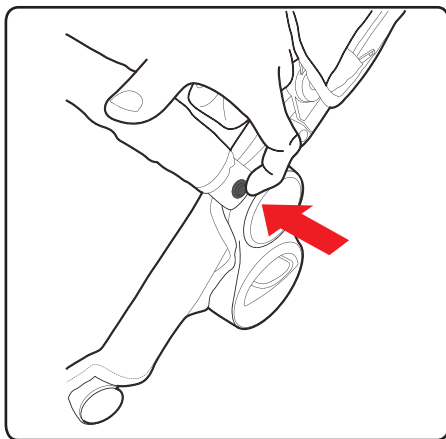

- B** To assist with putting a child in the stroller you can release the arm bar on one side. Press the release button in on the side the arm bar socket and pull the arm bar forward. Rotate the arm bar clear of the stroller. Reattach the arm bar after fastening the child in the harness.

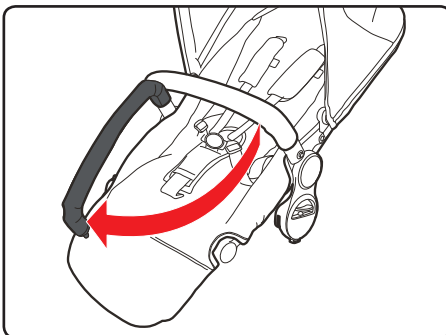

STROLLER ASSEMBLY

ATTACHING THE SHOULDER HARNESS PADS

IMPORTANT NOTE:

ENSURE THAT THE SHOULDER STRAPS ARE FITTED THROUGH THE APPROPRIATE HARNESS SLOTS TO SUIT YOUR CHILD'S SEATED SHOULDER HEIGHT.

- A** Release the harness buckles (Refer to Page 32) and slide the shoulder harness pads onto the shoulder harness straps.

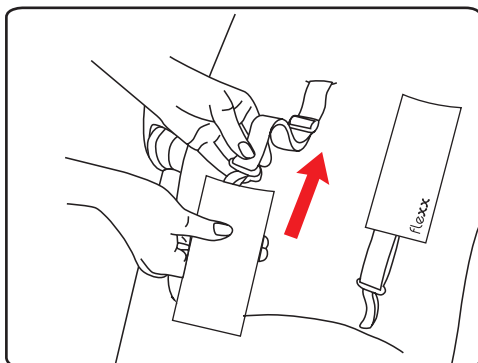

ATTACHING THE BOOT COVER

- A** Place the bottom of the boot cover over the leg rest.
- B** Pull the top section of the boot cover under the arm bar and the fold it over the top of the arm bar.
- C** Connect the hidden magnets to secure the boot cover in place.

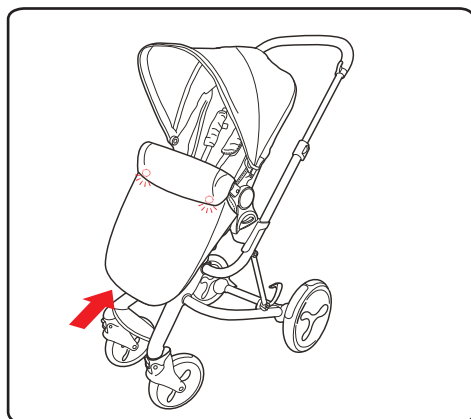

STROLLER ASSEMBLY

ATTACHING THE RAIN COVER

IMPORTANT NOTE:

**ENSURE THE RAIN COVER IS KEPT AWAY FROM THE CHILD'S FACE.
REFIT THE RAIN COVER IF REQUIRED TO ENSURE YOUR CHILD IS SAFE.**

- A** Place the rain cover over the canopy.
Pull the front elastic section of the rain cover over the stroller leg rest.
Ensure the rain cover fits snugly over the canopy and is securely fitted to the stroller seat.
- B** Attach the rain cover together at the back of the leg support using the press studs on the tabs.

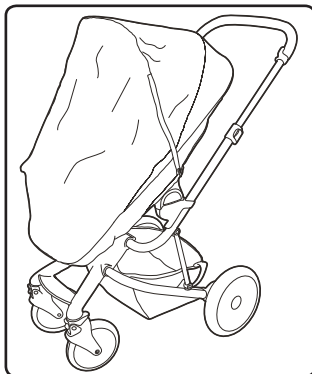

USING THE BRAKES

 **WARNINGS:** ALWAYS APPLY THE BRAKES WHEN THE STROLLER IS STATIONERY.

PLEASE NOTE: Pressing down on the brake pedal locks both rear wheels.

- A** Press down on the lower section of the brake pedal to engage the parking brake.

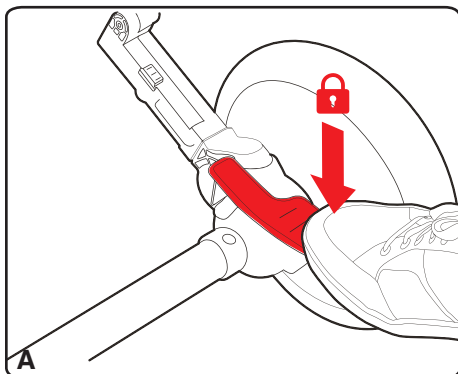

STROLLER OPERATION

USING THE BRAKES

- B** When the stroller is being used in single stroller mode, press down on the upper section of the brake pedal to disengage the parking brake.

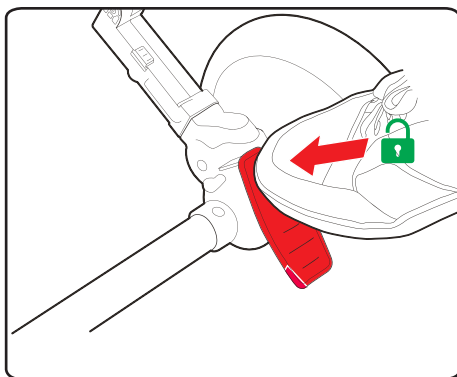

- C** When the stroller is being used in tandem mode (e.g. using the second seat or bassinet in the lower position on the stroller), lift the lower section of the brake pedal with your foot to disengage the parking brake.

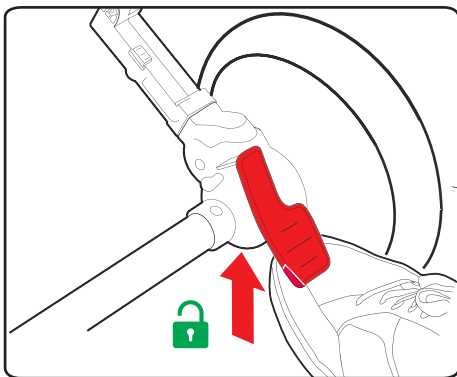

STROLLER OPERATION

USING THE FRONT WHEEL SWIVEL LOCK

PLEASE NOTE: Always lock the swivel wheels when using the stroller on rough surfaces as it will minimise wheel wobble.

You may need to swivel the wheels to the proper position to engage the swivel lock.

- A** Locate the swivel lock slider on the front of the wheel. Push the swivel lock slider down to allow the wheels to swivel.
- B** Push the swivel lock slider up to lock the wheels.

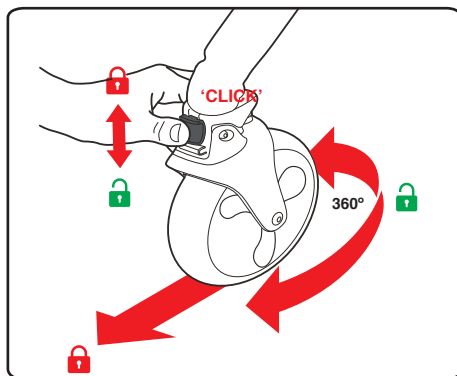

ADJUSTING THE HANDLE HEIGHT

PLEASE NOTE: There are 11 handle height settings.

- A** Release the handle by unlocking the handle height adjustment locks on both sides of the handle. Adjust the handle to the required height and lock the handle height adjustment locks on both sides of the handle.

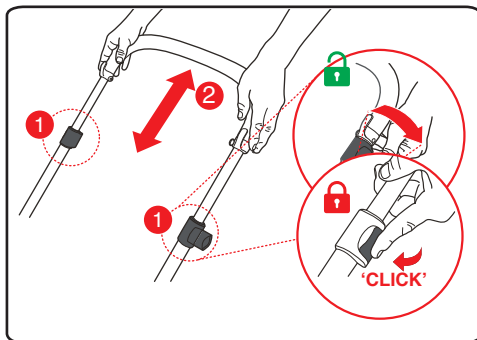

STROLLER OPERATION

ADJUSTING THE LEG REST

IMPORTANT NOTE:

- THE LEG REST FEATURE IS PROVIDED FOR YOUR CHILD'S COMFORT.
- THE LEG REST IS NOT DESIGNED TO SUPPORT EXTRA WEIGHT.
- DO NOT ALLOW CHILDREN TO STAND OR SIT ON THE LEG REST. IT WILL DISENGAGE IF EXTRA WEIGHT IS APPLIED.
- IF LEG REST DISENGAGES SIMPLY LIFT UP AGAIN TO RESET LEG REST MODE.

PLEASE NOTE: There are 3 leg rest positions.

- A** Pull the leg support up to raise to the desired height.

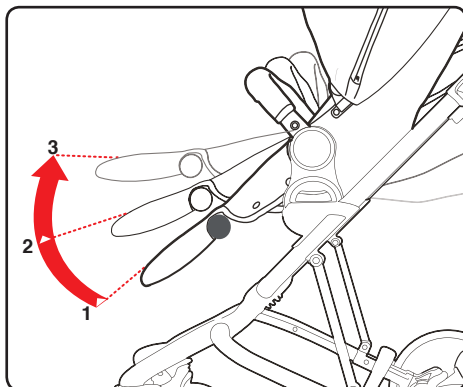

- B** Depress the release buttons on both sides of the leg rest hinge (1) and hold while lowering the leg rest (2) to the desired position.

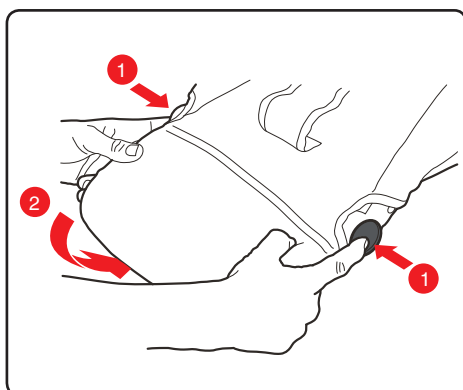

STROLLER OPERATION

ADJUSTING THE BACKREST



WARNINGS:

- THE UPRIGHT POSITIONS ARE NOT SUITABLE FOR USE WITH CHILDREN LESS THAN 6 MONTHS OLD.
- THE LOWEST RECLINE POSITION SHOULD BE USED TO TRANSPORT BABIES. THE BACKREST CAN BE ADJUSTED TO A MORE UPRIGHT POSITION AS THE CHILD GROWS OLDER AND IS ABLE TO SUPPORT ITS HEAD WITHOUT ASSISTANCE.

PLEASE NOTE: There are 4 backrest recline positions.

A Lift the recline lever located at the back of the seat and hold while raising or lowering the backrest to the desired position. The seat will lock into position when the recline lever is released

PLEASE NOTE: If the child is sitting in the seat, support the backrest as it reclines. If you have difficulty adjusting the backrest you may need to remove the child from the seat to allow you to raise or lower the backrest with ease.

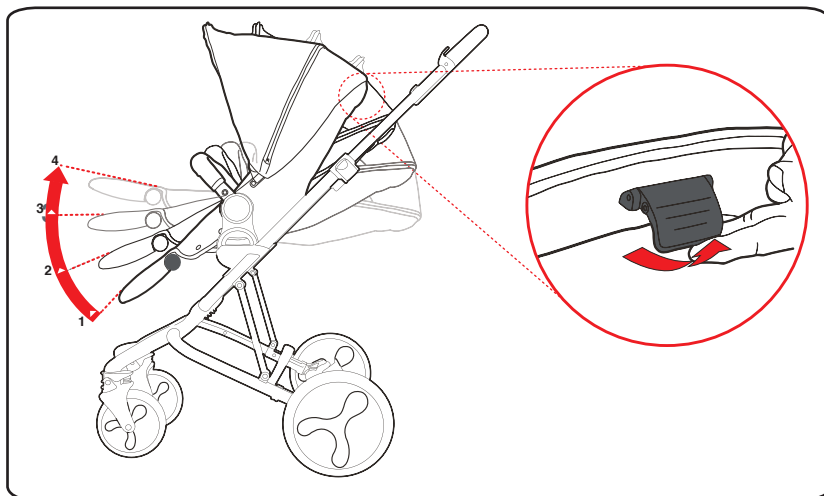

STROLLER OPERATION

SECURING YOUR CHILD IN THE HARNESS

⚠ WARNING: USE THE HARNESS AT ALL TIMES.

- ENSURE YOUR CHILD IS SECURED WITH A CORRECTLY ADJUSTED HARNESS.
 - THE ADJUSTED HARNESS SHOULD CLOSELY FIT THE CHILD.
 - NEVER LEAVE THE HARNESS BUCKLED WHEN NOT FITTED TO A CHILD IN THE STROLLER, BECAUSE THE HARNESS CAN FORM LOOPS WHICH MAY POSE A STRANGULATION HAZARD.
 - WHEN HARNESS IS NOT IN USE, DISCONNECT SHOULDER STRAPS FROM THE WAIST STRAPS AND BUCKLE TO PREVENT STRANGULATION.
-
- A five point harness is provided to restrain your child.
 - Buckle tongues separate for added safety.
 - To reconnect buckle tongues and to secure the child in the harness please follow the steps below carefully.

PLEASE NOTE: Each waist buckle tongue has a raised rib on one side and can only be locked into the buckle assembly with the raised rib facing up. Ensure the harness straps are not twisted as they may become uncomfortable for the child.

- A** Always apply the brakes.
Place child in stroller seat.
Position the shoulder strap near the child's shoulder.
Position crotch strap between legs.
Thread the waist strap buckle tongues through the shoulder straps tongue guides.

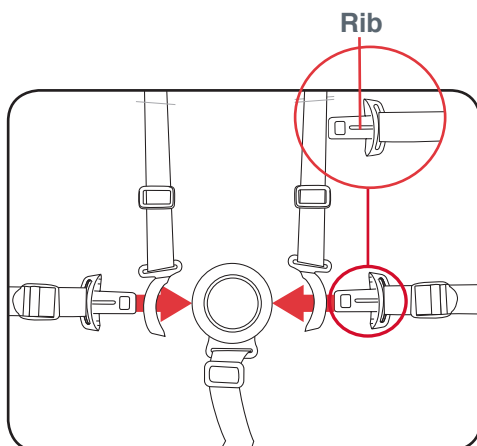

STROLLER OPERATION

SECURING YOUR CHILD IN THE HARNESS

- B** Hold the centre button in on the crotch buckle and insert the waist buckle tongues into the crotch strap buckle until you hear a 'click'.
- C** Repeat the procedure on the other side.

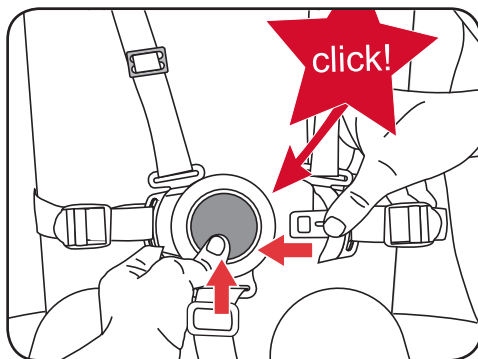
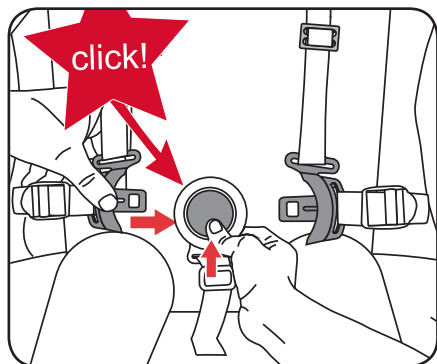

IMPORTANT: Pull on each waist buckle tongue to make sure they are locked into the crotch buckle assembly. If not, repeat above procedure.

ADJUSTING THE HARNESS

 **CAUTION:** DO NOT SLIDE 3 BAR SLIDER OVER THE SEWN TAB ON SHOULDER HARNESS.

- A** Tighten or loosen the shoulder straps and crotch strap by sliding the 3 bar harness adjuster up or down. The crotch strap should be adjusted to a snug fit.
- B** Tighten or loosen the waist straps, hold and lift the 4 bar harness adjuster and pull the harness strap to adjust to the desired fit. The waist strap needs to fit firmly around the child.

STROLLER OPERATION

OPENING THE HARNESS

- A** Release the harness by pressing the centre button in on the crotch buckle while pulling the waist tongues out of the crotch buckle.

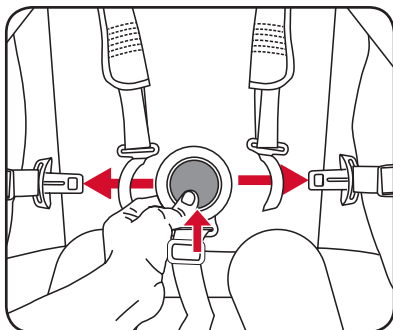

ADJUSTING THE SHOULDER HARNESS HEIGHT

IMPORTANT NOTE:

THE HARNESS CAN BE ADJUSTED TO THREE DIFFERENT HEIGHTS TO ACCOMMODATE THE CHILD. THE SHOULDER STRAPS MUST BE POSITIONED NEAR THE CHILD'S SHOULDERS.

- A** To change the shoulder harness height, push the shoulder harness tongue out of the current harness slot and through the back of the seat. Select the appropriate shoulder harness height and pull each shoulder harness tongue through the harness slot.

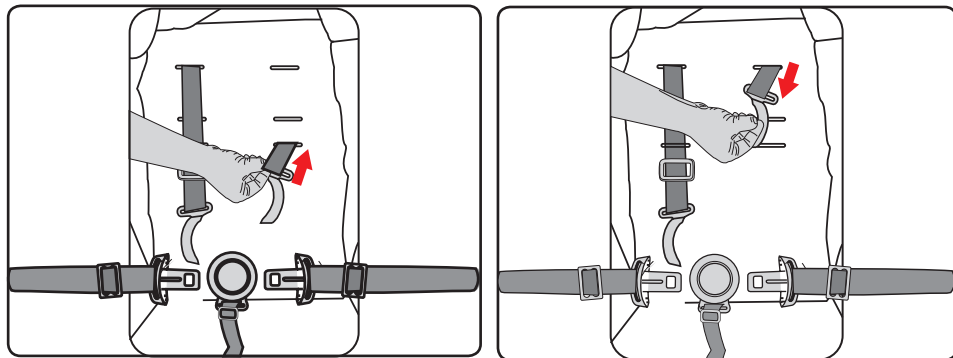

STROLLER OPERATION

USING THE TETHER STRAP

⚠ WARNINGS: USE THE TETHER STRAP TO STOP THE STROLLER ROLLING AWAY.

- THE STROLLER IS DESIGNED FOR USE ON FLAT OR GENTLY SLOPING SURFACES, AND MAY BE UNSTABLE ON HIGHER SLOPING AND UNEVEN SURFACES AND USERS SHOULD BE AWARE OF THE POSSIBILITY OF THE STROLLER ROLLING AWAY OR TIPPING OVER.
- NEVER LET GO OF THE STROLLER WHEN PARKED ON AN INCLINE OR SLOPING SURFACE BECAUSE IT MAY SLIDE OR TIP OVER. ALWAYS PARK ON A FLAT SURFACE AND APPLY THE BRAKES.
- ALWAYS APPLY THE BRAKES WHENEVER THE STROLLER IS STATIONARY.

A A wrist tether strap is provided on the handle grip. Slide your hand through the tether strap loop whenever you use the stroller. Only remove your hand from the tether strap loop when the brakes have been applied to the stroller wheels.

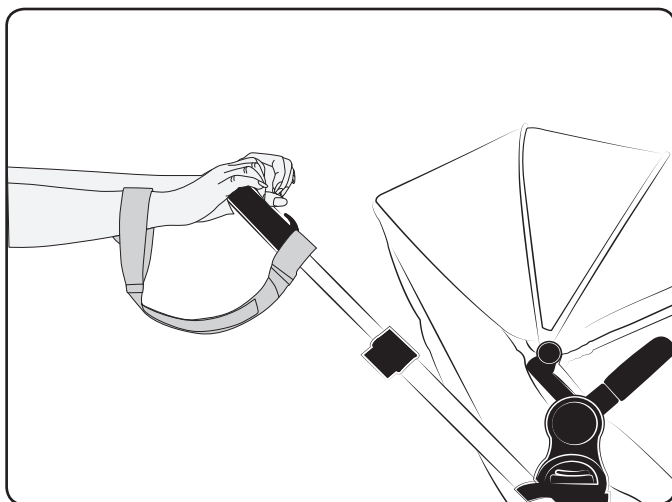

STROLLER OPERATION

USING THE STROLLER

PLEASE REFER TO PAGE 7 FOR LIFTING TECHNIQUES.

- Always ensure you bend your knees where appropriate and take due care when lifting the frame.
- With your hand through the wrist tether strap loop, push the stroller holding the handle.
- The stroller can be steered in the desired direction - allowing the front wheels to swivel will make this easier.
- The front wheels may wobble or oscillate when walking fast. Locking the front swivel wheels will stop this.
- The stroller can be taken up kerbs by either pressing down on the handles and raising the front wheels or turning the stroller around and pulling the stroller up the kerb.
- Caution is required when pushing the stroller on a steep slope as the stroller may become unstable. Always hold the handles firmly.
- Do not run with the stroller.
- Whenever you stop, always apply the brakes before you leave the stroller.
- Do not hang bags or goods more than 1.5 kg (total weight : bag and contents) from the handle (hooks supplied) as this could cause the stroller to tip over. To prevent the stroller from tipping over ensure that a seat, capsule or bassinet are engaged in the top position of the stroller before placing or removing the bag from the handle. For heavier load, use the storage basket.

STROLLER OPERATION

FOLDING THE STROLLER

PLEASE REFER TO PAGE 7 FOR LIFTING TECHNIQUES.

- **REMOVE THE CHILD FROM THE STROLLER BEFORE COMMENCING ANY FOLDING OPERATION.**
- **FOLD THE STROLLER SLOWLY AND BE CAREFUL WHERE YOU PLACE YOUR HANDS.**
- **WHEN FOLDING THE STROLLER, BE AWARE OF THE DANGER OF BEING INJURED BY MOVING PARTS AND LOCKING DEVICES DURING THE PROCESS. KEEP ALL HANDS AND LIMBS CLEAR OF THESE PARTS.**
- **THERE IS POTENTIAL FOR FINGERS OR PARTS OF THE BODY TO BE INJURED WHEN THE STROLLER IS BEING FOLDED, DUE CARE SHOULD BE EXERCISED.**
- **KEEP CHILDREN CLEAR OF THE STROLLER DURING FOLDING THE STROLLER.**

PLEASE NOTE: It is recommended to remove the stroller seat from the frame before folding for easier handling & a more compact fold.

- A** Remove the child from the stroller.
- B** Close the canopy. (Refer to Page 20)
- C** Lock the brakes. (Refer to Page 25)
- D** Lock the swivel wheels. (Refer to Page 27)
- E** Adjust the leg rest to the lowest position. (Refer to Page 28)
- F** Raise the backrest to the fully upright position. (Refer to Page 29)

STROLLER OPERATION

FOLDING THE STROLLER

- G** To fold the frame when in tandem mode, ensure the handle is extended so that the black triangle markers are clearly visible.

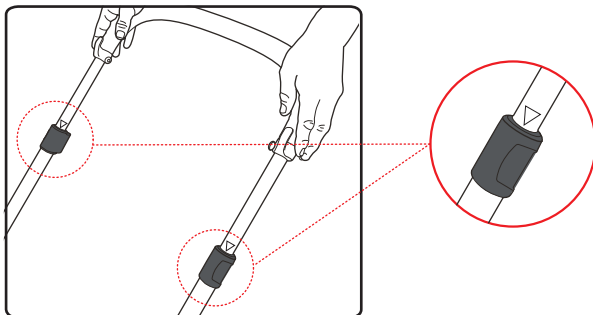

- H** Lift the frame folding handle and push down on the secondary lock button until it is in the position shown.

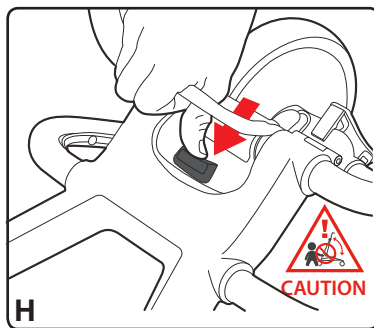
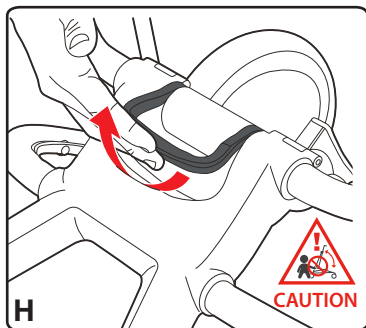

- I** Lift the frame using the frame folding handle (1); the frame will fold (2), allowing you to engage the frame lock.

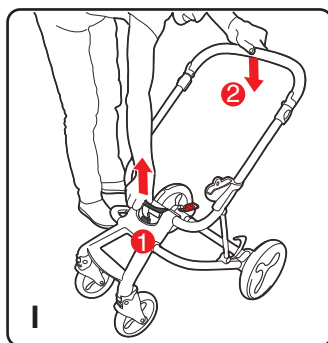

STROLLER OPERATION

LIFTING AND CARRYING THE STROLLER

IMPORTANT NOTES:

PLEASE REFER TO PAGE 7 FOR SMART LIFTING TECHNIQUES.

- **TO AVOID INJURY: BEND YOUR KNEES WHEN OPENING, LIFTING, CARRYING, FOLDING, UNFOLDING OR ADJUSTING THE STROLLER OR ANY ACCESSORIES.**

A Ensure the chassis lock is engaged on the frame before lifting the stroller.
To lift the stroller, grasp the frame halfway along the stroller, so the stroller is balanced.



FlexxTM

Tandem Pack

Includes: Second Seat, Tandem Axle,
Height Adaptors & Rain Cover

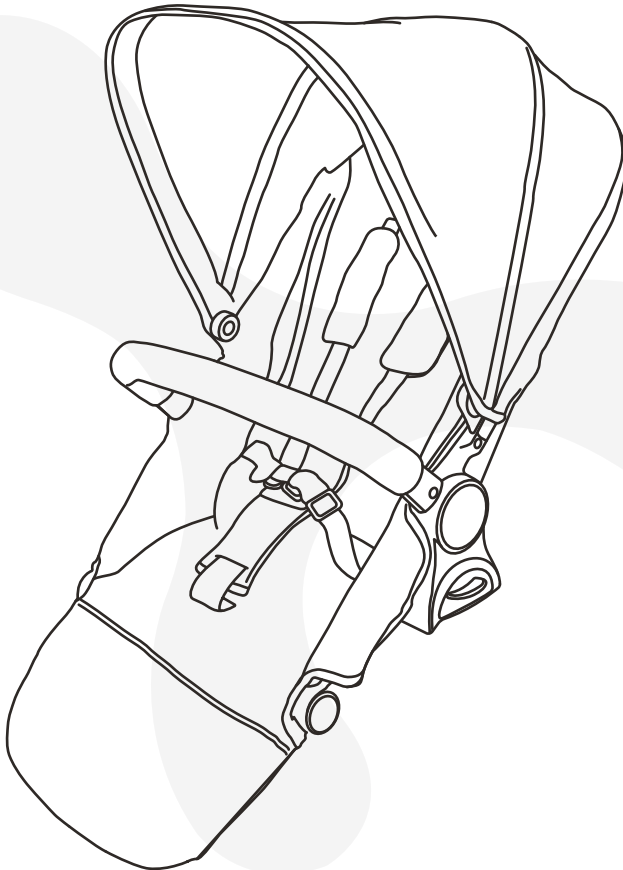

Series No. TP3401

WARNINGS

ALWAYS FOLLOW THE MANUFACTURERS INSTRUCTIONS.

READ ALL INSTRUCTIONS CAREFULLY BEFORE ASSEMBLY AND USE OF THIS STROLLER.

THE CORRECT USE AND MAINTENANCE OF THIS PRODUCT IS ESSENTIAL.

WARNINGS:

- **SECURE THE CHILD IN THE HARNESS AT ALL TIMES.**
- **DO NOT USE ANY ACCESSORIES OTHER THAN THOSE APPROVED FOR USE WITH THIS STROLLER BY BRITAX.**
- **IT IS UNSAFE TO USE ACCESSORIES NOT APPROVED FOR USE WITH THIS STROLLER.**
- **THE MAXIMUM WEIGHT OF THE CHILD USING THIS SECOND SEAT IS NOT TO EXCEED 17KG.**

IMPORTANT NOTES

- **DO NOT USE THIS SECOND SEAT WITH ANY OTHER MODELS OF STROLLER.**
- **THE SECOND SEAT MUST BE CORRECTLY INSTALLED AND LOCKED ONTO THE TANDEM AXLE.**
- **THE SECOND SEAT CAN ONLY BE USED IN THE FORWARD FACING POSITION, CONNECTED TO THE REAR OF THE STROLLER.**
- **DO NOT OVERLOAD THE STROLLER. OVERLOADING WILL CAUSE THE STROLLER TO TIP BACKWARDS.**
- **THE SECOND SEAT MUST BE REMOVED FROM THE FRAME BEFORE FOLDING.**

PARTS LIST

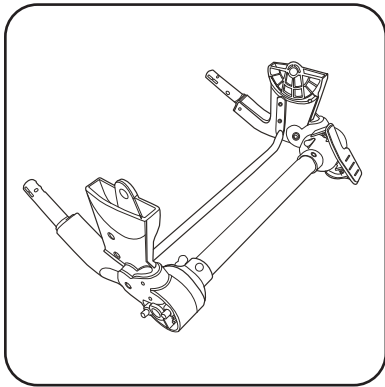

1 x Second seat axle

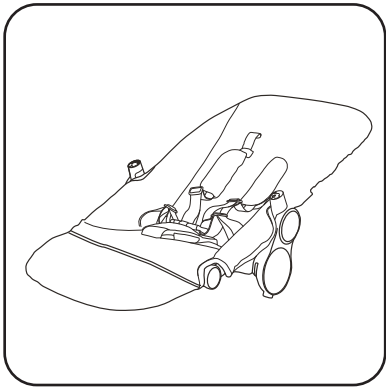

1 x Second seat

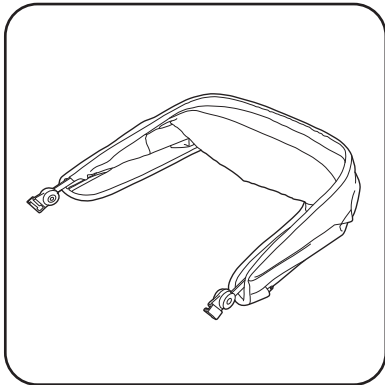

1 x Canopy

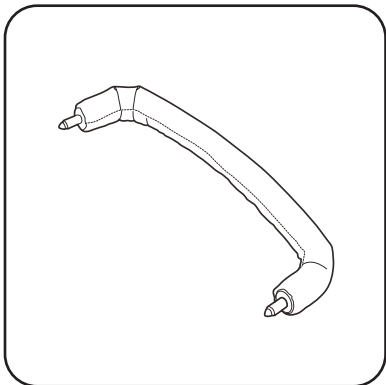

1 x Arm bar

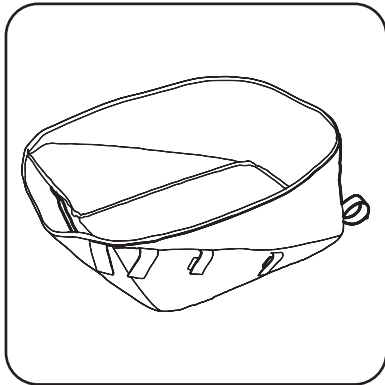

1 x Tandem Storage basket

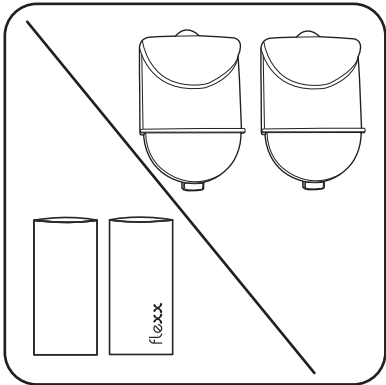

1 x Set of height adaptors
1 x Set of shoulder harness pads

TANDEM PACK ASSEMBLY

INSTALLING AND REMOVING THE TANDEM AXLE

- A** Slide both sides of the axle into the axle attachment housings on the stroller frame until you hear a 'click'. Pull on the axle to ensure it is locked into position

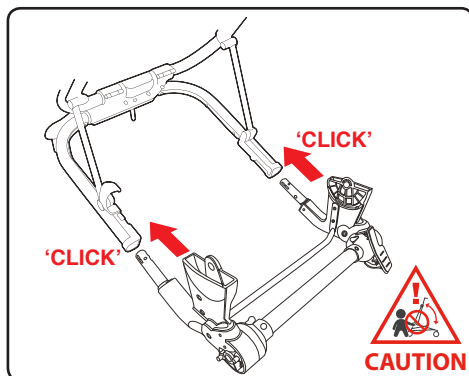

- B** To remove the axle, press down on the axle release buttons (1) located on the left and right hand side and pull the axle away (2) from the stroller frame.

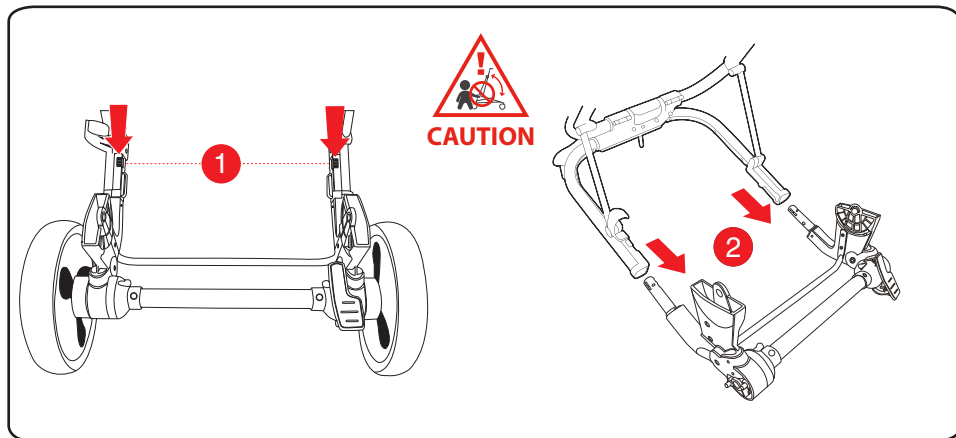

TANDEM PACK ASSEMBLY

ATTACHING THE STORAGE BASKET

- A** When the tandem axle is installed on the stroller, change to the tandem storage basket to fit into the basket area under the seat.

Slide the hook tabs at the front of the basket (**No. 1**) behind the metal bar and attach to the loop tabs on the basket to secure.

Slide the hook tabs on the side of the basket (**No's. 2 & 3**) behind the metal bar and attach to the loop tabs on the basket to secure.

Slide the hook tab (**No. 4**) through the brackets on the inside of the frame and attach to the loop tabs on the basket to secure.

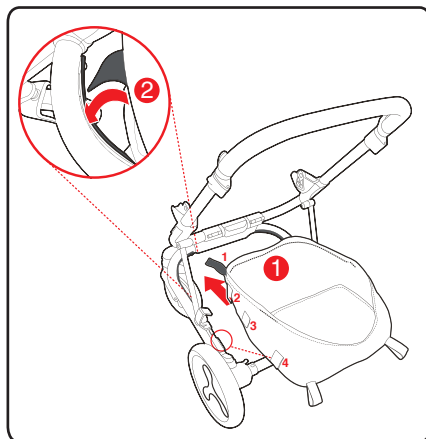
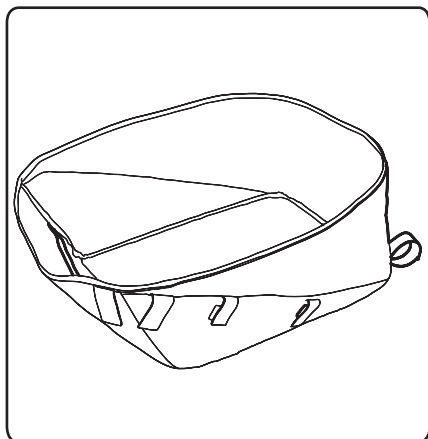

- B** Wrap the hook tabs on the rear of the storage basket around the axle and attach to the loop tab to secure.

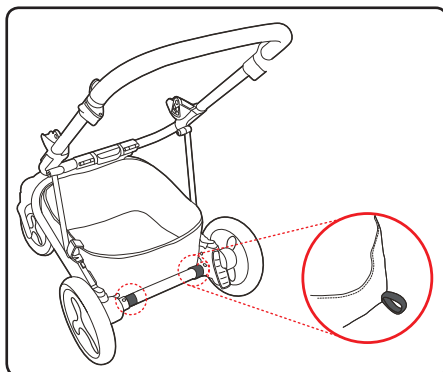

TANDEM PACK ASSEMBLY

ATTACHING THE CANOPY - See Page 20

REMOVING THE CANOPY - See Page 22

ATTACHING THE ARM BAR - See Page 22

REMOVING THE ARM BAR - See Page 23

ATTACHING THE SHOULDER HARNESS PADS - See Page 24

IMPORTANT NOTES:

PLEASE REFER TO PAGE 7 FOR SMART LIFTING TECHNIQUES.

- **WHEN ATTACHING OR REMOVING THE SECOND SEAT, BE AWARE OF THE DANGER OF BEING INJURED BY MOVING PARTS AND LOCKING DEVICES DURING THE PROCESS. KEEP ALL HANDS AND LIMBS CLEAR OF THESE PARTS.**
- **THERE IS POTENTIAL FOR FINGERS OR PARTS OF THE BODY TO BE INJURED WHEN THE STROLLER IS BEING FOLDED OR UNFOLDED, DUE CARE SHOULD BE EXERCISED.**
- **KEEP CHILDREN CLEAR OF THE STROLLER DURING FOLDING OF THE STROLLER.**
- **THE SECOND SEAT CAN ONLY BE USED IN THE FORWARD-FACING POSITION.**

ATTACHING THE SECOND SEAT TO THE TANDEM AXLE

- A** Lower the second seat and insert the connectors into the housings on the axle and push down on the seat until a 'click' is heard which indicates the connectors have locked into the housings.

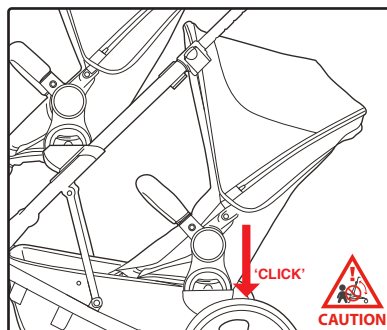

TANDEM PACK ASSEMBLY

REMOVING THE SECOND SEAT FROM THE TANDEM AXLE

IMPORTANT NOTES:

PLEASE REFER TO PAGE 7 FOR SMART LIFTING TECHNIQUES.

- ALWAYS REMOVE YOUR CHILD FROM THE SECOND SEAT BEFORE FOLDING OR REMOVING THE SECOND SEAT.

A Lift both release levers on the seat connectors at the same time to release the seat from the housings on the axle. Lift the seat up and away from the axle.

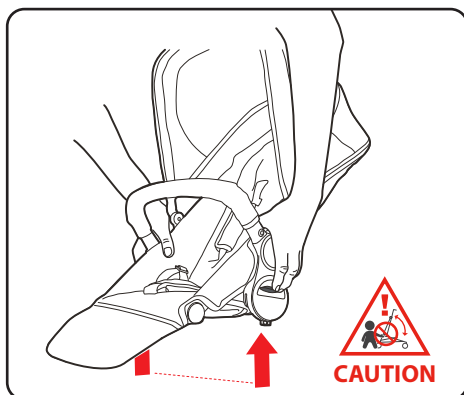
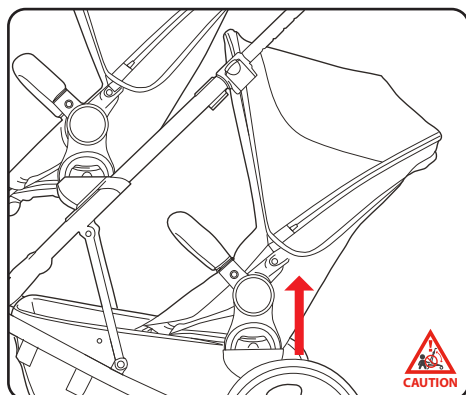

ADJUSTING THE BACKREST - See Page 29

SECURING YOUR CHILD IN THE HARNESS - See Pages 30 & 31

ADJUSTING THE HARNESS - See Page 31

OPENING THE HARNESS - See Page 32

ADJUSTING THE SHOULDER HARNESS HEIGHT - See Page 32

TANDEM PACK ASSEMBLY

INSTALLING AND REMOVING THE HEIGHT ADAPTORS

⚠ WARNING: DO NOT USE THE HEIGHT ADAPTORS (SUPPLIED WITH THE SECOND SEAT) IN SINGLE STROLLER MODE.

IMPORTANT NOTE:

THE HEIGHT ADAPTORS ARE SUPPLIED WITH THE SECOND SEAT.
THE HEIGHT ADAPTORS ARE USED TO CREATE MORE SPACE BETWEEN THE UPPER & LOWER POSITIONS (IF REQUIRED) OF THE STROLLER.

- A** Attach the height adapters to the stroller frame by lining up the connectors with the frame sockets. Press down on the adapters until you hear a 'click' which indicates the adapters have locked into the frame. Pull up on the height adapters to ensure they are locked into the frame sockets.
- B** To remove the adapters, press in and hold the button on the inside of the adaptor and then pull each adaptor up and out of the frame sockets.

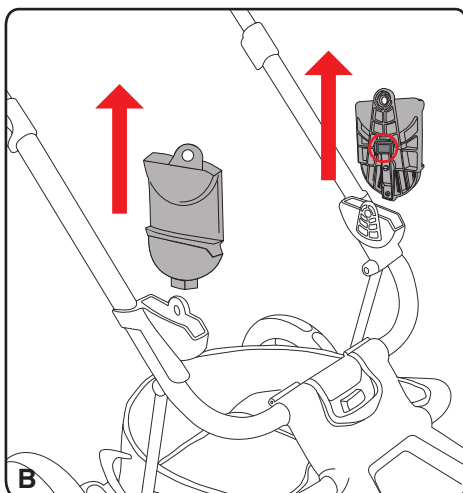
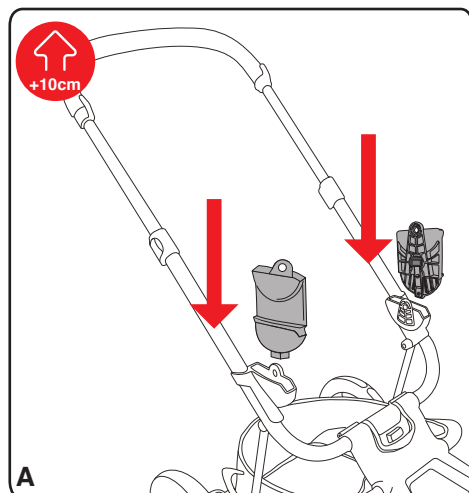



FlexxTM

Bassinet

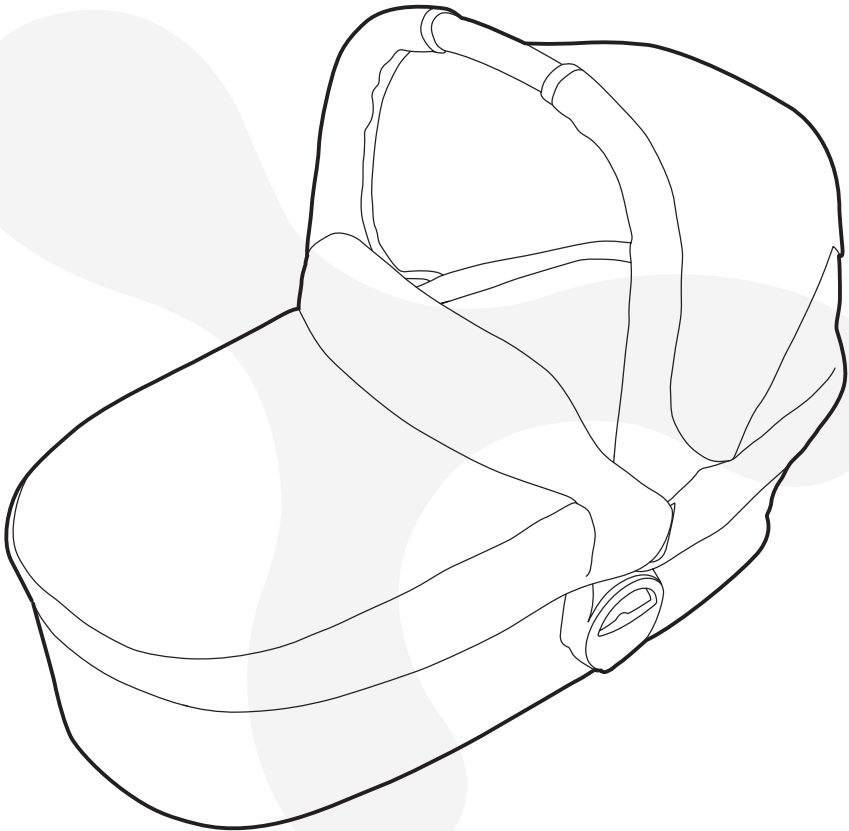

**PLEASE NOTE: THE FLEXX BASSINET MEETS THE REQUIREMENT OF THE
AS/NZS 8811.1:2013 - SLEEP SURFACES - TEST FOR FIRMNESS, AND
EN 1466:2014/AC:2015 SAFETY REQUIREMENTS FOR CARRY COTS.**

Series No. C3401

WARNINGS

ALWAYS FOLLOW THE MANUFACTURERS INSTRUCTIONS.

READ ALL INSTRUCTIONS CAREFULLY BEFORE ASSEMBLY AND USE OF THIS BASSINET.

THE CORRECT USE AND MAINTENANCE OF THIS PRODUCT IS ESSENTIAL.



WARNINGS:

- **DO NOT USE THE BASSINET ONCE THE CHILD CAN SIT UP.**
- **DO NOT USE ANY ACCESSORIES OTHER THAN THOSE APPROVED FOR USE WITH THIS STROLLER BY BRITAX.**
- **IT IS UNSAFE TO USE ACCESSORIES NOT APPROVED FOR USE WITH THIS STROLLER.**
- **THE MAXIMUM WEIGHT OF THE CHILD USING THIS BASSINET IS NOT TO EXCEED 9KG FOR THE BASSINET.**

IMPORTANT NOTES

- **THE FLEXX BASSINET IS THE ONLY BASSINET DESIGNED TO FIT THE FLEXX STROLLER.**
- **REMOVE THE STROLLER SEAT OR INFANT CARRIER FROM THE STROLLER FRAME BEFORE FITTING THE BASSINET.**
- **ALWAYS REMOVE YOUR CHILD FROM THE BASSINET BEFORE INSTALLING ON OR REMOVING FROM THE STROLLER FRAME.**
- **THE BASSINET MUST ALWAYS BE IN THE REARWARD-FACING POSITION (FACING TOWARDS THE HANDLE) WHEN IN THE UPPER POSITION ON THE STROLLER FRAME. THE BASSINET MUST ALWAYS BE IN THE FORWARD-FACING POSITION (FACING TOWARDS THE FRONT OF THE STROLLER) WHEN IN THE LOWER POSITION.**
- **THE BASSINET MUST BE REMOVED FROM THE FRAME BEFORE FOLDING.**
- **DO NOT LIFT THE STROLLER BY THE BASSINET.**

PARTS LIST

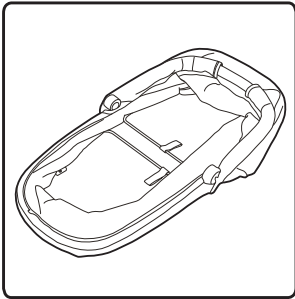

1 x Bassinet frame

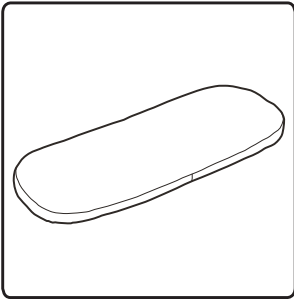

1 x Bassinet mattress

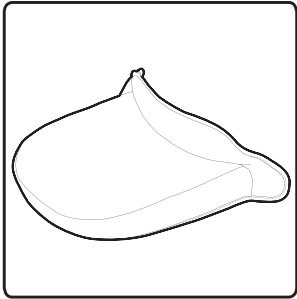

1 x Bassinet boot cover

BASSINET ASSEMBLY

ASSEMBLING THE BASSINET

PLEASE REFER TO PAGE 7 FOR SMART LIFTING TECHNIQUES.

- A** Raise the bassinet canopy until it clicks into place.
- B** Press down on the base of the bassinet & pull up on the bassinet canopy handle to raise the sides of the bassinet.

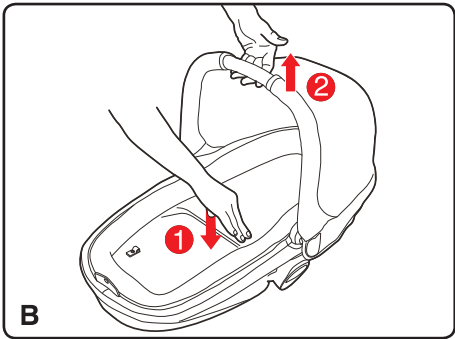
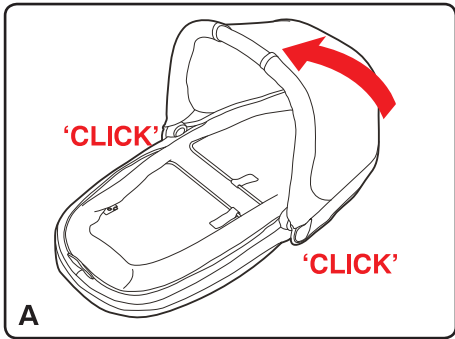

BASSINET ASSEMBLY

ASSEMBLING THE BASSINET

C Pull the frame supports outward by the straps until they lock under all 4 clips. Push down lightly on the top edges of the carry cot to ensure that the frame support rods are firmly locked in place.

D Place the mattress into the bassinet.

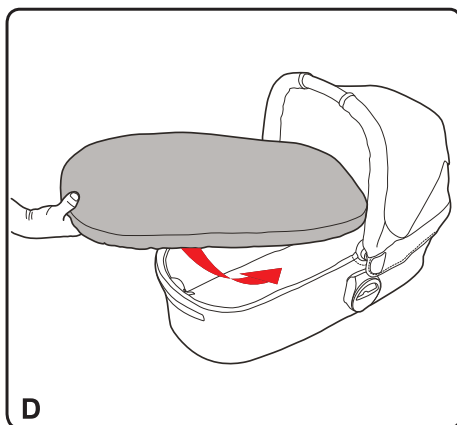
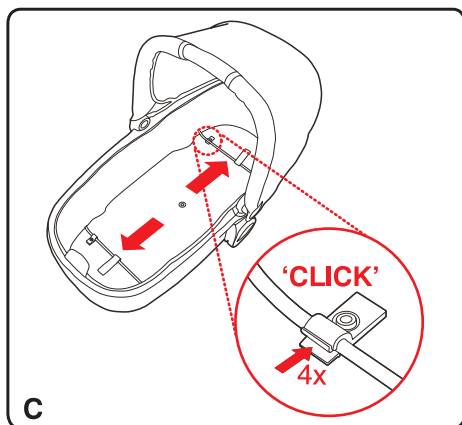

ATTACHING THE BASSINET TO THE STROLLER FRAME

PLEASE REFER TO PAGE 7 FOR SMART LIFTING TECHNIQUES.

IMPORTANT NOTE:

ALWAYS REMOVE YOUR BABY FROM THE BASSINET BEFORE ATTACHING OR REMOVING THE BASSINET.

PLEASE NOTE: The bassinet can only be used in rearward facing mode in the upper position on the stroller frame. The stroller frame will not fold with the bassinet attached. It must be removed before folding.

BASSINET OPERATION

ATTACHING THE BASSINET TO THE STROLLER FRAME

- A** Press down on the lower section of the brake pedal to engage the brake.
Insert the connectors on the bassinet into the housings on the stroller frame.

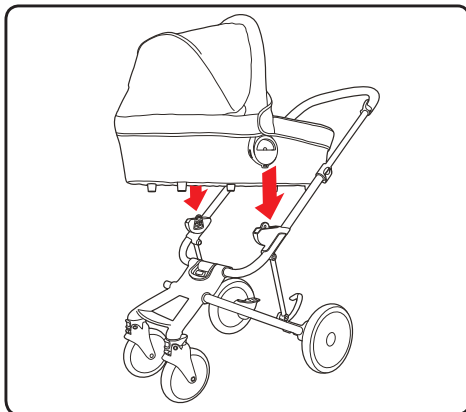

- B** Push down on the bassinet until a 'click' is heard which indicates the connectors have locked into the housings. Gently pull up on the canopy handle to ensure the bassinet has locked into the housings on the stroller frame.



BASSINET OPERATION

ATTACHING THE BOOT COVER

- A** Place the boot cover over the top edge of the bassinet and attach using the press studs and hook and loop on both sides of the bassinet.

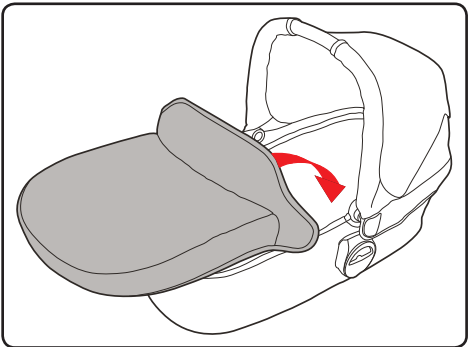

REMOVING THE BASSINET FROM THE STROLLER FRAME

- A** Lift the bassinet release lever located at the bottom of the canopy and using the handle, lift the bassinet away from the stroller.

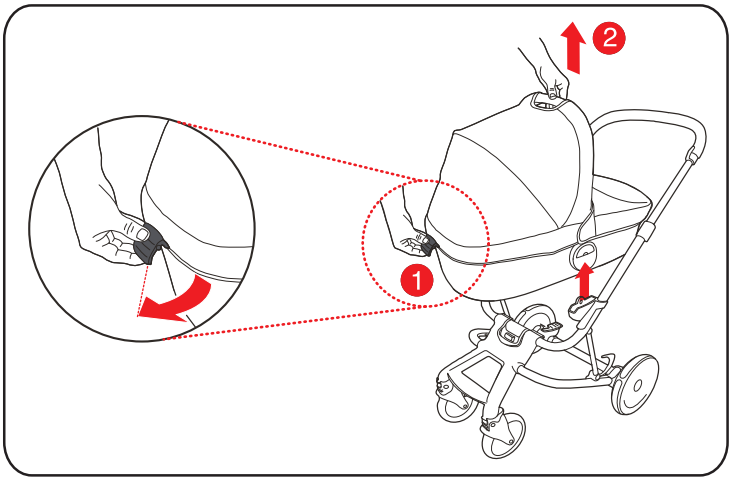

BASSINET OPERATION

ADJUSTING THE CANOPY

CAUTION:

ONLY USE THE CARRY HANDLE WHEN THE CANOPY IS IN THE FULLY EXTENDED AND LOCKED POSITION TO TRANSPORT THE BASSINET.

PLEASE NOTE: There are 3 canopy positions.

- A** The bassinet canopy can be lowered by pressing in the two buttons on the inside of the canopy hinge and rotate the canopy down to the desired position.
- B** Raise the bassinet canopy until it clicks into place.

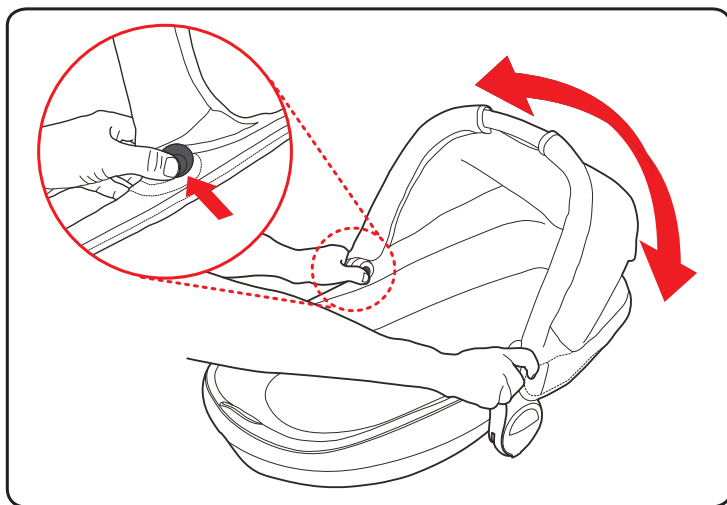

BASSINET OPERATION

ATTACHING THE BASSINET TO THE TANDEM AXLE

PLEASE REFER TO PAGE 7 FOR SMART LIFTING TECHNIQUES.

PLEASE NOTE: THE BASSINET CAN ONLY BE USED IN THE FORWARD-FACING MODE (FACING TOWARDS THE FRONT OF THE STROLLER) WHEN IN THE LOWER POSITION.

- A** Lower the bassinet and insert the connectors into the housings on the second seat axle and push down on the bassinet until a 'click' is heard which indicates the connectors have locked into the housings. Gently pull up on the bassinet canopy handle to ensure it is locked into place.

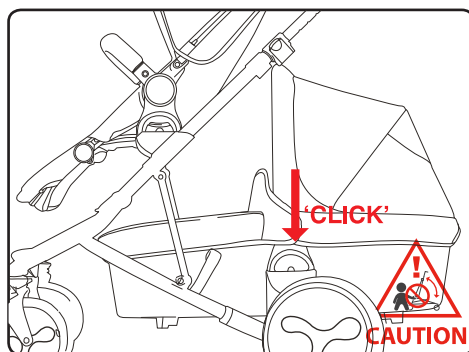

REMOVING THE BASSINET FROM THE TANDEM AXLE

IMPORTANT NOTES:

PLEASE REFER TO PAGE 7 FOR SMART LIFTING TECHNIQUES.

- **ALWAYS REMOVE YOUR CHILD FROM THE BASSINET BEFORE REMOVING THE BASSINET FROM THE TANDEM AXLE.**

- A** Lift the bassinet release lever located at the bottom of the canopy and using the handle, lift the bassinet up and away from the axle.

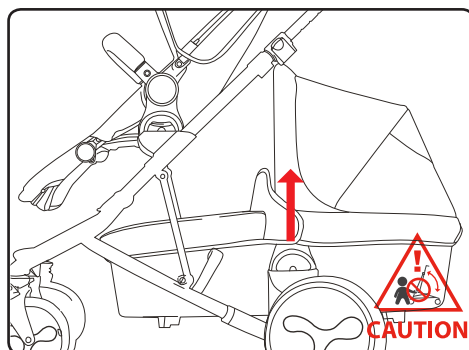



Unity

Click & Go Baby Capsule



Please Note: Flexx Unity Baby Capsule Receivers are sold separately and must be attached to the stroller before attempting to install the Britax Safe N Sound Unity Baby Capsule or the Britax Safe N Sound Unity Baby Capsule Isofix Compatible.

WARNINGS

WARNINGS:

- IT IS UNSAFE TO USE ACCESSORIES NOT APPROVED FOR USE WITH THIS STROLLER.
- DO NOT USE ANY ACCESSORIES OTHER THAN THOSE APPROVED FOR USE WITH THIS STROLLER BY BRITAX.
- THE MAXIMUM WEIGHT OF THE CHILD USING THE BRITAX SAFE N SOUND UNITY NEOS BABY CAPSULE OR BRITAX SAFE N SOUND UNITY BABY CAPSULE ISOFIX COMPATIBLE IS NOT TO EXCEED 12kg.

IMPORTANT NOTES:

- THE BRITAX SAFE N SOUND UNITY NEOS BABY CAPSULE OR BRITAX SAFE N SOUND UNITY BABY CAPSULE ISOFIX COMPATIBLE ARE THE ONLY COMPATIBLE BABY CAPSULES DESIGNED TO FIT THE FLEXX STROLLER.
- REMOVE THE STROLLER SEAT OR BASSINET FROM THE STROLLER FRAME BEFORE INSTALLING THE BABY CAPSULE.
- THE BABY CAPSULE MUST BE CORRECTLY INSTALLED AND LOCKED ONTO THE STROLLER.
- THE BABY CAPSULE CAN ONLY BE ATTACHED IN THE UPPER POSITION ON THE STROLLER FRAME AND MUST ALWAYS BE IN THE REARWARD-FACING POSITION (FACING TOWARDS THE HANDLE).
- SECURE THE CHILD USING THE BABY CAPSULE HARNESS AT ALL TIMES.
- DO NOT LEAVE CHILD IN THE BABY CAPSULE FOR EXTENDED PERIODS.
- THE BABY CAPSULE IS DESIGNED TO PROVIDE MOBILITY OUTSIDE OF THE CAR BUT IT SHOULD NOT BE USED INSTEAD OF AN APPROPRIATE COT.
- THE BABY CAPSULE MUST BE REMOVED FROM THE FRAME BEFORE FOLDING.

IMPORTANT NOTES

IMPORTANT NOTES:

- THE SUN IS VERY STRONG. DO NOT LEAVE YOUR CHILD EXPOSED TO THE SUN. THE CANOPY OR HOOD ON THIS PRODUCT WILL NOT GIVE YOUR CHILD TOTAL PROTECTION FROM THE HARMFUL RAYS OF THE SUN.

PLEASE NOTE: THESE INSTRUCTIONS ARE FOR INSTALLING AND REMOVING THE BABY CAPSULE ON THE STROLLER ONLY. FOR INSTALLING AND PROPER USE OF THE BABY CAPSULE IN THE CAR, PLEASE FOLLOW THE INSTRUCTION BOOK PROVIDED WITH THE BABY CAPSULE.

BABY CAPSULE

INSTALLING AND REMOVING THE BABY CAPSULE RECEIVERS



WARNING: THE FLEXX UNITY BABY CAPSULE RECEIVERS (PURCHASED SEPARATELY) MUST BE ATTACHED TO THE STROLLER FRAME BEFORE ATTEMPTING TO INSTALL THE BRITAX SAFE N SOUND UNITY CLICK & GO BABY CAPSULE OR THE BRITAX SAFE N SOUND UNITY BABY CAPSULE ISOFIX COMPATIBLE.

- A** Insert the baby capsule receivers into the stroller frame sockets ensuring the white triangles on the receivers and the stroller frame sockets are aligned. Press firmly down on the baby capsule receivers until you hear a 'click' which indicates the receivers have locked into the stroller frame sockets. Pull up on the baby capsule receivers to ensure they are locked into the frame sockets.

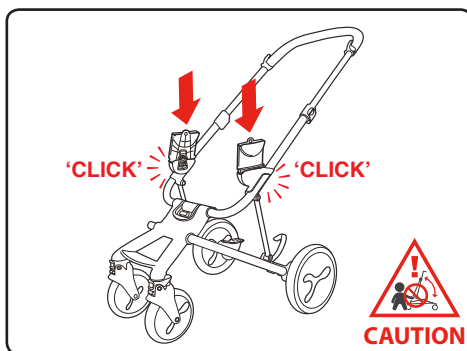

- B** To remove the baby capsule receivers, press in and hold the button on the inside of the receiver up and out of the frame sockets.

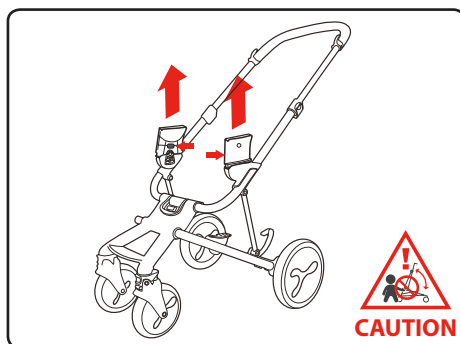

BABY CAPSULE

ATTACHING THE UNITY CLICK & GO BABY CAPSULE TO THE STROLLER FRAME

PLEASE REFER TO PAGE 7 FOR SMART LIFTING TECHNIQUES.

IMPORTANT NOTE:

ALWAYS REMOVE YOUR BABY FROM THE BABY CAPSULE BEFORE ATTACHING OR REMOVING THE BABY CAPSULE.

PLEASE NOTE: The baby capsule can only be used in rearward facing mode in the upper position on the stroller frame. The stroller frame will not fold with the baby capsule attached. It must be removed before folding.

PLEASE NOTE: Ensure the baby is secured in the baby capsule with the harness at all times. Refer to the baby capsule instructions regarding placing and securing your baby in the baby capsule.

The baby capsule has been fitted with a hood when using the stroller. The hood may also be used in the car.

- A** Lock the stroller brake. (Refer to Page 25).
Insert the connectors on the baby capsule into the receivers on the stroller frame.

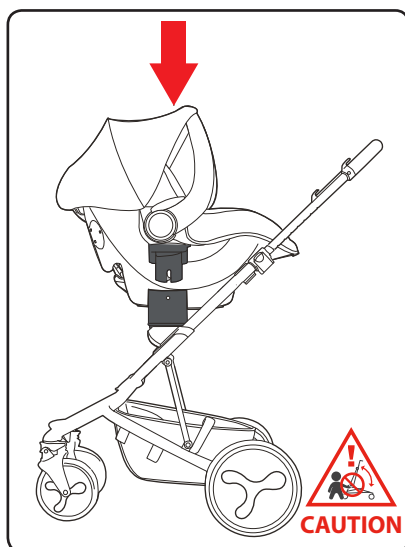

BABY CAPSULE

ATTACHING THE UNITY CLICK & GO BABY CAPSULE TO THE STROLLER FRAME

- B** Push down on the baby capsule until a 'click' is heard which indicates the connectors on the baby capsule have locked into the baby capsule receivers. Pull up on the baby capsule to ensure that it is securely locked onto the stroller frame.

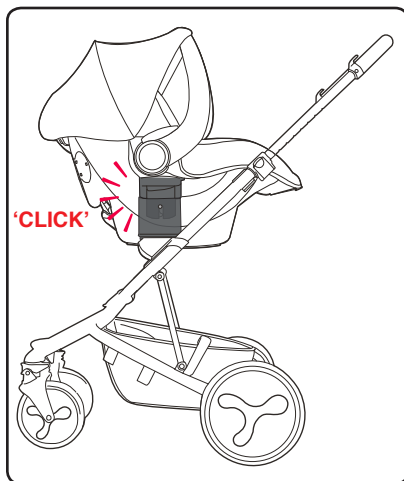

REMOVING THE UNITY CLICK & GO BABY CAPSULE FROM THE STROLLER FRAME

PLEASE REFER TO PAGE 7 FOR SMART LIFTING TECHNIQUES.

- A** Lock the stroller brake. (Refer to Page 25)
Squeeze both release levers on the Click & Go connectors at the same time and support the weight of the baby capsule. Lift and remove the baby capsule from the stroller frame.

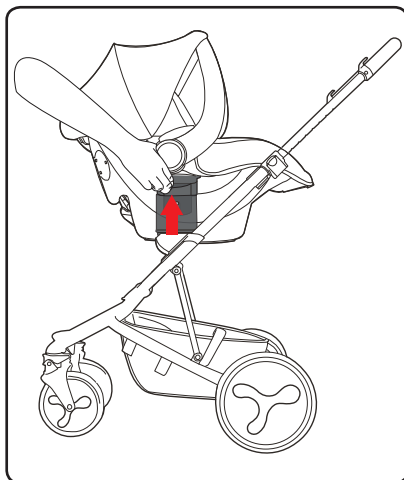

CARE AND MAINTENANCE

- To prolong the life of your stroller, bassinet or second seat - keep each product clean and do not leave it in the direct sunlight or in the car boot for extended periods of time.
- Removable fabric covers and trims may be cleaned using warm water with a household soap or mild detergent. Allow it to dry fully, preferably away from the direct sunlight.
- Non removable fabric covers and trims may be spot cleaned using a damp sponge with soap or a mild detergent. Allow it to dry completely before folding or storing it away.
- In some climates the covers and trims may be affected by mould and mildew. To help prevent this occurring, do not fold or store the product if it is damp or wet. Always store the product in a well ventilated area.
- When using your stroller at the beach - completely clean your stroller afterwards to remove the sand and salt from the mechanisms and wheel assembly. Sand and salt will cause premature wear and corrosion.
- If there are compression marks on the tyres - Use a domestic hair dryer to gently warm (DO NOT OVERHEAT) the tyre and the compression marks should slowly disappear.
- Always check parts regularly for tightness of screws, nuts, and other fasteners - tighten if required. To maintain the safety of your nursery product, seek prompt repairs for bent, torn, worn or broken parts.

THIS PRODUCT IS NOT INTENDED FOR COMMERCIAL USE.

NOTES

NOTES

NOTES

youtube.com/britaxaustralia



facebook.com/britaxaustralia



twitter.com/britaxaustralia



pinterest/britaxaustralia



britax.com.au



1300 303 330



BRITAX CHILDCARE PTY. LTD.

A Britax International Company

ABN 55 006 773 6000

Level 4/ 650 Lorimer street Port Melbourne
Victoria 3207 Australia

Britax Childcare Pty Ltd

(Customer Service 1300 303 330)

Britax Childcare (NZ) Ltd

(Customer Service 0508 688 822)

Due to the variations in style and design of our products, the illustrations used in this instruction booklet are generic.

We reserve the right to alter these products without notice.

The Britax Trademark is the property of Britax Childcare Holdings Limited - UK.

This product is designed to comply with Australian and New Zealand standard AS/NZS2088:2013 "Prms and Strollers - Safety Requirements."

©2017 Copyright Britax Childcare Pty. Ltd. Australia