

Agile Plus

Reverse Handle 4 Wheel Travel System Stroller



**Suitable for use with the Steelcraft Infant Carrier
or the Britax Click & Go Unity Infant Carrier
(Infant Carriers are sold separately)**

IMPORTANT: KEEP THIS BOOKLET IN A SAFE PLACE FOR FUTURE REFERENCE.

CONTENTS

Important Notes & Warnings.....	4-5
Manual Handling Techniques.....	6
Parts List.....	7-8
Assembled Stroller Parts List.....	9
1. To open the stroller.....	10-11
2. To attach and remove the front swivel wheels.....	11
3. To attach and remove the rear wheels.....	12
4. To use the swivel wheels.....	12
5. To attach and use the canopy.....	13-16
6. To attach and use the child tray.....	17-18
7. To attach and use the head pillow & shoulder pads.....	19
8. To attach the boot cover.....	20
9. To attach the rain cover.....	21
10. To adjust the backrest.....	22-23
11. To adjust the leg rest.....	24
12. To adjust the pivotal handle.....	25
13. To use the brakes.....	26
14. To use the reversal handle.....	27-28
15. To use the tether strap.....	29
16. To secure your child in the harness.....	30-34
17. To use the stroller.....	35
18. To fold the stroller.....	36-39
19. To lift and carry the stroller.....	40

20. Infant Carrier Warnings and Important Notes..... 41-43

2. To install the Steelcraft infant carrier..... 44-46

2. To release the Steelcraft infant carrier.....47-48

Care and Maintenance.....49

IMPORTANT NOTES:

ALWAYS FOLLOW THE MANUFACTURERS INSTRUCTIONS.
READ ALL INSTRUCTIONS CAREFULLY BEFORE ASSEMBLY AND USE
OF THIS STROLLER.
THE CORRECT USE AND MAINTENANCE OF THIS PRODUCT IS
ESSENTIAL.

- USE GREAT CARE WHEN USING THE STROLLER ON STAIRS, ESCALATORS, TRAVELATORS OR OTHER MOVING SURFACES.
- IT IS RECOMMENDED TO REMOVE THE CHILD FROM THE STROLLER BEFORE GOING UP OR DOWN STAIRS OR ESCALATORS.
- DO NOT LIFT THE STROLLER BY THE TRAY (Supplied) OR ARM BAR (Purchased Separately) BECAUSE IT MAY DISENGAGE.
- DO NOT ALLOW CHILDREN TO STAND ON THE SEAT.
- DO NOT HANG BAGS OR GOODS FROM THE HANDLE AS THIS COULD CAUSE THE STROLLER TO TIP OVER.
- DO NOT LEAVE THE STROLLER AND ITS ACCESSORIES NEAR AN OPEN FIRE OR EXPOSED FLAME.
- DO NOT PLACE MORE THAN 4 KG IN THE BASKET, OR 1 KG IN THE CANOPY POCKET (IF SUPPLIED).

WARNINGS: TO AVOID INJURY OR DEATH:

ALWAYS APPLY THE BRAKES WHENEVER THE STROLLER IS STATIONARY.

- **DO NOT LEAVE CHILDREN UNATTENDED.**
- **SECURE THE CHILD IN THE HARNESS AT ALL TIMES.**
- **DO NOT CARRY EXTRA CHILDREN OR BAGS ON THIS STROLLER.**
- **MAKE SURE CHILDREN ARE CLEAR OF ANY MOVING PARTS IF YOU ADJUST THE STROLLER.**
- **DO NOT USE ANY ACCESSORIES OTHER THAN THOSE APPROVED FOR USE WITH THIS STROLLER BY BRITAX.**
- **IT IS UNSAFE TO USE ACCESSORIES NOT APPROVED FOR USE WITH THIS STROLLER.**
- **THE MAXIMUM WEIGHT OPTIONS OF THE CHILD USING THIS STROLLER ARE NOT TO EXCEED THE FOLLOWING:**
PARENT FACING CHILD MODE: 17 KGS
CHILD FACING AWAY FROM PARENT MODE: 25KGS

FOR IMPORTANT NOTES AND WARNINGS ON ACCESSORIES - REFER TO THEIR INDIVIDUAL SECTIONS IN THIS BOOK. THE MAXIMUM WEIGHT VARIES FOR EACH ACCESSORY.



CAUTION

This CAUTION Symbol is shown at certain steps in this Instruction Manual to highlight the danger of being injured by moving parts.

The **SMART** lifting technique

This technique can be used to pick up small light loads from low levels.

Size up the Load

- Assess the load (size, shape and weight).
- Assess whether the load needs to be moved;
- Where is it going to be placed? Check that there are no obstructions;
- Assess whether mechanical or human assistance is required.

Move the Load as close to the body as possible

- A load is heavier to lift or carry if it is not close to the body.
- The whole hand should be used to ensure a firm grip.

Always bend your knees

- Maintain balance.
- Keep feet apart and in a comfortable position.
- Minimise lower back bending.
- Bend knees preferable at as large an angle as possible but not at a right angle - use a semi squat in preference to a full squat.

Raise the load with your legs

- Achieve the lift smoothly and without jerkiness.
- Maintain the normal curvature of the spine to allow the force of the load to be distributed evenly from the spine to the pelvis.

Turn your feet in the direction that you want to move the load.

- Avoid unnecessary bending, twisting and reaching.
- Change direction by turning your feet and not your back.
- To set the load down, squat down, keep your head up and let
- Let your legs do the work.

Remember to 'THINK TALL' chest lifted, shoulders relaxed, chin tucked in and head level.

PARTS LIST

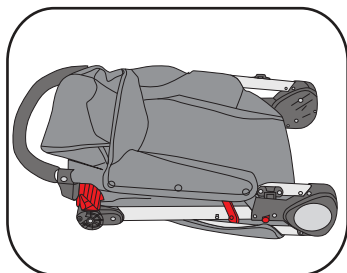

A 1 x Stroller Frame,
Seat & Basket

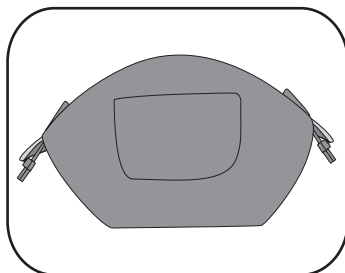

B 1 x Canopy

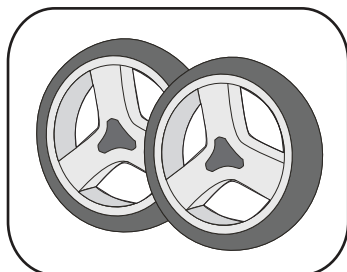

C 2 x Rear Wheels

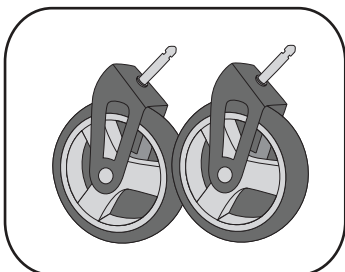

D 2 x Front wheels

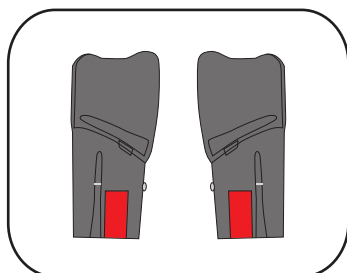

E 2 x Car Seat Receivers
for Steelcraft Infant Carrier

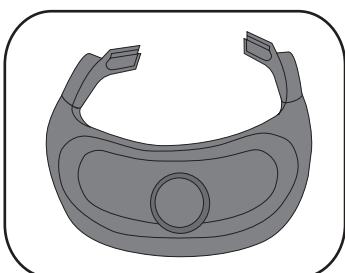

F 1 x Child Tray

PARTS LIST (Cont)

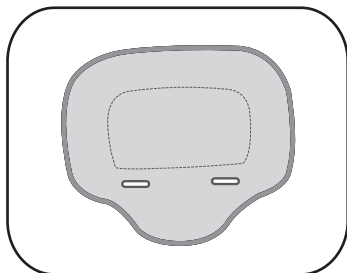

G 1 x Head Pillow

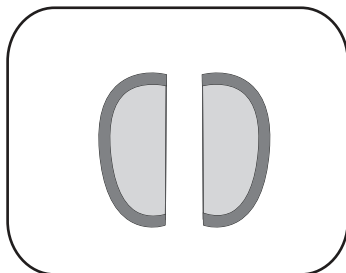

H 2 x Shoulder pads

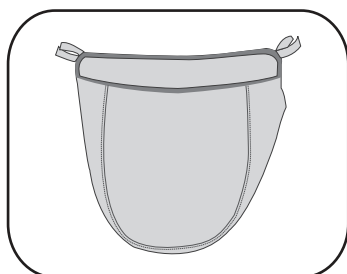

I 1 x Boot cover

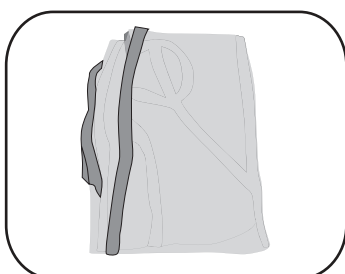

J 1 x Rain cover

ASSEMBLED STROLLER - PARTS LIST

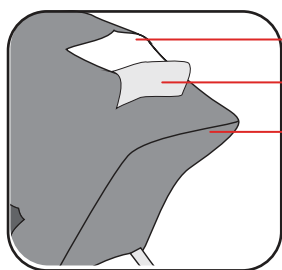
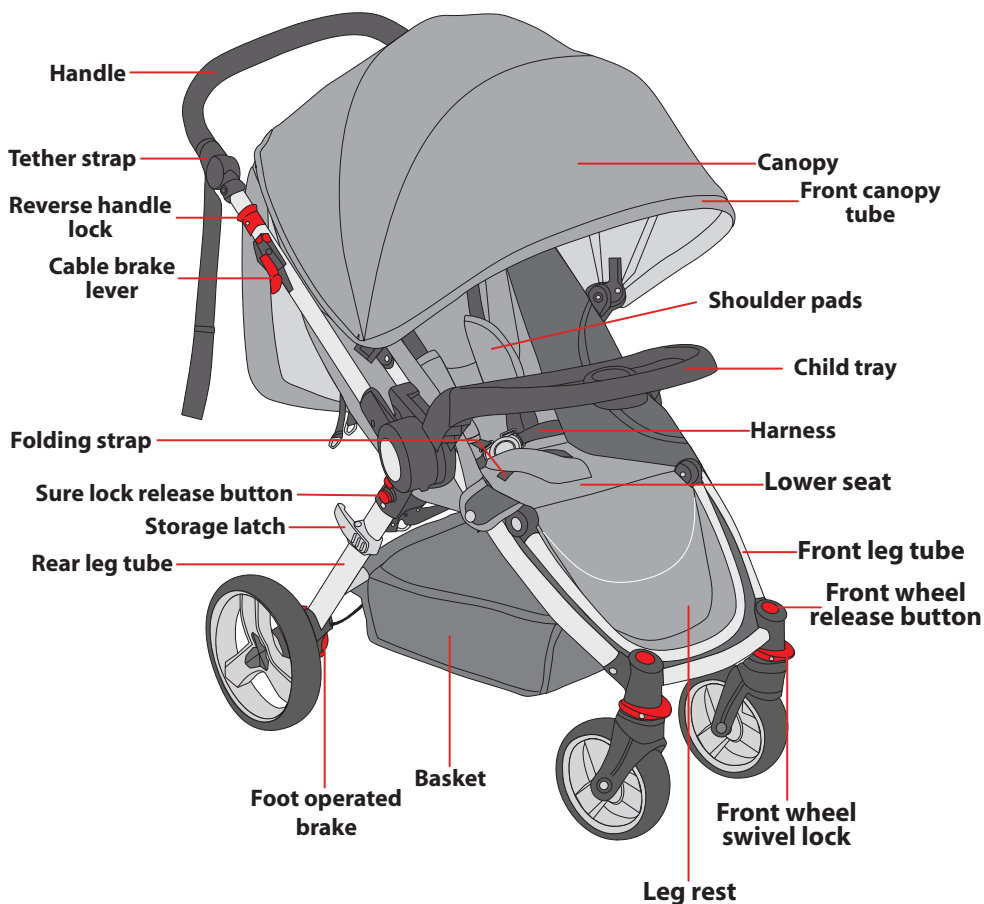

- Canopy window
- Canopy window cover
- Canopy back flap zipper

1. TO OPEN THE STROLLER

IMPORTANT NOTES:

PLEASE REFER TO PAGE 6 FOR SMART LIFTING TECHNIQUES.

- RELEASE THE STORAGE LATCH WITH DUE CARE AND OPEN THE FRAME.
- WHEN OPENING THE STROLLER, BE AWARE OF THE DANGER OF BEING INJURED BY MOVING PARTS AND LOCKING DEVICES DURING THE PROCESS. KEEP ALL HANDS AND LIMBS CLEAR OF THESE PARTS.
- THERE IS POTENTIAL FOR FINGERS OR PARTS OF THE BODY TO BE INJURED WHEN THE STROLLER IS BEING UNFOLDED, DUE CARE SHOULD BE EXERCISED.
- KEEP CHILDREN CLEAR OF THE STROLLER WHEN UNFOLDING THE STROLLER.
- OPEN THE STROLLER SLOWLY AND BE CAREFUL WHERE YOU PLACE YOUR HANDS.

A Release the storage latch (1) located on the rear leg.

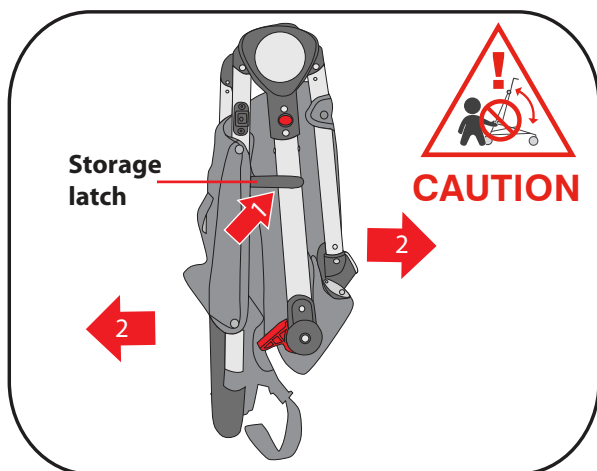

1. TO OPEN THE STROLLER (Cont.)

- B Open the frame as shown by the arrows (2) until you hear a 'click' which indicates the frame is fully opened and locked.

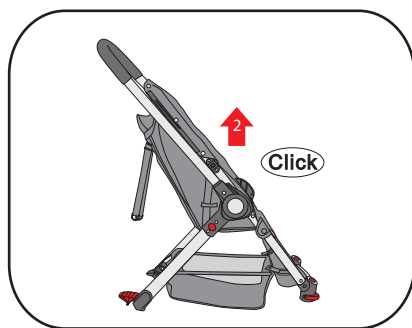

2. TO ATTACH AND REMOVE THE FRONT SWIVEL WHEELS

- A To assemble the front swivel wheel assembly, insert the swivel wheel assembly and push it into the wheel moulding until you hear a 'click' which indicates the wheel is locked in. Check the wheel assembly is fully locked by pulling against it.
- B To remove the front swivel wheel assembly, locate and press in the red button on top of the wheel moulding.

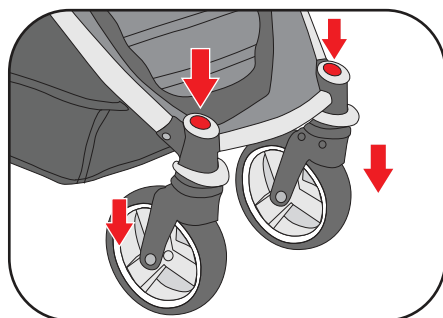
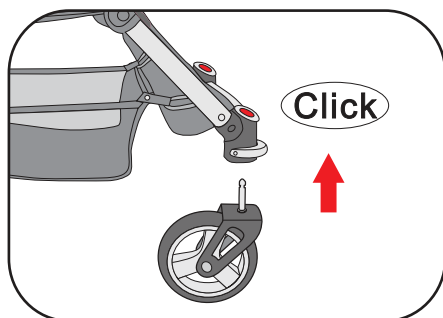

3. TO ATTACH AND REMOVE THE REAR WHEELS

- A To attach the rear wheels, insert each wheel axle into the moulding and push in until locked. You should hear a 'click' which indicates the wheel has locked in. Pull on the wheel to make sure it is engaged. Repeat the process if not locked in.
- B To remove the wheels, pull the metal latch downwards on the underneath of the brake moulding to release the wheel, and then pull the wheel off.

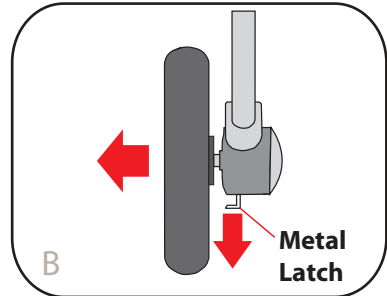
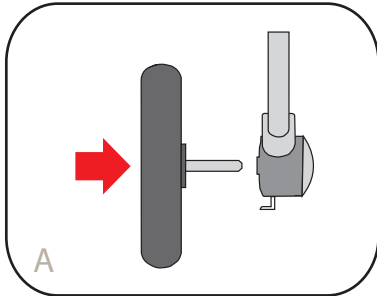

4. TO USE THE SWIVEL WHEELS

- A Press the swivel lock down to lock the swivel wheels. Push the swivel wheel lock up to allow the wheels to swivel.
- Please Note: Always lock the swivel wheels when using the stroller on rough surfaces as it will minimise wheel wobble.**

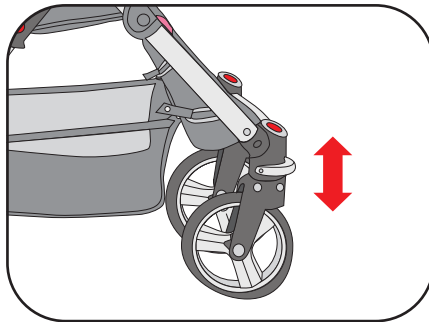

IMPORTANT NOTE:

The sun is very strong. **DO NOT LEAVE YOUR CHILD EXPOSED TO THE SUN.** The canopy or hood on this product will not give your child total protection from the harmful rays of the sun.

- A1** To attach the canopy, insert the canopy mouldings into the frame mouldings until they connect together. The back flap of the canopy can be attached to the main canopy with the zipper attachment.

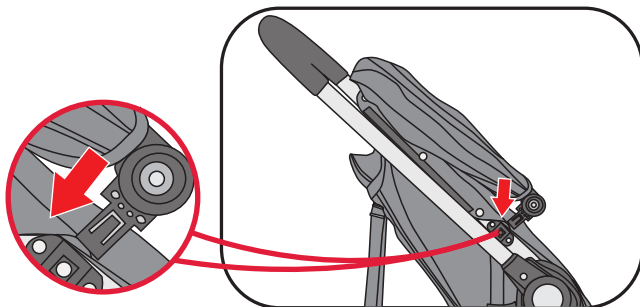

- A2** Attach the snaps located along the edge on the underside of the canopy to the top of the seat pad.

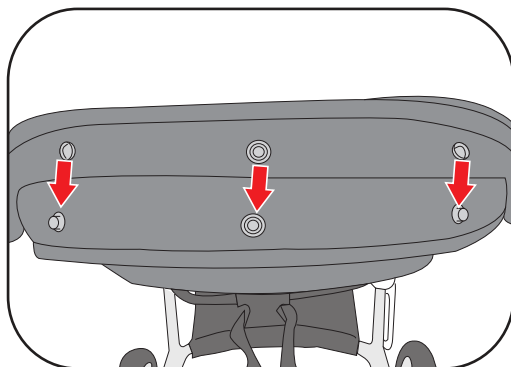

5. TO ATTACH AND USE THE CANOPY (Cont)

- A3** Attach the hook strip (A) on the inside edge of the canopy to the loop strip (B) on the side of the stroller.

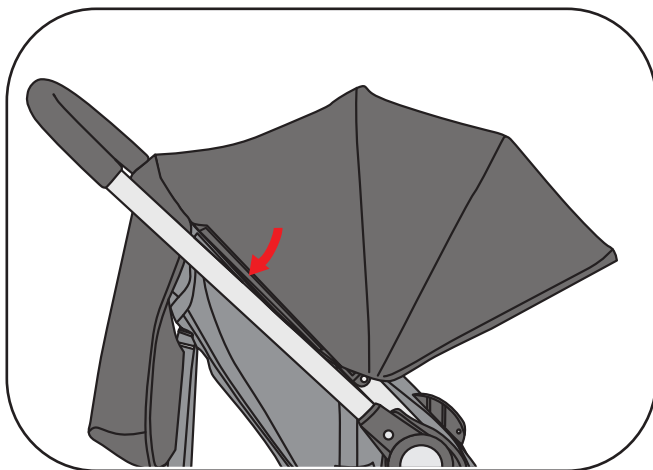

- B** To adjust the canopy, open by pulling forward, or close by pushing it backward.

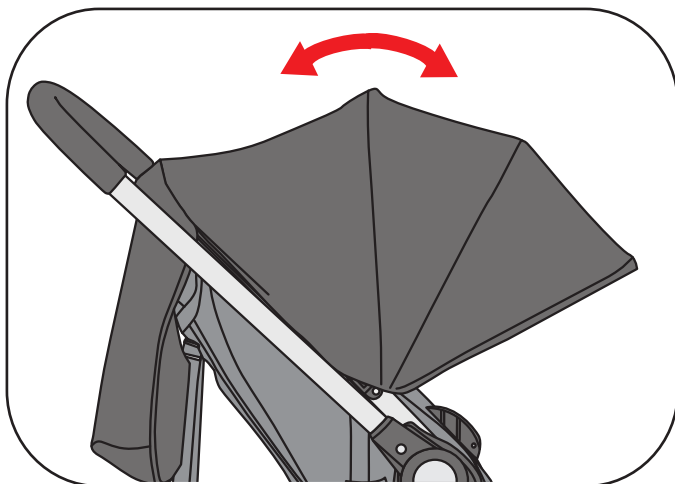

5. TO ATTACH AND USE THE CANOPY (Cont)

- C To open the canopy window lift the canopy window flap away from the canopy.

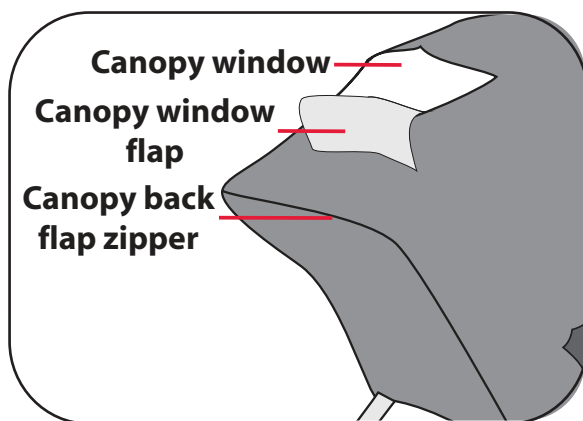

- D To remove the canopy, press in the button on the canopy moulding and pull out of the frame mouldings.

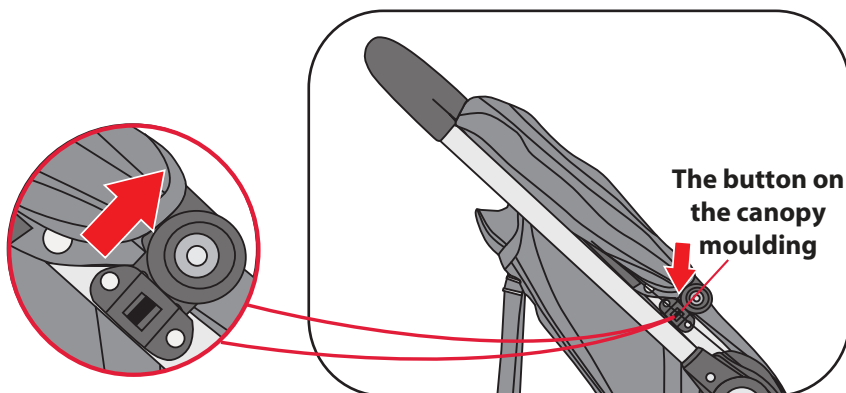

5. TO ATTACH AND USE THE CANOPY (Cont)

- E For additional air circulation the back flap of the canopy can be removed by opening the zipper. To reattach the back flap to the main canopy secure with the zipper.

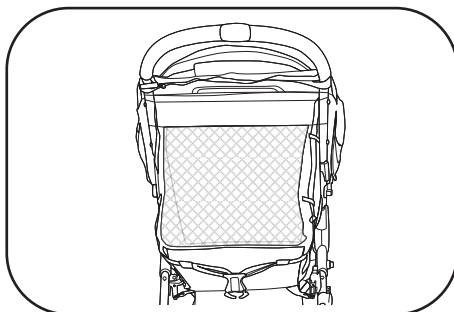
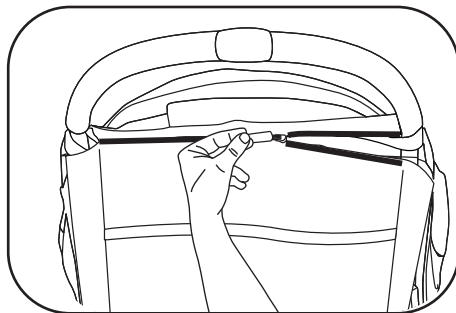

- F You can also fold up the back flap and secure with the toggle and elastic.

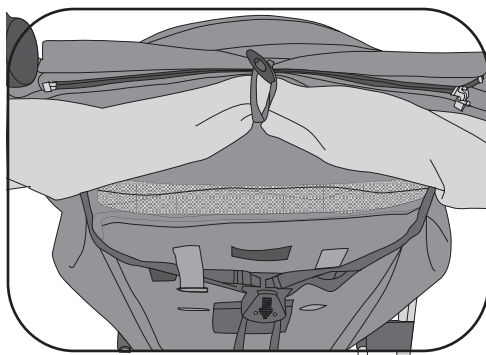

6. TO ATTACH AND USE THE CHILD TRAY



WARNING: WHEN A CHILD IS IN THE STROLLER
KEEP THE CHILD TRAY ATTACHED TO THE ADAPTORS AT ALL
TIMES.

- A Stand beside the stroller and pull the fabric back from the sides of the stroller to expose the stroller hinge. Take one child tray adaptor at a time & insert the adaptor into the stroller hinge as show. Each adaptor is marked Left & Right for correct fitting. Push on the adaptor until you hear a 'click' which indicates the adaptor has locked in. Pull up on each adaptor to check they have fully locked in.

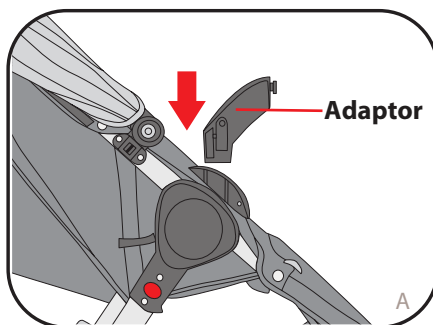

- B Align the child tray onto the adaptors and lower the child tray until you hear a 'click'.

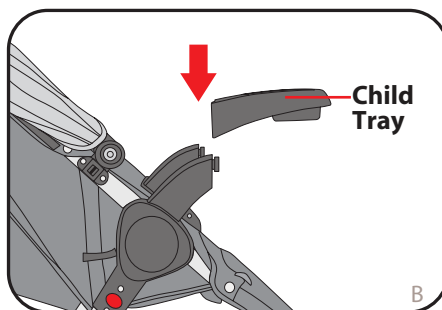

6. TO ATTACH AND USE THE CHILD TRAY(Cont)

- C To release the child tray, pull the grey tab underneath the tray and rotate the tray.

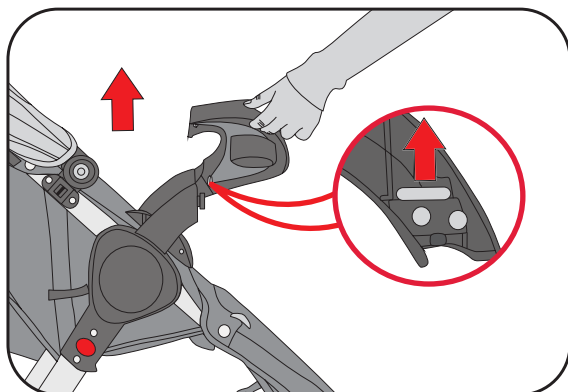

- D To remove the child tray, push the grey tabs on the adaptors and lift the adaptors and tray until it is removed.

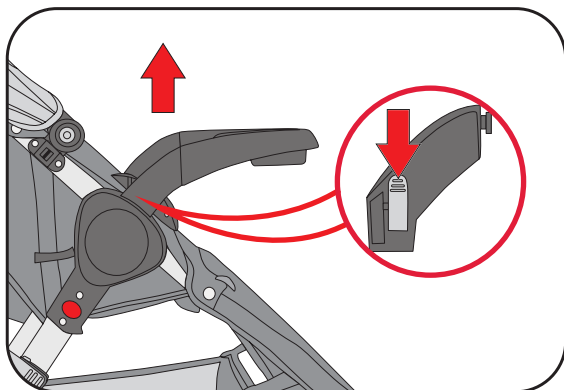

7. TO ATTACH & USE THE HEAD PILLOW & TO ATTACH THE SHOULDER PADS

- A** To attach the head pillow, release the harness buckles and thread the shoulder straps through the harness slot. The head pillow has a small height adjusting range. Attach the head pillow in the most appropriate position for your child using the hook & pile strips.
- B** To attach the shoulder pads, release the harness buckles and slide the shoulder pads onto the shoulder harness.

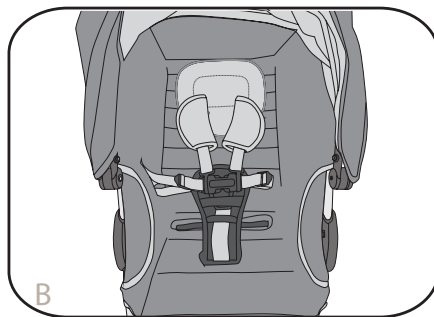
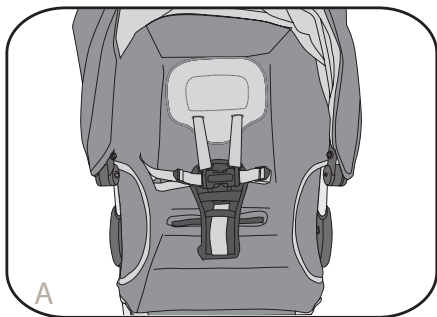
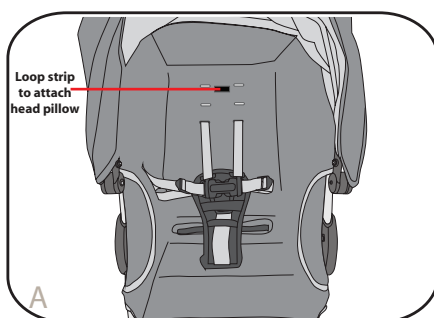
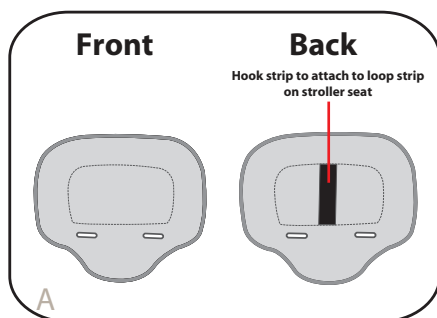

8. TO ATTACH THE BOOT COVER

- A Raise the leg rest, hook boot cover under the leg support and pull the boot cover up. Connect the hook and loop strip around the stroller frame.
- B If the child tray is attached, raise the leg rest, hook boot cover under the leg support and pull the boot cover under the child tray. Connect the hook and loop strip around the stroller frame.



9. TO ATTACH THE RAIN COVER

IMPORTANT NOTE:

ENSURE THE RAIN COVER IS KEPT AWAY FROM THE CHILD'S FACE. REFIT THE RAIN COVER IF REQUIRED TO ENSURE YOUR CHILD IS SAFE.

PLEASE NOTE: The rain cover can be fitted with the handle in either the forward or reverse position.

- A Place the rain cover over the extended canopy of the stroller and pull the short section of the raincover over the rear of the stroller.
- B Attach the hook and loop straps on the front of the rain cover around the wheel moulding above the swivel lock.



10. TO ADJUST THE BACKREST

WARNINGS:

- **THE UPRIGHT POSITIONS ARE NOT SUITABLE FOR USE WITH CHILDREN LESS THAN 6 MONTHS OLD.**
- **THE LOWEST RECLINE POSITION SHOULD BE USED TO TRANSPORT BABIES. THE BACKREST CAN BE ADJUSTED TO A MORE UPRIGHT POSITION AS THE CHILD GROWS OLDER AND IS ABLE TO SUPPORT ITS HEAD WITHOUT ASSISTANCE.**

PLEASE NOTE: If the child is sitting in the seat, support the backrest as it reclines. If you have difficulty adjusting the backrest you may need to remove the child from the seat to allow you to raise or lower the backrest with ease.

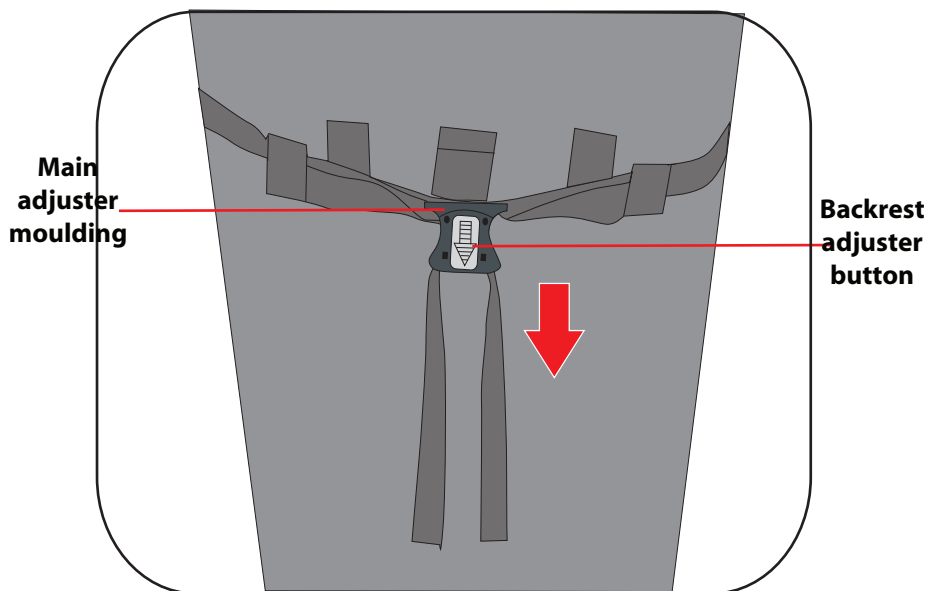

10. TO ADJUST THE BACKREST

- A To raise the backrest, hold the main adjuster moulding in one hand, then grasp the plastic rings fixed to the adjuster straps with the other hand. Push up on the main adjuster moulding at the same time pull the adjuster strap to the desired position.

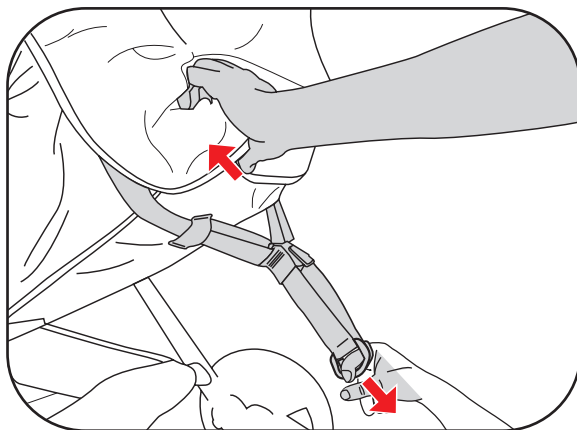

- B To lower the backrest, support the backrest with one hand and with the other hand pull down the on the backrest adjuster button and lower the backrest to the desired position.

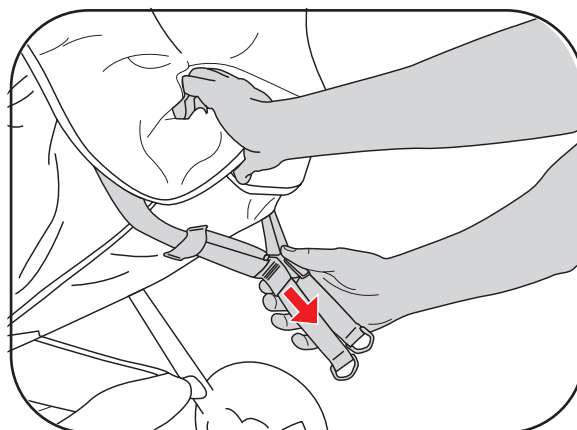

IMPORTANT NOTES:

- THE LEG REST FEATURE IS PROVIDED FOR YOUR CHILDS COMFORT.
- THE LEG REST IS NOT DESIGNED TO SUPPORT EXTRA WEIGHT.
- DO NOT ALLOW CHILDREN TO STAND OR SIT ON THE LEG REST. IT WILL DISENGAGE IF EXTRA WEIGHT IS APPLIED.
- IF LEG REST DISENGAGES SIMPLY LIFT UP AGAIN TO RESET LEG REST MODE.

A To adjust the leg rest, press the release buttons in on both sides of the leg rest and raise or lower to your desired position.

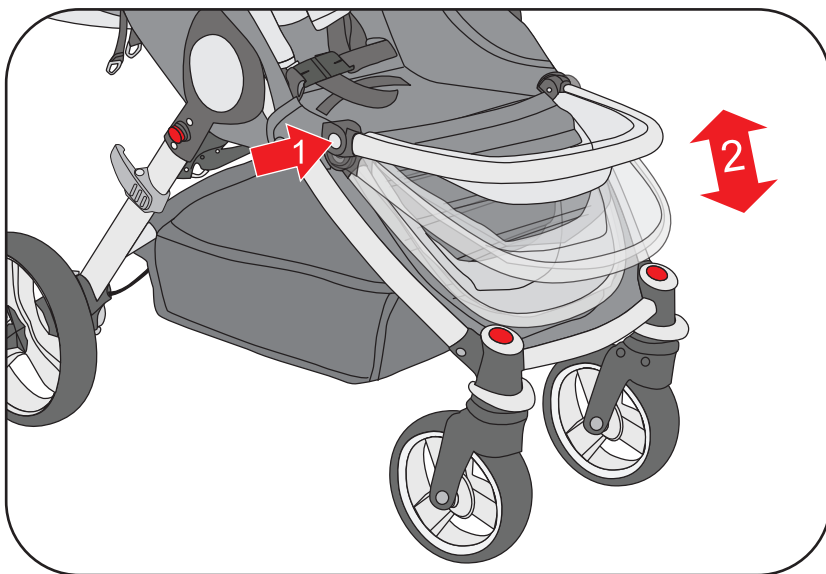

PLEASE NOTE: When folding the stroller, lower the leg rest all the way down so the hook & loop tabs under the leg rest fasten together. This will prevent the leg rest from any damage during folding.

12. TO ADJUST THE PIVOTAL HANDLE

- A To adjust the handle height, squeeze in and hold the buttons on the inside of the handle. Rotate the handle up or down to the desired position then release the buttons.

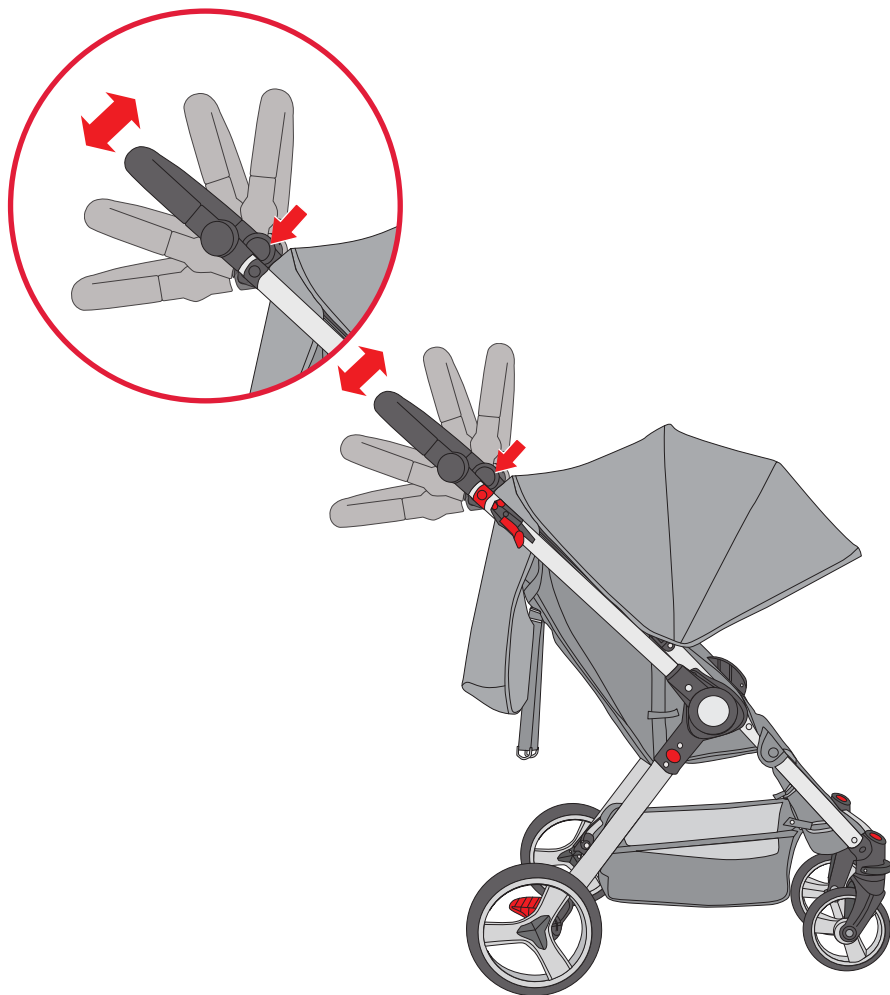

13. TO USE THE REVERSE HANDLE

IMPORTANT NOTE:

WHEN A CHILD IS IN THE STROLLER, ENSURE THEIR FINGERS ARE NOT ON THE TRAY/ARM BAR WHEN MOVING THE HANDLE.

Please Note: When making adjustments to the handle position you must also adjust the position of the wheels. See Section 4 - To use the swivel wheels.

When stroller is in parent facing child mode, ensure the wheels are unlocked so the wheels can swivel freely.

- A Lift the reverse handle lock on each side of the handle to release it into the forward or reverse positioning. Ensure that both sides are fully locked before using the stroller.

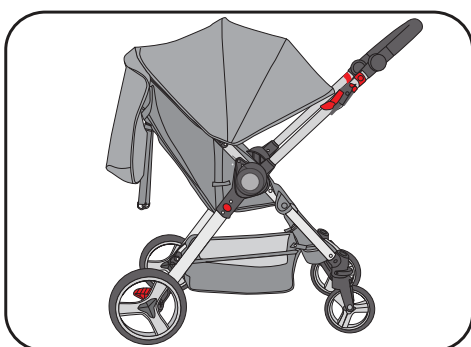
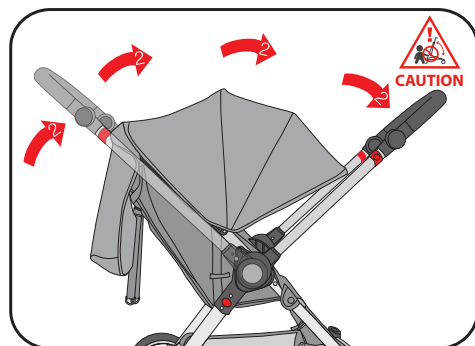
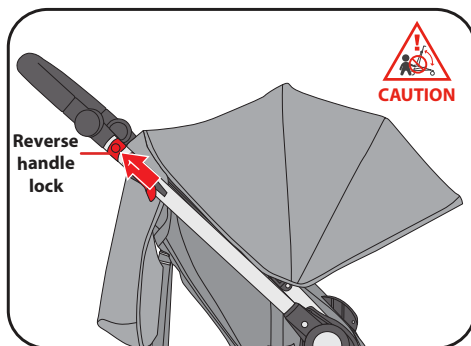

14. TO USE THE BRAKES

IMPORTANT NOTE:

THERE ARE TWO BRAKING SYSTEMS ON THIS STROLLER, THE REAR WHEEL BRAKE PEDAL IS USED WHEN THE HANDLE IS BEHIND THE STROLLER IN THE CHILD FACING AWAY FROM PARENT MODE.

THE CABLE BRAKE LEVER ON THE HANDLE IS USED WHEN THE HANDLE IS IN FRONT OF THE STROLLER IN THE PARENT FACING CHILD MODE MODE.



WARNING: ALWAYS APPLY THE BRAKES WHEN THE STROLLER IS STATIONARY.

REAR WHEEL BRAKE PEDAL

- A To lock the rear wheel, press the brake pedal down. Check that the brakes have locked by trying to push the stroller forward. If not locked, repeat this step.
- B To release the brake, push the brake pedal up.

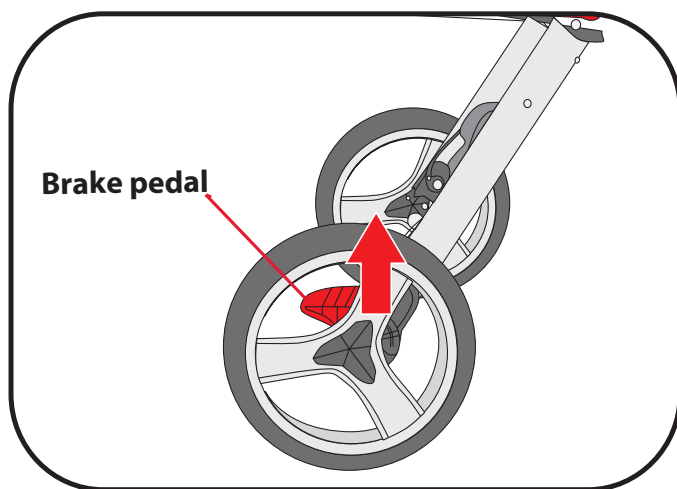

14. TO USE THE BRAKES (Cont)

CABLE BRAKE LEVER

- A** To lock the rear wheels, gently pull cable brake lever up towards the handle until it locks into place. Check that the brakes have locked by trying to push the stroller forward. If not locked, repeat this step.
- B** To release the cable brake, push the brake lever in towards the handle and hold, then push the red tab in and release the lever.

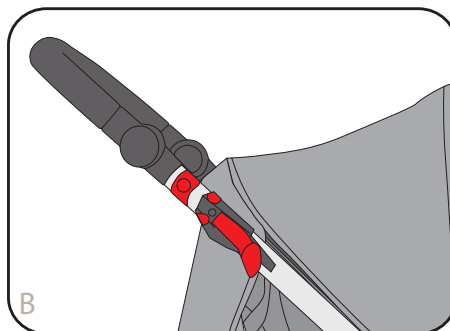
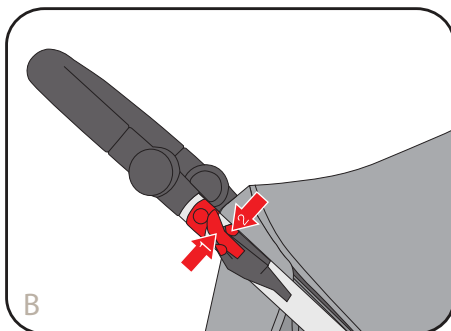
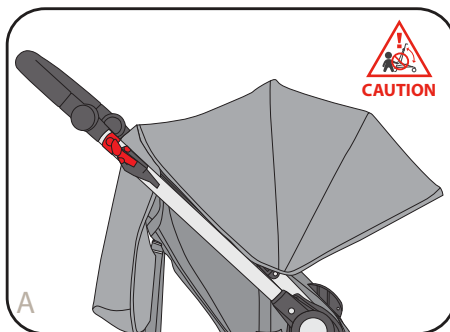
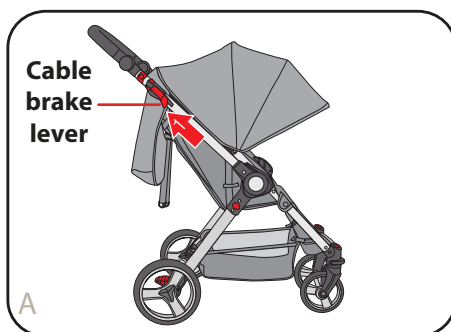

15. TO USE THE TETHER STRAP

WARNINGS: USE THE TETHER STRAP TO STOP THE STROLLER ROLLING AWAY.

- **THE STROLLER IS DESIGNED FOR USE ON FLAT OR GENTLY SLOPING SURFACES, AND MAY BE UNSTABLE ON HIGHER SLOPING AND UNEVEN SURFACES AND USERS SHOULD BE AWARE OF THE POSSIBILITY OF THE STROLLER ROLLING AWAY OR TIPPING OVER.**
- **NEVER LET GO OF THE STROLLER WHEN PARKED ON AN INCLINE OR SLOPING SURFACE BECAUSE IT MAY SLIDE OR TIP OVER. ALWAYS PARK ON A FLAT SURFACE AND APPLY THE BRAKES.**
- **ALWAYS APPLY THE BRAKES WHENEVER THE STROLLER IS STATIONARY.**

A A wrist tether strap is provided on the handle grip. Slide your hand through the tether strap loop whenever you use the stroller. Only remove your hand from the tether strap loop when the brakes have been applied to the stroller wheels.

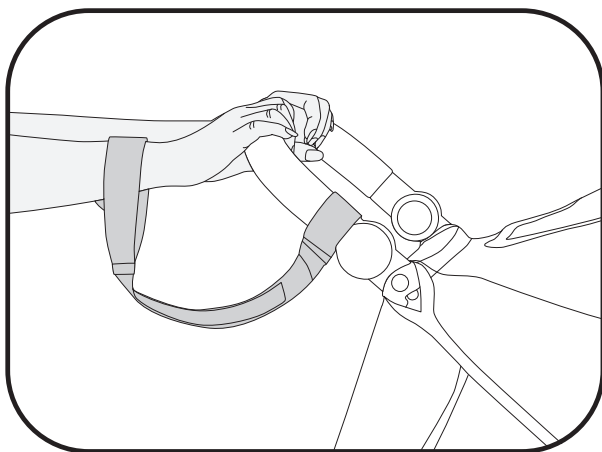

16. TO SECURE YOUR CHILD IN THE HARNESS

WARNING: USE THE HARNESS AT ALL TIMES.

- **ENSURE YOUR CHILD IS SECURED WITH A CORRECTLY ADJUSTED HARNESS.**
- **THE ADJUSTED HARNESS SHOULD CLOSELY FIT THE CHILD.**
- **NEVER LEAVE THE HARNESS BUCKLED WHEN NOT FITTED TO A CHILD IN THE STROLLER, BECAUSE THE HARNESS CAN FORM LOOPS WHICH MAY POSE A STRANGULATION HAZARD.**
- **WHEN HARNESS IS NOT IN USE, DISCONNECT SHOULDER STRAPS FROM THE WAIST STRAPS AND BUCKLE TO PREVENT STRANGULATION.**
- A five point harness is provided to restrain your child.
- Buckle tongues separate for added safety.
- To reconnect buckle tongues and to secure the child in the harness please follow the steps below carefully.

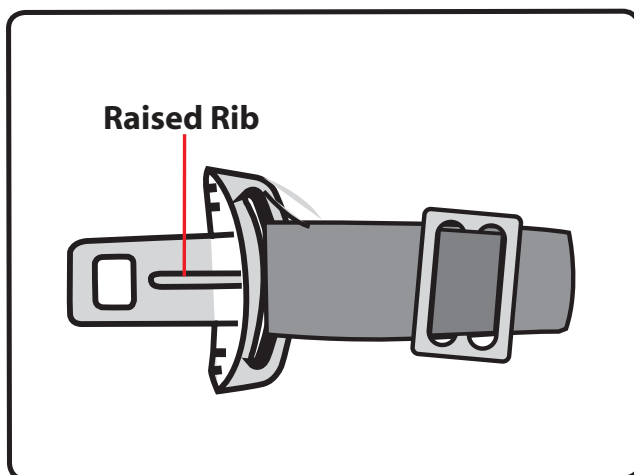

Please Note: Each waist buckle tongue has a raised rib on one side and can only be locked into the buckle assembly with the raised rib facing up.

16. TO SECURE YOUR CHILD IN THE HARNESS (Cont)

- A Always apply the brakes. Place child in seat. Slip one shoulder strap over each shoulder. Position crotch strap between legs. Push the buckle tongues (A) on waist straps through the tongue guides (B) on shoulder straps.

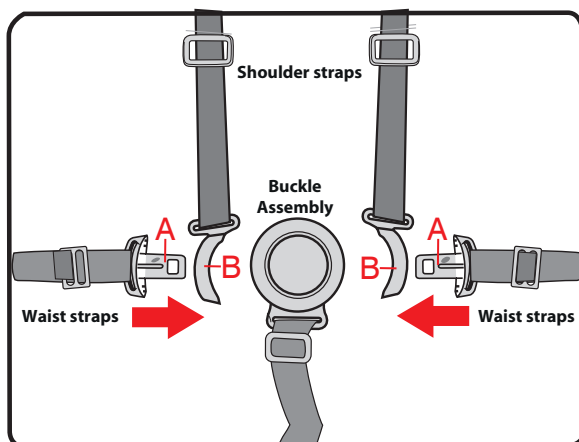

Please Note: Ensure the straps are not twisted as they may become uncomfortable for the child.

- B1 Hold the buckle tongue (A) on the waist strap & tongue guides (B) on shoulder straps together.

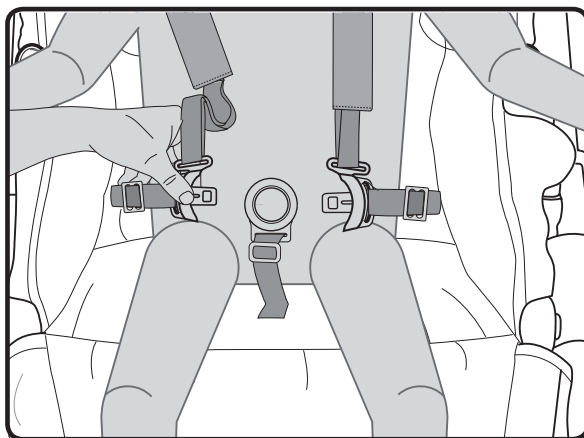

16. TO SECURE YOUR CHILD IN THE HARNESS (Cont)

- B2 Press in and hold the centre crotch buckle button and insert the waist buckle tongues into the crotch buckle assembly.

IMPORTANT: Pull on each waist buckle tongue to make sure they are locked into the crotch buckle assembly. If not, repeat above procedure.

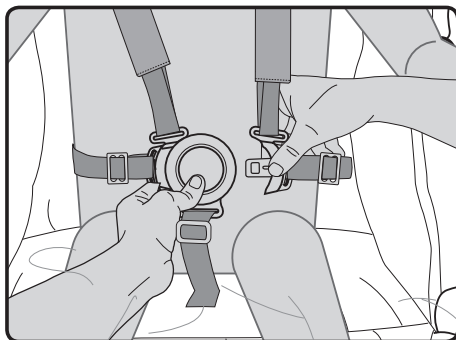

- C Tighten or loosen the shoulder straps and crotch strap by sliding the 3 bar harness adjuster up or down. The crotch strap should be adjusted to a snug fit.

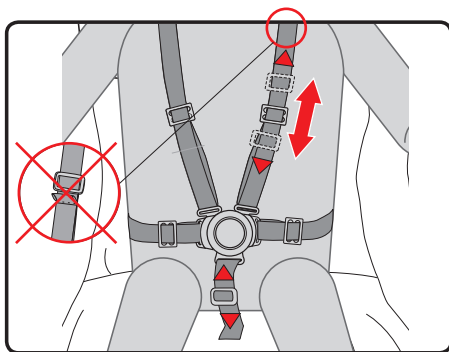

⚠ CAUTION: DO NOT SLIDE 3 BAR SLIDER OVER THE SEWN TAB ON SHOULDER HARNESS.

16. TO SECURE YOUR CHILD IN THE HARNESS (Cont)

- D Tighten or loosen the waist straps, hold and lift the 4 bar harness adjuster and pull the harness strap to adjust to the desired fit. The waist strap needs to fit firmly around the child.

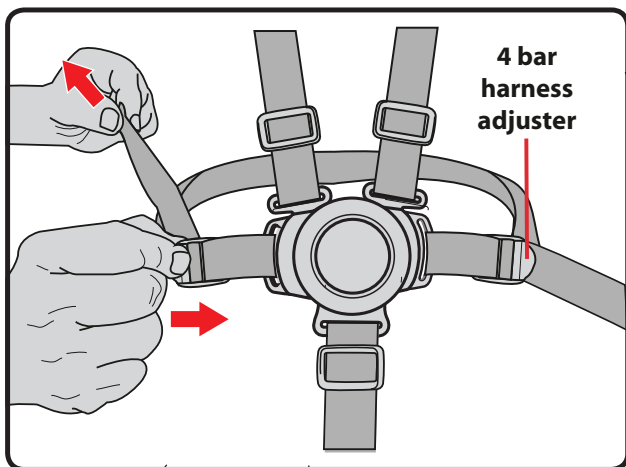

- E Release the harness by depressing the button in the centre of the buckle while pulling the two waist tongues away from the buckle assembly.

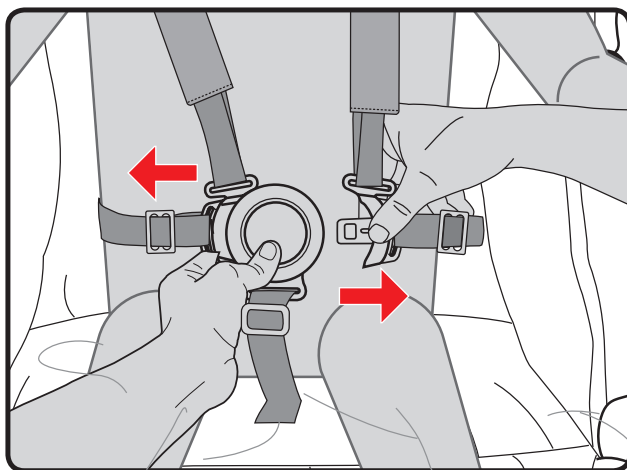

16. TO SECURE YOUR CHILD IN THE HARNESS (Cont)

- F The stroller seat has *2 or 3 sets of harness slots at different heights to accommodate the child. The shoulder straps must be positioned near the child's shoulders. To change the shoulder harness height, push the shoulder harness tongue out of the current harness slot and through the back of the seat and then pull the shoulder harness buckle tongue through the desired slot.

*Depending on the model

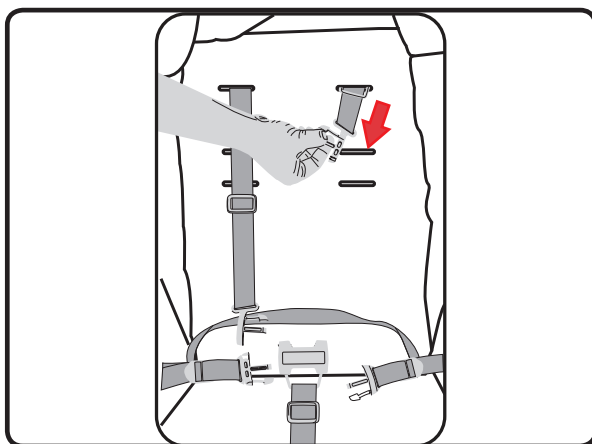
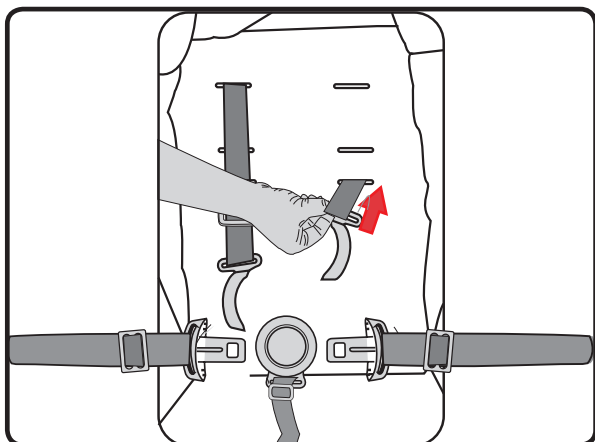

17. TO USE THE STROLLER

PLEASE REFER TO PAGE 6 FOR LIFTING TECHNIQUES.

- Always ensure you bend your knees where appropriate and take due care when lifting the frame.
- With your hand through the wrist tether strap loop, push the stroller holding the handle.
- The stroller can be steered in the desired direction - allowing the front wheels to swivel will make this easier.
- The front wheels may wobble or oscillate when walking fast. Locking the front swivel wheels will stop this.
- The stroller can be taken up kerbs by either pressing down on the handles and raising the front wheels or turning the stroller around and pulling the stroller up the kerb.
- Caution is required when pushing the stroller on a steep slope as the stroller may become unstable. Always hold the handles firmly.
- Do not run with the stroller.
- Whenever you stop, always apply the brakes before you leave the stroller.
- Do not hang bags or goods from the handle. Use the storage basket.

IMPORTANT NOTES:

PLEASE REFER TO PAGE 6 FOR LIFTING TECHNIQUES.

- REMOVE THE CHILD FROM THE STROLLER BEFORE COMMENCING ANY FOLDING OPERATION.
- FOLD THE STROLLER SLOWLY AND BE CAREFUL WHERE YOU PLACE YOUR HANDS.
- WHEN FOLDING THE STROLLER, BE AWARE OF THE DANGER OF BEING INJURED BY MOVING PARTS AND LOCKING DEVICES DURING THE PROCESS. KEEP ALL HANDS AND LIMBS CLEAR OF THESE PARTS.
- THERE IS POTENTIAL FOR FINGERS OR PARTS OF THE BODY TO BE INJURED WHEN THE STROLLER IS BEING FOLDED, DUE CARE SHOULD BE EXERCISED.
- KEEP CHILDREN CLEAR OF THE STROLLER DURING FOLDING THE STROLLER.

A To fold the stroller, the handle must be at the rear of the stroller in the child facing away from parent mode (where you're standing behind your child) See Step 13. Remove the boot cover & rain cover from the stroller (if fitted). The child tray can also be removed (if fitted) for a more compact fold.



18. TO FOLD THE STROLLER (Cont)

- B To prevent the canopy back flap from dragging on the ground when the stroller is folded, either (A1) remove the back flap by opening the zipper at the top of the back flap, then close the canopy, or (A2) tuck the bottom of the canopy back flap into the small mesh pocket on the backrest, then close the canopy.

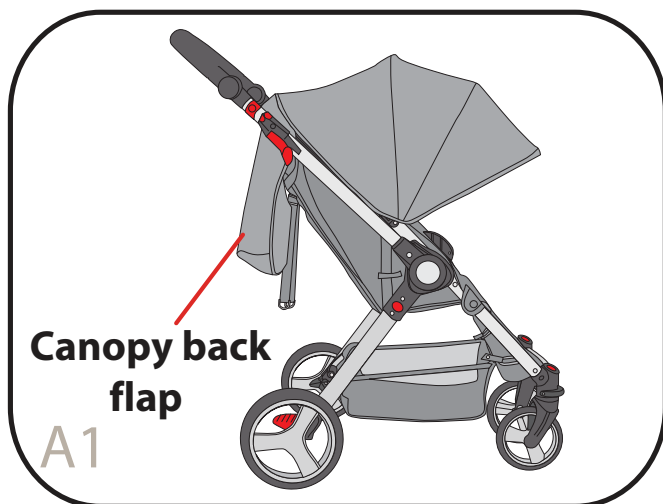

18. TO FOLD THE STROLLER (Cont)

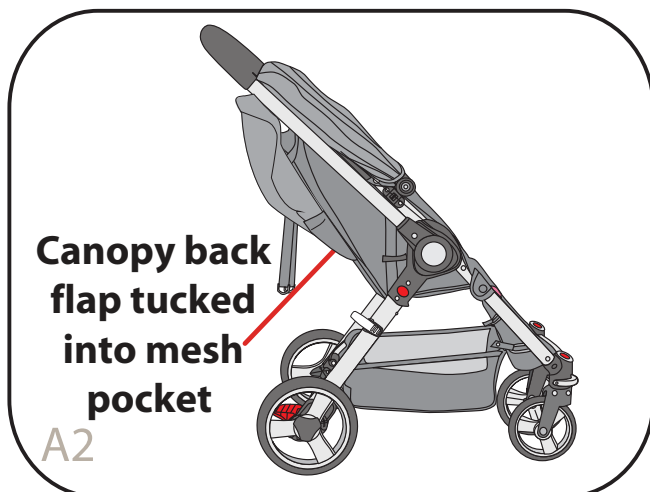

- B** Before folding stroller ensure leg rest is in the lowest position and ensure the pivotal handle is in the highest position.

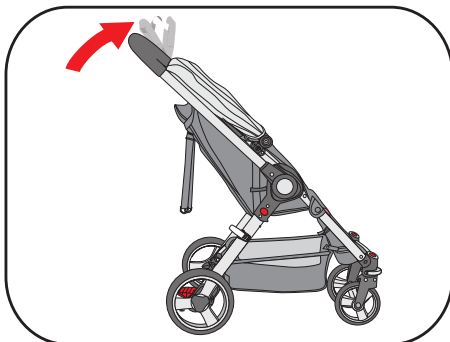
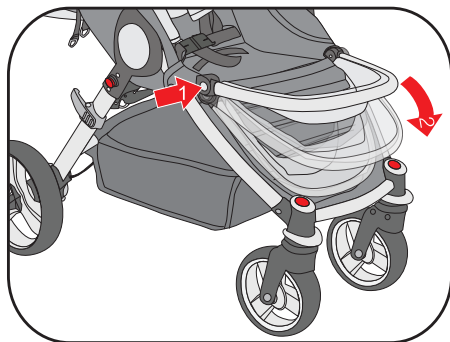

PLEASE NOTE: When folding the stroller, lower the leg rest all the way down so the hook & loop tabs under the leg rest fasten together. This will prevent the leg rest from any damage during folding.

18. TO FOLD THE STROLLER (Cont)

- C Press the **RED** Sure Lock release button (1) located on the right hand side of the stroller. With the other hand pull up the folding strap (2) as shown by the arrow. The stroller will now fold.

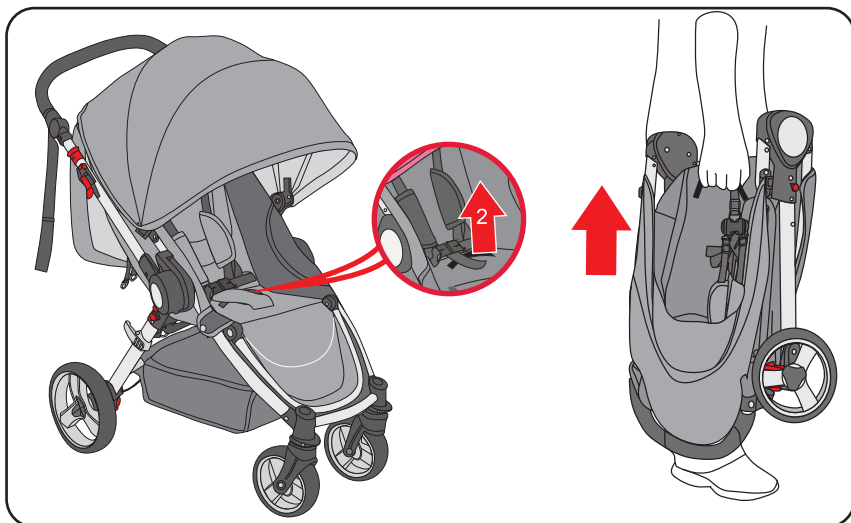

- D Lock the frame together with the storage latch. A carry handle is supplied for ease of transport when stroller is fully folded.

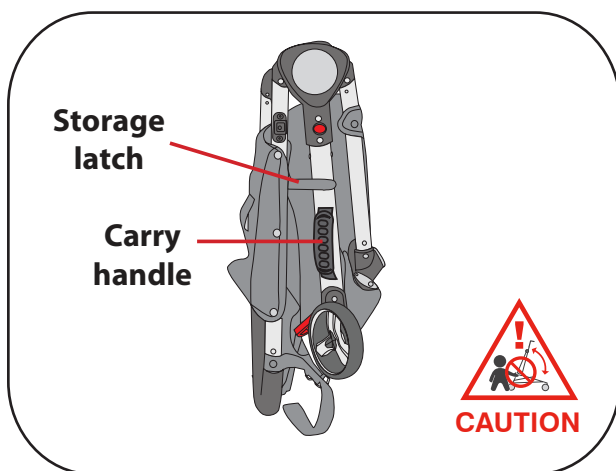

IMPORTANT NOTES:

PLEASE REFER TO PAGE 6 FOR LIFTING TECHNIQUES.

- TO AVOID INJURY: BEND YOU KNEES WHEN OPENING, LIFTING, CARRYING, FOLDING, UNFOLDING OR ADJUSTING THE STROLLER OR ANY ACCESSORIES.
- TO LIFT THE STROLLER, GRASP THE CARRY HANDLE SO THE STROLLER IS BALANCED.

A Ensure the storage latch is locked onto the frame before lifting the stroller. To lift the stroller grasp the carry handle, so the stroller is balanced.

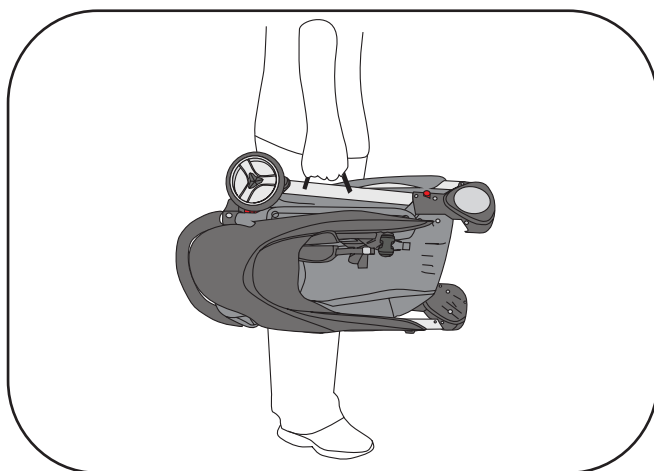

Note: Only use the handle to carry the stroller.

19. INFANT CARRIER WARNINGS & IMPORTANT NOTES (Infant Carriers sold separately)

WARNINGS:

- **IT IS UNSAFE TO USE ACCESSORIES NOT APPROVED FOR USE WITH THIS STROLLER.**
- **DO NOT USE ANY ACCESSORIES OTHER THAN THOSE APPROVED FOR USE WITH THIS STROLLER BY BRITAX.**
- **THE MAXIMUM WEIGHT OF THE CHILD USING THE STEELCRAFT INFANT CARRIER IS NOT TO EXCEED 9kg.**
- **THE MAXIMUM WEIGHT OF THE CHILD USING THE SAFE N SOUND UNITY INFANT CARRIER IS NOT TO EXCEED 12kg.**

IMPORTANT NOTES:

- THE STEELCRAFT INFANT CARRIER AND THE SAFE N SOUND UNITY INFANT CARRIER ARE THE ONLY COMPATIBLE INFANT CARRIERS DESIGNED TO FIT THE AGILE, AGILE PLUS & AGILE TWIN STROLLERS
- THE INFANT CARRIER MUST BE CORRECTLY FITTED AND LOCKED ONTO THE STROLLER.
- WHEN LOCKED ONTO THE STROLLER FRAME, THE INFANT CARRIER MUST ONLY BE USED IN THE REARWARD FACING POSITION. (FITTED FACING TOWARD THE STROLLER HANDLE AND FACING THE MOTHER.)
- SECURE THE CHILD USING THE INFANT CARRIER HARNESS AT ALL TIMES
- DO NOT LEAVE CHILD IN THE INFANT CARRIER FOR EXTENDED PERIODS.

19. INFANT CARRIER WARNINGS & IMPORTANT NOTES (Infant Carriers sold separately)

IMPORTANT NOTES:

- THE INFANT CARRIER IS DESIGNED TO PROVIDE MOBILITY OUTSIDE OF THE CAR BUT IT SHOULD NOT BE USED INSTEAD OF AN APPROPRIATE COT.
- THE INFANT CARRIER MUST BE REMOVED FROM THE FRAME BEFORE FOLDING.
- THE SUN IS VERY STRONG. DO NOT LEAVE YOUR CHILD EXPOSED TO THE SUN. THE CANOPY OR HOOD ON THIS PRODUCT WILL NOT GIVE YOUR CHILD TOTAL PROTECTION FROM THE HARMFUL RAYS OF THE SUN.

IMPORTANT NOTE: TRAY (supplied) OR ARMBAR (sold separately) BEFORE INSTALLING THE STEELCRAFT OR UNITY INFANT CARRIER ON THE STROLLER, THE ARMBAR OR TRAY MUST BE REMOVED.

PLEASE NOTE: THESE INSTRUCTIONS ARE FOR INSTALLING AND REMOVING THE INFANT CARRIER ON THE STROLLER ONLY. FOR INSTALLING AND PROPER USE OF THE INFANT CARRIER IN THE CAR, PLEASE FOLLOW THE INSTRUCTION BOOK PROVIDED WITH THE INFANT CARRIER.

19. INFANT CARRIER WARNINGS & IMPORTANT NOTES (Cont) **(Infant Carriers sold separately)**

INSTALLATION OF UNITY INFANT CARRIER

IMPORTANT NOTES:

- AGILE CLICK & GO RECEIVERS (sold separately) ARE REQUIRED FOR INSTALLATION OF THE 40A/2010 SERIES & 40A/2013 SERIES SAFE N SOUND UNITY INFANT CARRIER TO THE AGILE STROLLER.
- THE 40A/2010 SAFE N SOUND UNITY INFANT CARRIER ALSO REQUIRES BRITAX STROLLER ADAPTORS (sold separately) FOR INSTALLATION TO THE AGILE STROLLER.
- PLEASE REFER TO AGILE CLICK & GO RECEIVERS INSTRUCTION LEAFLET FOR THE CORRECT INSTALLATION OF THE RECEIVERS AND UNITY INFANT CARRIER TO THE STROLLER.
- PLEASE REFER TO BRITAX STROLLER ADAPTORS INSTRUCTION LEAFLET FOR THE CORRECT INSTALLATION OF THE ADAPTORS TO THE 40A/2010 SAFE N SOUND UNITY INFANT CARRIER.

20. TO INSTALL THE STEELCRAFT INFANT CARRIER

- A Stand in front of the stroller and pull the fabric back from the sides of the stroller to expose the stroller hinge. Take one car seat receiver at a time and insert the receiver into the stroller hinge as shown. Push on the receiver until you hear a 'click' which indicates the receiver has locked in. Pull up on each receiver to check they have fully locked in.

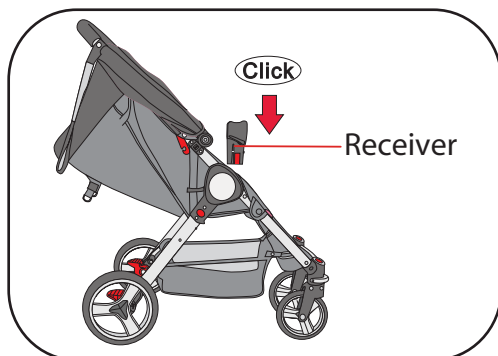

Please Note: Fit receivers standing in front of the stroller. Car seat receivers are marked Left & Right for correct fitting.

- B Face the feet end of the Infant Carrier towards the stroller backrest. With the Infant Carrier handle in the upright position, locate the Infant Carrier handle mouldings over the receivers on either side. Notice the indicator is GREEN.

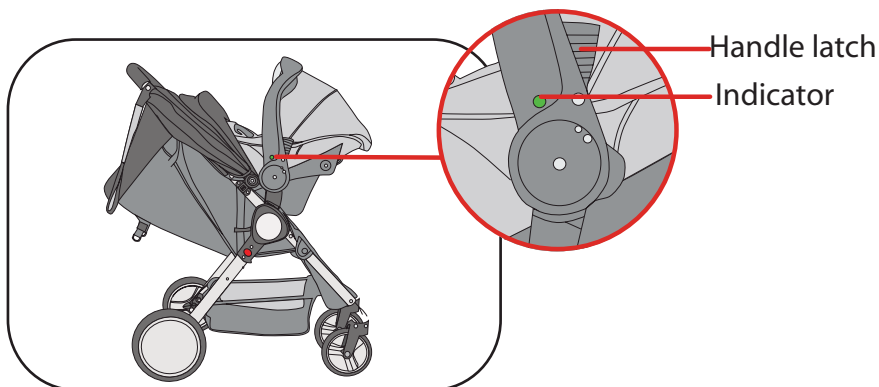

20. TO INSTALL THE STEELCRAFT INFANT CARRIER (Cont)

- C Lower the Infant Carrier into the receivers. Press down firmly on both sides.



- D The Infant Carrier now needs to be locked securely into the receivers. Squeeze in and hold the latches on either side of the handle, rotate the handle backwards. The GREEN indicator will now turn to RED.

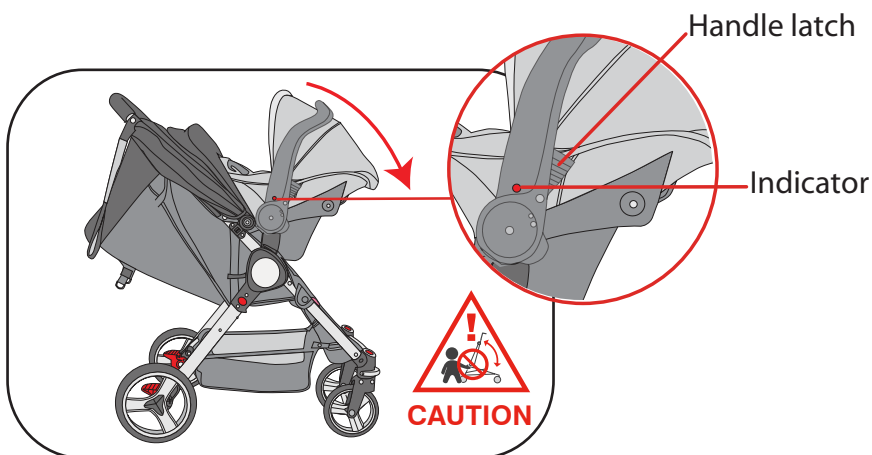

20. TO INSTALL THE STEELCRAFT INFANT CARRIER (Cont)

- E Release the handle latches. Then with one hand holding the front of the Infant Carrier, push the Infant Carrier handle all the way down until you hear it lock into the receivers. The handle indicator should now be GREEN and the Infant Carrier should be locked into the receivers. If the indicator is RED the Infant Carrier handle is not in the locked position, repeat step D.

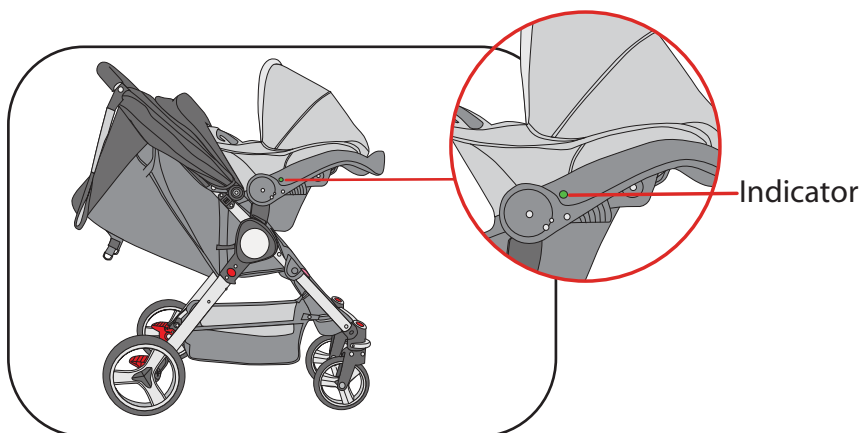

IMPORTANT: Ensure that the Infant Carrier is locked into place by pulling up on both sides. Do not use the Infant Carrier if it is not correctly installed.

NOTE: Ensure the baby is secured in the Infant Carrier with the harness at all times. Refer to the Infant Carrier instructions regarding placing and securing your baby in the Infant Carrier. The Infant Carrier has been fitted with a hood when using the stroller. The hood may also be used in the car.

21. TO RELEASE THE INFANT CARRIER

- A To remove the Infant Carrier, squeeze both handle latches in to release the locks. The indicator will now be RED.

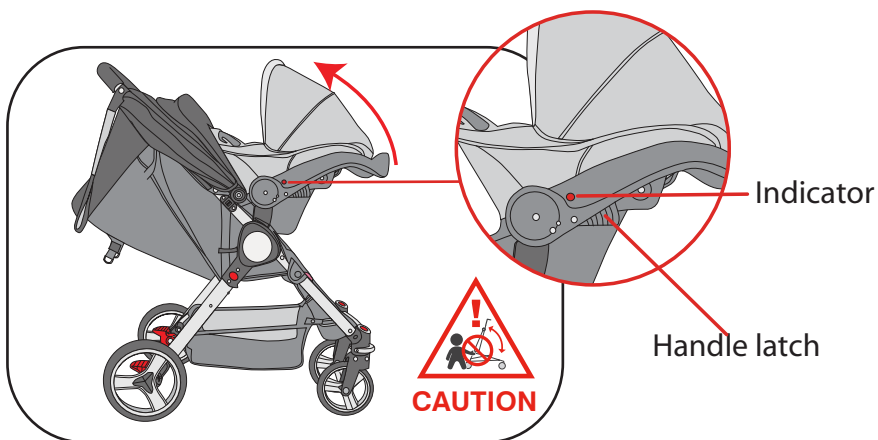

- B Continue to rotate the handle forward until it returns to the upright position. Release the latches, the indicator should now be GREEN.

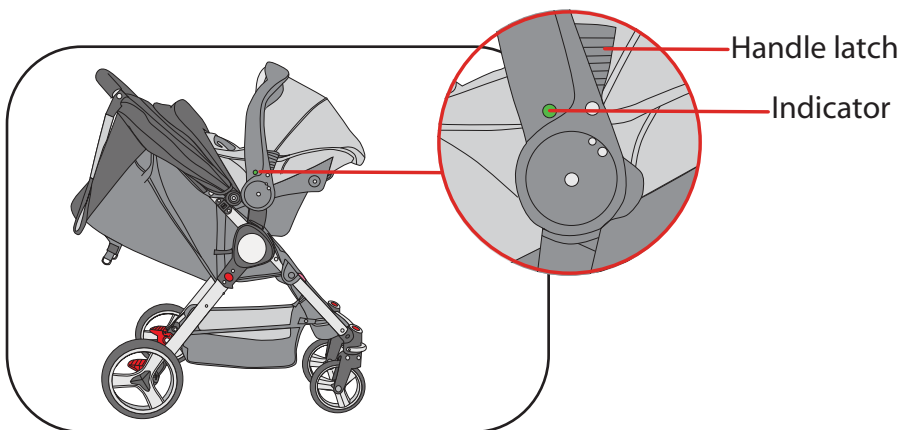

21. TO RELEASE THE INFANT CARRIER

- C Lift and remove the Infant Carrier away from the stroller.

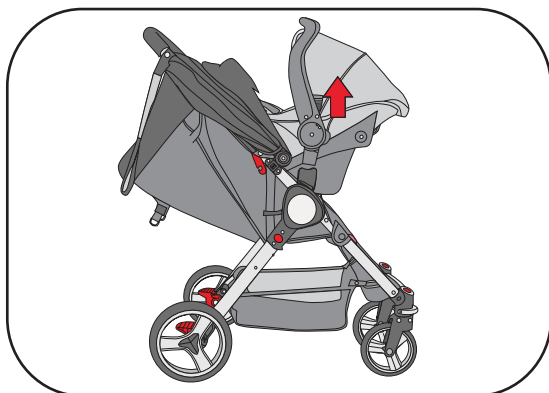

- D To remove the receivers, press the red button in on the inside of the receiver and pull the receiver up.

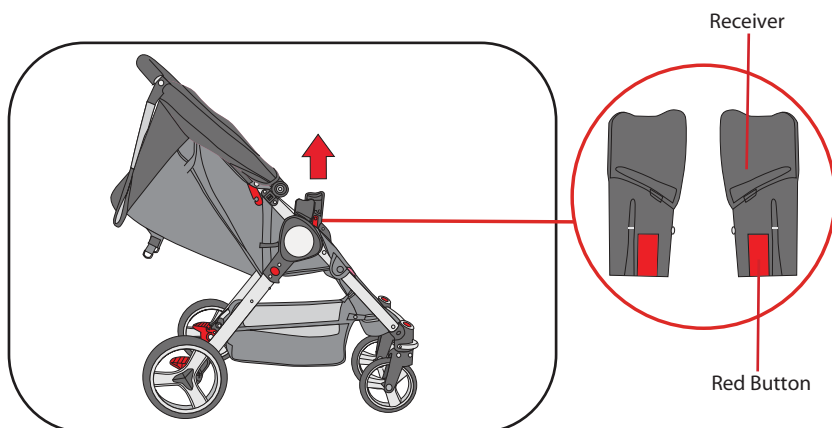

CARE AND MAINTENANCE

- To prolong the life of your stroller keep it clean and do not leave it in the direct sunlight or in the car boot for extended periods of time.
- Removable fabric covers and trims may be cleaned using warm water with a household soap or mild detergent. Allow it to dry fully, preferably away from the direct sunlight.
- Non removable fabric covers and trims may be spot cleaned using a damp sponge with soap or a mild detergent. Allow it to dry completely before folding or storing it away.
- In some climates the covers and trims may be affected by mould and mildew. To help prevent this occurring, do not fold or store the product if it is damp or wet. Always store the product in a well ventilated area.
- When using your stroller at the beach - completely clean your stroller afterwards to remove the sand and salt from the mechanisms and wheel assembly. Sand and salt will cause premature wear and corrosion.
- If there are compression marks on the tyres - Use a domestic hair dryer to gently warm (DO NOT OVERHEAT) the tyre and the compression marks should slowly disappear.
- Always check parts regularly for tightness of screws, nuts, and other fasteners - tighten if required. To maintain the safety of your nursery product, seek prompt repairs for bent, torn, worn or broken parts.

THIS PRODUCT IS NOT INTENDED FOR COMMERCIAL USE.

BRITAX CHILDCARE PTY. LTD A Britax International company.
(Incorporated in Victoria) A.B.N. 55 006 773 600
99 Derby Road, Sunshine, Victoria, 3020, Australia
Phone: (03) 9288 7288 Fax: (03) 9311 5798

Due to our continuing program of development, Britax Reserves the right to alter these specifications, colour or design without any further notice.

The Steelcraft trademark is the property of Britax Childcare Pty. Ltd - Australia.

The Britax trademark is the property of Britax Childcare Holdings Limited - UK

Visit the Britax website www.britax.com.au or email is at au-custserv@britax.com

Due to the variations in the style and design of our products the illustrations used in this instruction booklet are generic.

This product is designed to comply with Australian and New Zealand standards AS/NZ2088:2013 "Prams and Strollers - Safety Requirements."

©2010-2013 Copyright Britax Childcare Pty. Ltd. Australia