

SteelcraftTM

EZ ride LIGHTWEIGHT STROLLER

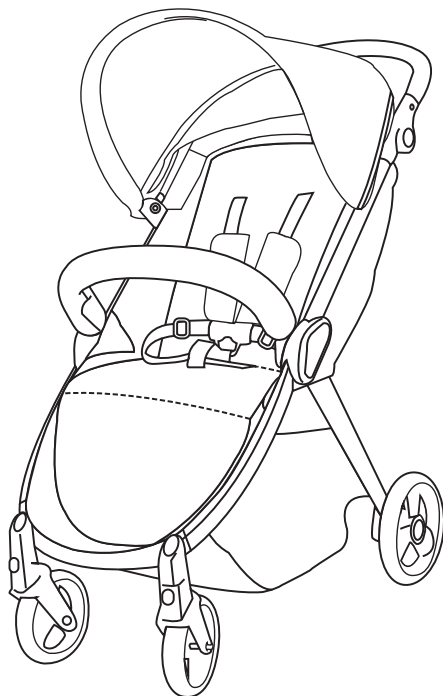

IMPORTANT: KEEP THIS BOOKLET IN A SAFE PLACE FOR FUTURE REFERENCE.

www.britax.com.au

Series LX5016

IMPORTANT NOTES

IMPORTANT NOTES:

**ALWAYS FOLLOW THE MANUFACTURERS INSTRUCTIONS.
READ ALL INSTRUCTIONS CAREFULLY BEFORE ASSEMBLY AND USE
OF THIS STROLLER.
THE CORRECT USE AND MAINTENANCE OF THIS PRODUCT IS
ESSENTIAL.**

- **USE GREAT CARE WHEN USING THE STROLLER ON STAIRS, ESCALATORS, TRAVELATORS OR OTHER MOVING SURFACES.**
- **IT IS RECOMMENDED TO REMOVE THE CHILD FROM THE STROLLER BEFORE GOING UP OR DOWN STAIRS OR ESCALATORS.**
- **DO NOT LIFT THE STROLLER BY THE ARM BAR OR TRAY BECAUSE IT MAY DISENGAGE.**
- **DO NOT ALLOW CHILDREN TO STAND ON THE SEAT.**
- **DO NOT HANG BAGS OR GOODS FROM THE HANDLE AS THIS COULD CAUSE THE STROLLER TO TIP OVER.**
- **DO NOT LEAVE THE STROLLER AND ITS ACCESSORIES NEAR AN OPEN FIRE OR EXPOSED FLAME.**
- **DO NOT PLACE MORE THAN 5KG IN THE BASKET, OR 1KG IN THE CANOPY POCKET (IF SUPPLIED).**

WARNINGS

WARNINGS: TO AVOID INJURY OR DEATH:

ALWAYS APPLY THE BRAKES WHENEVER THE STROLLER IS STATIONARY.

- **DO NOT LEAVE CHILDREN UNATTENDED.**
- **SECURE THE CHILD IN THE HARNESS AT ALL TIMES.**
- **DO NOT CARRY EXTRA CHILDREN OR BAGS ON THIS STROLLER.**
- **MAKE SURE CHILDREN ARE CLEAR OF ANY MOVING PARTS IF YOU ADJUST THE STROLLER.**
- **DO NOT USE ANY ACCESSORIES OTHER THAN THOSE APPROVED FOR USE WITH THIS STROLLER BY BRITAX.**
- **IT IS UNSAFE TO USE ACCESSORIES NOT APPROVED FOR USE WITH THIS STROLLER.**
- **THE MAXIMUM WEIGHT OF THE CHILD USING THIS STROLLER IS NOT TO EXCEED 20 KG.**



CAUTION

This **CAUTION** Symbol is shown at certain steps in this Instruction Manual to highlight the danger of being injured by moving parts.

MANUAL HANDLING TECHNIQUES

The SMART lifting technique

This technique can be used to pick up small light loads from low levels.

Size up the Load

- Assess the load (size, shape and weight).
- Assess whether the load needs to be moved;
- Where is it going to be placed” Check that there are no obstructions;
- Assess whether mechanical or human assistance is required.

Move the Load as close to the body as possible

- A load is heavier to lift or carry if it is not close to the body.
- The whole hand should be used to ensure a firm grip.

Always bend your knees

- Maintain balance.
- Keep feet apart and in a comfortable position.
- Minimise lower back bending.
- Bend knees preferable at as large an angle as possible but not at a right angle - use a semi squat in preference to a full squat.

Raise the load with your legs

- Achieve the lift smoothly and without jerkiness.
- Maintain the normal curvature of the spine to allow the force of the load to be distributed evenly from the spine to the pelvis.

Turn your feet in the direction that you want to move the load.

- Avoid unnecessary bending, twisting and reaching.
- Change direction by turning your feet and not your back.
- To set the load down, squat down, keep your head up and let your legs do the work.

Remember to ‘THINK TALL’ chest lifted, shoulders relaxed, chin tucked in and head level.

PARTS LIST

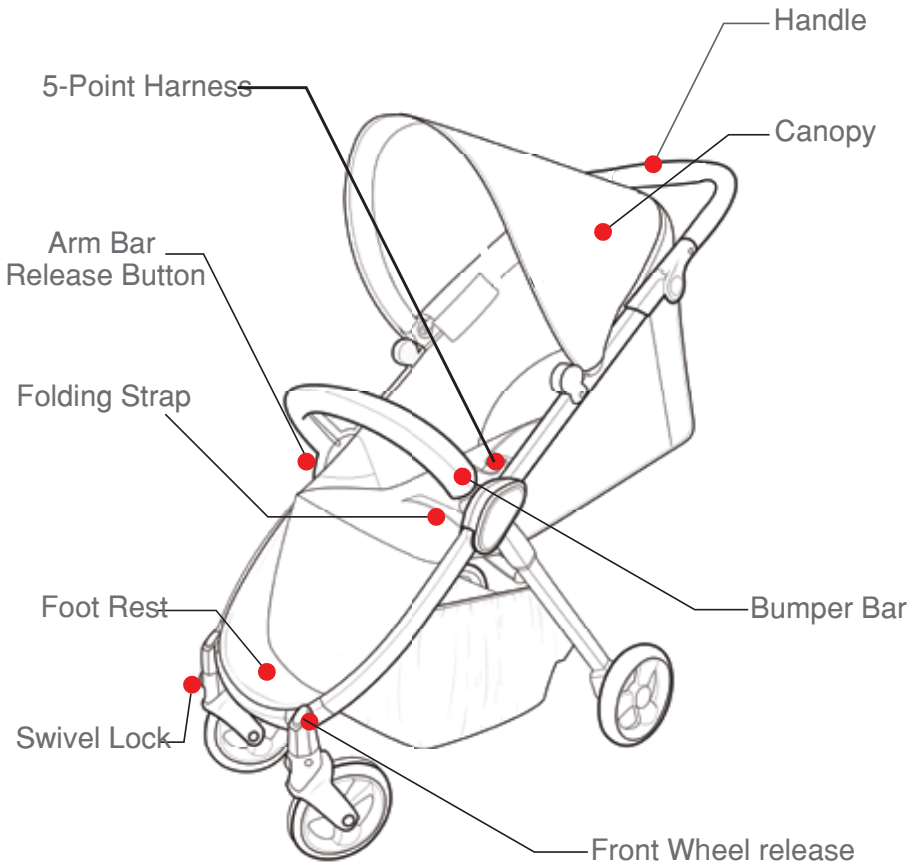

PARTS LIST

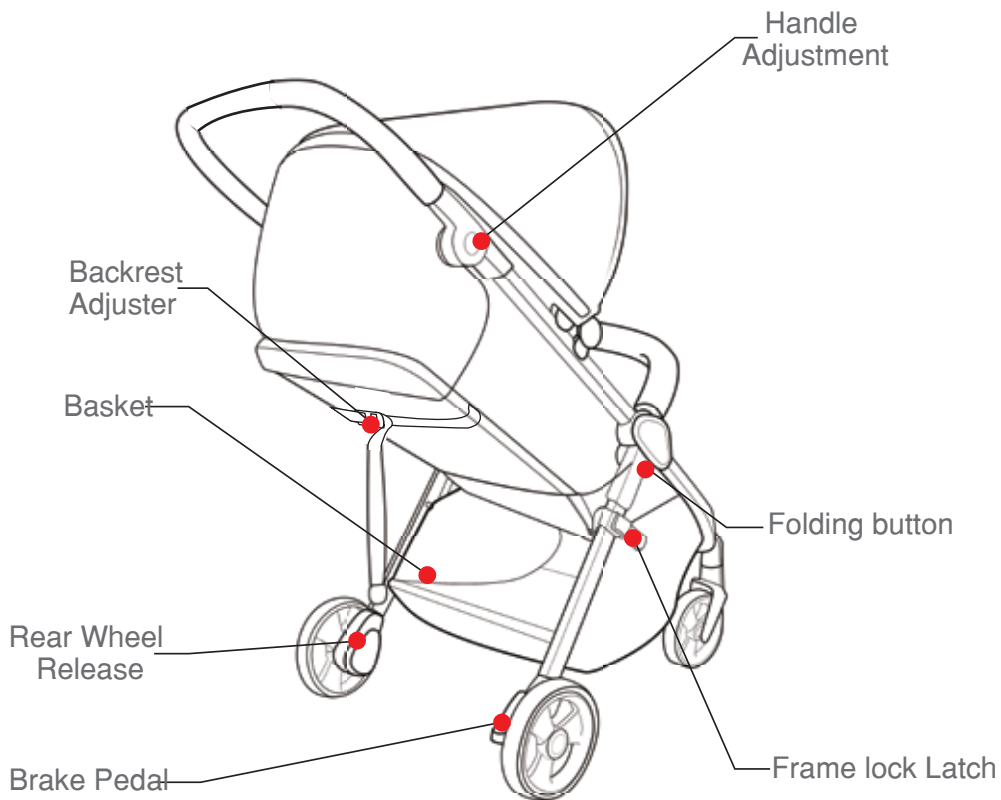

STROLLER ASSEMBLY

OPENING THE STROLLER FRAME

IMPORTANT NOTES:

PLEASE REFER TO PAGE 4 FOR SMART LIFTING TECHNIQUES.

- RELEASE THE FRAME LOCK LATCH WITH DUE CARE AND OPEN THE FRAME.
- WHEN OPENING THE STROLLER, BE AWARE OF THE DANGER OF BEING INJURED BY MOVING PARTS AND LOCKING DEVICES DURING THE PROCESS. KEEP ALL HANDS AND LIMBS CLEAR OF THESE PARTS.
- THERE IS POTENTIAL FOR FINGERS OR PARTS OF THE BODY TO BE INJURED WHEN THE STROLLER IS BEING UNFOLDED, DUE CARE SHOULD BE EXERCISED.
- KEEP CHILDREN CLEAR OF THE STROLLER WHEN UNFOLDING THE STROLLER.
- OPEN THE STROLLER SLOWLY AND BE CAREFUL WHERE YOU PLACE YOUR HANDS. KEEPING YOUR HANDS ON THE HANDLE IS THE BEST WAY TO UNFOLD THE STROLLER.

- A Release the frame lock latch (1) located on the rear leg.
- B Open the frame as shown by the arrows (2) until you hear a 'click' which indicates the frame is fully opened and locked. Push down on the stroller handle to confirm that the frame is locked.

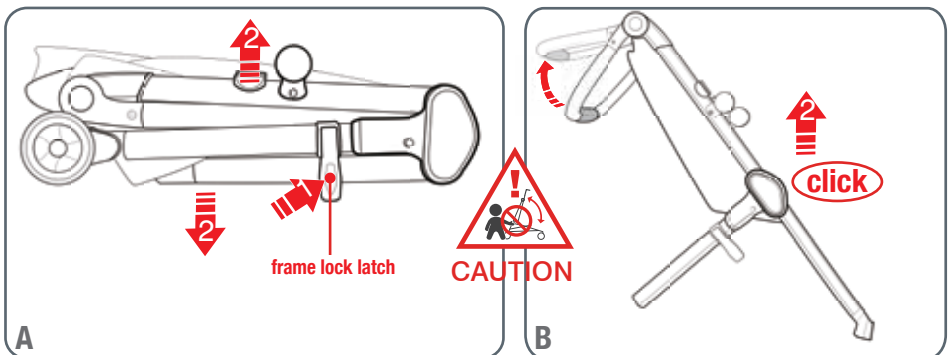

STROLLER ASSEMBLY

ATTACHING AND REMOVING THE FRONT SWIVEL WHEELS

- A** To attach each front swivel wheel, insert the swivel wheel and push it into the wheel moulding until you hear a 'click' which indicates the wheel is locked in. Pull on each wheel to make sure it is engaged. Repeat the process if not locked in.
- B** To remove each front swivel wheel, press the grey quick release button on the top of the front leg mouldings.

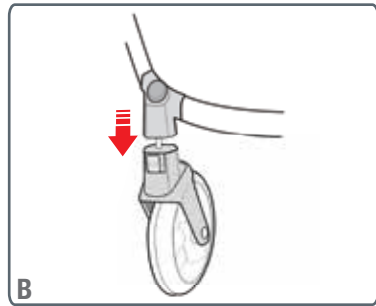
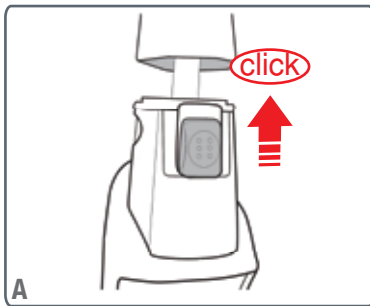

ATTACHING AND REMOVING THE FRONT REAR WHEELS

- A** Insert each wheel axle into the moulding and push in until locked. You should hear a 'click' which indicates the wheel has locked in. Pull on the wheel to make sure it is engaged. Repeat the process if not locked in.
- B** To remove the wheels, pull the metal latch downwards on the underneath of the rear wheel moulding to release the wheel, and then pull the wheel off.

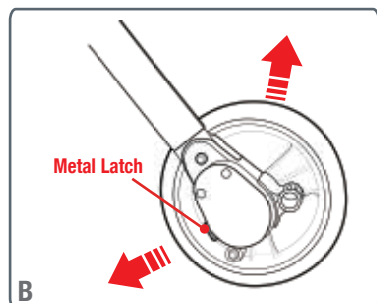
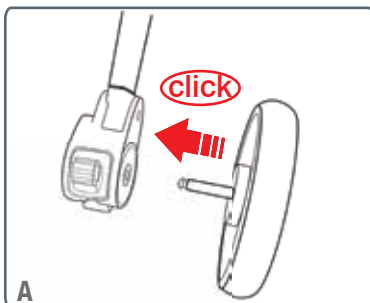

STROLLER ASSEMBLY

ATTACHING THE CANOPY

IMPORTANT NOTE:

The sun is very strong. **DO NOT LEAVE YOUR CHILD EXPOSED TO THE SUN.** The canopy or hood on this product will not give your child total protection from the harmful rays of the sun.

- A To attach the canopy, slide the canopy mouldings (as shown by the arrow) into the frame mouldings until they lock together.
- B Attach the hook strip (1) on the outside edge of the canopy to the loop strip (2) on the inside edge of the stroller seat side panel.

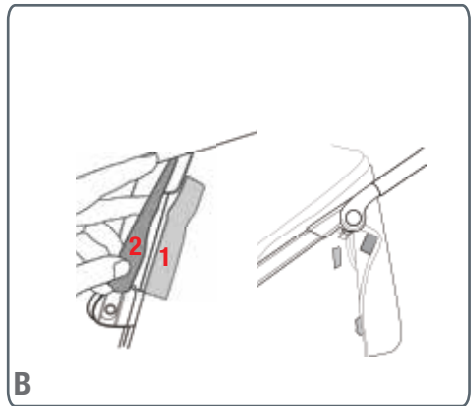
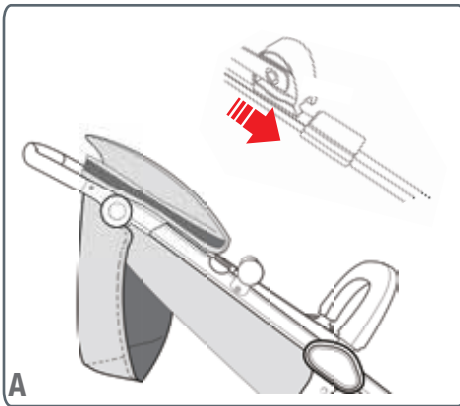

- C To adjust the canopy, open by pulling forward, or close by pushing it backward.

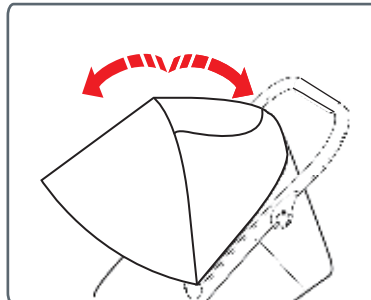

STROLLER ASSEMBLY

ATTACHING THE CANOPY

- D** To use the peek a boo window in the canopy back flap, lift the window cover which is held in place by hook and loop tabs. Roll the canopy window flap up and secure with the elastic loop and toggle.

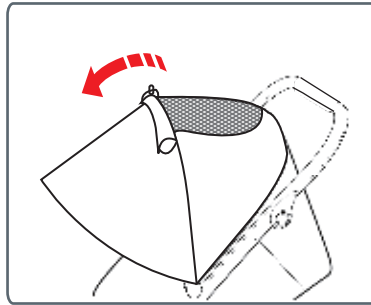

- E** To remove the canopy, slide the canopy mouldings (as shown by the arrow) out of the frame mouldings.

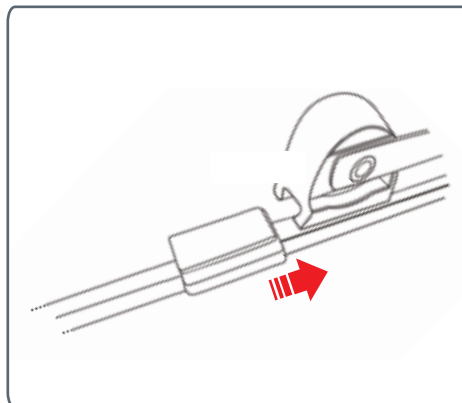

STROLLER ASSEMBLY

ATTACHING THE ARM BAR

! **WARNING:** WHEN A CHILD IS IN THE STROLLER KEEP THE ARM BAR ATTACHED TO THE ADAPTORS AT ALL TIMES.

- A** Stand beside the stroller and pull the fabric back from the sides of the stroller to expose the stroller hinge. Slide the arm bar mouldings onto the stroller hinge (as shown by the arrow) until you hear a 'click' which indicates the arm bar has locked in. Pull up on the arm bar to ensure it has fully locked in.

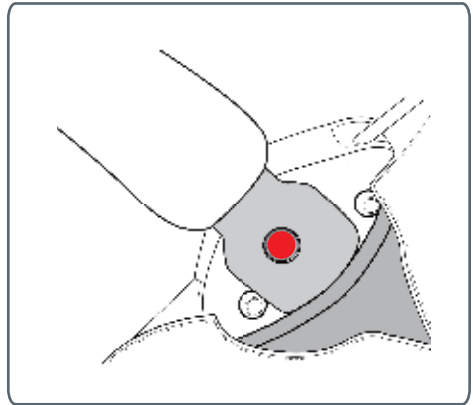
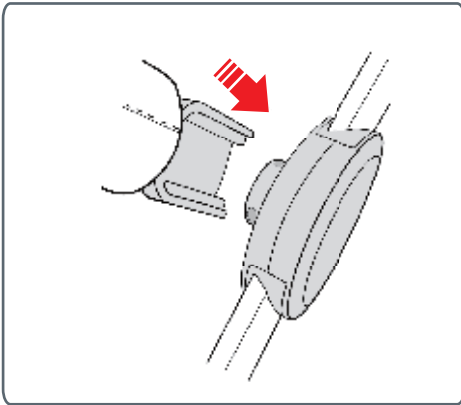

- B** To remove the arm bar, push the red quick release tabs in on the inside of each stroller hinge and slide the arm bar out of the stroller.

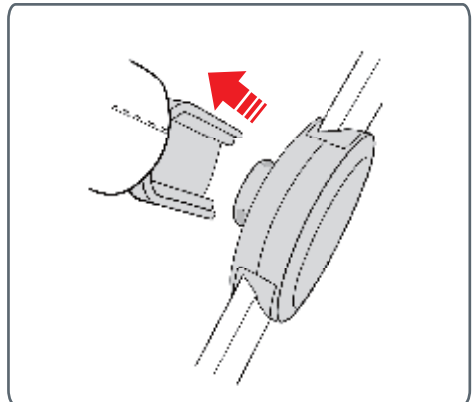
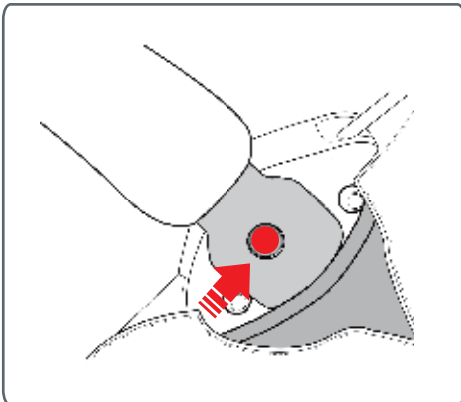

STROLLER OPERATION

USING THE BRAKES

 **WARNING:** ALWAYS APPLY THE BRAKES WHEN THE STROLLER IS STATIONARY.

A The red brake lever is located on the right hand side of the stroller beside the rear wheel.

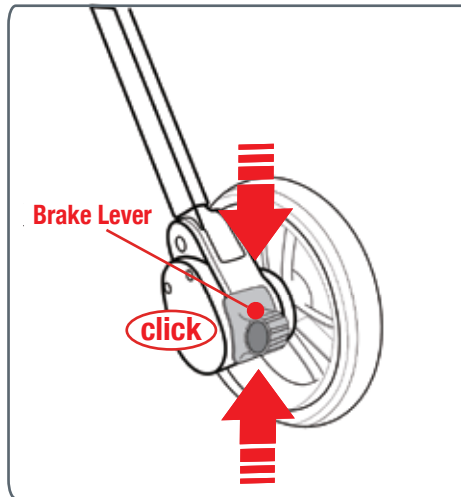

B To lock the rear wheels, press the brake lever down until you hear a 'click'. Push the stroller back and forth to confirm the wheels are locked. If not locked, repeat this step.

C To unlock the rear wheels, push the brake lever up until you hear a 'click'.

STROLLER OPERATION

USING THE FRONT SWIVEL WHEELS

PLEASE NOTE: Always lock the swivel wheels when using the stroller on rough surfaces as this will minimise wheel wobble.

The swivel wheels should only be locked when the wheels are in the trailing position (wheels under frame).

- A** To lock the swivel wheels, push the swivel lock up on the front of each wheel until you hear a 'click'.
- B** To allow the wheels to swivel, push the swivel lock down on the front of each wheel until you hear a 'click'.

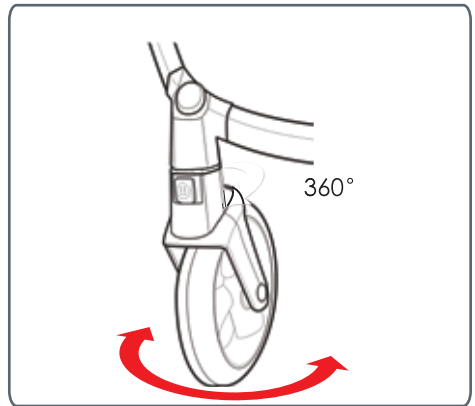
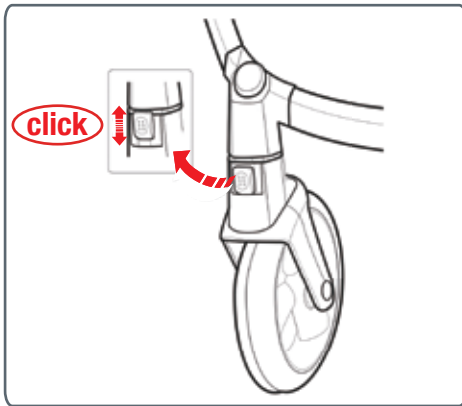

STROLLER OPERATION

ADJUSTING THE BACKREST

WARNINGS:

- **THE UPRIGHT POSITIONS ARE NOT SUITABLE FOR USE WITH CHILDREN LESS THAN 6 MONTHS OLD.**
- **THE LOWEST RECLINE POSITION SHOULD BE USED TO TRANSPORT BABIES. THE BACKREST CAN BE ADJUSTED TO A MORE UPRIGHT POSITION AS THE CHILD GROWS OLDER AND IS ABLE TO SUPPORT ITS HEAD WITHOUT ASSISTANCE.**

PLEASE NOTE: If the child is sitting in the seat, support the backrest as it reclines. If you have difficulty adjusting the backrest you may need to remove the child from the seat to allow you to raise or lower the backrest with ease.

A To raise the backrest, grasp the plastic slider and with the other hand pull the strap until you reach the desired position.

B To lower the backrest, support the backrest with one hand and with the other hand pull the plastic slider to the left to extend the strap until you reach the desired position.

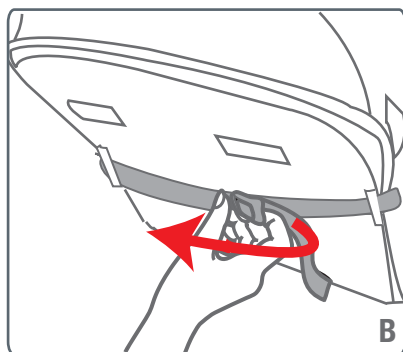
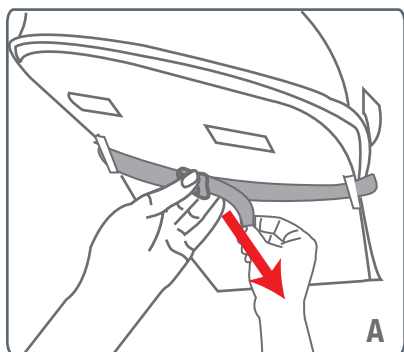

STROLLER OPERATION

ADJUSTING THE PIVOTAL HANDLE

- A** To adjust the handle height, squeeze in and hold the buttons on the outside of the handle. Rotate the handle up or down to the desired position then release the buttons.

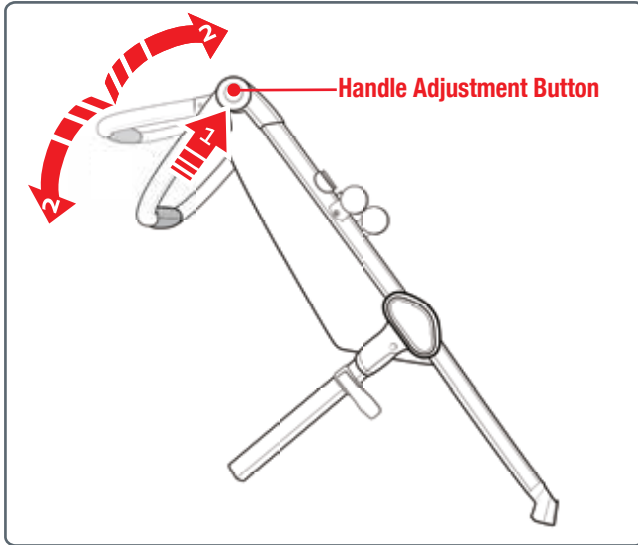

STROLLER OPERATION

USING THE TETHER STRAP

! **WARNINGS:** USE THE TETHER STRAP TO STOP THE STROLLER ROLLING AWAY.

- THE STROLLER IS DESIGNED FOR USE ON FLAT OR GENTLY SLOPING SURFACES, AND MAY BE UNSTABLE ON HIGHER SLOPING AND UNEVEN SURFACES AND USERS SHOULD BE AWARE OF THE POSSIBILITY OF THE STROLLER ROLLING AWAY OR TIPPING OVER.
- NEVER LET GO OF THE STROLLER WHEN PARKED ON AN INCLINE OR SLOPING SURFACE BECAUSE IT MAY SLIDE OR TIP OVER. ALWAYS PARK ON A FLAT SURFACE AND APPLY THE BRAKES.
- ALWAYS APPLY THE BRAKES WHENEVER THE STROLLER IS STATIONARY.

A A wrist tether strap is provided on the handle grip. Slide your hand through the tether strap loop whenever you use the stroller. Only remove your hand from the tether strap loop when the brakes have been applied to the stroller wheels.

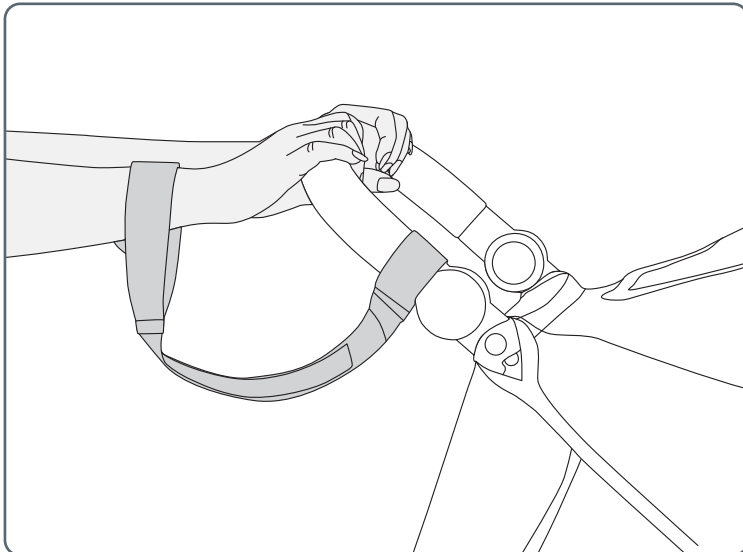

STROLLER OPERATION

USING THE HARNESS

 **WARNING:** USE THE HARNESS AT ALL TIMES.

- ENSURE YOUR CHILD IS SECURED WITH A CORRECTLY ADJUSTED HARNESS.
- THE ADJUSTED HARNESS SHOULD CLOSELY FIT THE CHILD.
- NEVER LEAVE THE HARNESS BUCKLED WHEN NOT FITTED TO A CHILD IN THE STROLLER, BECAUSE THE HARNESS CAN FORM LOOPS WHICH MAY POSE A STRANGULATION HAZARD.
- WHEN HARNESS IS NOT IN USE, DISCONNECT SHOULDER STRAPS FROM THE WAIST STRAPS AND BUCKLE TO PREVENT STRANGULATION.
- A five point harness is provided to restrain your child.
- Buckle tongues separate for added safety.
- To reconnect buckle tongues and to secure the child in the harness please follow the steps below carefully.

A Always apply the brakes on the stroller when placing the child in the stroller. Slip one shoulder strap over each shoulder. Position crotch strap between legs.

PLEASE NOTE: Ensure the straps are not twisted as they may become uncomfortable for the child.

STROLLER OPERATION

USING THE HARNESS

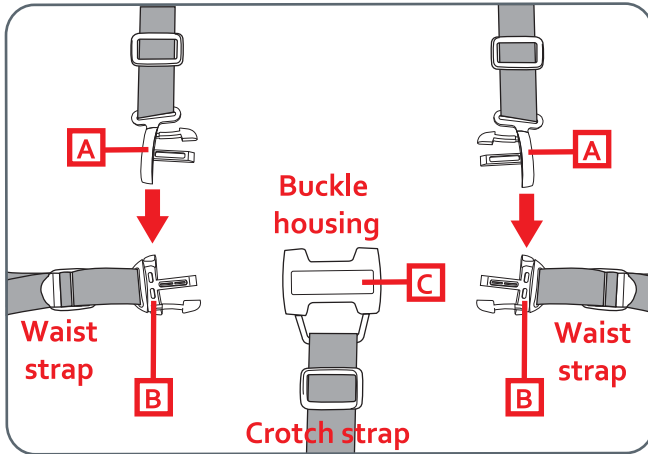

B Position the shoulder strap tongue (A) on top of the waist buckle tongue (B) on both sides.

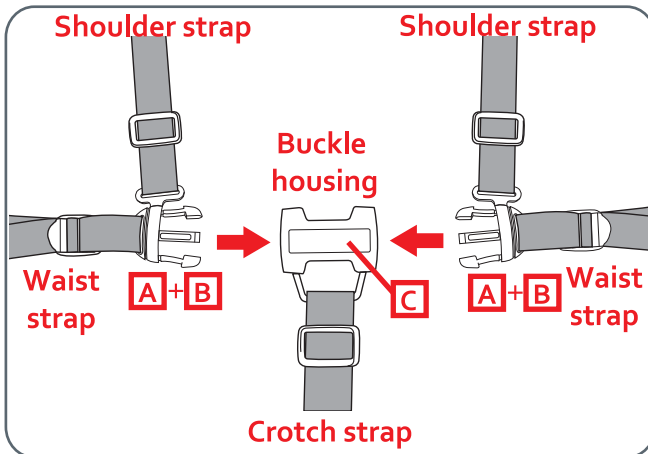

C Push both buckle tongues (A + B) into the buckle housing (C) until the buckle tongues lock into position.

STROLLER OPERATION

USING THE HARNESS

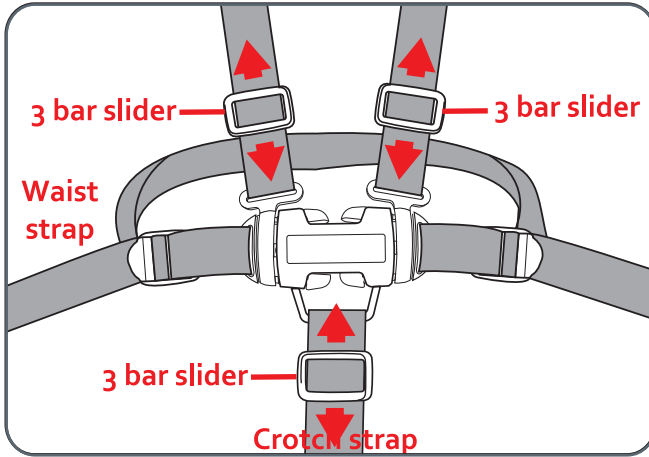

D Tighten or loosen crotch straps by sliding the 3 bar sliders up or down.

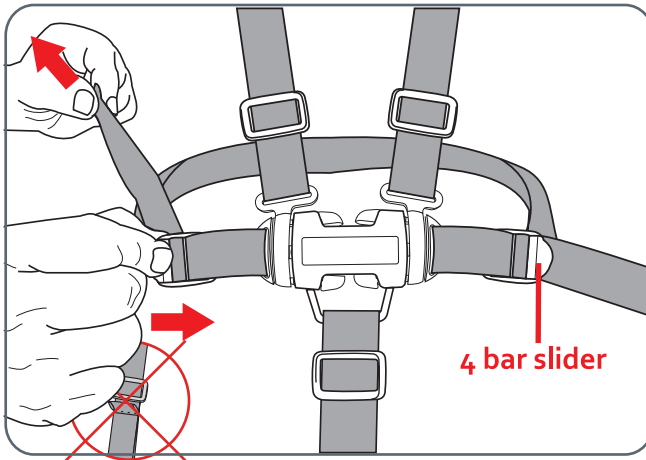

E To tighten or loosen the waist straps, hold and lift the 4 bar slider and then pull the harness strap to adjust to the desired fit. The waist strap needs to fit firmly around the child.

STROLLER OPERATION

USING THE HARNESS

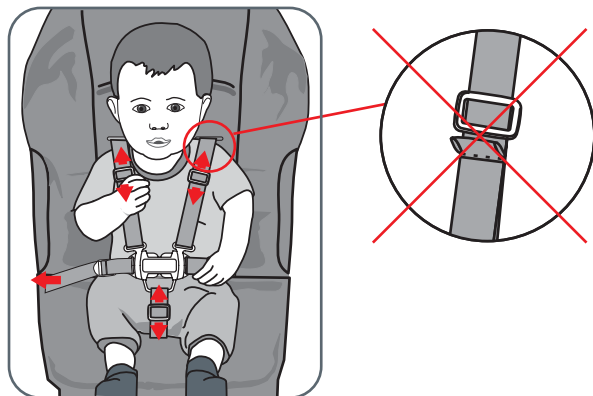

F To tighten or loosen the shoulder straps, slide the 3 bar slider up or down to adjust to the desired fit. Always adjust the harness strap when changing the seating position of the child.

! **CAUTION:** DO NOT SLIDE 3 BAR SLIDER OVER THE SEWN TAB ON SHOULDER HARNESS.

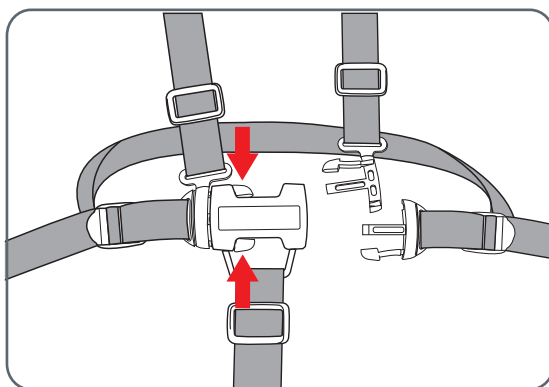

G To release the buckle, squeeze the top and buckle tongues together with enough pressure so the buckle tongues can release from the buckle housing.

STROLLER OPERATION

USING THE HARNESS

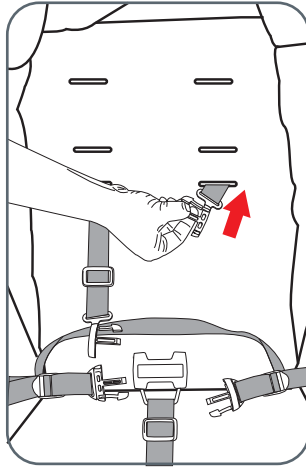

- H** The stroller seat has 3 sets of harness slots at different heights to accommodate the child. To change the shoulder harness height, push the shoulder harness tongue out of the current harness slot and through the back of the seat fabric.

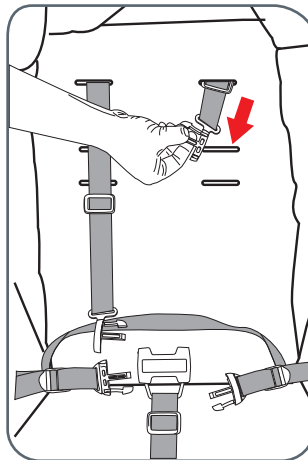

- I** To reposition the harness, pull the shoulder harness buckle tongue through the desired slot.

STROLLER OPERATION

USING THE STROLLER

PLEASE REFER TO PAGE 4 FOR LIFTING TECHNIQUES.

- Always ensure you bend your knees where appropriate and take due care when lifting the frame.
- With your hand through the wrist tether strap loop, push the stroller holding the handle.
- The stroller can be steered in the desired direction - allowing the front wheels to swivel will make this easier.
- The front wheels may wobble or oscillate when walking fast. Locking the front swivel wheels will stop this.
- The stroller can be taken up kerbs by either pressing down on the handles and raising the front wheels or turning the stroller around and pulling the stroller up the kerb.
- Caution is required when pushing the stroller on a steep slope as the stroller may become unstable. Always hold the handle firmly.
- Do not run with the stroller.
- Whenever you stop, always apply the brakes before you leave the stroller.
- Do not hang bags or goods from the handle. Use the storage basket.

STROLLER OPERATION

FOLDING THE STROLLER

IMPORTANT NOTES:

PLEASE REFER TO PAGE 4 FOR LIFTING TECHNIQUES.

- REMOVE THE CHILD FROM THE STROLLER BEFORE COMMENCING ANY FOLDING OPERATION.
- FOLD THE STROLLER SLOWLY AND BE CAREFUL WHERE YOU PLACE YOUR HANDS.
- WHEN FOLDING THE STROLLER, BE AWARE OF THE DANGER OF BEING INJURED BY MOVING PARTS AND LOCKING DEVICES DURING THE PROCESS. KEEP ALL HANDS AND LIMBS CLEAR OF THESE PARTS.
- THERE IS POTENTIAL FOR FINGERS OR PARTS OF THE BODY TO BE INJURED WHEN THE STROLLER IS BEING FOLDED, DUE CARE SHOULD BE EXERCISED.
- KEEP CHILDREN CLEAR OF THE STROLLER DURING FOLDING THE STROLLER.

- A** Remove the child from the stroller before commencing any folding operation.
- B** Lock the brakes. (Refer to Page 12)
- C** Lock the swivel wheels. (Refer to Page 13)
- D** Raise the backrest to the fully upright position. (Refer to Page 14)
- E** Close the canopy. (Refer to Page 9)

STROLLER OPERATION

FOLDING THE STROLLER

F Press the folding button (1) located on the right hand side of the stroller. With the other hand pull up on the folding strap (2) (as shown by the arrow). The stroller will now fold.

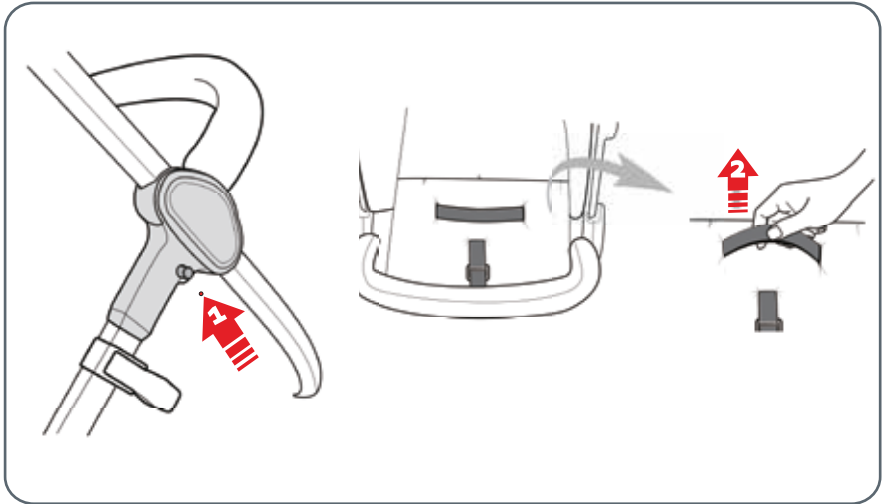

G Lock the frame with the frame lock latch.

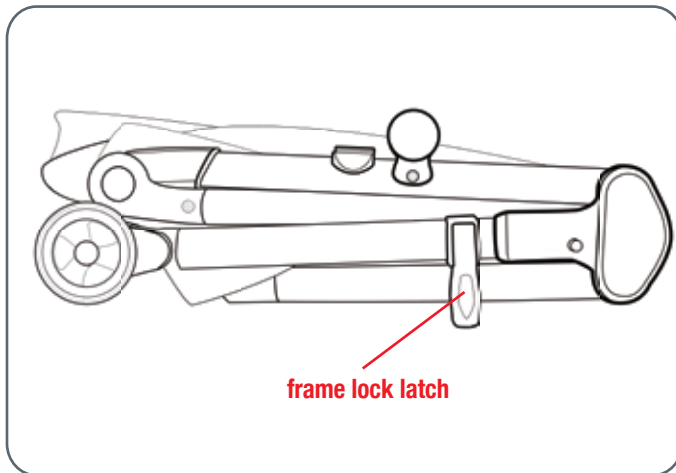

STROLLER OPERATION

LIFTING AND CARRYING THE STROLLER

IMPORTANT NOTES:

PLEASE REFER TO PAGE 4 FOR LIFTING TECHNIQUES.

- **TO AVOID INJURY: BEND YOUR KNEES WHEN OPENING, LIFTING, CARRYING, FOLDING, UNFOLDING OR ADJUSTING THE STROLLER OR ANY ACCESSORIES.**
- A** Ensure the frame lock latch is locked onto the frame before lifting the stroller. To lift the stroller, grasp the frame halfway along the stroller, so the stroller is balanced.

CARE AND MAINTENANCE

- To prolong the life of your stroller keep it clean and do not leave it in the direct sunlight or in the car boot for extended periods of time.
- Removable fabric covers and trims may be cleaned using warm water with a household soap or mild detergent. Allow it to dry fully, preferably away from the direct sunlight.
- Non removable fabric covers and trims may be spot cleaned using a damp sponge with soap or a mild detergent. Allow it to dry completely before folding or storing it away.
- In some climates the covers and trims may be affected by mould and mildew. To help prevent this occurring, do not fold or store the product if it is damp or wet. Always store the product in a well ventilated area.
- When using your stroller at the beach - completely clean your stroller afterwards to remove the sand and salt from the mechanisms and wheel assembly. Sand and salt will cause premature wear and corrosion.
- If there are compression marks on the tyres - Use a domestic hair dryer to gently warm (DO NOT OVERHEAT) the tyre and the compression marks should slowly disappear.
- Always check parts regularly for tightness of screws, nuts, and other fasteners - tighten if required. To maintain the safety of your nursery product, seek prompt repairs for bent, torn, worn or broken parts.

THIS PRODUCT IS NOT INTENDED FOR COMMERCIAL USE.

WARRANTY



DID YOU KNOW:

Registering your product purchase online simplifies proof of purchase in event of a warranty claim.

Scan this QR code on your phone to go straight to our website to fill out the registration form.



MAKING A WARRANTY CLAIM

Your rights under a Britax company warranty are separate from and independent of your rights under the statutory consumer guarantees. What you need to do to enforce your rights under a statutory consumer guarantee is set out in the **Australian Competition and Consumer Commission's Consumer Guarantees - A Guide for Consumers**.

To make a claim under a Britax company warranty, please contact our customer service team on:

1300 303 330 - Australia, 0508 688 822 - New Zealand

or alternatively by email at:

Australia - au-custserv@britax.com

New Zealand - nzoffice@britax.com

You will be required to :

1. Return the product to the place of purchase or to a designated repair agent;
2. Present your receipt as proof of purchase;
3. Identify the defect in the product; and
4. Present the product to Britax for inspection on request.

WARRANTY

Britax will advise you whether the product is covered by the Britax company warranty. Britax's decision of whether a product is covered by a Britax company warranty is final. Britax will act reasonably when determining whether a product is covered by a company warranty.

AUSTRALIAN CONSUMER LAW

On all of our goods, you have the benefit of a statutory consumer guarantee. In summary, goods are guaranteed to be of "acceptable quality" (fit for purpose), goods are guaranteed to match any sample against which they are sold. These consumer guarantees are provided for by the Australian Consumer Law and, if you believe anyone of these guarantees is not satisfied by a Britax product, you have rights under the Australian Consumer law to enforce that guarantee.

Your rights under the statutory consumer guarantees are set out in the Australian Competition and Consumer Commission's Consumer Guarantees - A Guide for Consumers.

In addition to the statutory consumer guarantees, BRITAX offers its own company warranty on all of its products. You therefore have the option of seeking redress for defective or faulty product either under the BRITAX company warranty or the statutory guarantees. After the Britax company warranty expires, you still have your rights under the statutory consumer guarantees.

Depending on the product involved, the following Britax company warranty applies:

WARRANTY

STEELCRAFT WARRANTY

Steelcraft products are covered by this company warranty against faulty materials and workmanship (normal wear and tear excluded) that affects the normal operation of your Steelcraft product. In the unlikely event that you find that your Steelcraft product does not satisfy this warranty, Britax will (at its option) repair or replace that product within a reasonable period of you making a claim in accordance with this policy.

In the event that a replacement product is no longer available, Britax reserves the right to provide what it considers to be a suitable alternative.

For this company warranty to apply, you must make an application before the expiration of the following periods from date of purchase:

- 2 years on Steelcraft strollers, Steelcraft stroller accessories, highchairs, portable cots, walkers and rockers.

This company warranty does not apply to second hand or aftermarket goods or goods used for rental, hire or other commercial purposes or to any claim where the damage or fault is, in whole or part, the result of incorrect installation, mistreatment, intentional damage, any use other than use in normal conditions or any use otherwise than in accordance with the Instruction Manual for that product.

Please read your instruction manual carefully before using any of our products.

INTERNATIONAL WARRANTY

Britax products are available through a network of retailers in Australia and New Zealand. If you are an International customer we do not offer a warranty service outside of these regions.

NOTES

NOTES

Steelcraft[™]

BRITAX CHILDCARE PTY. LTD.

A.B.N. 55 006 773 600

Level 4, 650 Lorimer Street, Port Melbourne, Victoria 3207, Australia

Phone: (03) 9288 7288 Fax: (03) 9311 5798

CUSTOMER SERVICE

1300 303 330 - Australia 0508 688 822 - New Zealand

Due to our continuing program of development, Britax reserves the right to alter the specifications, color or design without any further notice.

The Steelcraft trademark is the property of Britax Childcare Pty.Ltd - Australia.

The Britax trademark is the property of Britax Childcare Holdings Limited - UK.

Visit the Britax website at: www.britax.com.au or email us at au-custserv@britax.com

Due to the variations in the style and design of our products the illustrations used in this instruction booklet are generic.

This product is designed to comply with Australian and New Zealand standard AS/NZS2088:2013 "Prms and Strollers - Safety Requirements."

©2019 Copyright Britax Childcare Pty. Ltd. Australia