



# BRITAX HOLIDAY

## Instruction Manual



**IMPORTANT: KEEP THIS BOOKLET IN A SAFE PLACE FOR FUTURE REFERENCE.**

Series No.BX85C

# WARNINGS

---

ALWAYS FOLLOW THE MANUFACTURERS INSTRUCTIONS.

READ ALL INSTRUCTIONS CAREFULLY BEFORE ASSEMBLY AND USE OF THIS STROLLER.

THE CORRECT USE AND MAINTENANCE OF THIS PRODUCT IS ESSENTIAL.

## **WARNINGS:** TO AVOID INJURY OR DEATH:

**DO NOT USE THIS STROLLER FOR CHILDREN LESS THAN 6 MONTHS OLD.**

**ALWAYS APPLY THE BRAKES WHENEVER THE STROLLER IS STATIONARY.**

- DO NOT LEAVE CHILDREN UNATTENDED.
- SECURE THE CHILD IN THE HARNESS AT ALL TIMES.
- DO NOT CARRY EXTRA CHILDREN OR BAGS ON THIS STROLLER.
- MAKE SURE CHILDREN ARE CLEAR OF ANY MOVING PARTS IF YOU ADJUST THE STROLLER.
- DO NOT USE ANY ACCESSORIES OTHER THAN THOSE APPROVED FOR USE WITH THIS STROLLER BY BRITAX.
- IT IS UNSAFE TO USE ACCESSORIES NOT APPROVED FOR USE WITH THIS STROLLER.
- THE MAXIMUM WEIGHT OF THE CHILD USING THIS STROLLER IS NOT TO EXCEED 18 KG.



## CAUTION

This **CAUTION** Symbol is shown at certain steps in this Instruction Manual to highlight the danger of being injured by moving parts.

# STROLLER FEATURES

---

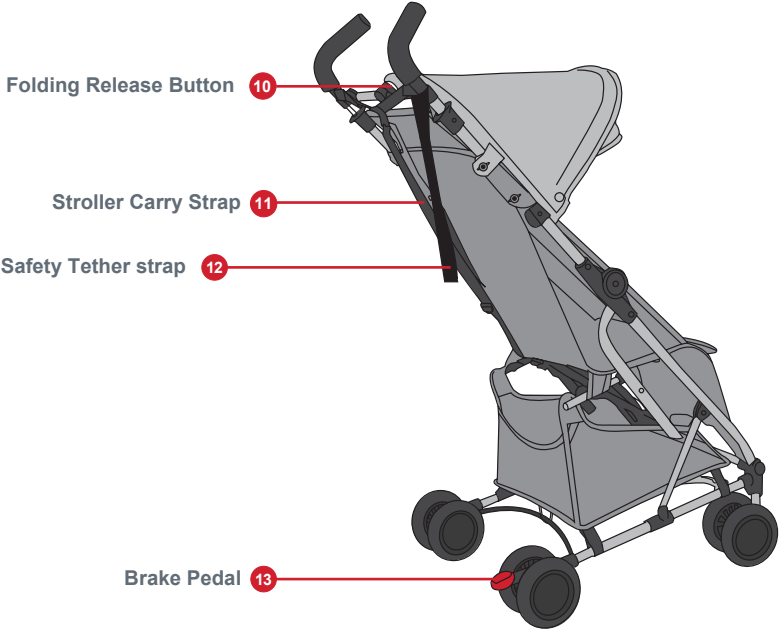

# STROLLER ASSEMBLY

---

## IMPORTANT NOTES:

- USE GREAT CARE WHEN USING THE STROLLER ON STAIRS, ESCALATORS, TRAVELATORS OR OTHER MOVING SURFACES.
- IT IS RECOMMENDED TO REMOVE THE CHILD FROM THE STROLLER BEFORE GOING UP OR DOWN STAIRS OR ESCALATORS.
- DO NOT ALLOW CHILDREN TO STAND ON THE SEAT.
- DO NOT HANG BAGS OR GOODS FROM THE HANDLE AS THIS COULD CAUSE THE STROLLER TO TIP OVER.
- DO NOT LEAVE THE STROLLER AND ITS ACCESSORIES NEAR AN OPEN FIRE OR EXPOSED FLAME.
- DO NOT PLACE MORE THAN 2 KG IN THE BASKET.
- DO NOT RUN WITH THE STROLLER.
- WHENEVER YOU STOP ALWAYS APPLY THE BRAKES BEFORE YOU LEAVE THE STROLLER.
- WHEN OPENING THE STROLLER, BE AWARE OF THE DANGER OF BEING INJURED BY MOVING PARTS AND LOCKING DEVICES DURING THE PROCESS. KEEP ALL HANDS AND LIMBS CLEAR OF THESE PARTS.
- THERE IS POTENTIAL FOR FINGERS OR PARTS OF THE BODY TO BE INJURED WHEN THE STROLLER IS BEING UNFOLDED, DUE CARE SHOULD BE EXERCISED.
- KEEP CHILDREN CLEAR OF THE STROLLER WHEN UNFOLDING THE STROLLER.
- OPEN THE STROLLER SLOWLY AND BE CAREFUL WHERE YOU PLACE YOUR HANDS. KEEPING YOUR HANDS ON THE HANDLE IS THE BEST WAY TO UNFOLD THE STROLLER.

# STROLLER ASSEMBLY

## OPENING THE STROLLER FRAME

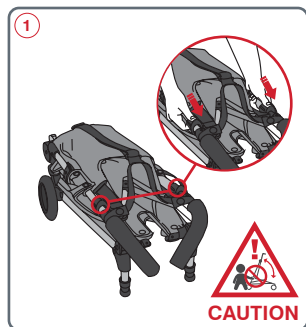

## ATTACHING & REMOVING THE FRONT WHEELS

Attaching the wheels

Removing the wheels

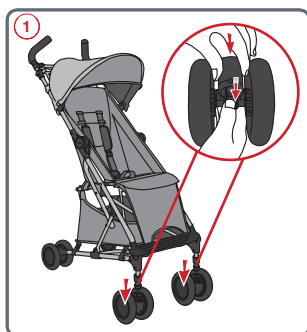

## USING THE BRAKES



**WARNINGS:** ALWAYS APPLY THE BRAKES WHEN THE STROLLER IS STATIONARY.

PLEASE NOTE: Pressing the brake pedal down locks both rear wheels.

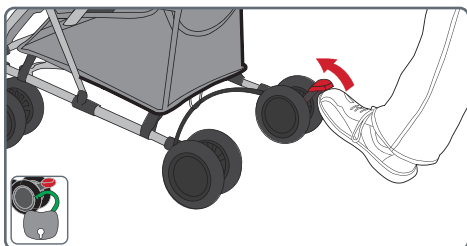
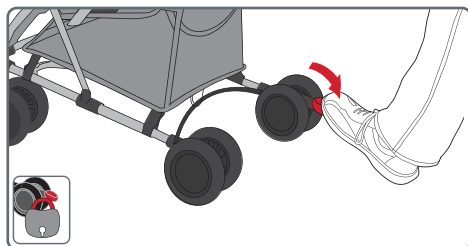

# STROLLER ASSEMBLY

## ATTACHING OR REMOVING THE CANOPY

### IMPORTANT NOTE:

The sun is very strong. **DO NOT LEAVE YOUR CHILD EXPOSED TO THE SUN.** The canopy or hood on this product will not give your child total protection from the harmful rays of the sun.

Attaching the canopy



Removing the canopy



# STROLLER OPERATION

---

## USING THE HARNESS



### **WARNING:** USE THE HARNESS AT ALL TIMES.

- ENSURE YOUR CHILD IS SECURED WITH A CORRECTLY ADJUSTED HARNESS.
  - THE ADJUSTED HARNESS SHOULD CLOSELY FIT THE CHILD.
  - NEVER LEAVE THE HARNESS BUCKLED WHEN NOT FITTED TO A CHILD IN THE STROLLER, BECAUSE THE HARNESS CAN FORM LOOPS WHICH MAY POSE A STRANGULATION HAZARD.
  - WHEN HARNESS IS NOT IN USE, DISCONNECT SHOULDER STRAPS FROM THE WAIST STRAPS AND BUCKLE TO PREVENT STRANGULATION.
- 
- A five point harness is provided to restrain your child.
  - Buckle tongues separate for added safety.
  - To reconnect buckle tongues and to secure the child in the harness please follow the steps below carefully.

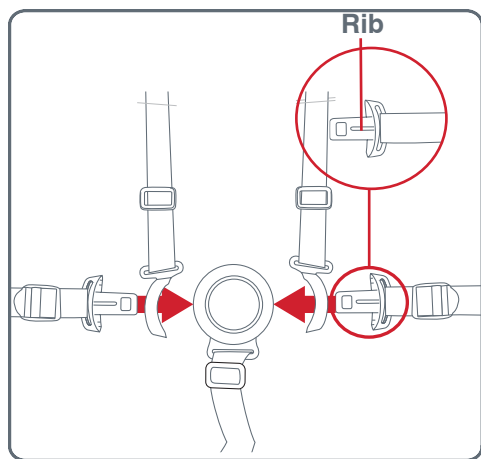

**PLEASE NOTE:** Each waist buckle tongue has a raised rib on one side and can only be locked into the buckle assembly with the raised rib facing up.

Ensure the harness straps are not twisted as they may become uncomfortable for the child.

# STROLLER OPERATION

## USING THE HARNESS

Securing your child in the harness.



**IMPORTANT NOTE:** Pull on each waist buckle tongue to make sure they are locked into the crotch buckle assembly.

Adjusting the shoulder harness straps.



**! CAUTION:** Do not slide 3 bar slider over the sewn tab on the shoulder harness.

Adjusting the shoulder harness strap height



**IMPORTANT NOTE:** The harness can be adjusted to three different heights to accommodate the child. The shoulder straps must be positioned near the child's shoulders.

Releasing the harness.





# STROLLER OPERATION

---

## USING THE TETHER STRAP

**⚠ WARNINGS:** USE THE TETHER STRAP TO STOP THE STROLLER ROLLING AWAY.

- THE STROLLER IS DESIGNED FOR USE ON FLAT OR GENTLY SLOPING SURFACES, AND MAY BE UNSTABLE ON HIGHER SLOPING AND UNEVEN SURFACES AND USERS SHOULD BE AWARE OF THE POSSIBILITY OF THE STROLLER ROLLING AWAY OR TIPPING OVER.
- NEVER LET GO OF THE STROLLER WHEN PARKED ON AN INCLINE OR SLOPING SURFACE BECAUSE IT MAY SLIDE OR TIP OVER. ALWAYS PARK ON A FLAT SURFACE AND APPLY THE BRAKES.
- ALWAYS APPLY THE BRAKES WHENEVER THE STROLLER IS STATIONARY.



# STROLLER OPERATION

## FOLDING THE STROLLER

- REMOVE THE CHILD FROM THE STROLLER BEFORE COMMENCING ANY FOLDING OPERATION.
- FOLD THE STROLLER SLOWLY AND BE CAREFUL WHERE YOU PLACE YOUR HANDS.
- WHEN FOLDING THE STROLLER, BE AWARE OF THE DANGER OF BEING INJURED BY MOVING PARTS AND LOCKING DEVICES DURING THE PROCESS. KEEP ALL HANDS AND LIMBS CLEAR OF THESE PARTS.
- THERE IS POTENTIAL FOR FINGERS OR PARTS OF THE BODY TO BE INJURED WHEN THE STROLLER IS BEING FOLDED, DUE CARE SHOULD BE EXERCISED.
- KEEP CHILDREN CLEAR OF THE STROLLER WHEN FOLDING THE STROLLER.

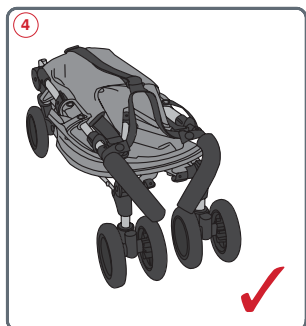
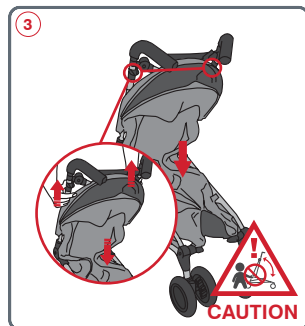
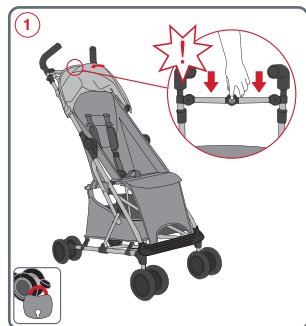

# STROLLER OPERATION

---

## LIFTING AND CARRYING THE STROLLER

### IMPORTANT NOTES:

- **TO AVOID INJURY: BEND YOUR KNEES WHEN OPENING, LIFTING, CARRYING, FOLDING, UNFOLDING OR ADJUSTING THE STROLLER OR ANY ACCESSORIES.**
- **Ensure that the storage latch is engaged when lifting or carrying the vehicle.**

**PLEASE NOTE: A carry strap is supplied for ease of transport when stroller is fully folded. Only use the carry strap to carry stroller.**

## CARE AND MAINTENANCE

---

- To prolong the life of your stroller - keep the product clean and do not leave it in the direct sunlight or in the car boot for extended periods of time.
- Removable fabric covers and trims may be cleaned using warm water with a household soap or mild detergent. Allow it to dry fully, preferably away from the direct sunlight.
- Non removable fabric covers and trims may be spot cleaned using a damp sponge with soap or a mild detergent. Allow it to dry completely before folding or storing it away.
- In some climates the covers and trims may be affected by mould and mildew. To help prevent this occurring, do not fold or store the product if it is damp or wet. Always store the product in a well ventilated area.
- When using your stroller at the beach - completely clean your stroller afterwards to remove the sand and salt from the mechanisms and wheel assembly. Sand and salt will cause premature wear and corrosion.
- If there are compression marks on the tyres - Use a domestic hair dryer to gently warm (DO NOT OVERHEAT) the tyre and the compression marks should slowly disappear.
- Always check parts regularly for tightness of screws, nuts, and other fasteners - tighten if required. To maintain the safety of your nursery product, seek prompt repairs for bent, torn, worn or broken parts.

**THIS PRODUCT IS NOT INTENDED FOR COMMERCIAL USE.**

**youtube.com/britaxaustralia**



**facebook.com/britaxaustralia**



**twitter.com/britaxaustralia**



**pinterest/britaxaustralia**



**britax.com.au**



**1300 303 330**



BRITAX CHILDCARE PTY. LTD.

A Britax International Company

ABN 55 006 773 6000

99 Derby Road Sunshine

Victoria 3020 Australia

Britax Childcare Pty Ltd

(Customer Service 1300 303 330)

Britax Childcare (NZ) Ltd

(Customer Service 0508 688 822)

Due to the variations in style and design of our products, the illustrations used in this instruction booklet are generic.

We reserve the right to alter these products without notice.

The Britax Trademark is the property of Britax Childcare Holdings Limited - UK.

This product is designed to comply with Australian and New Zealand standard AS/NZS2088:2013 "Prams and Strollers - Safety Requirements."

©2016 Copyright Britax Childcare Pty. Ltd. Australia