

Video Instruction  
Available on Website  
[www.britax.com.au](http://www.britax.com.au)

# INSTRUCTION MANUAL



Suitable for use with Cruiser Infant Carrier (sold separately)  
KEEP INSTRUCTIONS FOR FUTURE REFERENCE



Series HB 5300

# **IMPORTANT NOTES:**

**ALWAYS FOLLOW THE MANUFACTURERS INSTRUCTIONS. READ ALL INSTRUCTIONS CAREFULLY BEFORE ASSEMBLY AND USE OF THIS STROLLER.**

**THE CORRECT USE AND MAINTENANCE OF THIS PRODUCT IS ESSENTIAL.**

- USE GREAT CARE WHEN USING THE STROLLER ON STAIRS, ESCALATORS, TRAVELATORS OR OTHER MOVING SURFACES.
- IT IS RECOMMENDED TO REMOVE THE CHILD FROM THE STROLLER BEFORE GOING UP OR DOWN STAIRS OR ESCALATORS.
- DO NOT LIFT THE STROLLER BY THE ARM BAR OR TRAY (IF SUPPLIED) BECAUSE IT MAY DISENGAGE.
- DO NOT ALLOW CHILDREN TO STAND ON THE SEAT.
- DO NOT HANG BAGS OR GOODS FROM THE HANDLE AS THIS COULD CAUSE THE STROLLER TO TIP OVER.
- DO NOT LEAVE THE STROLLER AND ITS ACCESSORIES NEAR AN OPEN FIRE OR EXPOSED FLAME.
- DO NOT PLACE MORE THAN 4 KG IN THE BASKET, OR 1KG IN THE CANOPY POCKET (IF SUPPLIED).

### **WARNINGS:** TO AVOID INJURY OR DEATH:

**ALWAYS APPLY THE BRAKES WHENEVER THE STROLLER IS STATIONARY.**

- **DO NOT LEAVE CHILDREN UNATTENDED.**
- **SECURE THE CHILD IN THE HARNESS AT ALL TIMES.**
- **DO NOT CARRY EXTRA CHILDREN OR BAGS ON THIS STROLLER.**
- **MAKE SURE CHILDREN ARE CLEAR OF ANY MOVING PARTS IF YOU ADJUST THE STROLLER.**
- **DO NOT USE ANY ACCESSORIES OTHER THAN THOSE APPROVED FOR USE WITH THIS STROLLER BY BRITAX.**
- **IT IS UNSAFE TO USE ACCESSORIES NOT APPROVED FOR USE WITH THIS STROLLER.**
- **THE MAXIMUM WEIGHT OF THE CHILD USING THIS STROLLER IS NOT TO EXCEED 20 KG.**

**FOR IMPORTANT NOTES AND WARNINGS ON ACCESSORIES - REFER TO THEIR INDIVIDUAL SECTIONS IN THIS BOOK. THE MAXIMUM WEIGHT VARIES FOR EACH ACCESSORY.**



**CAUTION**

**This CAUTION Symbol is shown at certain steps in this Instruction Manual to highlight the danger of being injured by moving parts.**

## MANUAL HANDLING TECHNIQUES

### **The SMART lifting technique**

This technique can be used to pick up small light loads from low levels.

#### **Size up the Load**

- Assess the load (size, shape and weight).
- Assess whether the load needs to be moved;
- Where is it going to be placed" Check that there are no obstructions;
- Assess whether mechanical or human assistance is required.

#### **Move the Load as close to the body as possible**

- A load is heavier to lift or carry if it is not close to the body.
- The whole hand should be used to ensure a firm grip.

#### **Always bend your knees**

- Maintain balance.
- Keep feet apart and in a comfortable position.
- Minimise lower back bending.
- Bend knees preferable at as large an angle as possible but not at a right angle - use a semi squat in preference to a full squat.

#### **Raise the load with your legs**

- Achieve the lift smoothly and without jerkiness.
- Maintain the normal curvature of the spine to allow the force of the load to be distributed evenly from the spine to the pelvis.

#### **Turn your feet in the direction that you want to move the load.**

- Avoid unnecessary bending, twisting and reaching.
- Change direction by turning your feet and not your back.
- To set the load down, squat down, keep your head up and let
- Let your legs do the work.

**Remember to 'THINK TALL' chest lifted, shoulders relaxed, chin tucked in and head level.**

## STROLLER FEATURES

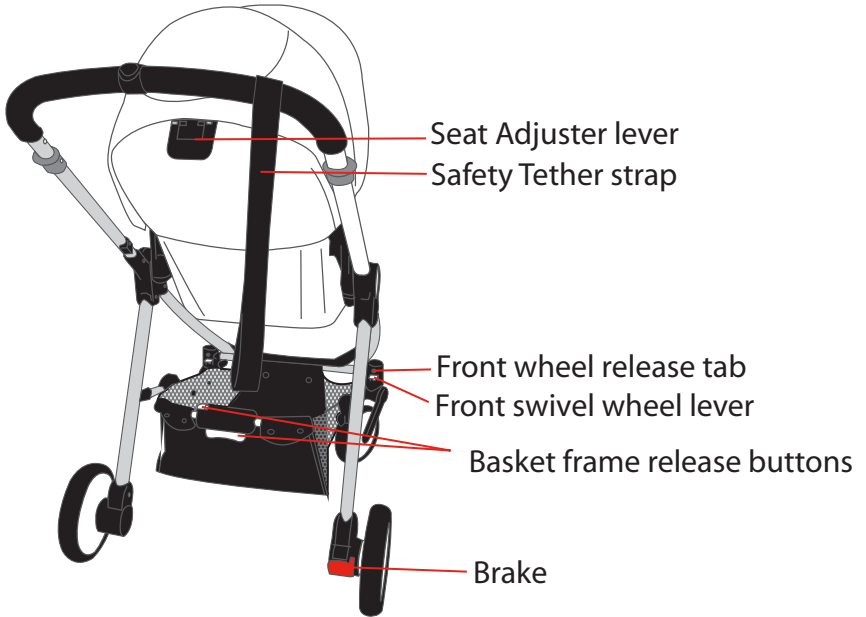
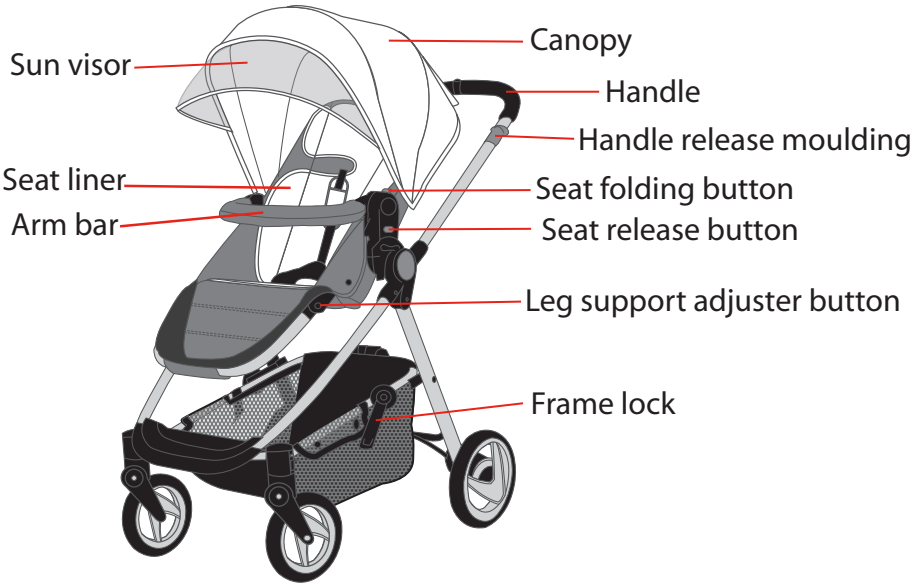

## PARTS LIST

A 1 x Stroller Frame & Basket

B 1 x Seat

C 1 x Canopy

D 1 x Arm bar

E 2 x Rear Wheels

F 2 x Front Wheels

G 1 x Padded seat liner

H Shoulder pads

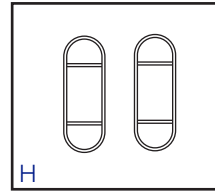
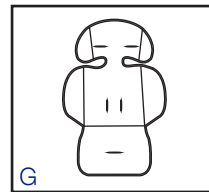
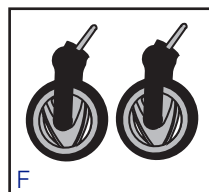
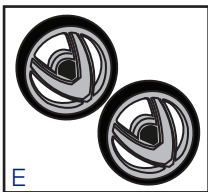
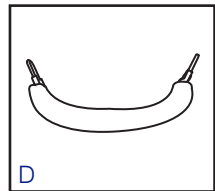
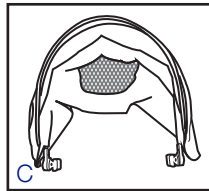
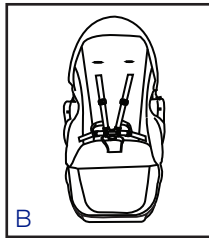
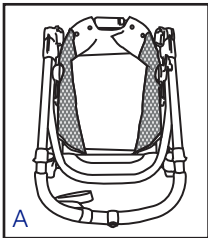

## 1. OPEN THE FRAME

### **CAUTION:**

- RELEASE THE STORAGE LATCH WITH DUE CARE AND OPEN THE FRAME.
- WHEN OPENING OR FOLDING THE STROLLER , BE AWARE OF THE DANGER OF BEING INJURED BY MOVING PARTS AND LOCKING DEVICES DURING THIS PROCESS. KEEP ALL HANDS AND LIMBS CLEAR OF THESE PARTS AND IN PARTICULAR BE AWARE TO KEEP CHILDREN AWAY FROM ANY DANGER.
- OPEN THE STROLLER SLOWLY AND BE CAREFUL WHERE YOU PLACE YOUR HANDS. KEEPING YOUR HANDS ON THE HANDLE IS THE BEST WAY TO FOLD OR UNFOLD THE STROLLER.

### **IMPORTANT NOTES:**

**PLEASE REFER TO PAGE 4 FOR SMART LIFTING TECHNIQUES.**

## 1. OPEN THE FRAME

- A** Stand the frame on its side on a flat, clean surface.
- B** Locate the frame lock, press and hold down. Then move the handle slightly forward so the frame is unlocked.
- C** With each hand holding the handle and rear leg frame continue to open all the way until the handle is locked in position.
- D** Now stand the frame upright.
- E** While holding the handle push down the top of the basket until frame is completely open and locked in position.

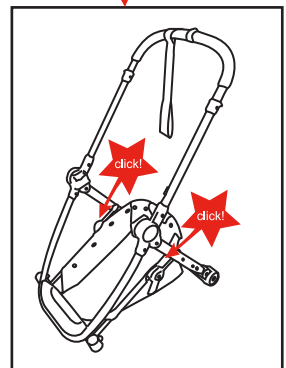
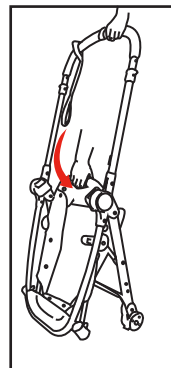
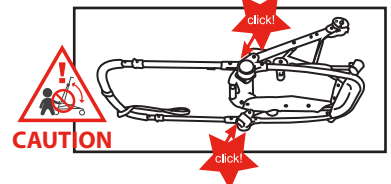
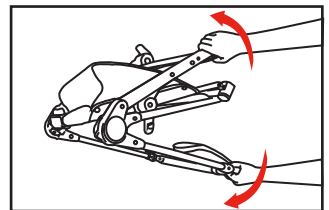
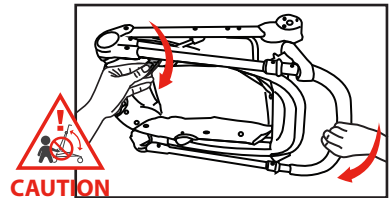
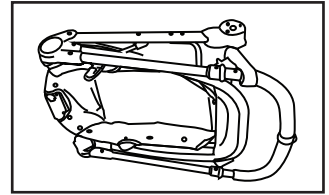



## 2. TO FIT AND REMOVE THE REAR WHEELS

**NOTE:** The axle has a flat surface and needs to be aligned correctly into the wheel housing.

**A** Align the flat surface of the axle with the flat surface of the wheel housing and insert the wheel until it locks in. Pull on the wheel to confirm it is locked in. If not locked in, repeat the procedure. Then repeat the rear wheel installation for the other side.

**B** To remove the rear wheels, locate the spring loaded lever (on the underside of the wheel housing). Pull the lever down and at the same time remove the wheel. Repeat for the other side.

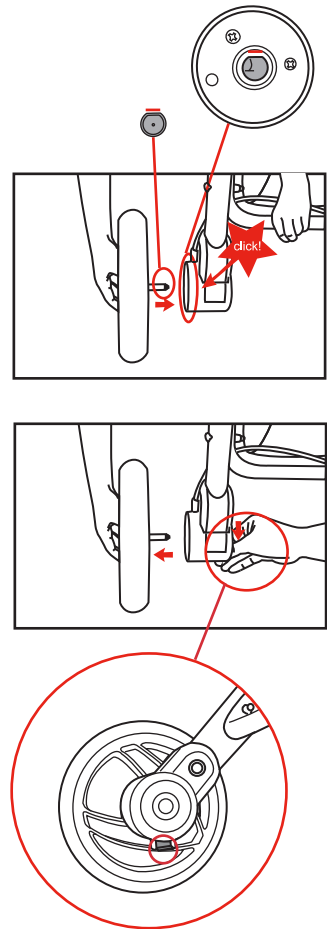

### 3. TO USE THE BRAKES

**⚠ WARNING:** ALWAYS APPLY THE BRAKES WHENEVER THE STROLLER IS STATIONARY.

**A** With your foot, press down the RED brake lever to lock the wheels. Gently push the stroller forwards and backwards a few times to make sure the brake is engaged.

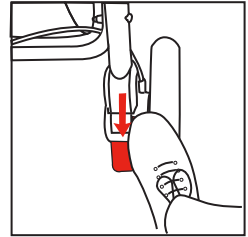

**B** To release the brake, lift the brake lever up.

**NOTE:** It is recommended to leave the brake locked for the remainder of the Stroller assembly.

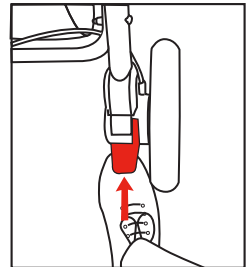

## 4. TO FIT AND REMOVE THE FRONT WHEELS

**A** Take one front wheel at a time and insert the post into the front wheel housing. Push in until it locks into place. Pull on the front to confirm it is locked in. If not locked in, repeat the procedure.

**B** To remove the front wheels, locate the silver tab behind the front wheel housing. Push in and hold and remove the front wheel. Repeat for the other side.

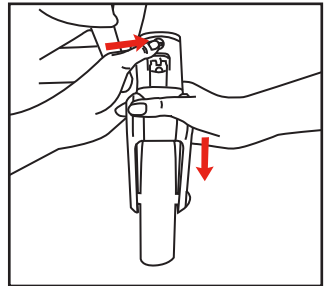
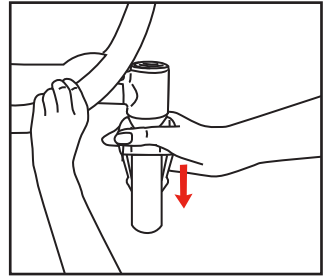
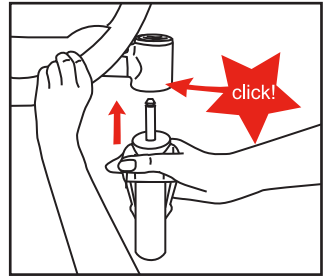

## 5. FRONT SWIVEL WHEEL LOCKS

**NOTE:** The swivel wheel locks are located behind the wheel housing.

**A** To lock the front swivel wheels , press down each front wheel lever to the locked position. The swivel wheels will lock automatically when the wheels turn to a straight position.

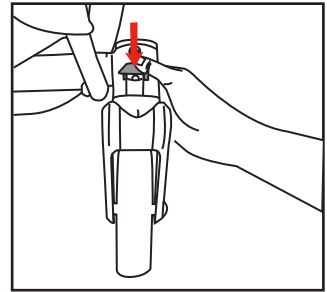

**B** To unlock the wheels , raise both levers up until the wheels are in swivel mode.

**C** Rotate the Stroller frame into the standing position.

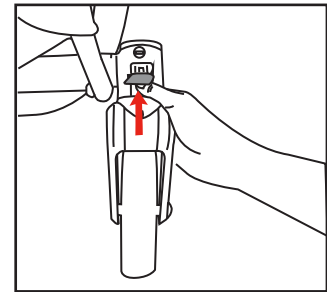

## 6. TO OPEN THE SEAT

**A** Hold down the bottom of the seat with one hand.

**B** Rotate the top of the seat open and into the locked position. Confirm it has locked open. If not locked, repeat the procedure.

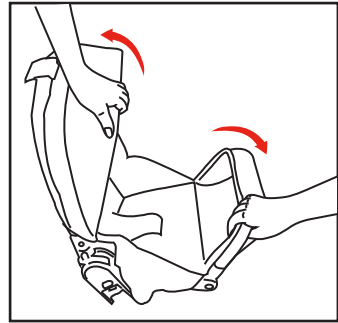

## 7. TO FIT THE SEAT IN THE FORWARD FACING POSITION

**A** On each side, locate the seat mouldings over the frame mouldings as shown.

**B** Push down on both sides until you hear the seat lock onto the frame. Pull up on each side to confirm they are locked. If not locked onto the frame, push down again to lock. Pull up on the seat to confirm engagement. Repeat again if necessary.

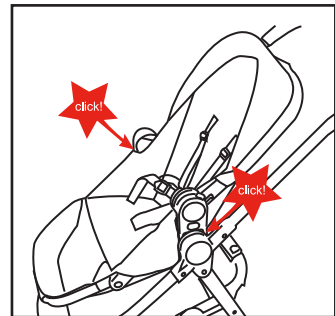
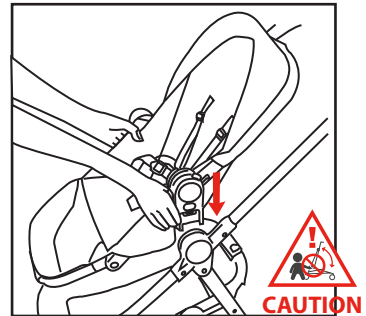

## 8. TO ADJUST THE BACKREST

### **WARNING:**

- **THE UPRIGHT POSITIONS ARE NOT SUITABLE FOR A CHILD UNDER 6 MONTHS OLD.**
- **THE LOWEST RECLINE POSITION SHOULD BE USED TO TRANSPORT BABIES. THE BACKREST CAN BE ADJUSTED TO A MORE UPRIGHT POSITION AS THE CHILD GROWS OLDER AND IS ABLE TO SUPPORT ITS HEAD WITHOUT ASSISTANCE.**

**A** To adjust the seat up or down to one of three positions, lift the spring loaded lever behind the top of seat, all the way up until the seat can rotate freely.

**B** As the seat rotates, continue to hold the lever but allow the lever to close. The seat will lock into the next recline or upright position.

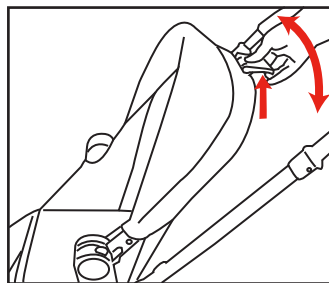

## 9. TO REMOVE THE SEAT

### **WARNING:**

**DO NOT REMOVE THE SEAT FROM THE FRAME WHILE YOUR CHILD IS STILL IN THE STROLLER.**

**A** Release one side at a time. Hold the side of the seat, press in the seat release button and lift the side up. Repeat for the other side and once both sides are released, remove the seat from the frame.

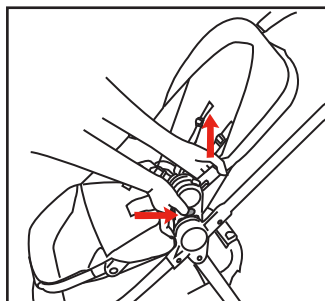

## 10. TO FIT THE SEAT IN THE REARWARD FACING POSITION

**A** On each side, locate the seat mouldings over the frame mouldings as shown.

**B** Push down on both sides until you hear the seat lock onto the frame. Pull up on each side to confirm they are locked. If not locked onto the frame, push down again to lock. Pull up on the seat to confirm engagement. Repeat again if necessary.

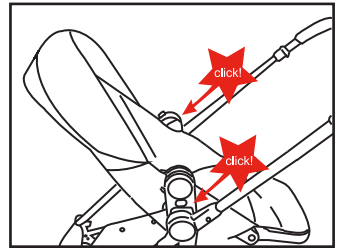
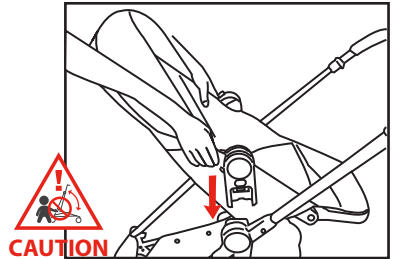

## 11. TO FIT THE ARM BAR

# **WARNING:**

**WHEN A CHILD IS IN THE STROLLER, KEEP THE ARM BAR ATTACHED TO THE FRAME AT ALL TIMES.**

**NOTE: Make sure the CAUTION notice is facing up.**

- A** Align the arm bar mouldings on each side, with the Stroller frame receiver mouldings.
- B** Press each side into the frame mouldings until they lock in. Pull on each side to confirm engagement. Repeat procedure if not locked in.
- C** The Arm bar can be removed. Press in hold the one or both tabs on the sides of the arm bar to release one or both sides.
- D** The Arm bar can be released on one or both sides to allow for easier child access.

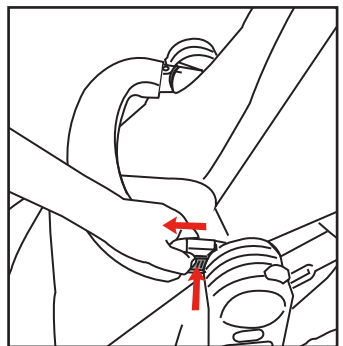
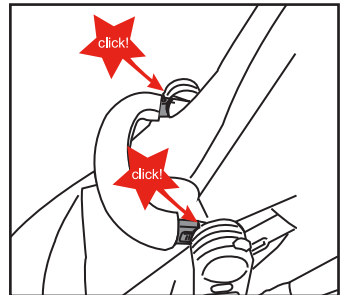
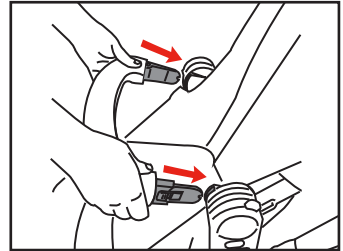



## 12. TO ATTACH AND USE THE CANOPY

### IMPORTANT NOTE:

- **THE SUN IS VERY STRONG. DO NOT LEAVE YOUR CHILDREN EXPOSED TO THE SUN.**
- **THE CANOPY OR HOOD ON THIS PRODUCT WILL NOT GIVE YOUR CHILD TOTAL PROTECTION FROM THE HARMFUL RAYS OF THE SUN.**

**A** Align the canopy mouldings to each side of the Stroller frame as shown. Push each canopy moulding onto the frame and fix into position.

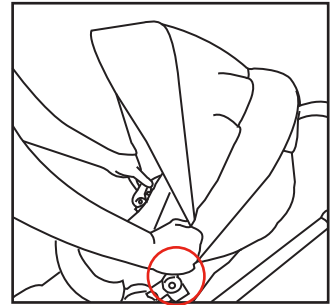

**B** Fit the rear section of the canopy to the top of the seat. Attach the hook strips on underside of the canopy to the loop strips around the top section of the seat.

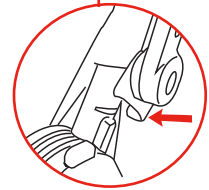

**C** To adjust the pivotal canopy, push forward or pull back on the canopy and adjust to the desired position.

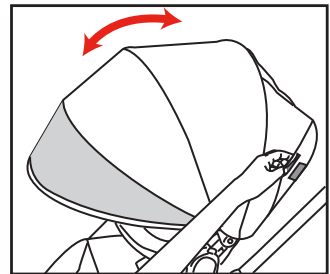

**D** The canopy has a clear visor section. Fold under the front section or extend as required.

**E** The canopy window is secured by a hidden magnet. To open the canopy window flap, lift the cover. To close the canopy window flap and attach it to the hidden magnet in the centre section on the bottom of the canopy window.

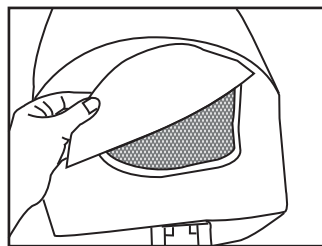

### 13. TO ADJUST THE LEG SUPPORT

#### **IMPORTANT NOTE:**

- **THE LEG SUPPORT FEATURE IS PROVIDED FOR YOUR CHILD'S COMFORT.**
- **THE LEG SUPPORT IS NOT DESIGNED TO SUPPORT EXTRA WEIGHT.**
- **DO NOT ALLOW CHILDREN TO STAND OR SIT ON THE LEG SUPPORT. IT MAY DISENGAGE IF EXTRA WEIGHT IS APPLIED.**

**A** The leg support has 4 positions. To lower the leg support, press in and hold both the left and right buttons, and adjust to the desired position.

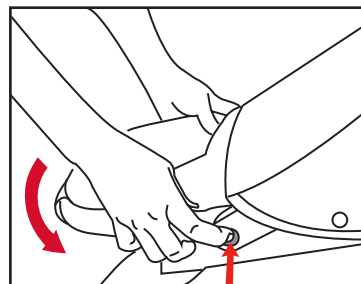

**B** To raise the leg support, just hold it and lift up to desired position.

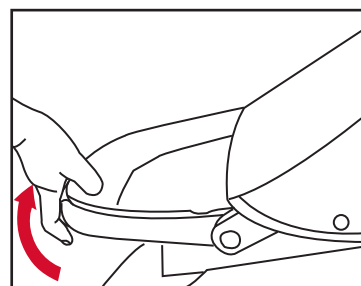

## 14. TO SECURE YOUR CHILD IN THE HARNESS

### **WARNING:** USE THE HARNESS AT ALL TIMES.

- ENSURE YOUR CHILD IS SECURED WITH A CORRECTLY ADJUSTED HARNESS.
- THE ADJUSTED HARNESS SHOULD CLOSELY FIT THE CHILD.
- NEVER LEAVE THE HARNESS BUCKLED WHEN NOT FITTED TO A CHILD IN THE STROLLER, BECAUSE THE HARNESS CAN FORM LOOPS WHICH MAY CAUSE A STRANGULATION HAZARD.
- A five point harness is provided to restrain your child.
- Buckle tongues separate for added safety.
- To reconnect buckle tongues and to secure the child in the harness please follow the steps below carefully.

### **IMPORTANT NOTES:**

**Apply the brake before putting the child in the stroller and removing the child from the stroller.**

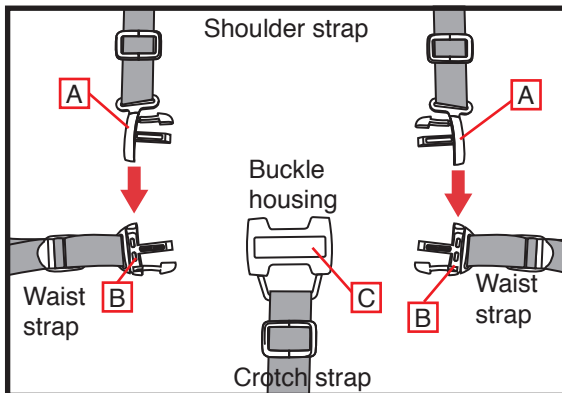

**A** Position the shoulder strap tongue (A) on the top of the waist buckle tongue (B) on both sides.

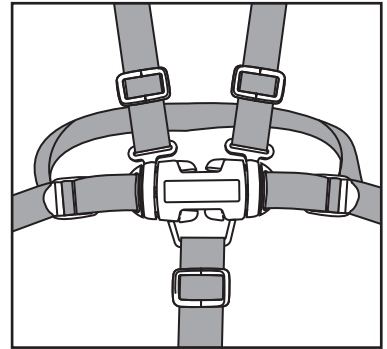
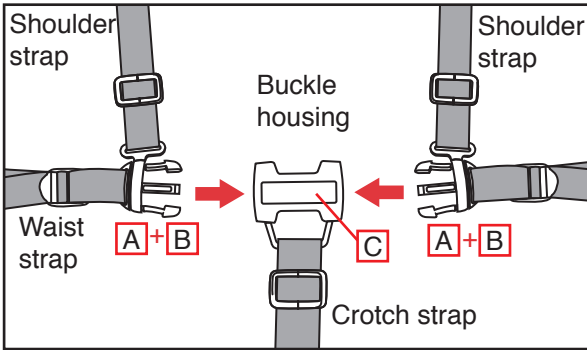

**B** Push both buckle tongues (A+B) into the buckle housing (C) until the buckle tongues lock into position.

**D** Tighten or loosen the waist straps, hold and lift the 4 bar slider and then pull the harness strap, to adjust to the desired fit. The waist strap needs to fit firmly around the child.

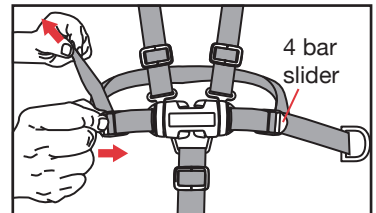

**E** Tighten or loosen the shoulder straps, slide the 3 bar slider up or down to adjust to the desired fit. Always adjust the harness strap when changing the seating position of the child.



**F** To release the buckle. Squeeze the top and buckle tongues together with enough pressure so the buckle tongues can release from the buckle housing.

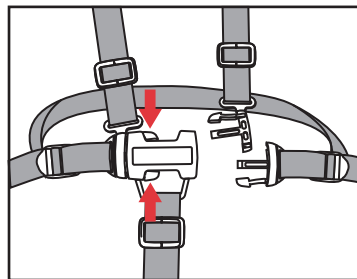

**G** The stroller seat has \*2 or 3 sets of harness slots at different heights to accommodate the child.

To change the shoulder harness height, push the shoulder harness tongue out of the current harness slot and through the back of the seat. Position the shoulder straps near the child's shoulders.

\* Depending on the model

**H** To reposition shoulder harness, pull the shoulder harness buckle tongue through the desired slot.

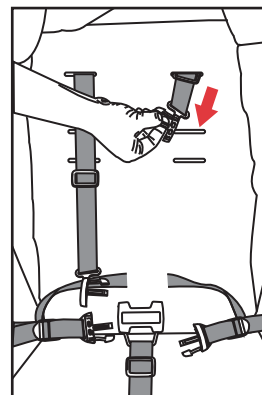
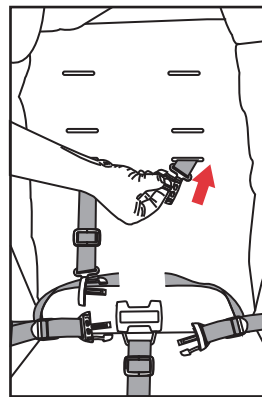

## 15. TO FIT THE SEAT LINER

**NOTE:** Release the harness buckle before fitting the seat liner.

- A** Place the Seat Liner into the Stroller.
- B** Place the each shoulder harness straps in the gap on the seat liner.
- C** Thread the each waist strap through the button hole.
- D** Thread the Crotch Strap and pad up through the button hole.

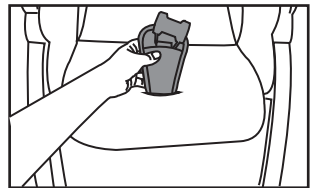
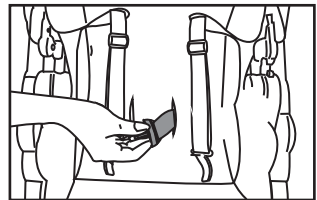
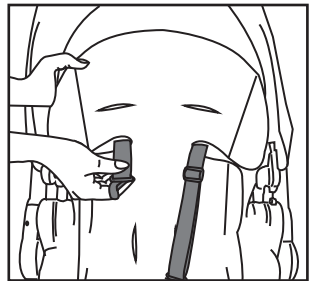
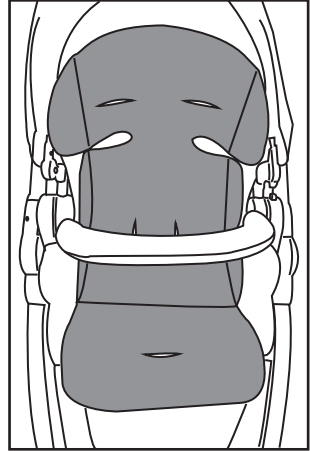

## 16. TO FIT THE SHOULDER PADS

**A** Slide each shoulder strap through each shoulder pad.

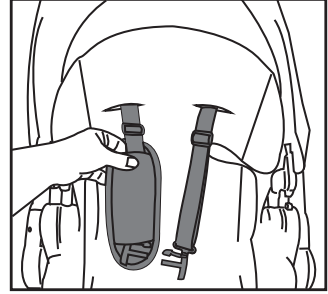

## 17. TO USE THE TETHER STRAP

### **WARNINGS:**

- **USE THE TETHER STRAP TO STOP THE STROLLER ROLLING AWAY.**
- **USE THE TETHER STRAP TO STOP THE STROLLER FROM ROLLING AWAY.**
- **NEVER LET GO OF THE STROLLER WHEN PARKED ON AN INCLINE OR SLOPING SURFACE BECAUSE IT MAY SLIDE OR TIP OVER.**
- **ALWAYS PARK ON A FLAT SURFACE AND APPLY BRAKES.**

**A** A wrist tether strap is provided near the handle. Slide your hand through the tether strap loop whenever you use the stroller, and before you release the brake. Only remove your hand from the tether strap loop when the brakes have been applied to the stroller wheels.

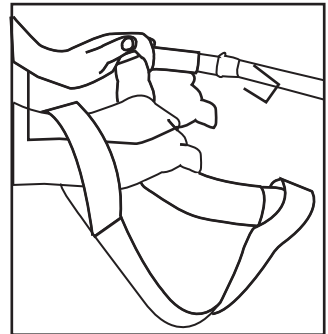

## 18. TO USE THE STROLLER

### IMPORTANT NOTE:

**THE STROLLER IS DESIGNED FOR USE ON FLAT OR GENTLY SLOPING SURFACES, AND MAY BE UNSTABLE ON HIGHER SLOPING AND UNEVEN SURFACES AND USERS SHOULD BE AWARE OF THE POSSIBILITY OF THE STROLLER ROLLING AWAY OR TIPPING OVER.**

- With your hand through the wrist tether strap loop, push the stroller holding both handles.
- The stroller can be steered in the desired direction - allowing the front wheels to swivel will make this easier.
- The front wheels may wobble or oscillate when walking fast. Locking the front swivel wheels will stop this.
- The stroller can be taken up kerbs by either pressing down on the handles and raising the front wheels and mounting the kerb or turning the stroller around and pulling the stroller up the kerb.
- Caution is required when pushing the stroller across steep slopes or uneven surfaces this may cause stroller to become unstable and fall over. Always hold the handles firmly.
- Do not run with the stroller.
- Whenever you stop, always apply the brakes before you leave the stroller.
- Do not carry shopping or bags hanging over the handle. Use the storage basket.

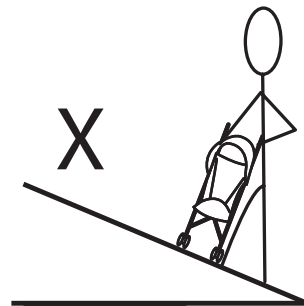
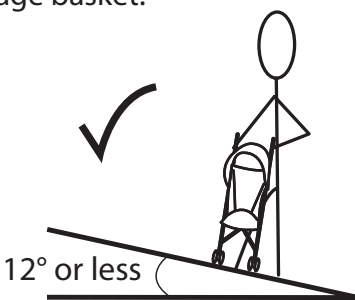



## **WARNING:**

- **THERE IS POTENTIAL FOR FINGERS OR PARTS OF THE BODY TO BE INJURED WHEN THE VEHICLE IS BEING FOLDED OR UNFOLDED, DUE CARE SHOULD BE EXERCISED.**
- **WHEN OPENING OR FOLDING THE STROLLER, BE AWARE OF THE DANGER OF BEING INJURED BY MOVING PARTS AND LOCKING DEVICES DURING THIS PROCESS. KEEP ALL HANDS AND LIMBS CLEAR OF THESE PARTS AND IN PARTICULAR BE AWARE TO KEEP CHILDREN AWAY FROM ANY DANGER.**
- **KEEP CHILDREN CLEAR OF THE VEHICLE DURING FOLDING OR UNFOLDING THE VEHICLE.**
- **REMOVE THE CHILD FROM THE STROLLER BEFORE COMMENCING ANY FOLDING OPERATION.**
- **FOLD THE STROLLER SLOWLY AND BE CAREFUL WHERE YOU PLACE YOUR HANDS. KEEPING BOTH OF YOUR HANDS ON THE HANDLE IS THE BEST WAY TO FOLD OR UNFOLD THE STROLLER.**

## **IMPORTANT NOTES:**

**When folding and unfolding the product, always ensure that the brake is engaged and all locks are properly engaged. Incorrect folding may cause damage to the stroller & frame. Please follow the folding instructions carefully.**

## 19. TO FOLD THE STROLLER

**NOTES:** With the seat attached, the stroller can only be folded with the seat in the forward facing mode.

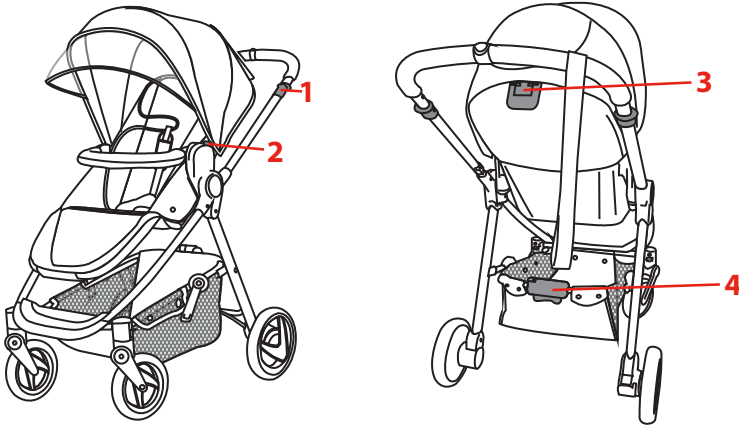

**Folding procedure by numbers 1 to 4 (as shown on the stroller)**

**A** For easy folding, **MAKE SURE THE FRONT WHEELS ARE IN SWIVEL WHEEL MODE.** If wheels are in fixed mode, the frame lock cannot engage.

**B** Push down on the brake lever to lock the brakes.

**C** Fold the canopy and put the leg support down.

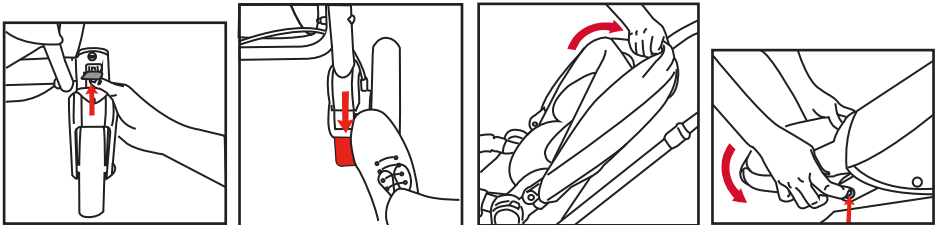

**D** Pull up on both handle release mouldings ① and fold the handle all the way forward.

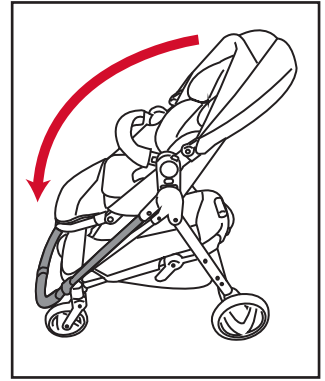
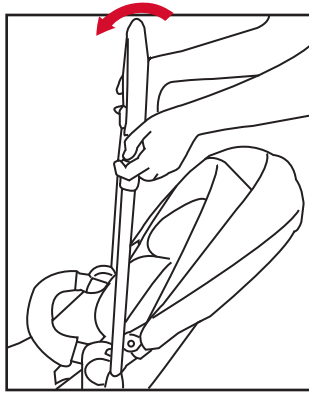
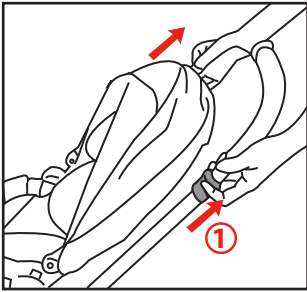

**E** With one hand, push down and hold the grey seat folding button ② on the seat moulding. Then with your other hand, lift the seat adjusting lever ③ all the way up and fold the seat forward.

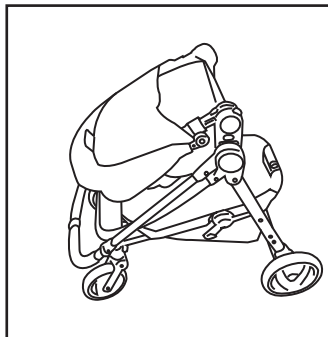
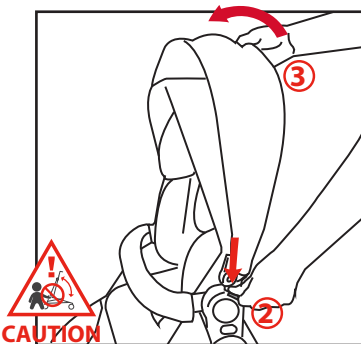

**F** With one hand , grasp the basket frame release latches. Slide the top button to the right and at the same time squeeze the button underneath and lift up. The frame will start to fold.

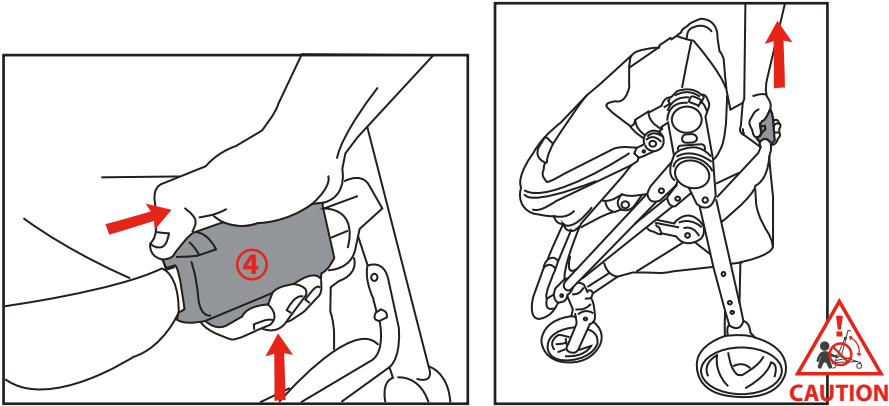

**G** Continue to fold the frame together and engage the frame lock.

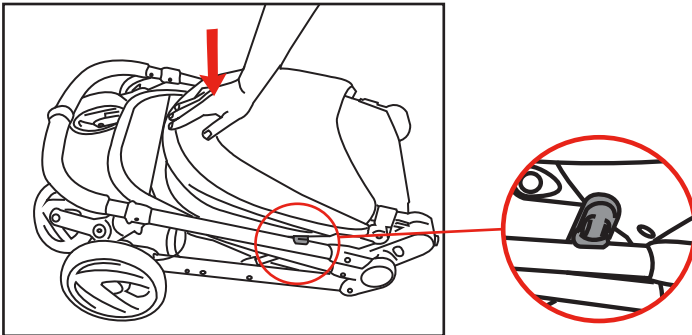

## 20. TO UNFOLD THE STROLLER

**A** To unfold the stroller, hold the stroller handle with one hand and release the frame latch with the other hand.

**B** Open the handle with both hands until handle locks into position.

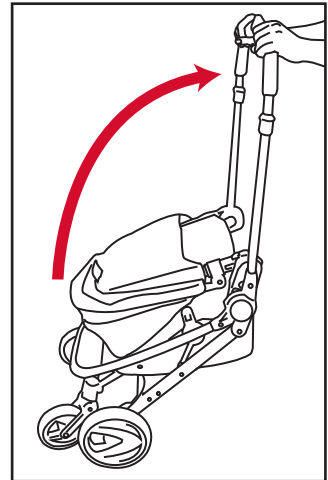
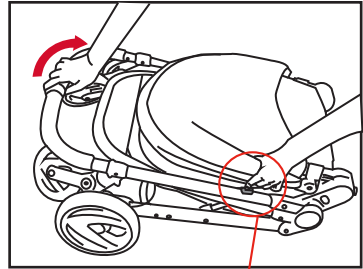

**C** While holding the handle push down the top of the basket until frame locks open.

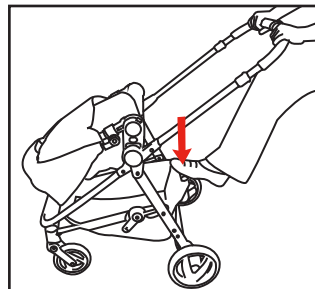

**D** Rotate the top of the seat all the way backwards until it locks. Adjust the backrest to the desired position.

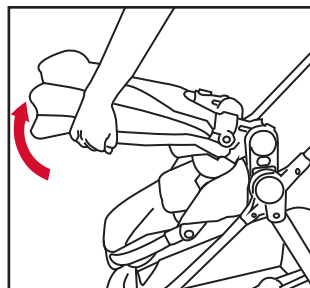

## 21. TO LIFT AND CARRY THE STROLLER

**IMPORTANT NOTES:** To lift the Stroller , grasp the frame approximately halfway along the Stroller , so the Stroller is balanced.

Please refer to page 4 Manual handling techniques.

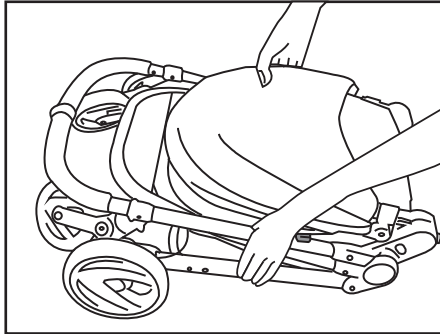

# WARNINGS:

- **IT IS UNSAFE TO USE ACCESSORIES NOT APPROVED FOR USE WITH THIS STROLLER.**
- **DO NOT USE ANY ACCESSORIES OTHER THAN THOSE APPROVED FOR USE WITH THIS STROLLER BY BRITAX.**
- **THE MAXIMUM WEIGHT OF THE CHILD USING THIS PRODUCT IS NOT TO EXCEED 9kg.**
  
- THE SOLAR INFANT CARRIER IS THE ONLY INFANT CARRIER DESIGNED TO FIT THIS STROLLER.
- THE INFANT CARRIER MUST BE CORRECTLY FITTED AND LOCKED ONTO THE STROLLER.
- THE INFANT CARRIER MUST ONLY BE USED IN THE REARWARD FACING POSITION, FITTED TO THE STROLLER FACING TOWARD THE STROLLER HANDLE.
- SECURE THE CHILD IN THE HARNESS AT ALL TIMES.
- DO NOT LEAVE THE CHILD IN THE INFANT CARRIER FOR EXTENDED PERIODS.
- THE INFANT CARRIER MUST BE REMOVED FROM THE FRAME BEFORE FOLDING.
- THE SUN IS VERY STRONG. DO NOT LEAVE YOUR CHILD EXPOSED TO THE SUN. THE CANOPY OR HOOD ON THIS PRODUCT WILL NOT GIVE YOUR CHILD TOTAL PROTECTION FROM THE HARMFUL RAYS OF THE SUN.

**Please Note: These Instructions are for installing and removing the Infant Carrier on the stroller only. For installing and proper care of the Infant Carrier in the car please follow the Instruction book that is included with the Infant Carrier.**



## 22. TO ATTACH THE INFANT CARRIER

**A** Remove stroller seat from the Frame. See section 9 To remove the seat.

**B** With the Infant Carrier handle in the upright position, locate the Infant Carrier handle mouldings on either side and push down on the Infant Carrier directly over the frame mouldings. Notice the indicator is GREEN.

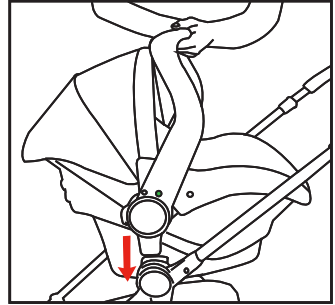

**C** By pushing in and holding the latches on either side of the handle, rotate the handle backwards. The GREEN indicator will now turn to RED.

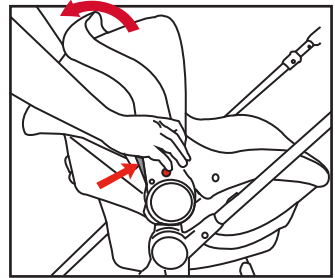

**D** Release the handle latches. Then with one hand holding the front of the Infant Carrier push the Carrier handle all the way down until you hear it lock into the frame.

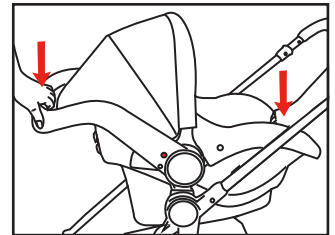

**E** The handle indicator should now be GREEN and the Infant Carrier should be locked into the frame.

**F IMPORTANT:** Pull up on both sides of the Infant Carrier and confirm it is locked into the frame. If not locked on both sides. Repeat Steps A & E.

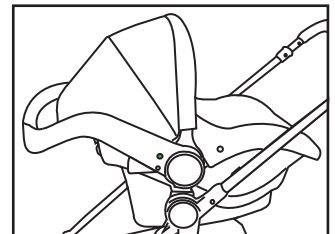

**G** Secure your baby into the Infant Carrier by the harness provided.

## 23. TO RELEASE THE INFANT CARRIER

**A** Squeeze both handle latches in to release the locks.

The indicator will now be RED.

**B** Continue to rotate the handle forward until it returns to the upright position.

The indicator should now be GREEN.

**C** Lift and remove the Infant carrier away from the stroller frame.

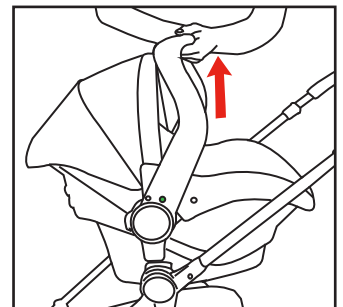
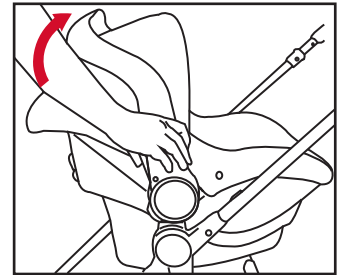
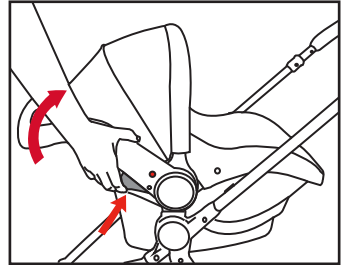

## 24. CARE AND MAINTENANCE

- To prolong the life of your stroller keep it clean and do not leave it in the direct sunlight or in the car boot for extended periods of time.
- Removable fabric covers and trims may be cleaned using warm water with a household soap or mild detergent. Allow it to dry fully, preferably away from the direct sunlight.
- Non removable fabric covers and trims may be spot cleaned using a damp sponge with soap or a mild detergent. Allow it to dry completely before folding or storing it away.
- In some climates the covers and trims may be affected by mould and mildew. To help prevent this occurring, do not fold or store the product if it is damp or wet. Always store the product in a well ventilated area.
- When using your stroller at the beach - completely clean your stroller afterwards to remove the sand and salt from the mechanisms and wheel assembly. Sand and salt will cause premature wear and corrosion.
- If there are compression marks on the tyres - Use a domestic hair dryer to gently warm (DO NOT OVERHEAT) the tyre and the compression marks should slowly disappear.
- Always check parts regularly for tightness of screws, nuts, and other fasteners - tighten if required. To maintain the safety of your nursery product, seek prompt repairs for bent, torn, worn or broken parts.

**THIS PRODUCT IS NOT INTENDED FOR COMMERCIAL USE.**

BRITAX CHILDCARE PTY. LTD A Britax International company.  
(Incorporated in Victoria) A.B.N. 55 006 773 600  
99 Derby Road, Sunshine, Victoria 3020, Australia  
Phone: (03) 9288 7288 Fax: (03) 9311 5798

**CUSTOMER SERVICE**

1300 303 330 - Australia 0508 688 822 - New Zealand

Due to our continuing program of development, Britax reserves the right to alter the specifications, color or design without any further notice.

The Steelcraft trademark is the property of Britax Childcare Pty.Ltd - Australia.

The Britax trademark is the property of Britax Excelsior Limited - UK.

Visit the Britax website at: [www.britax.com.au](http://www.britax.com.au) or email us at [au-custserv@britax.com](mailto:au-custserv@britax.com)

Due to the variations in the style and design of our products the illustrations used in this instruction booklet are generic.

This product is designed to comply with Australian and New Zealand standard AS/NZS2088:2013 Prams and Strollers - Safety Requirements.

© 2010-2013 Copyright Britax Childcare Pty. Ltd. Australia



Art No. 4001753