

**Britax**

**Safe-n-Sound™**

# SICT™ Easy Adjust™

## Convertible Child Restraint

Series No. 7200/A/2010

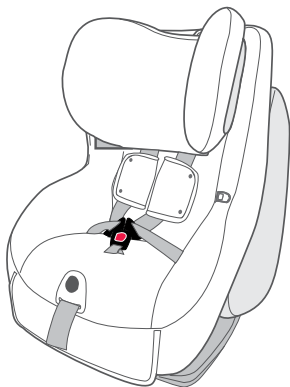
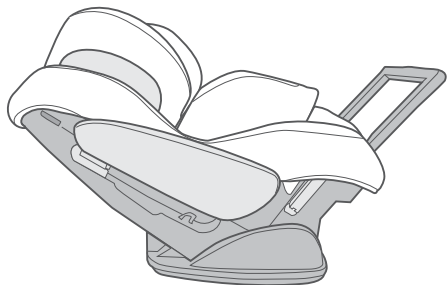

# Instructions for Installation & Use



**IMPORTANT: KEEP THIS BOOKLET IN THE PLACE PROVIDED ON THE CHILD RESTRAINT**

# INDEX

---

## PAGE

- 3 INTRODUCTION
- 4 WARNINGS
- 6 SHOULDER HEIGHT MARKERS A GROWING CHILD
- 7 SHOULDER HEIGHT MARKERS
- 8 SHOULDER HEIGHT MARKERS THE NEXT STEP
- 9 SPECIAL FEATURES: REARWARD-FACING
- 11 SUITABLE FOR USE
- 13 HOW TO SETUP
- 18 HOW TO INSTALL
- 24 HOW TO USE
- 28 SPECIAL FEATURES: FORWARD-FACING
- 30 SUITABLE FOR USE
- 31 HOW TO SETUP
- 36 HOW TO INSTALL
- 41 HOW TO USE
- 42 CARE & MAINTENANCE
- 48 ACCESSORIES
- 50 TRAVELLING TIPS
- 52 INSTALLATION OF CAR ANCHOR FITTING
- 56 IN CASE OF ACCIDENT

# INTRODUCTION

---

To be used only in a rearward-facing position for an infant until their shoulders reach the lower shoulder height marker (approximately 12 months of age). Then to be used in a forward-facing position until their shoulders reach the upper shoulder height marker (approximately 4 years of age).

Continue to use this child restraint until the child reaches this limit.

Do not use forward facing until child's shoulders are above the lower shoulder height marker.

Infants are at risk of serious injury if they face forward too early.

Children are at risk of serious injury if they move to booster seats too early.

Children that have outgrown this restraint are safest in a booster seat until their shoulders reach the upper shoulder height marker of the booster seat.

**CAREFULLY READ ALL THE INSTRUCTIONS FOR INSTALLATION. IN THE EVENT OF DOUBT ABOUT THE METHOD OF INSTALLATION, CONSULT BRITAX CHILDCARE OR AGENT OR A CHILD RESTRAINT FITTING STATION AUTHORISED BY A RELEVANT TRANSPORT AUTHORITY OR, IN NEW ZEALAND, THE AGENT FOR THE VEHICLE.**

No child restraint can guarantee absolute protection from injury in every crash. However, to ensure that your child gets all the protection designed into the restraint PLEASE READ AND FOLLOW THESE INSTRUCTIONS EXACTLY and use only BRITAX Safe-n-Sound recommended parts and accessories.

You purchased a model with the added protection of a Side Impact Cushion Technology™ you can see the Side Impact Cushion fitted on the sides of the seat. There is no installation or assembly required to activate the Side Impact Cushion, it only functions in a side crash to provide additional protection to the occupant.

**THIS RESTRAINT MUST BE ATTACHED TO A CHILD RESTRAINT ANCHORAGE POINT IN THE CAR. REFER TO CAR OWNER'S HANDBOOK FOR LOCATION OF ANCHORAGE POINTS. REFER TO A CHILD RESTRAINT FITTING STATION IF NO ANCHORAGE POINTS ARE IN THE MOTOR CAR.**

Always store the instruction book in the pocket provided on the side or the back of the cover.



## WARNINGS

- Use the restraint exactly as shown in the instructions.
- Fit the restraint firmly to the car seat.
- Fit the harness firmly to the child.
- A loose restraint or harness is dangerous.
- Supervision of children is needed because they may be able to undo buckles and adjusters.
- **DO NOT LEAVE CHILDREN UNATTENDED IN THE CAR.**
- Do not alter or modify this restraint.
- Repairs must only be done by the manufacturer or agent.
- Do not allow the restraint to come into contact with polishes, oils, bleach and other chemicals.
- Destroy the restraint if it has been in a severe crash, even if no damage is visible.
- **DO NOT USE THIS RESTRAINT WITHOUT A COVER.**
- Regularly check the restraint components, straps & other fitments for correct function and condition. Seek prompt repair.
- To ensure baby's back is evenly supported do not put more than one nappy on the baby and make sure the nappy is not thickly folded at the back.
- If an airbag is fitted in the desired seating position where the child restraint is to be fitted, follow the vehicle manufacturer's warnings and instructions.
- **DO NOT USE A REAR-FACING CHILD RESTRAINT WHERE AN AIRBAG IS FITTED IN THE FRONT OF THE SEATING POSITION.**
- The restraint should not be purchased or sold as a second hand item. It is recommended not to use child restraints older than 10 years as the protection in an accident may be reduced.
- **THIS RESTRAINT IS NOT SUITABLE FOR USE WHERE THE ANCHORAGE STRAP MAY FALL INTO A SPLIT IN THE SEAT BACK (E.G. HATCHBACK OR WAGON).**



## WARNINGS

- The restraint should not be purchased or sold as a second hand item. It is recommended not to use child restraints older than 10 years as the protection in an accident may be reduced.
- The restraint is not intended to be a substitute baby cot or bed. It is only designed to enable safe transportation of children in motor vehicles. Do not leave a baby in the restraint for long periods of time.
- Upper anchorage straps and extension straps may be damaged by unsecured cargo in a collision. Secure or remove hazardous cargo before using this strap. Hatchback or wagon: Do not use the child restraint where the upper anchorage strap may fall into a split in the seat back.
- Protect all webbing from abrasion and cutting by sharp corners and edges.
- Do not lift the seat by the headrest.
- Do not store in areas that may get hot, like in car boots, roof space, beside shed walls which get hot in summer. Do not place heavy items on top of the seat as this may distort the plastic.



## WARNING:

**DO NOT LEAVE CHILDREN UNATTENDED IN THE CAR.**

# SHOULDER HEIGHT MARKERS A GROWING CHILD

## Newborn (Rearward Facing)

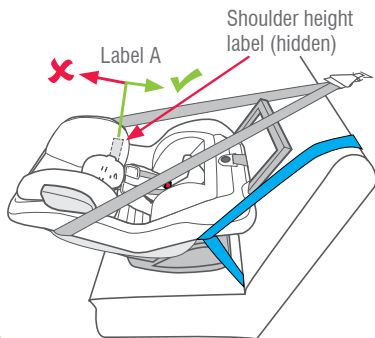

## Older baby (Rearward Facing)

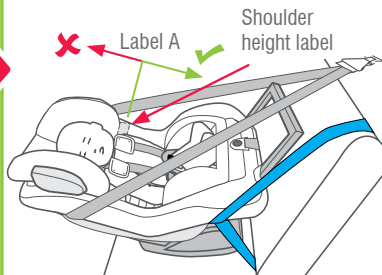

Turn to forward-facing when the child's shoulders reach the lower shoulder height marker.

## Child Use (Forward Facing)

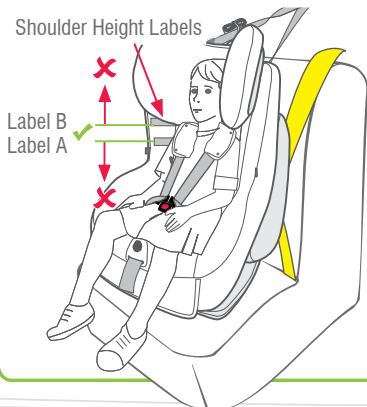

Move to the next form of child restraint when the child's shoulders reach the upper shoulder height marker.

# SHOULDER HEIGHT MARKERS

Shoulder height markers are provided on this restraint for a visual indication that the child is safe to ride in this restraint. Do not turn to forward-facing until the child's shoulder's reach the lower marker. Do not continue to use the restraint if the child's shoulders are above the top marker.

 **IMPORTANT: Follow this advice.**

## LOWER SHOULDER HEIGHT MARKER : Label A

When the child's shoulders reach the lower marker, the child restraint must be turned to face towards the front of the vehicle or move the child to another Forward Facing seat with in built harness. Approximately 12 months of age.

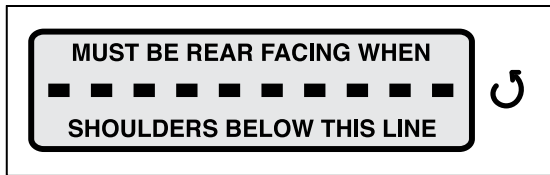

## UPPER SHOULDER HEIGHT MARKER : Label B

When the child's shoulders reach this upper marker, the child is now too big for the child restraint. It is now time to move to the next child restraint. Approximately 4 years of age.

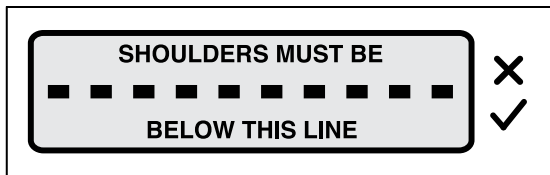

# SHOULDER HEIGHT MARKERS THE NEXT STEP

---

## For the next child restraint choose from:

- Convertible Booster Seat ( Note: you can move to a convertible booster seat once the child's shoulders reach the lower shoulder height marker),

OR

- Booster Seat and an accessory Child Harness (A Child Harness must be used if the car is fitted with a lap only seatbelt in the desired seating position),

OR

- Booster seat and lap-sash seatbelt.



Convertible Booster seat used with internal harness until approximately 4 years and then as a booster seat.



Booster seat and accessory Child Harness.

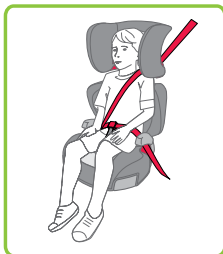

Booster seat and lap-sash seatbelt.



# SPECIAL FEATURES: REARWARD-FACING

To be used only in a rearward-facing position until the infant's shoulders reach the lower shoulder height marker (approximately 12 months of age).

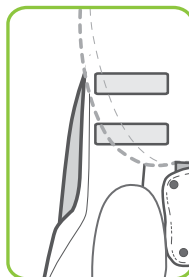

Shoulder Height Markers hidden under headrest in lowest position.

13

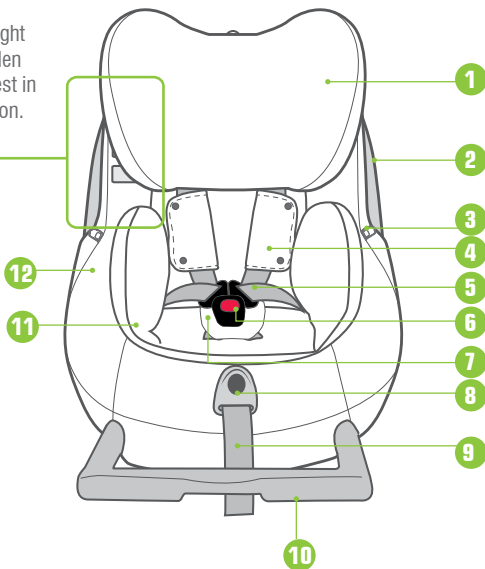

1. AHR Easy Adjust Headrest
2. Side Impact Cushion Technology™
3. Harness Tongue holders
4. Shoulder Pads
5. Fully adjustable 6 point harness
6. Quick Release Buckle (Red button)
7. Ez Buckle System
8. Harness Adjustment Button
9. Harness Adjustment Strap
10. Stabilising Bar for rearward facing use
11. Infant Safety Cushion™ Insert
12. Padded cover for comfort (may vary in style)
13. Shoulder Height Markers (Hidden behind headrest)

Harness Tongues



Harness Buckle

# SPECIAL FEATURES: REARWARD-FACING

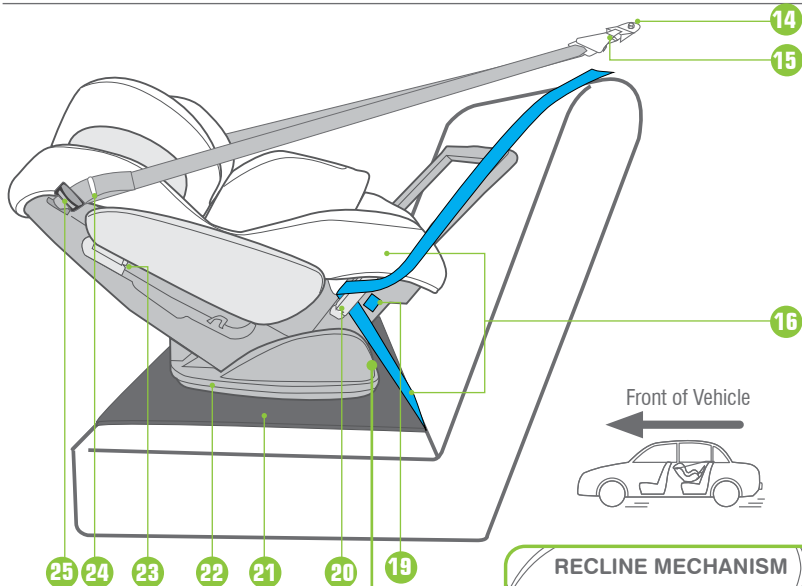

- 14. Car's Anchor Fitting
- 15. Attachment Clip
- 16. Vehicle seatbelt
- 17. Blue Release Latch
- 18. Grey Recline Latch
- 19. Blue **REARWARD FACING BELT PATH** label
- 20. Rearward-facing Lock-off
- 21. Messy Mat™
- 22. Base (shown in rearward-facing mode)

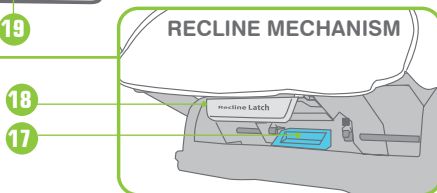

- 23. Forward facing sash belt lock-off
- 24. Upper Anchorage Storage Band
- 25. Upper Anchorage Strap Adjuster

## SUITABLE FOR USE

TO BE USED WITH A LAP SASH OR LAP ONLY SEATBELT IN THE BACK OF MOST CARS WITH FORWARD-FACING SEATS.

To be used only in a rearward-facing position until the child's shoulders reach the lower shoulder height marker (approximately 12 months of age). Then to be used in forward-facing position until the shoulders reach the upper shoulder height marker (approximately 4 years of age).

Continue to use this restraint in this rear facing mode until the child's shoulders reach the limit of the lower shoulder height marker before turning the seat to face forward. A baby's neck muscles may be unable to support their head thus the baby should remain rear facing until the neck muscles become stronger.

The purchaser should check the measurements between the front of the seat back of the rear seat and all front seats in the car in which the child restraint is intended to be used, to ensure that the space is sufficient. If you have the restraint check it fits in your car.

Regional Road Rules may prohibit the use of this restraint in the front seat until the child is 4 years of age. Check your Regional Road Rules for exemptions.

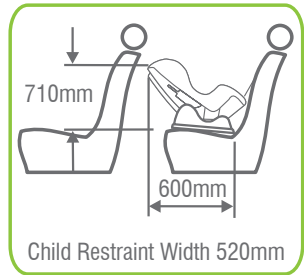

## SUITABLE FOR USE



### WARNINGS

**DO NOT USE RESTRAINT IN REARWARD FACING MODE WITHOUT STABILISING BAR FULLY EXTENDED.**

Do not use the restraint without the Upper Anchorage Strap correctly attached.

**DO NOT USE A REAR FACING CHILD RESTRAINT WHERE AN AIRBAG IS FITTED IN FRONT OF THE SEATING POSITION.**

Do not use on any vehicle seat which faces sideways or rearwards.



Do not allow the front seat to alter the installed position of the restraint. It is permissible to allow the restraint to touch the front vehicle seat.

Never leave babies or toddlers in a stationary car in the sun because of the risk of heat exhaustion. Ensure babies and toddlers have adequate ventilation and are shaded from direct sunlight through side or rear windows.

### CHILD RESTRAINT ANCHORAGE

To use this child restraint, the car will need a child restraint anchor fitting in the seating position that you intend to use. Refer to the car owner's handbook.

If no anchor fitting is provided then you will need to install an anchor fitting. Refer to pages 52 to 55.

The anchor fitting is required for attaching the upper anchorage strap in both rear facing mode and forward facing mode covered later in the these instructions.

# HOW TO SETUP

## INSTALLING INTO VEHICLE REARWARD FACING

- A.** The restraint is normally packaged in the fully upright forward facing mode so if you need to use it rearward facing you must first fully recline the restraint. Convert the restraint to rearward facing mode by referring to steps below.
- B.** If Upper Anchorage Strap is folded up for storage undo Storage Strap then lengthen. Fully press Upper Anchorage Adjuster Button (A) while pulling Upper Anchorage Strap (B) to lengthen.

Fully press Adjuster Button (A) while pulling Upper Anchorage Strap (B) to lengthen.

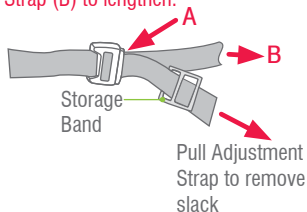

## FULLY RECLINE IN CHILD USE MODE:

Place one hand on the front corner of the base firmly while with the other hand lifts the Grey Recline Latch up to unlock, continue pulling restraint forward until fully reclined. The Blue Release Latch prevents over reclining when installed forward facing.

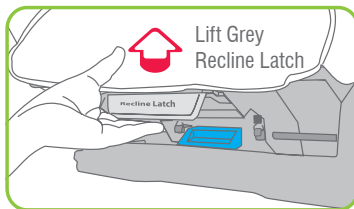

## CONVERT TO REARWARD FACING MODE:

Once fully reclined, press the Blue Release Latch located under the restraint body while with the other hand lifts the Grey Recline Latch up to unlock, continue pulling the restraint forward until fully reclined into rearward facing mode.

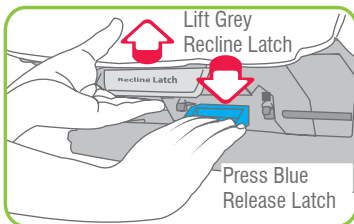

# HOW TO SETUP

## INSTALLING INTO THE CAR (USING SEATBELT)

- A.** Place restraint rearward facing in the chosen seating position with the Messy Mat™ (if fitted) positioned centrally in the seating position.
- B.** Undo the buckle and place buckle tongues in the Harness Tongue Holders on each side of the cover. Lift the flap at the end of the seat sufficiently to access the stabilising bar, pull out stabilising bar and then gently push bar forward until you hear a click. The Stabilising bar is now latched in place.

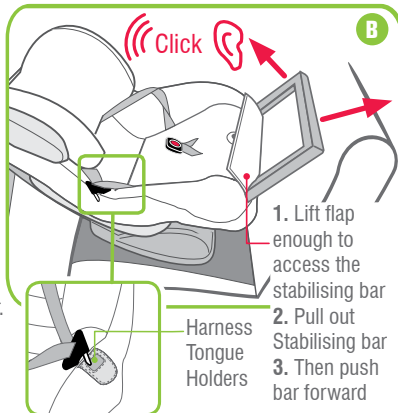

- D.** Remove the Infant Safety Cushion™ Insert, and gently lift headrest trim end, then pull back downwards the centre panel flap and Ez Buckle System, including the comfort pad from the inner seat of trim.

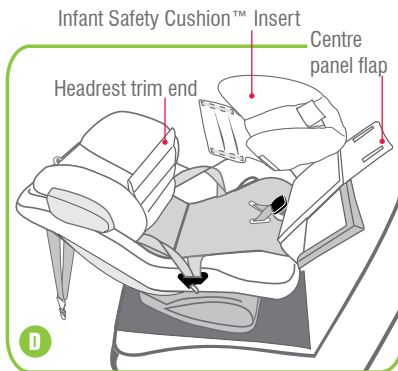

# HOW TO SETUP

- D. If using a lap-sash seatbelt, open the rearward facing lock-off. Fully lengthen the seatbelt and feed the seatbelt through the closest seatbelt path slot and pass across the seating surface behind the crotch buckle straps and through the opposite slot. Follow the blue **REARWARD FACING BELT PATH** label.

Seatbelt path slot

Lock-off (open)  
on both sides

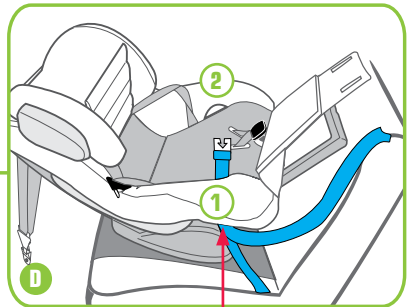
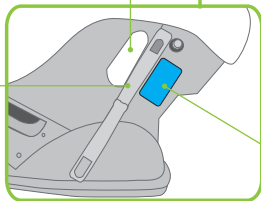

Pass buckle tongue through slots 1 and 2.

Blue - **REARWARD FACING BELT PATH** label.

- E. Engage seatbelt buckle and tongue. Firmly push down on the seat with knee or hand, whilst pulling the sash belt with the other hand to tighten the seatbelt. While holding the tension, close the lock-off on the buckle side, which will then hold this tension. Close the lock-off on the other sash side (but only clamping the lap portion). See illustrations on page 16. Do not use the lock-off if the buckle interferes with closing the lock-off.

**NOTE:** Seatbelt buckle and tongue must not rest between restraint cover and restraint. If seatbelt buckle is adjustable, adjust buckle as low as possible away from the restraint.

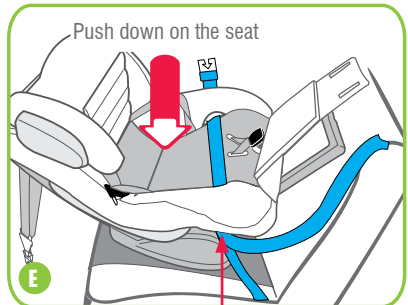

Pass buckle tongue through here

## HOW TO SETUP

**F.** Refit the harness buckle through the seat pad and fit the seat pad around the push button adjuster moulding. Refit the seat pad by connecting with the seat cover along the seat surface and up the backrest. For smaller babies replace the Infant Safety Cushion™ Insert. Do not use the insert if the child's shoulders reach the Lower Shoulder Height Marker, remove the insert for longer use whilst still rear facing. See page 23 for advice on positioning the shoulder straps and headrest.

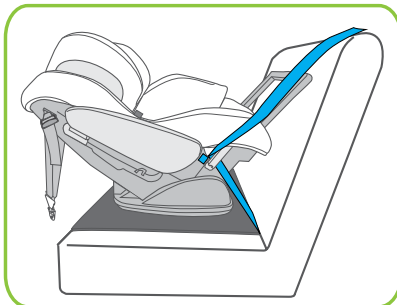

**G.** Align the restraint centrally to the chosen seating position. Pull sash portion of seatbelt until all slack is removed from lap portion of seatbelt. Adjust seatbelt to hold the restraint firmly against the vehicle seat back. For retractor seatbelts, allow excess belt to feed back into retractor. Lock the rear facing seatbelt lock-off to prevent the seatbelt slackening.

If placing the restraint in a seating position with a lap only seatbelt, tighten the seatbelt so as to hold the restraint firmly against the vehicle seat back.

On the opposite side to the seatbelt buckle, only pass the lap portion of the belt through the lock-off and lock in place (optional).

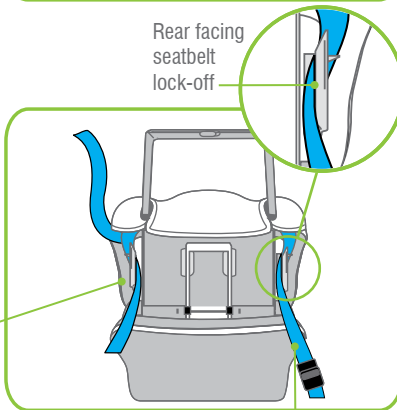

On the car seatbelt buckle side, pass both lap and sash seatbelt through the lock-off and lock in place



## HOW TO SETUP

H. Fit the attachment clip to the car's anchor fitting as shown. Make sure to remove as many twists as possible from the upper anchorage strap. Refer to the car owner's handbook for the location of the child restraint anchor fitting.

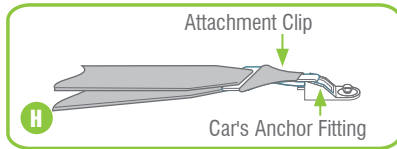

I. Tighten the adjustable upper anchorage strap by pulling adjustment strap (C) to remove slack, but do not over-tighten causing the restraint base to lift off the vehicle seat. This will usually be done once the baby has been harnessed into the seat. Roll up excess strap tightly so the webbing is thick enough to be held in the storage band. Pull Adjustment Strap to remove slack

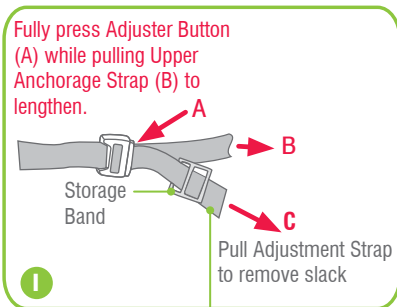

The strap will usually fit around the outside of the Side Impact Cushion. Do not over tighten the upper anchorage strap, just remove the slack from the upper anchorage strap.



# HOW TO INSTALL

Ensure the upper anchorage strap is tightened, attached to the anchor fitting and that the straps are the same length on both sides of attachment clip.

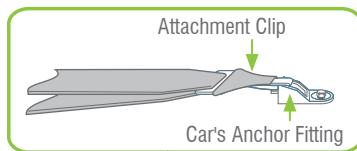

A single twist is required in rearward facing mode.

Do not use this slot for rearward facing installation

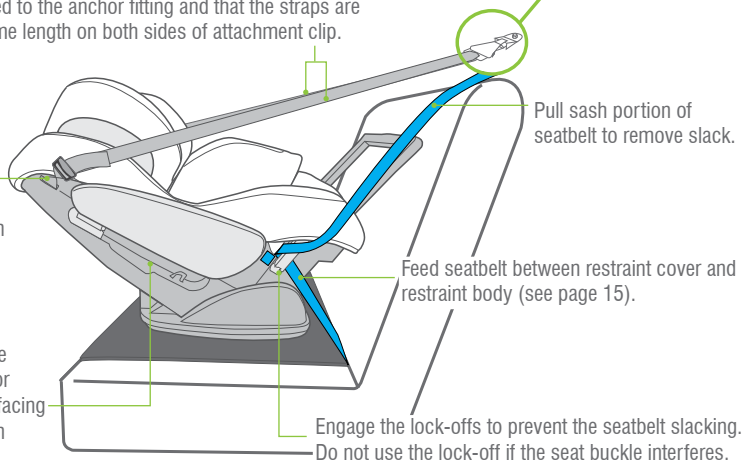

## WARNINGS

**DO NOT USE RESTRAINT IN REARWARD FACING MODE WITHOUT STABILISING BAR FULLY EXTENDED.**

**THE UPPER ANCHORAGE STRAP MUST ALWAYS BE FITTED WHEN THE CHILD RESTRAINT IS USED IN A VEHICLE.**

**ALWAYS ATTACH THE HOOK AND REMOVE THE SLACK.**

# HOW TO INSTALL

**IMPORTANT:** If using an Extension Strap, positioning the attachment clip above the baby may lead to injury in an accident therefore make sure that the attachment clip is not positioned in front of the vehicle seat. Use a shorter extension strap or no extension strap.

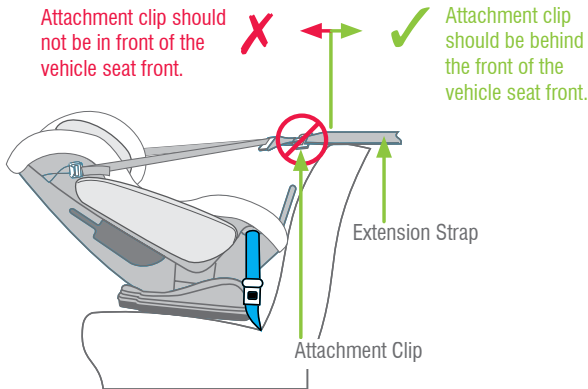

## HOW TO INSTALL

### ANGULAR ADJUSTMENT OF RESTRAINT

Some vehicle seats have more rearward slope than others. If the angle of the seat causes the baby to be too upright for comfort, the angle may be altered by placing a firm packing between the seat and the underside of the base. Packing can be a firmly rolled up towel.

Do not remove all of the rearward slope by over packing. Always leave a rearward slope angle of approximately 10 to 15 degrees as shown

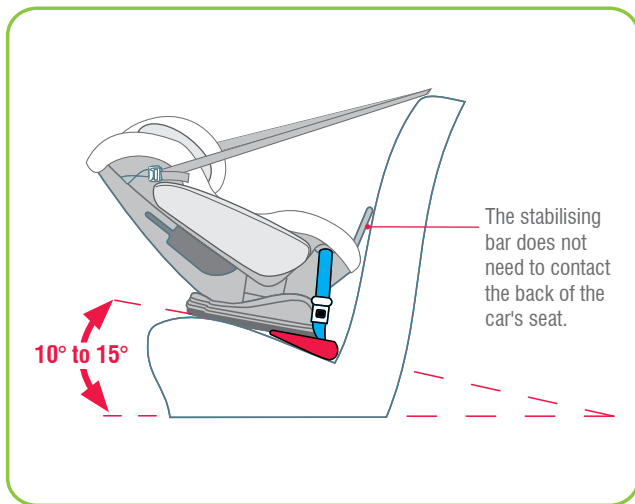

## ADJUSTING HARNESS STRAP HEIGHT & HEADREST: FOR REARWARD-FACING MODE

Correct fitment of the harness is very important as it restrains the baby in the restraint. The headrest must be in the correct position and the harness must fit firmly around upper torso of the baby and be positioned so as to leave the baby's arms and legs free.

For babies in rear facing mode the headrest must be in the position where the **top** of the shoulder strap slots are nearest to the child's shoulders, but not lower than the child's shoulders. Instructions for adjusting the headrest is on the next page. If your baby has reached the lower shoulder height marker then the restraint should be converted for "toddler use" (Refer to Forward Facing section starting on page 28).

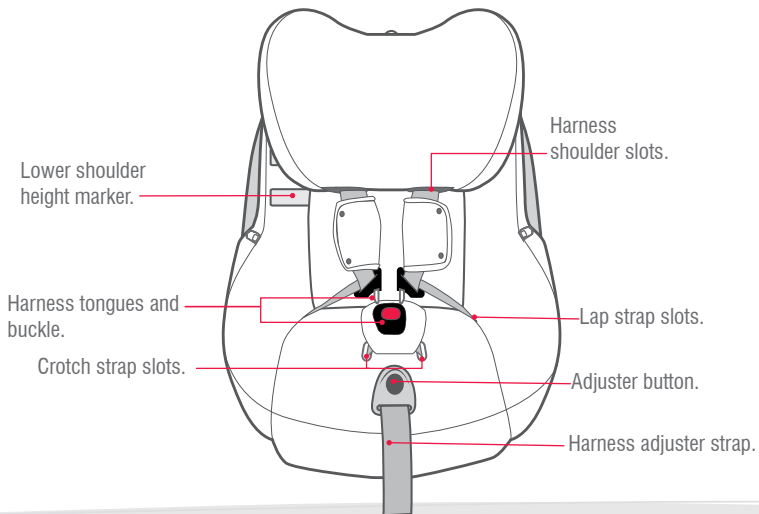

## HOW TO INSTALL

1. The shoulder straps must be in the slots which are nearest to the child's shoulders, but not lower than the child's shoulders. There is only one set of slots so the seat will always have the shoulder straps in place.
2. Use the Infant Safety Cushion™ insert when rearward facing for smaller babies until their shoulders reach the lower shoulder height marker. Remove the Infant Safety Cushion™ to create more room. Remain rearward facing until the child reaches the Lower Shoulder Height Marker again.
3. Discontinue the use of the Infant Safety Cushion™ insert if there is insufficient room for the baby or their shoulders reach the lower shoulder height marker.

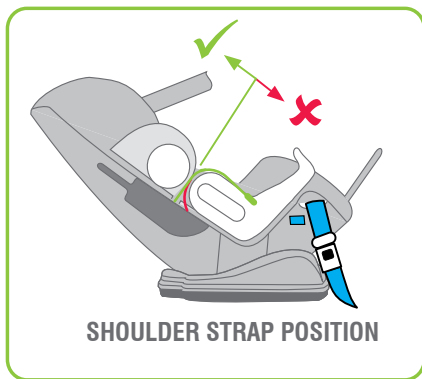

# HOW TO INSTALL



## ADJUSTING AHR EASY ADJUST HEADREST AND HARNESS STRAP HEIGHT

- A. Loosen the harness straps before adjusting the headrest.
- B. You do not need to remove the restraint from the vehicle to adjust the harness or headrest positions. Small adjustments may be done with the child in the seat, the child will need to lean forward to allow the headrest to be adjusted.
- C. To adjust the headrest, lift the Easy Adjust lever at the top of the headrest then gently pull up or push down the headrest so that the shoulder strap slots are level with or slightly above your child's shoulders. If the headrest is just above the shoulders then the harness level will be correct.
- D. Release AHR Easy Adjust Headrest Lever so that it locks into position. Ensure that it has locked in position by gently pushing down on the headrest.
- E. If the headrest is moved up, then down with the child in the seat, before use, check that the headrest cover has not bunched up behind child's back.

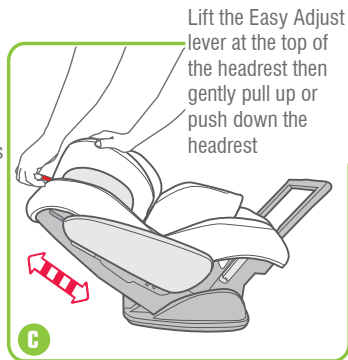

**NOTE:** For comfort ensure the bottom edges of the headrest are not contacting the child's shoulders.

**Do not adjust the headrest by pulling on the Side Impact Cushion.**

# HOW TO USE

## PLACING BABY INTO RESTRAINT

- A.** Ensure the headrest and shoulder straps are adjusted to the correct height for your child (see page 6, 7 and 22).
- B.** Slacken the upper anchorage strap and allow the straps to fall to the sides of the restraint for easy access to the baby.
- C.** Slacken harness straps by pushing and holding the harness adjustment button, grasping BOTH shoulder harness straps and pulling out the desired amount of slack. Release harness adjustment button when there is enough slack.
- D.** Lay the baby on their back into the restraint and fit harness as shown above. Make sure the baby is dressed to allow harness buckle to be pulled up between baby's legs e.g. a jump suit. Make sure the baby's arms and legs are free. Never wrap baby in a blanket before placing in restraint.

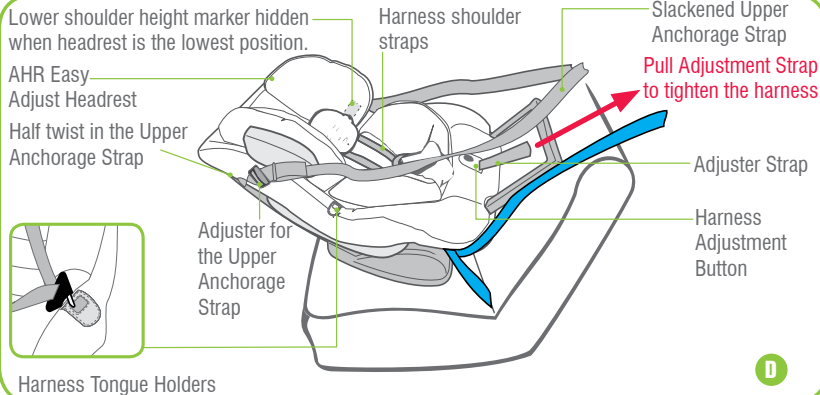



## HOW TO USE

- E. Fit either harness tongue into the harness buckle followed by the other tongue until a click is heard. Should the second tongue not insert, press the red button and reinsert the tongues. Ensure secure engagement by pulling harness straps.

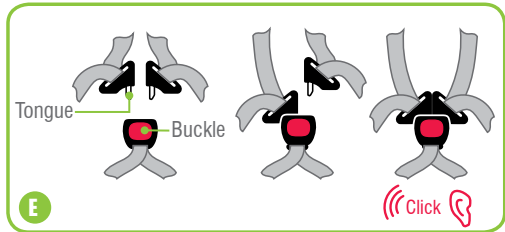

- F. Remove slack from harness lap straps by pulling shoulder straps. Then pull the adjuster strap below the push button - See illustration D on page 24.

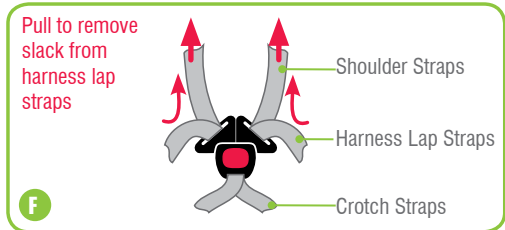

### CAUTION: A LOOSE HARNESS IS DANGEROUS.

Make sure that nothing is obstructing harness straps and that baby's arms and legs are free with the straps in the correct location - see previous page.

Do not use the restraint if straps do not tighten and contact BRITAX Childcare Customer Service. Refer to back cover for details.



### IMPORTANT:

The Infant Safety Cushion™ Insert is designed to snugly support baby for extra support and comfort and must be used for smaller babies. Discontinue use when baby's shoulder's reach the Lower Shoulder Height Marker or the Insert is a tight fit or creates discomfort for larger babies.

## HOW TO USE

**G.** Retighten adjustable upper anchorage strap by pulling adjustment strap to remove slack as shown.

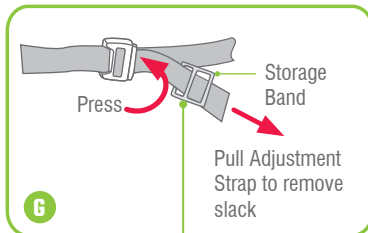

**H.** Always roll up excess strap tightly so the webbing is thick enough to be held in the storage band.

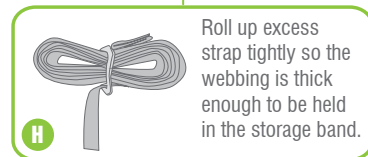

## REMOVING BABY FROM RESTRAINT

- A.** Press upper anchorage strap adjuster button while pulling upper anchorage straps to slacken. Allow upper anchorage straps to fall to the sides for easy access into restraint.
- B.** Push and hold the harness adjustment button while pulling both shoulder harness straps to slacken harness to the desired amount.
- C.** Press the red button on harness buckle then both harness tongues will be released. Insert buckle tongues into harness tongue holders to hold harness straps away from the child. Move each shoulder strap to baby's side then pick up baby.

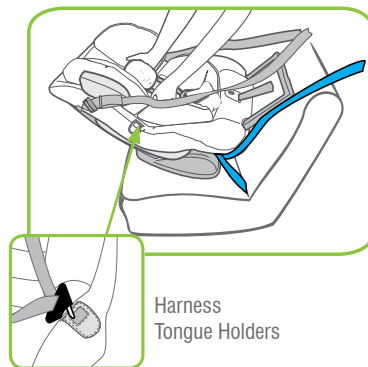

## REMOVING RESTRAINT FROM VEHICLE

- A.** Disengage the seatbelt buckle and remove seatbelt from the restraint.
- B.** Release the stored strap and fully press upper anchorage strap adjuster button (A) while pulling upper anchorage strap (B) to slacken as shown right. In some vehicles loosening of the upper anchorage strap may be difficult. If so, try pushing the restraint against the vehicle seat back or slightly lifting the restraint to release the tension.
- C.** Disengage the attachment clip from anchor fitting. The child restraint is now disconnected.  
See pages 31 and 32 for the storage of the stabilising bar and returning the seat to the upright position for forward facing mode or storage.

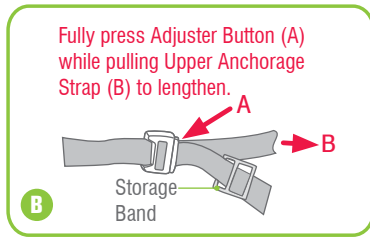

# SPECIAL FEATURES: FORWARD-FACING

To be used only in a forward-facing position by children whose shoulder's have reached the lower shoulder height marker (approximately 12 months of age) until the shoulders reach the upper shoulder height marker (approximately 4 years of age.)

FORWARD FACING

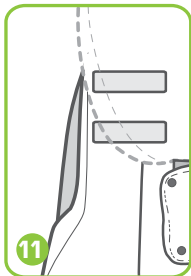

Shoulder Height Markers hidden under headrest in lowest position.

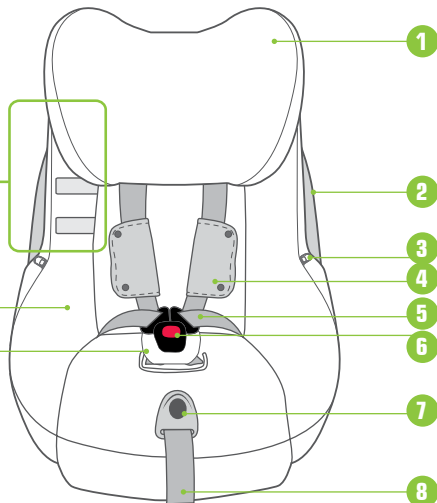

1. AHR Easy Adjust Headrest
2. Side Impact Cushion Technology™
3. Harness Tongue Holders
4. Shoulder Pads
5. Fully Adjustable 6 point harness
6. Quick Release Harness Buckle (Red button)
7. Harness Adjuster Button
8. Harness Adjustment Strap
9. Ez Buckle System
10. Padded Cover for comfort
11. Shoulder Height Markers (Hidden behind headrest)

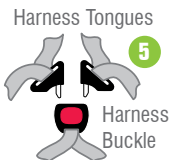

Harness Tongues

Harness Buckle

# SPECIAL FEATURES: FORWARD-FACING

- 12. Car's Anchor Fitting
- 13. Vehicle seatbelt
- 14. Forward facing sash belt lock-off
- 15. Yellow **FORWARD-FACING BELT PATH** labels
- 16. Base (shown in forward facing mode)
- 17. Messy Mat™ (if supplied)
- 18. Blue Release Latch
- 19. Grey Recline Latch
- 20. Rear facing Lock-off
- 21. Upper Anchorage Strap Adjuster
- 22. Upper Anchorage Storage Band
- 23. Adjuster Upper Anchorage Strap
- 24. Attachment Clip

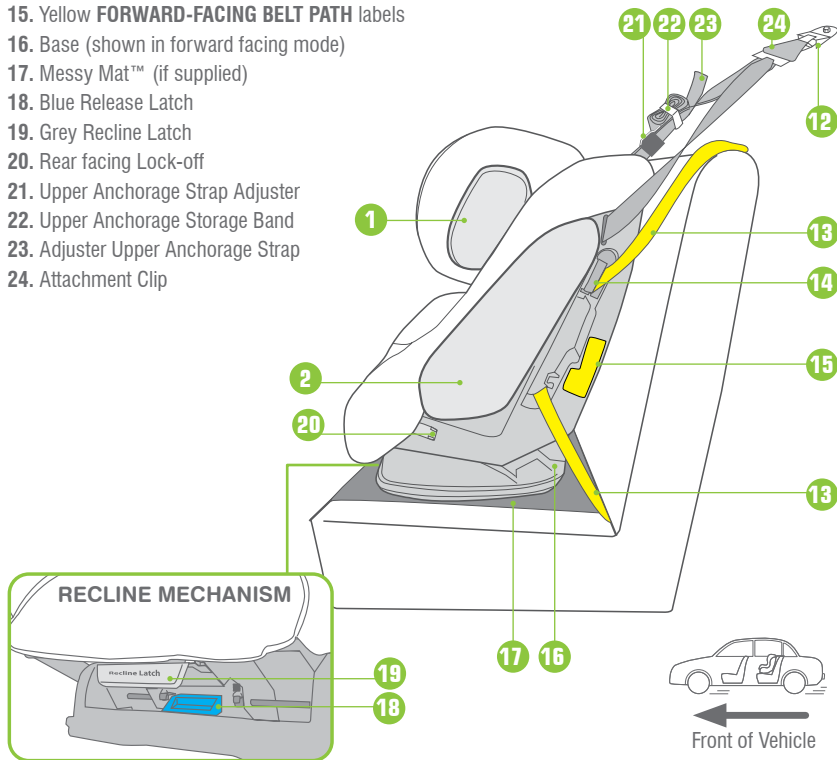

FORWARD FACING

# SUITABLE FOR USE

---

TO BE USED WITH A LAP SASH OR LAP ONLY SEATBELT IN THE BACK OF MOST CARS WITH FORWARD-FACING SEATS.

Once the child's shoulders reach the lower shoulder height marker then the seat can be changed to the forward-facing position and used until the child's shoulders reach the upper shoulder height marker.

Continue to use this restraint in this forward-facing mode until the child's shoulders reaches the limit of the upper shoulder height marker. The child should not sit forward-facing until the baby's neck muscles are able to support their head. Do not move to a Booster Seat until the child has outgrown this child restraint.

Regional Road Rules may prohibit the use of this restraint in the front seat of the vehicle until the child is 4 years of age. Check your Regional Road Rules for exemptions.



## WARNINGS

**DO NOT USE RESTRAINT IN FORWARD-FACING MODE WITH THE REAR FACING MODE STABILISING BAR PULLED OUT.**

Do not use the restraint without the Upper Anchorage Strap correctly attached.

If your vehicle is not fitted with an anchor point, please contact a Safety Restraint Fitting Station authorised by the relevant State Government Body for correct fitment of the restraint. In New Zealand contact the agent for the vehicle. The upper anchorage strap must be attached to an anchorage point using an extension strap if necessary.

Do not use on any vehicle seat which faces sideways or rearwards.

Do not use the Infant Safety Cushion™ Insert in Forward Facing 'Child Use' mode.

If an airbag is fitted in the desired seating position where the child restraint is fitted, follow the vehicle manufacturer's warnings and instructions.

Children are at risk of serious injury if they move to a booster seat too early.

# HOW TO SETUP

## INSTALLING INTO VEHICLE FORWARD FACING (UPRIGHT OR RECLINED)

- A. Remove the seat from the vehicle by disengaging the seatbelt and upper anchorage strap refer to page 41.
- B. Remove the Infant Safety Cushion™ Insert as this is no longer required. Refer to page 22.
- C. To store the stabilising bar, lift the seat pad at the end of the seat which uncovers the stabilising bar storage recess.
- D. Press the blue button on left side (facing seat) and gently push stabilising bar back and then down into the recessed area.
- E. Re-attach the seat pad at the end of the seat.

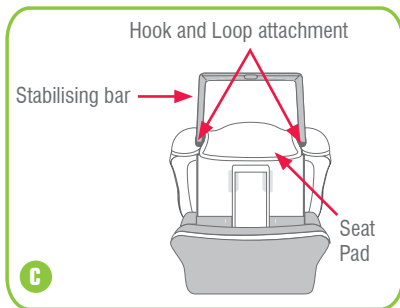

1. Button under trim

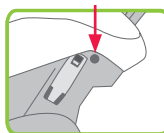

2. Rotate backwards

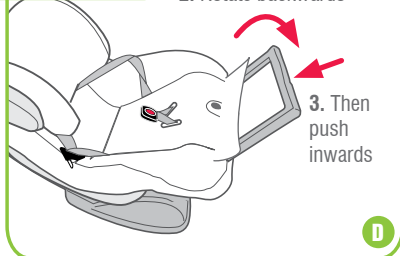

FORWARD FACING



### IMPORTANT:

**DO NOT USE RESTRAINT IN FORWARD-FACING POSITION WITH THE STABILISING BAR PULLED OUT.**

**Do not recline into baby position when using restraint in forward facing child use mode.**

Ensure harness and headrest are in the correct position (Refer to page 37 and 38).

# HOW TO SETUP

**F.** Convert the restraint to forward facing mode by placing one hand over rear corner of the base and lift the top end of restraint with the other hand until audible click is heard.

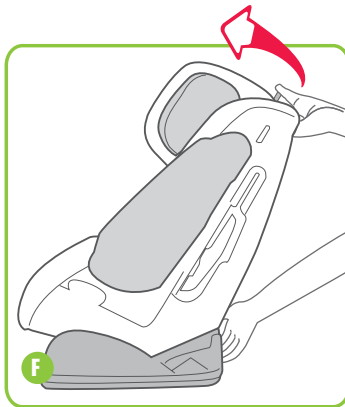

**G.** Determine whether an upright or reclined position is preferred and adjust if necessary.

**H.** To adjust the recline, place one hand on the front corner of base firmly, while with the other hand push the grey recline latch up to unlock and push back until the restraint is at the desired position. Ensure the grey recline latch is engaged in position by pushing on the restraint.

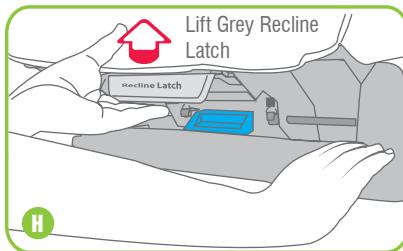



## HOW TO SETUP

- I. Position restraint in forward-facing mode and align restraint centrally to the chosen reclined seating position.

Some vehicle seat fabrics (particularly velours) may be damaged by a child restraint used continuously. We recommend the use of a messy mat or thick towel to keep the vehicle seat in good condition.



**FORWARD  
FACING**

# HOW TO SETUP

- J. Fully lengthen seatbelt. Thread the seatbelt into forward facing seatbelt path (yellow marker) as shown below, ensuring that the seatbelt is behind the harness straps and that the lap part of the seatbelt is below the hook as shown below, on each side.

**NOTE:** Seatbelt extenders should not be used. If the seatbelt is not long enough to secure the child restraint. If they are used then the buckle tongue must not enter the seating zone.

- K. Engage seatbelt buckle and tongue. Firmly push down on the seat with knee or hand, whilst pulling the sash belt with the other hand to tighten the lap portion of the car's seatbelt. Feed the sash portion into the lock-off and whilst holding the belt tension, press the lock-off lever to clamp the sash belt. For inertia/retractable seatbelts, allow excess belt to feed back into retractor.
- L. If using just a lap seatbelt, thread the seatbelt through the back of the seat following the belt path. Keep the belt under the hook on each side. Then engage the buckle and tighten the seatbelt so the restraint is held firmly against the car's back.

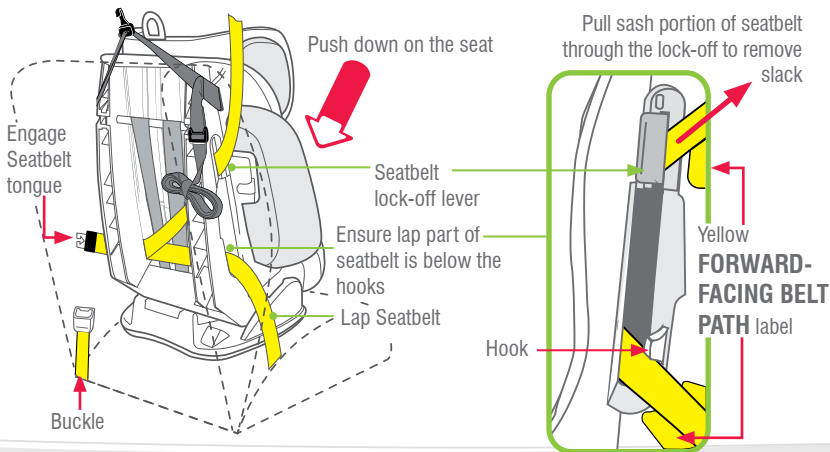

# HOW TO SETUP

## INSTALLING INTO VEHICLE FORWARD-FACING (UPRIGHT OR RECLINED)

- M. Fit the attachment clip to the anchor fitting as shown. Make sure to remove as many twists as possible from the upper anchorage strap. Refer to the car owners handbook for the location of the child restraint anchor fitting.



### WARNING

#### Always attach the hook and remove slack

- N. Tighten adjustable upper anchorage strap by pulling adjustment strap to remove slack as shown below, but do not over-tighten causing the restraint base to lift off the vehicle seat.
- O. Roll up excess strap tightly so the webbing is thick enough to be held in the storage band and is away from child's reach.



#### CAUTION:

Always roll up the excess strap otherwise it may hang outside the car door or could strangle a child.



#### IMPORTANT:

Check that the seatbelt is not twisted and the diagonal belt is only clamped by the lock-off which is located on the opposite side from the car seat buckle.

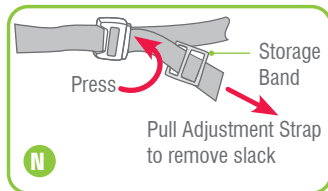
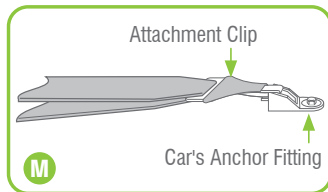

FORWARD FACING

# HOW TO INSTALL

FORWARD FACING

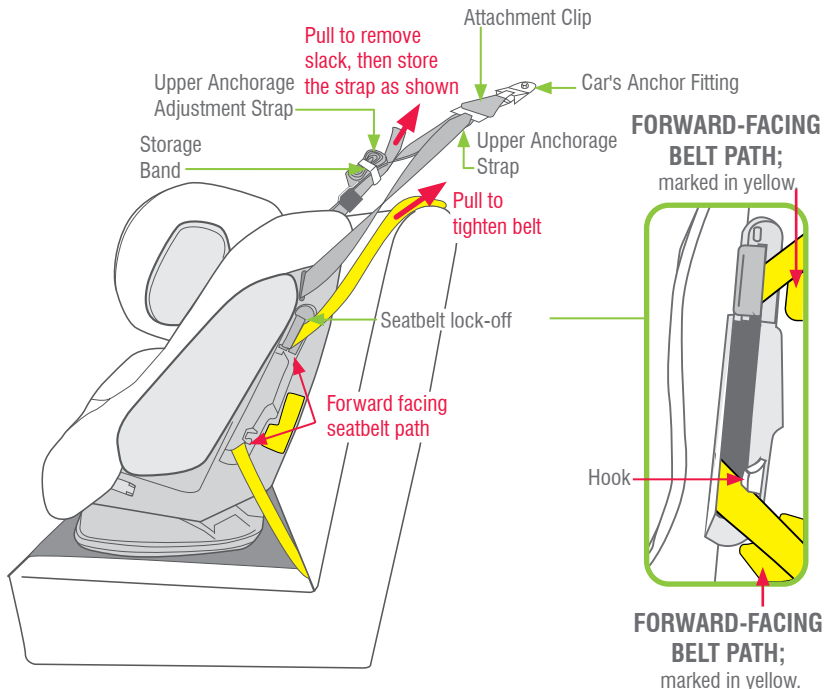

**!** **IMPORTANT: Always roll up the excess Upper Anchorage Adjustment Strap.**

# HOW TO INSTALL

## ADJUSTING HARNESS STRAP HEIGHT AND HEADREST

Correct fitment of the harness is very important as it restrains the child in the restraint. The harness must fit firmly around the upper torso of the child and be positioned so as to leave the child's arms and legs free.

The headrest must be in the position where the top of the shoulder slots are nearest to the child's shoulders, but not more than 25mm below the child's shoulders. If the headrest is in the top position and the shoulders are above the upper shoulder height marker then the child is too tall for the restraint and the restraint should not be used; move to next type of restraint (see pages 8).

The shoulder straps must be in the slots which are nearest to the child's shoulders, but not more than 25mm below the child's shoulders.

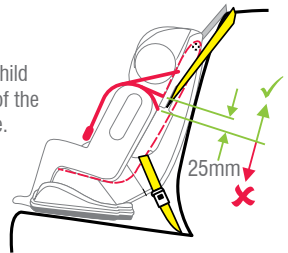

**NOTE:** This child restraint does not require the shoulder straps to be disconnected to adjust their height, only the headrest needs to be moved to adjust the shoulder strap position.

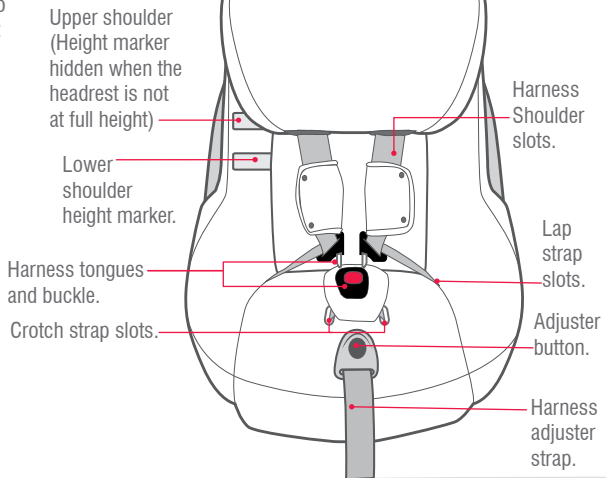

FORWARD FACING

# HOW TO INSTALL



## ADJUSTING AHR EASY ADJUST HEADREST AND HARNESS STRAP HEIGHT

- A.** Loosen the harness straps before adjusting the headrest.
- B.** You do not need to remove the restraint from the vehicle to adjust the harness or headrest positions. Small adjustments may be done with the child in the seat, the child will need to lean forward to allow the headrest to be adjusted.
- C.** To adjust the headrest, lift the red Easy Adjust lever at the top of the headrest then gently pull up or push down the headrest so that the shoulder strap slots are level with or slightly above your child's shoulders. If the headrest is just above the shoulders then the harness level will be correct. Refer to page 37.
- D.** Release AHR Easy Adjust Headrest Lever so that it locks into position. Ensure that it has locked in position by gently pushing down on it.
- E.** If the headrest is adjusted with the child in the seat, always check that the headrest cover has not bunched up behind child's back.

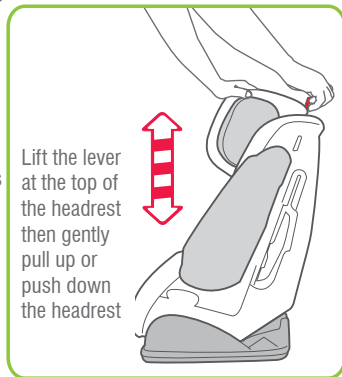

**NOTE:** For comfort ensure the bottom edges of the headrest are not contacting the child's shoulders.

**Do not adjust the headrest by pulling on the Side Impact Cushion.**

# HOW TO INSTALL

## PLACING CHILD IN THE RESTRAINT

**A.** Lengthen harness by pushing and holding the harness adjustment button while pulling on either shoulder strap until the harness will accommodate the child. Release harness adjustment button when there is enough slack and place harness straps on each side of the seat.

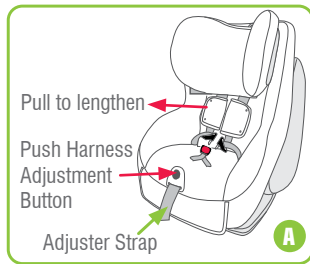

**B.** Place child in the restraint and feed each arm through shoulder straps. Pull harness buckle up between child's legs.

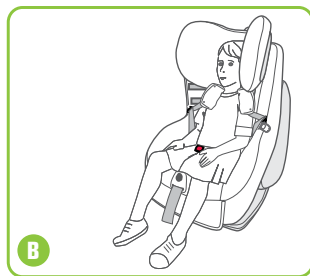

**C.** Fit either harness tongue into the harness buckle followed by the other tongue until a click is heard. Should the second tongue not insert press the red button and reinsert the tongues. The buckle fully locked when both tongues are inserted and a click is heard when the last tongue is inserted. Ensure secure engagement by pulling harness straps.

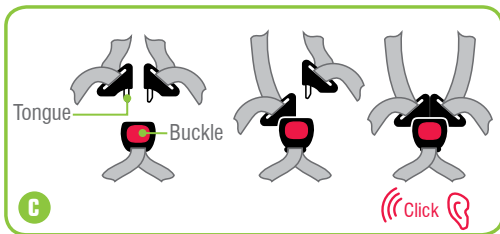

FORWARD FACING

# HOW TO INSTALL

FORWARD FACING

D. Ensure all slack is removed from harness lap straps by pulling shoulder straps, then pull harness adjustment strap to adjust harness to a comfortable but firm fit. Check that the slack in straps is removed. Shoulder harness straps must fit firmly to the child. A loose harness could result in serious injury in an accident.

Do not use restraint if straps do not tighten and contact your local authorised service agent for repair.



**CAUTION:**

**A LOOSE HARNESS IS DANGEROUS**

Pull to remove slack from harness lap straps

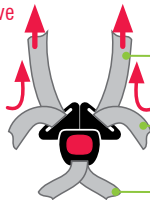

Shoulder Straps

Harness Lap Straps

Crotch Straps

D

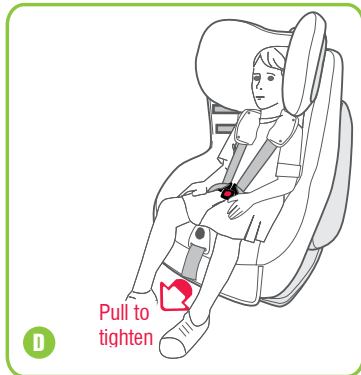

D

Pull to tighten

## TO REMOVE CHILD

Press red button on harness buckle then both harness tongues will be released. Lift the shoulder straps from the child's shoulders.



Harness  
Tongue Holders



# HOW TO USE

## TO RECLINE RESTRAINT

The child restraint may be reclined or positioned upright without removing the child from the restraint. Lift grey recline latch and push or pull to get the desired recline. There are 4 recline positions including upright. You will be able to gain partial recline from upright position lifting the grey recline latch up and pulling the seat forward (see page 13). The extent of the recline will be limited by the location of the anchorage point. Loosening of the upper anchorage strap may be required when positioning the restraint to either an upright or reclined position. Once the required position has been determined always tighten the upper anchorage strap, tighten the car's seatbelt and close the lock-off.

## TO REMOVE RESTRAINT FROM VEHICLE

- A.** Disengage seatbelt tongue from buckle and remove the seatbelt from the restraint.
- B.** Release the stored strap and fully press upper anchorage strap adjuster button (A) while pulling upper anchorage strap (B) to slacken as shown right. In some vehicles loosening of the upper anchorage strap may be difficult. If so, try pushing the restraint against the vehicle seat back or slightly lifting the restraint to release the tension.
- C.** Disengage the attachment clip from anchor fitting. The child restraint is now disconnected.

Lift grey recline latch up while moving restraint into desired recline position.

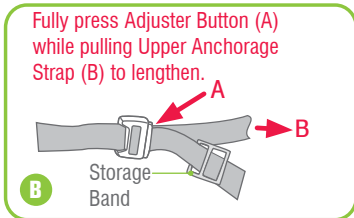
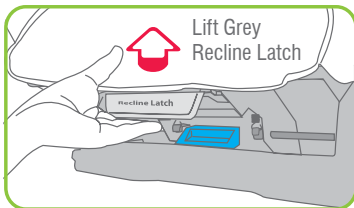

FORWARD FACING

# CARE & MAINTENANCE

---

## REGULAR CARE OF THIS RESTRAINT:

Please check the following items regularly to ensure the safety of your child:

- A.** Check the webbing of the straps for fraying,
- B.** Check that the buckle clicks and is not sluggish or sticky in operation,
- C.** Check there are no cracks in moulding,
- D.** Check the harness adjuster is operating and is clamping the webbing,
- E.** Ensure the buckle is free of fluff, liquid or other matter that may enter the buckle slots. Clean the buckle if it is sluggish to engage. See next page.
- F.** If any part of the restraint is cracked or broken, seek repair immediately or replace the child restraint.



## CLEANING CAR SEAT

Use only mild soap and water to clean all metal and plastic parts of the restraint. Do not use chemicals or cleaning agents.

**HARDWARE:** Use only mild soap and water to clean all webbing, metal and plastic parts of your child's restraint, using a damp cloth.

Do not use chemicals or cleaning agents. Do not try and place any hardware into a washing machine.

**STRAPS/HARNESS:** We would only recommend that you spot clean the straps/Harness with a damp sponge. The harness straps can be soaked, however they must be thoroughly dried without excessive heat (never tumble dry). The harness straps should not be placed in a washing machine as this may cause damage to the stitching or even damage your washing machine.

**CAR SEAT COVER:** The restraint has a flame retardant cover which is removable for cleaning, please clip the hook and loop together on the cover and seat pad (if supplied) to prevent any damage to the cover when washing. Cleaning instructions are on the care label attached to the cover. All Car Seat covers are machine washable (gentle cycle), cold water only, rinse well and dry on a flat surface. Do not tumble dry, bleach or dry-clean.

# CARE & MAINTENANCE

## BUCKLE OPERATION

To ensure the buckle remains operational the inside of the buckle must be kept free of liquids, sand, dirt, fluff, food or similar substances. If the buckle is not operating or you do not hear a strong audible click when second tongue is inserted then the buckle needs to be washed or replaced. Contact Customer Service for assistance.

## TO CLEAN HARNESS BUCKLE:

If sticky liquids such as baby formula, fruit juice, etc. get inside your harness buckle, it may become sluggish. An indication of a sluggish harness buckle is that you cannot hear a click when engaging the harness tongues. To restore the harness buckle to good working order it needs to be cleaned as follows:

- A.** Remove the harness buckle from the restraint: From the underside of the restraint pull each crotch 3-bar slide then turn the 3-bar slide and push through each slot.
- B.** Place the harness buckle under warm (max. 40 degrees Celsius) running water as shown below. Let the water run through the mouth of the buckle for five minutes. Check the harness buckle is clean by engaging the harness tongues and buckle several times until you hear a click.
- C.** If you still cannot hear a strong audible click then repeat the cleaning process several times.
- D.** Refit the harness buckle to the restraint ensuring the red button facing outwards and the 3-bar slide is fed through the same slots.

**If the Harness Buckle cannot be returned to its original working condition then contact BRITAX Customer Service for assistance.**

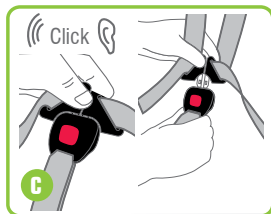
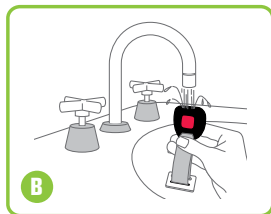
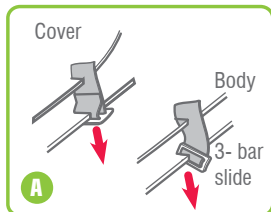

# CARE & MAINTENANCE

---

## COVER (STYLE MAY VARY)

The restraint has a flame retardant cover which is removable for cleaning. Cleaning instructions are on the care label attached to the cover. If fluffy cover is fitted then washing the cover prior to use will remove excess fluff.

Drying the Infant Safety Cushion™ Insert will take additional time as the impact foam will absorb moisture. Before washing re-engage the hook and loop on the cover and Seat Pad to prevent the 'hook' damaging the fabric.

The cover has been designed to protect your child when seated in the restraint. Care should be taken if children either eat or drink while in the restraint as some food or drink products may cause damage or marking to the cover. Wash or clean immediately.

Do not pull sticky items from covers as the cover may be damaged - soak in water and gently remove.



### **VERY IMPORTANT:**

**Only use this child restraint with the cover supplied or a manufacturer-authorised replacement cover with identical shoulder height markers.**

# CARE & MAINTENANCE

## TO REMOVE COVER:

- A. Remove the restraint from vehicle.
- B. Disengage harness tongues from harness buckle.
- C. Remove any accessories such as the Infant Safety Cushion™ Insert and Ez Buckle System.
- D. Remove headrest cover by unclipping the press studs on the headrest hardware, peel the elastic loops from behind the headrest. Pull the headrest slightly forward and peel headrest trim away from the seat.

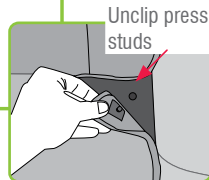
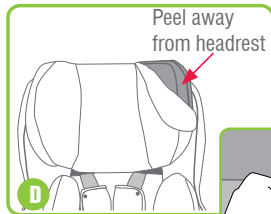

**NOTE:** The restraint is fitted with Side Impact Cushions, the headrest trim has elastic which pulls over the Side Impact Cushions that can be easily removed and replaced.

Unhook elastic loops from the back of the restraint

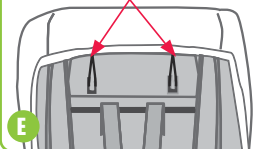

- E. To remove the cover, unhook elastic loops from behind the restraint and at the front of the restraint underneath the stabilising bar. Remove plastic flaps from the both sides of the cover (next to air cushion). Peel away from restraint while feeding through the harness adjuster button moulding, harness tongues and strap through the lap and crotch strap slots in the cover and over the headrest moulding.

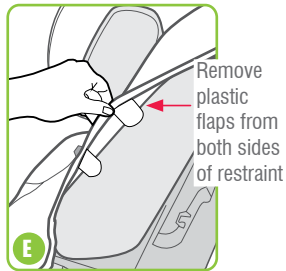

# CARE & MAINTENANCE

---

## TO REPLACE COVER:

- A. Feed the harness tongues and shoulder straps through lap strap slots.
- B. Stretch the cover over the top of the restraint first, then the sides of the child restraint, and then stretch the cover around the rim of the restraint. Feeding through the harness adjuster button and crotch strap.
- C. Clip the plastic flaps in slots of air cushion, on either side of restraint.
- D. Replace the elastic loops behind the restraint and at the front of the restraint underneath the stabilising bar.
- E. Fit the headrest cover over the headrest and feed the harness through the open slots in cover, ensure elastic is at the rear of headrest, behind cushions. Clip in press studs to the moulding.
- F. Refit the Infant Safety Cushion™ Insert, if required. See page 22 suitability.
- G. Ensure the harness straps are not twisted.

## CARE & MAINTENANCE

### TO REPLACE INFANT SAFETY CUSHION™ INSERT

The Infant Safety Cushion™ Insert is designed to snugly support baby for extra support and comfort and must be used for small babies when Rearward-Facing. Discontinue use when the Infant Safety Cushion™ Insert is tight fit or creates discomfort for larger babies. Do not use when in Forward-Facing mode.

- A. Disconnect the buckle and place the insert under the shoulder and lap straps.
- B. Attach hook and loops on both sides of Insert.
- C. Feed the crotch strap through the flap in the Infant Safety Cushion™ Insert and re-connect buckle.
- D. Tuck the flap underneath the Infant Safety Cushion™ Insert.

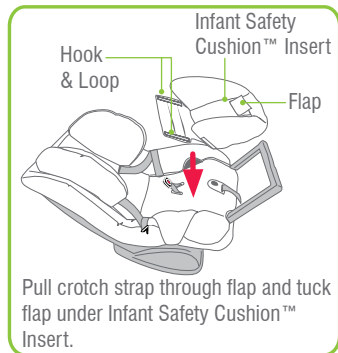

**NOTE:** Discontinue the use of Infant Safety Cushion™ Insert once the child's shoulders reach the Lower Shoulder Height Marker.

# ACCESSORIES

**ONLY USE BRITAX SAFE-N-SOUND SEAT COVERS AND ACCESSORIES THAT ARE DESIGNED AND TESTED FOR USE WITH THIS PRODUCT.**

The following instructions apply to accessories that may be supplied with this restraint at point of purchase. If not, a variety of accessories are available from various retailers of BRITAX Safe-n-Sound products.

## SHOULDER PADS

Shoulder pads are designed to provide extra comfort for baby or child and are easily fitted to the shoulder harness straps:

- A.** Pull apart the fasteners and remove shoulder pads from harness.
- B.** Re-fit shoulder pads to harness and attach fasteners for use.

## EZ BUCKLE SYSTEM (WHERE FITTED)

Ez Buckle system retains the harness buckle in a forward position and prevents the child from sitting on the buckle when boarding. Aids in opening harness and placing child in the seat.

- A.** Feed Ez Buckle system through slot in front of crotch buckle slot
- B.** Feed Crotch buckle through slot in Ez Buckle system as shown. Ensure that the Ez Buckle system is behind the buckle- i.e. the buckle is in front.

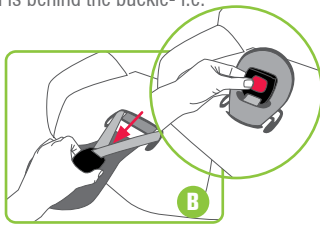
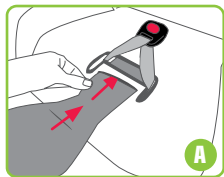
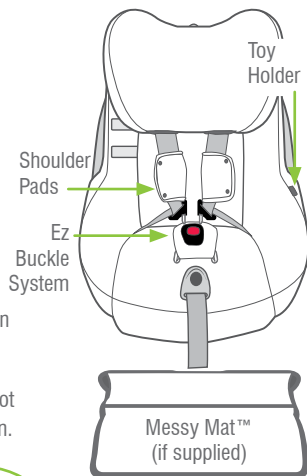



## MESSY MAT™ (IF SUPPLIED)

The messy mat has been specifically designed to protect your vehicle seat from children's shoes rubbing against it. If the Messy Mat™ has been supplied it must be used to protect the car upholstery.

### CAUTION:

The Messy Mat™ pocket is only for small, light items. DO NOT overload the pocket with heavy, bulky items as this may damage the pocket or cause passengers to trip over them.



## TOY HOLDER

The toy holder is located on the side of the cover.

Feed through strap and attach hook and loop.

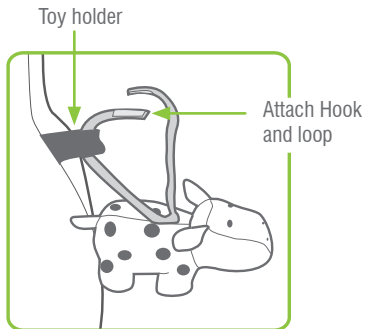

# TRAVELLING TIPS

---

## SAFETY

Never hold a baby in your arms when riding in a motor vehicle. In this position the baby could be thrown against the dashboard, windscreen or other occupant and suffer serious injury or death.

When riding in a motor vehicle never nurse a baby and use the same seatbelt for both of you. In this position the baby or child could be crushed.

Children must be secured in appropriate restraints at all times when the car is in motion. Children travelling unrestrained and standing up in the car are in danger of serious injury or death. Traffic regulations in all states require children to be secured in child restraints or adult seatbelts where available.

Plan your trip with frequent comfort stops to reduce stress on babies, young children and driver. Keep the car well ventilated to reduce heat stress. Two car windows should be kept open to maintain a good flow of fresh air if air conditioning is not used.

Never leave babies or toddlers in a stationary car in the sun because of the risk of heat exhaustion.

Ensure babies and toddlers are adequately shaded from direct sunlight through side or rear windows. Be on guard against carbon monoxide poisoning which can occur through only a slight leak in the exhaust system while travelling in a closed car.

Securely stow all heavy objects, feeding bottles, etc. that could become missiles during an accident and cause injury to any occupant.

## CLOTHING

Take several changes of clothing and bibs for possible car sickness. Disposable nappies and liners are very handy while travelling. Since it is often warmer in the car, dress the baby in light clothing. When cooler, it is easier to place a blanket over the baby than it is to remove the baby from the restraint and change clothes.

## FEEDING

**Never breast feed a baby while car is in motion.** Babies will require extra feeding if travelling in the heat. For bottle fed babies, make up the bottles and refrigerate before leaving home for a day trip. Place in a cool bag and reheat as needed with hot water from a thermos.

Alternatively, bring boiled water in a thermos and pre-measured amounts of baby formula in small containers. Use the water from the thermos to mix with the formula when required. Regardless which method is used, it is always a good plan to carry some boiled water in a sterile container or bottle.

**Do not attempt to carry warm milk because germs multiply rapidly in warm milk.**

# INSTALLATION OF CAR ANCHOR FITTING

---

Consult the vehicle owner's handbook for location of anchorage fittings or anchorage points and the possible use of spacers. Some vehicles may have an anchor fitting fitted by the vehicle manufacturer. If anchorage points cannot be found refer to car manufacturer or local child restraint fitting station or traffic authority for optimum position of anchorage point and the use of spacers.

## UPPER ANCHORAGE STRAP



### **IMPORTANT:**

THE ATTACHMENT CLIP COVER MUST ALWAYS BE USED AS IT PREVENTS THE RISK OF INCORRECT FITMENT OF THE ATTACHMENT CLIP TO THE ANCHOR FITTING. ALWAYS ENSURE THAT THE ATTACHMENT CLIP IS CORRECTLY ENGAGED TO THE ANCHOR FITTING AND NOT HOOKED OR FITTED TO ANY OTHER OBJECT BEFORE EACH USE OF THE RESTRAINT. THIS IS ESPECIALLY IMPORTANT IN VEHICLES SUCH AS STATION WAGONS, VANS, HATCH BACKS OR VEHICLES WITHOUT A FIXED PARCEL SHELF, SINCE THE ANCHOR POINT IS USUALLY NOT VISIBLE.

### **IMPORTANT INSTALLATION NOTE:**

In some vehicles the anchor fitting in the rear vertical panel can only be installed in one way. Please refer to vehicle owner's handbook or a child restraint fitting station for correct method.

# INSTALLATION OF CAR ANCHOR FITTING

Extension Strap distance to be measured.  
Length 300mm (Use BRITAX Safe-n-Sound part 0035).  
Length 600mm (Use BRITAX Safe-n-Sound part 0036).  
Available from all major child restraint retailers.

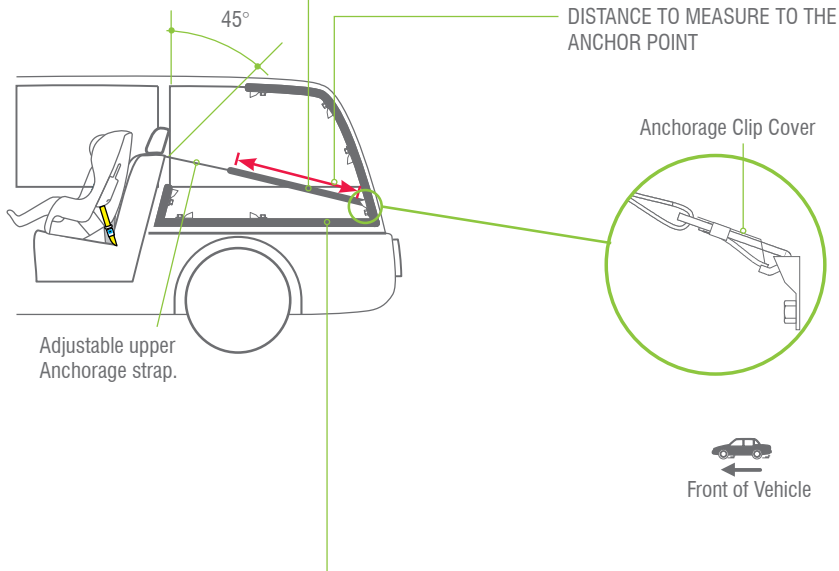

The shaded areas of this diagram illustrate the possible locations of the anchor fitting. Within each shaded area is an anchor fitting showing the correct way to install the fitting. Ensure the anchor fitting is aligned as illustrated unless stated otherwise in the vehicle owner's handbook.

# INSTALLATION OF CAR ANCHOR FITTING

## IF THE CAR IS FITTED WITH CHILD RESTRAINT ANCHORAGE POINT

Locate the anchorage point behind the rear seating position. (consult the car owners handbook for the location of the anchorage point). The anchorage point should be directly behind and central to the restraint. Remove thread plug from the parcel shelf/floor/roof, etc. and install anchor bolt and fitting as shown in Fig 1.

**CAUTION:** DO NOT OVERTIGHTEN ANCHOR BOLT. OVERTIGHTENING MAY FRACTURE OR BREAK BOLT. MAXIMUM TORQUE IS 20 Nm (14.75 ft.lb.)

**Note:** Minimum of five full turns of anchor bolt is required before tightening force is applied.

## IF THE CAR IS NOT FITTED WITH CHILD RESTRAINT ANCHORAGE POINTS

**For Sedans only** - Drill 9mm diameter hole in the parcel shelf on the centre line of the seating position as shown in Fig 3. Before drilling the hole, check the underside for accessibility. Install the anchor bolt as shown in Fig 2.

**For vehicles other than Sedans** - In Australia, consult your nearest child restraint fitting station or traffic authority for vehicle inspection to find the best, correct position for the placement of the anchorage point, and for the correct attachment bolt length and use of spacers. In New Zealand, consult the agent for the vehicle.

**Note to Queensland purchasers:** The installation of anchorage points must be approved by authorised officers appointed by Queensland Transport. Authorised officers can be sourced from all Queensland Transport Customer Service and Queensland Ambulance Service Centres.

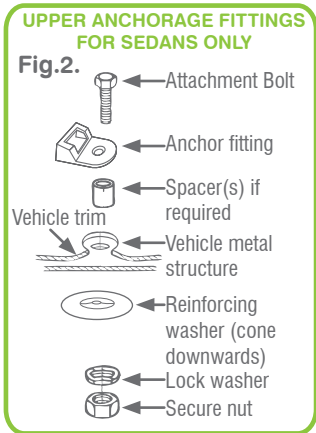
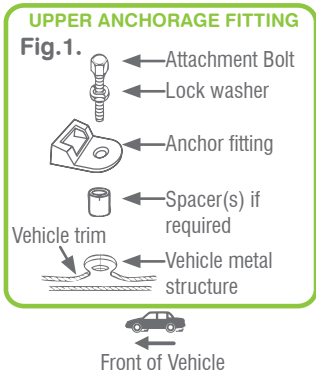

# INSTALLATION OF CAR ANCHOR FITTING

ONLY USE A 5/16 UNC GRADE 5 BOLT. IF THE BOLT IS NOT THE CORRECT LENGTH THE CAR MANUFACTURER'S HAND BOOK CAN PROVIDE ADVICE ON THE CORRECT LENGTH BOLT.



## WARNING

CHILD RESTRAINTS MUST NOT BE ATTACHED TO UNSOUND METAL OR TO WOOD, OR SYNTHETIC STRUCTURES. WHEN DRILLING 9 MM HOLE DO NOT DRILL THROUGH FUEL LINES, FUEL TANKS, ELECTRICAL WIRING, OR RADIO SPEAKERS. WEBBING STRAPS MUST BE PROTECTED FROM SHARP CORNERS AND EDGES. THE ANCHOR FITTING MUST BE USED ONLY AS DESCRIBED ABOVE. IT MUST NOT BE HOOKED ONTO ANY OTHER OBJECT.

## CAR INSTALLATION ACCESSORIES

**(From retailers of BRITAX Safe-n-Sound products)**

**EXTRA ANCHOR KITS:** Available for using the restraint in additional cars.

Re-order no: 0038

**EXTENSION STRAPS:** May be required for cars without a fixed parcel shelf.

Re-order no: 0035 (length 300mm) or

0036 (length 600mm)

**GATED 3-BAR SLIDE (Locking clip):** For converting lap-sash seatbelt to lap belt, and to obtain a better fit to the car where the fitted lock-off may not be suitable. Most cars will not need this, Re-order no: 0215.



Note: Marking on the top of a Grade 5 Bolt.



Front of Vehicle

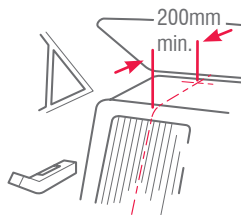

Fig.3. Centre line of seating position

# IN CASE OF ACCIDENT

---

If your restraint has been involved in a severe crash, you should destroy the restraint even if no damage is obvious. Some insurance companies offer vehicle insurance which covers or partially covers the replacement of your child restraint. Contact your insurance company for further details. Your insurance company may require you to keep the child restraint for assessment, **but do not use the child restraint after a severe crash**. To assist you in making an accident insurance claim cut the following statement and include it with your claim.

## NOTICE TO INSURANCE COMPANY CHILD RESTRAINT INVOLVED IN AN ACCIDENT

All BRITAX Safe-n-Sound child restraints are manufactured to Australian/New Zealand Standards AS/NZS1754-2010 which requires us to advise users of child restraints to "Destroy the entire restraint if it has been in use in a severe crash, even if no damage is obvious". The joint Australian/New Zealand Standards committee CS/85, advise that this statement applies whether a child was in the child restraint or not. We consider a "severe crash" as being one where the main body structure of the vehicle is distorted.

There is no method of determining if the restraint has been damaged and we concur with the Australian/New Zealand Standards in recommending destruction of the child restraint.

This notice is to advise you of the requirements of the Australian/New Zealand Standards and our obligation in complying with the standards.

Please assist the owner of this restraint in their claim.

### AUSTRALIA

BRITAX Childcare Pty. Ltd.

A.B.N 55 006 773 600

### Head office and registered address

99 Derby Road, Sunshine, Victoria 3020.

PO Box 147 Sunshine, Victoria 3020.

**Customer Service** 1300 303 330

**Email** au-custserv@BRITAX.com

**www.BRITAX.com.au**

### NEW ZEALAND

BRITAX Childcare (NZ) Ltd.

**Customer Service** 0508 688 822

**Email** nz-custserv@BRITAX.com

**www.BRITAX.co.nz**





# IN CASE OF ACCIDENT

---

## CRASH EXCHANGE

We would never want you to experience an accident, but unfortunately accidents do happen.

If you experience an accident you may be eligible for a free replacement.

The BRITAX Safe-n-Sound Crash Exchange Program is a voluntary program designed to ensure that our children are safe and that any seat that may have experienced a severe crash is taken out of the market.

There is no method of determining if the restraint has been damaged in a severe crash, so the restraint should be destroyed as the crash may reduce the child restraints ability to perform.

Since its inception in 2006, the Crash Exchange program has helped 100's of families ensure that their children have new restraints and that the restraints are not sold second hand placing others at risk.

Our Crash Exchange Terms and Application form are accessible on our website. Please visit [www.BRITAX.com.au](http://www.BRITAX.com.au) for further information.



# NOTES

---





## AUSTRALIA

Britax Childcare Pty. Ltd.  
A.B.N 55 006 773 600

### Head office and registered address

99 Derby Road, Sunshine, Victoria 3020.  
PO Box 147 Sunshine, Victoria 3020.

**Customer Service** 1300 303 330

**Email** [au-custserv@britax.com](mailto:au-custserv@britax.com)

**www.britax.com.au**

## INTERNATIONAL ENQUIRIES

Contact your local Distributor.

The Safe-n-Sound, SICT, Infant Safety Cushion and Easy Adjust trademarks are the property of BRITAX Childcare Pty. Ltd. (Australia).  
The BRITAX trademark is the property of BRITAX Excelsior Limited (UK).

We reserve the right to alter this product without notice.

© 1995-2013 BRITAX Childcare Pty. Ltd. This product is covered by Australian and overseas Patent applications. Patents pending.