

*Steelcraft*TM

BABY CAPSULE
Series No. 60/A/2013/1



**IMPORTANT: KEEP THIS BOOKLET IN THE
PLACE PROVIDED ON THE CHILD RESTRAINT**

QUICK SETUP WITH SEATBELT

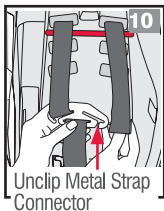
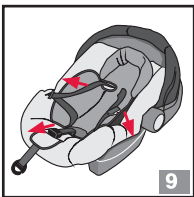
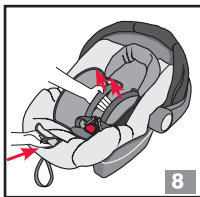
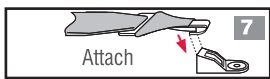
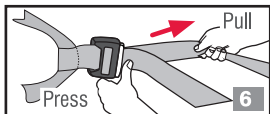
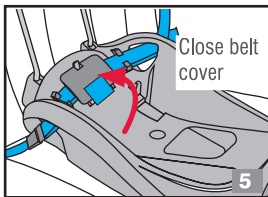
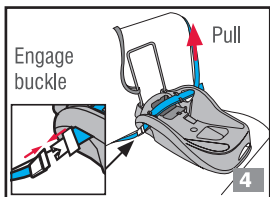
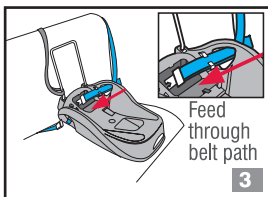
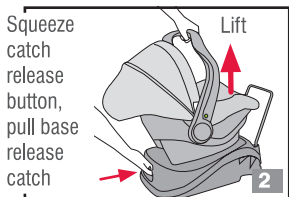
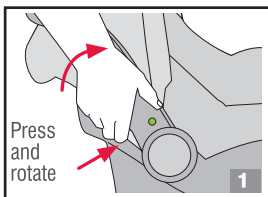

QUICK SETUP WITH SEATBELT

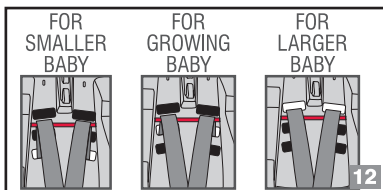
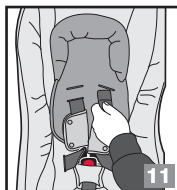

Over Cross bar

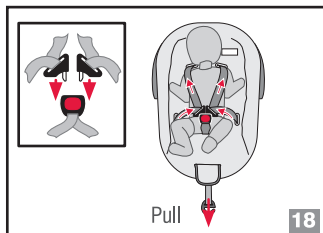
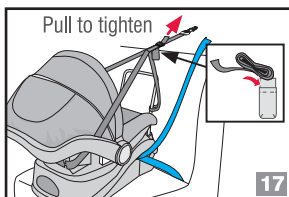
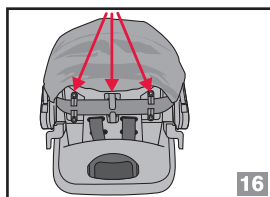
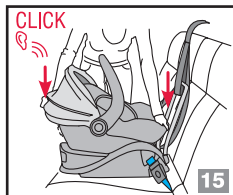
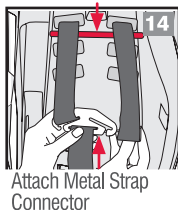
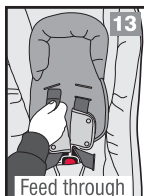

INTRODUCTION

To be used only in a rearward-facing position until the infant's shoulders reach the shoulder height marker (approximately 6 months of age).
Continue to use this infant restraint until the child reaches this limit.
Infants are at risk of serious injury if they face forward too early.

عِيَضْرِلَا يِفْتَك لَصِي يَح فَلَخَلَا إِلَى إِهْجَاوَمَلَا ةِيَعَضُولَا يِف طَقَف اِهْمَادَخْتَسَا مَتِي (رَهْشَا ةَس رَمَع يِف أَبْيَرَقَت) فَاتَكْأَلَا عَافَتَرَا ةَمَالَع إِلَى دَحَلَا اِذْه إِلَى لَفَطَلَا لَوْصَو نِيَحَلَا اِذْه عَضْرِلَا زَجَا مَادَخْتَسَا يِف رَمَتَسَا مَامْأَلَا إِلَى مَهْهِيَجْوَت مَت اِذَا ةِيرِيَطَخَلَا تَابَاَصْإِلَا إِلَى ضَرَعَتَلَلَا ةَرَطَاخَم يِف عَضْرِلَا نَوَكِي مَزَالَلَا نَم رَثْأَا ةَرَكَبَم ةَرَوْصَب.

Chỉ được sử dụng ở vị trí hướng mặt về phía sau cho đến khi vai em bé cao lên tới vạch ghi độ cao của vai (khoảng 6 tháng tuổi).
Hãy tiếp tục sử dụng ghế em bé này cho đến khi em đạt tới giới hạn này.
Bé sơ sinh có nguy cơ bị chấn thương nghiêm trọng nếu chúng hướng mặt về phía trước quá sớm.

Sólo deben utilizarse orientadas hacia atrás hasta que los hombros del niño alcancen el marcador de altura (aproximadamente a los 6 meses de edad).
Utilice este sistema de seguridad infantil hasta que el niño alcance ese límite.
El niño corre el riesgo de sufrir lesiones graves si se utiliza la silla orientada hacia adelante antes de tiempo.

僅可後向安裝使用，直至嬰兒肩膀達到肩膀高度標記（大約6個月大）。
孩子應一直採用後向式坐姿，直至其達到後向式坐姿的上限。
孩子若過早乘坐前向式汽車座椅，可能會對其造成嚴重的傷害。

Magagamit lamang sa isang nakaharap sa likuran na posisyon hanggang sa maabot ng balik at ng sanggol ang marka ng taas ng balik (humigit-kumulang 6 na buwang edad).

Ipagpatuloy ang paggamit ng pampigil ng sanggol na ito hanggang sa maabot ng bata ang limitasyong ito.

Ang mga sanggol ay nasa seryosong peligro ng pagkapinsala kung sila ay haharap sa unahan ng masyadong maaga.

केवल पीछे की तरफ मुँह करीब हुये स्थिति में तब तक प्रयोग करें जबतक शिशु का कंधा कंधे के चर्चितक न पहुँच जाए (लगभग 6 महीने की आयु पर)।

शिशु के इस सीमा तक पहुँचने तक इस शिशु प्रतबिन्ध का प्रयोग जारी रखें।

शिशुओं को समय से पहले सामने की ओर बैठाए जाने पर उन्हें गम्भीर चोट का खतरा होता है।

Da utilizzare solo in posizione rivolta all'indietro fino a quando le spalle del bambino raggiungono il marcatore di altezza della spalla (circa 6 mesi di età).

Continuare a utilizzare questo sistema di ritenuta per neonati fino a quando il bambino raggiunge questo limite.

I neonati sono a rischio di lesioni gravi se messi in posizione frontale troppo presto.

只用于后向式安装，直到婴儿的肩膀达到肩高标记（大约6个月的宝宝）

在婴儿达到该座椅上限以前必须不断使用这一婴儿安全座椅。

婴儿过早乘坐前向式座椅则可能受到严重的伤害。

Na χρησιμοποιείται μόνο σε θέση στραμμένο προς τα πίσω μέχρι οι ώμοι του βρέφους να φτάσουν τον δείκτη ύψους του ώμου (περίπου 6 μηνών). Συνεχίστε να χρησιμοποιείτε αυτό το σύστημα συγκράτησης νηπίων μέχρι το παιδί να φτάσει σε αυτό το όριο.

Τα βρέφη κινδυνεύουν με σοβαρό τραυματισμό σε περίπτωση που κοιτάζουν προς τα εμπρός πολύ νωρίς.

INTRODUCTION

TO BE USED WITH A LAP-SASH OR LAP-ONLY SEATBELT IN THE BACK OF MOST CARS WITH FORWARD FACING SEATS.

THIS RESTRAINT IS NOT SUITABLE FOR USE WHERE THE UPPER ANCHORAGE STRAP MAY FALL INTO A SPLIT IN THE SEAT BACK. (E.G. HATCHBACK OR WAGON).

CAREFULLY READ ALL THE INSTRUCTIONS FOR INSTALLATION. IN THE EVENT OF DOUBT ABOUT THE METHOD OF INSTALLATION, CONSULT BRITAX CHILDCARE OR AGENT OR A CHILD RESTRAINT FITTING STATION AUTHORISED BY A RELEVANT TRANSPORT AUTHORITY OR, IN NEW ZEALAND, THE AGENT FOR THE CAR.

No child restraint can guarantee absolute protection from injury in a crash. However, to ensure that your child gets all the protection designed into the restraint, PLEASE READ AND FOLLOW THESE INSTRUCTIONS EXACTLY and use only Safe-n-Sound or Steelcraft (Britax) recommended parts and accessories.

THIS RESTRAINT MUST BE ATTACHED TO A CHILD RESTRAINT ANCHORAGE POINT IN THE CAR. REFER TO CAR OWNER'S HANDBOOK FOR LOCATION OF ANCHORAGE POINTS. REFER TO A CHILD RESTRAINT FITTING STATION IF NO ANCHORAGE POINTS ARE IN THE MOTOR CAR.

Britax Childcare Pty. Ltd. continues to provide care for your children when travelling in motor cars with a range of child restraints suitable throughout their childhood.

Regional Road Rules may prohibit the use of this restraint in the front seat of the car. Check your Regional Road Rules for exemptions.

This instruction book can be stored under the Baby Capsule for future reference.

Page

8	WARNINGS
10	SHOULDER HEIGHT MARKERS & A GROWING CHILD
12	THE NEXT STEP
13	FEATURES
16	SUITABLE FOR USE
18	HOW TO SET-UP
21	HOW TO INSTALL
26	HOW TO USE
40	HOW TO INSTALL IN AN AIRCRAFT
43	CARE AND MAINTENANCE
49	ACCESSORIES
51	INSTALLATION OF CAR'S UPPER ANCHORAGE POINT
56	ALTERNATIVE INSTALLATION IF SEATBELT LOOSENS
58	TRAVEL SYSTEM - USE WITH STROLLER
62	TRAVELLING TIPS
63	IN CASE OF ACCIDENT
64	CONTACT DETAILS AND WARRANTY



WARNINGS

- Use the restraint exactly as shown in the instructions.
- Fit the restraint firmly to the car seat.
- Fit the harness firmly to the child.
- A loose restraint or harness is dangerous.
- **DO NOT LEAVE CHILDREN UNATTENDED IN THE CAR.**
- Supervision of children is needed because they may be able to undo the buckles and adjusters.
- **DO NOT USE A REAR-FACING CHILD RESTRAINT WHERE AN AIRBAG IS FITTED IN FRONT OF THE SEATING POSITION.** For other airbags, refer to the car owner's handbook for warnings and instructions.
- To ensure infant's back is evenly supported do not put more than one nappy on the baby and make sure the nappy is not thickly folded at the back.
- Do not alter or modify this restraint.
- Repairs must only be done by the manufacturer or agent.
- Do not allow the restraint to come into contact with polishes, oils, bleach and other chemicals.
- Destroy the restraint if it has been in a severe crash, even if no damage is visible.
- **DO NOT USE THIS RESTRAINT WITHOUT THE COVER.**
- Do not harness an infant wrapped in a blanket or swaddled. Any blanket or wrap must only be placed over the harness and infant.
- This child restraint is not approved for use with any connectors that connect to the car's ISOFIX low anchorages.
- Make sure the handle is latched properly every time you pick up the Baby Capsule.
- The restraint is not intended to be a substitute baby cot or bed. It is only designed to enable safe transportation of children in motor vehicles. Do not leave a baby in the restraint for long periods of time.



IMPORTANT :

- This restraint must be used in conjunction with a lap or lap-sash seat belt.
- Do not use the child restraint facing forwards. Do not use excessively upright or reclined.
- The restraint should not be purchased or sold as a second hand item. It is recommended not to use child restraints older than 10 years as the protection in an accident may be reduced.
- THIS RESTRAINT IS NOT SUITABLE FOR USE WHERE THE TOP TETHER STRAP MAY FALL INTO A SPLIT IN THE SEAT BACK OR OFF THE SIDE OF THE SEAT.
- THIS RESTRAINT MUST BE ATTACHED TO A CHILD RESTRAINT UPPER ANCHORAGE POINT IN THE CAR. REFER TO CAR OWNER'S HANDBOOK FOR LOCATION OF UPPER ANCHORAGE POINTS. REFER TO A CHILD RESTRAINT FITTING STATION IF NO UPPER ANCHORAGE POINTS ARE IN THE MOTOR CAR.
- Seatbelt extenders are not recommended to be used if the seatbelt is not long enough to secure the child restraint. If seatbelts are too short then seek advice from a child restraint fitter and consider their recommendations before using a seatbelt extender. If you use a seatbelt extender, ensure the seatbelt buckle does not sit above the base moulding or prevent the capsule locking onto the base.
- Always secure the loose end of the top tether strap do not use the child restraint where this strap may fall into a split in the seat back or off the side of the seat.

SHOULDER HEIGHT MARKERS & A GROWING CHILD

NEW BORN

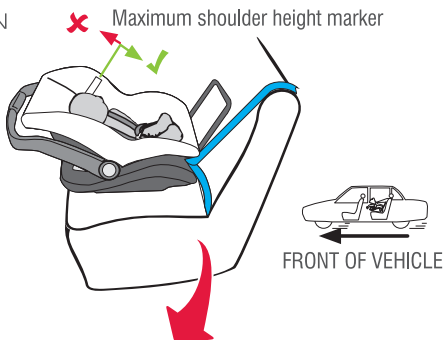

OLDER BABY

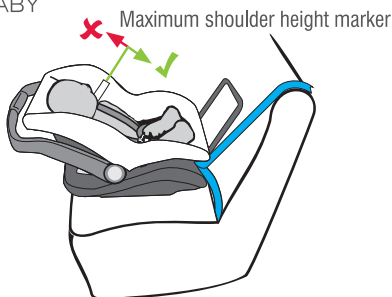

The Capsule is not suitable for your child when their shoulders are above the shoulder height marker.

If the babies neck muscles are unable to support their head, the child should remain Rearward-facing, choose a child seat that will take larger babies in Rearward-facing.

DO NOT MOVE TO THE NEXT RESTRAINT UNTIL THE SHOULDERS REACH THE SHOULDER HEIGHT MARKER.

Top Tether not shown for illustration purposes.

SHOULDER HEIGHT MARKERS & A GROWING CHILD

Shoulder height markers are provided on this restraint for a visual indication that the child is safe to travel in this restraint.

 **IMPORTANT: Follow this advice.**

MAXIMUM SHOULDER HEIGHT MARKER

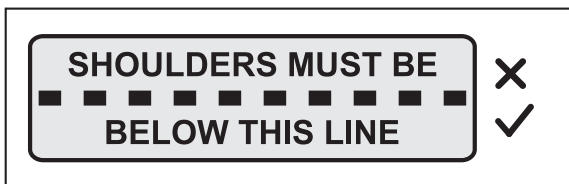

When the child's shoulders reach this marker, the child is now too big for this child restraint. It is now time to move to the next child restraint.

THE NEXT STEP

Next type of restraint that can be used in the car for your child.

When your child has outgrown the seat, you may use either:

- Convertible Child Seat, some convertible seats are suitable for up to approximately 30 months. Continue to keep your child rear facing until the shoulders reach the lower or middle shoulder height marker. Then turn to forward facing until the child reaches the upper height marker- approximately 4 years of age.

Convertible
Child Seat

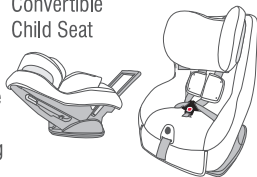

OR

- Dedicated forward facing seat with in-built harness for infants who have out grown their rear facing seat. From approximately 6 months, this can be used up to approximately 8 years of age with built-in harness.

Forward facing,
Harnessed
Child Seat

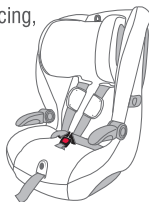

OR

- Convertible booster seat with in-built harness that faces forward- for children who have out grown their rear facing seat. From approximately 6 months, this can be used up to approximately 4 years of age with built-in harness and converted to a booster seat for use up to approximately 8 years of age.

Convertible
Booster Seat

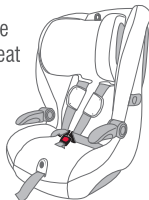

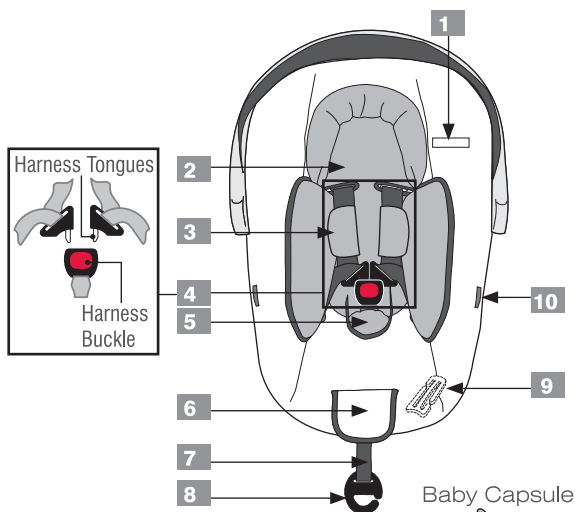

1. Shoulder Height Marker
2. Baby Insert Pad (if fitted)
3. Shoulder Pads (if fitted)
4. Harness Tongues and Buckle (Red button)
5. Buckle Pad (if fitted)
6. Harness Adjuster (under flap)
7. Harness Adjustment Strap
8. Harness Adjustment Strap Hook (disconnected)
9. 3 Bar Gated Slide (stored underneath the capsule)
10. Buckle Tongue Holders (each side - if fitted)

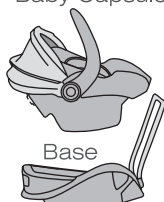

FEATURES

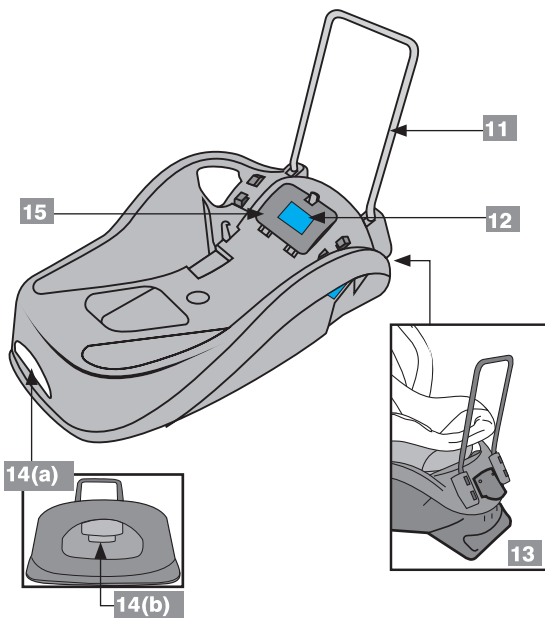

- 11. Stabilising Bar
- 12. Blue REAR-FACING SEATBELT PATH labels
- 13. Angle Adjustment Foot
- 14(a). Base Release Catch
- 14(b). Catch Release Button
- 15. Belt Cover

Top Tether not shown for illustration purposes.

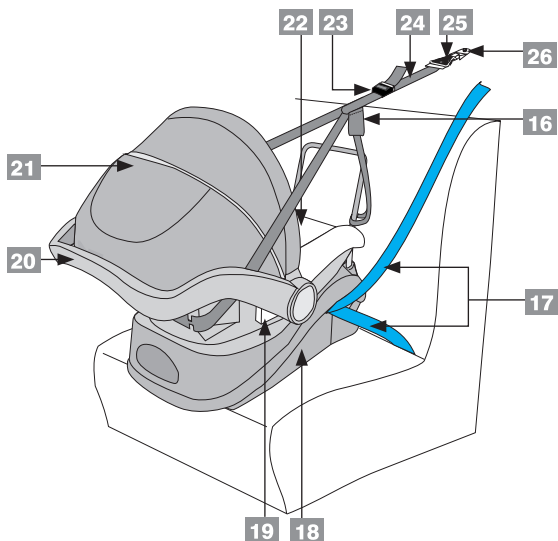

- 16. Storage Pocket
- 17. Car's Seat Belt
- 18. Base
- 19. Carry Handle Release Button
- 20. Carry Handle
- 21. Canopy
- 22. Baby Capsule
- 23. Top Tether Adjuster
- 24. Top Tether Strap
- 25. Attachment Clip
- 26. Car's Upper Anchorage fitting

SUITABLE FOR USE

To be used only in a rearward-facing position until the infant's shoulders reach the shoulder height marker (approximately 6 months of age).

Continue to use this infant restraint until the child reaches this limit.

Infants are at risk of serious injury if they face forward too early.

If the baby's neck muscles are unable to support their head, then the child should remain rear-facing, choose a restraint that will suit larger babies in a rear-facing mode.

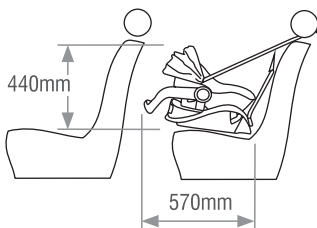

To ensure that the space is sufficient, the purchaser should check the measurements between the vehicle's rear and front seats in which the child restraint is intended to be used.

Ensure babies and toddlers are adequately shaded from direct sunlight through side or rear windows.

Check the car is ventilated by opening windows or using the car's ventilation system taking in external air. Recirculation setting is not suitable for providing ventilation.



WARNINGS

THE TETHER STRAP MUST ALWAYS BE FITTED WHEN THE CHILD RESTRAINT IS USED IN A VEHICLE.

Do not use the restraint without the top tether strap correctly attached. The top tether strap must be attached to an anchorage point using an extension strap if necessary.

The Baby Capsule may just touch the front seat, but not in such a way that the installation angle is affected.

Do not recline the seat excessively, it must be installed at the correct angle (see page 21 - 22).

Do not allow the front seat to alter the installed position of the restraint. It is permissible to allow the restraint to touch the seat on front of it.

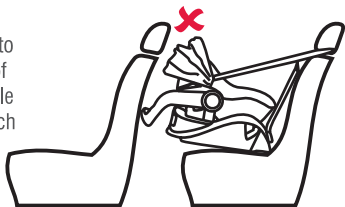

Do not use on any vehicle seat which faces sideways or rearwards. DO NOT USE A REAR-FACING CHILD RESTRAINT WHERE AN AIRBAG IS FITTED IN FRONT OF THE SEATING POSITION. For other airbags, refer to the car owner's handbook for warnings and instructions.

HOW TO SET-UP

REMOVING BABY CAPSULE FROM BASE

- A. Squeeze both release handle buttons and rotate the handle to upright carry position until the indicator is green.

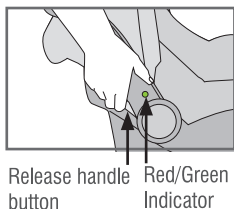

- B. Grasp the carry handle with one hand, then squeeze the base catch release button and pull out base release catch with the other hand. With the catch released, raise the Baby Capsule away from the base.

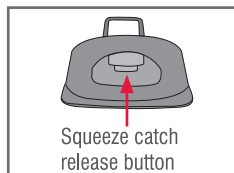

Then pull base release catch

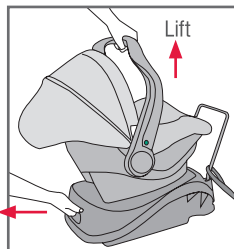

ADJUSTMENT OF HANDLE POSITION

A. The Baby Capsule features a sturdy carry handle. At the base of the handle there are handle release buttons on each side which control the three positions of the handle. The carry position is upright and suitable to carry the baby. Ensure the indicator at the side of the handle is green, which will indicate the handle is locked, and it is safe to lift the Capsule. If the indicator is red then it is not locked and unsafe to lift the baby.

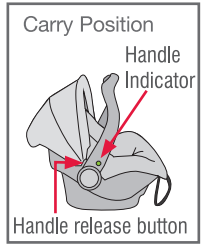

B. To convert from carry to access position, press the handle release button on each side and rotate the handle towards the front of the Baby Capsule. Rotate until the handle locks into the next position. The handle indicator will turn from Red (unlocked) to Green when the handle is locked.

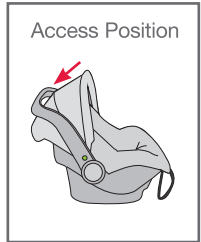

This position ensures the handle does not interfere with the attachment of the upper anchorage strap or removal of the baby.

C. To convert to a non-rocking position press both handle release buttons and rotate the handle to the next position. Ensure the handle is locked in position securely. The handle can be in any locked position when the Baby Capsule is installed in the car.

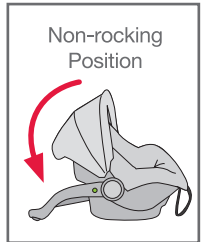

D. Press the handle release buttons to reposition the handle to suit your needs.



IMPORTANT:

Make sure the handle is locked properly every time you pick up the Capsule.

HOW TO SET-UP

TO REMOVE/FIT CANOPY

- A. To remove the Canopy, unclip the elastic Canopy loops from the cover strap clips at the handle pivot point.
- B. Then pull the plastic canopy frame out of the mouldings at both sides of the Baby Capsule.
- C. Fitting the Canopy is the reverse of the removal procedure.

Elastic Canopy loops must always be fitted when Canopy is in use.

- D. The Canopy can be rotated to cover the baby or opened by rotating to the desired position.

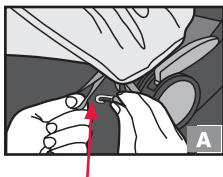

Elastic Canopy loops

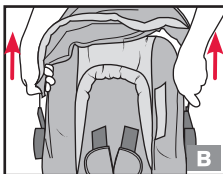

Consult the car owner's handbook for location of anchor fittings or anchorage points. Some vehicle manufacturers have an anchor fitting fitted in the car.

If there is no child restraint anchor fitting or child restraint anchor point refer to page 51 for the installation of the anchor fitting as well as the use of extension straps.

An anchor fitting is required to attach the upper anchorage strap to fully install the Capsule to the car. The upper anchorage strap must be used with this capsule when used in the car.

For installing the Base to the car, select a seating position with a child restraint anchor fitting directly behind the seating position.

INSTALLING THE BASE TO THE CAR

- A. Place the base and Baby Capsule on vehicle seat in a seating position where a child restraint anchor fitting is installed. The Level Indicator Line needs to be level with the road, (ie parallel with the road surface). Check and adjust the recline angle of the base if necessary.

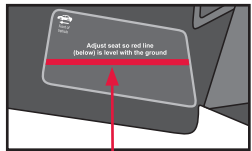

Level Indicator Line on both sides of base.

HOW TO INSTALL

B. If your car's seat is contoured, you may need to adjust the angle of the base so your baby is not too upright.

The recline angle may be altered using the three position adjustment foot located at the stabilising bar end of the base. To adjust, pull out on angle adjustment foot adjuster and lower or raise the angle adjustment foot to the desired position. Place back in the seating position and check the Level Indicator Line.

Pull flap outward, adjust recline foot then release

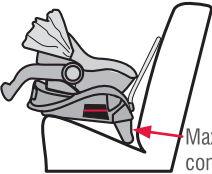
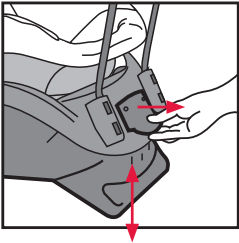

Maximum compensation

Road

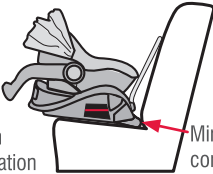

Minimum compensation

Road

HOW TO INSTALL

- C. For car's with flat seats, some packing (such as firmly rolled up nappy or towel) may be required to get a better angle and to have the stabilising bar contact the car's seatback or close to the seatback.

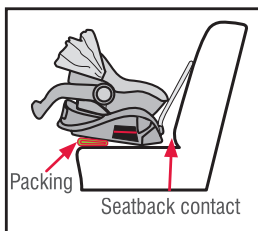

- D. Place the base into the car in the selected seating position with the Stabilising bar beside the car's seat back as shown.
- E. Open the belt cover. Extend the seat belt to maximum length. For a lap-sash seat belt, position the tongue in the middle of the fully extended belt. Feed the tongue through the seatbelt path opening and locate in the guides on each side of the base, following the blue REAR-FACING SEATBELT PATH labels on each side.

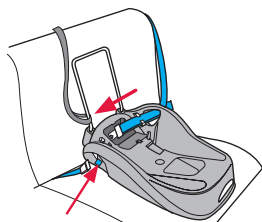

**Blue REARWARD-FACING
BELT PATH label**

Feed the Belt through the
guide hooks

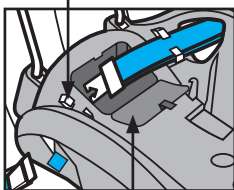

Belt Cover Open

HOW TO INSTALL

- F. Engage the seatbelt tongue to the buckle.
- G. With the base against the car seatback, remove all slack from the lap belt by pulling the sashbelt. Allow excess sash belt to feed back in to the retractor. Then close the belt cover.
- H. If the seat belt will not stay tight, then fit the 3-bar gated slide to the lap-sash belt to prevent loosening. See pages 56 to 57.

To remove the base from the car, release the seat belt, lift the belt cover and remove the seatbelt.

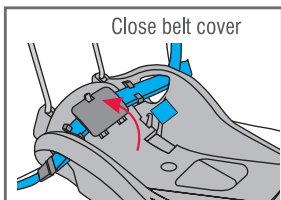
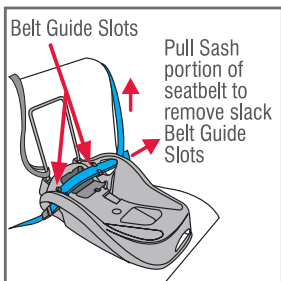

INSTALLING TOP TETHER STRAP

- A. Locate the child restraint anchor fitting in the car that is directly behind the rear seat location chosen. Refer to the car owner's manual for the location of anchorage fittings. If there is no anchorage fitting installed, refer to page 51 for instructions in adding an anchor fitting. Connect the Top Tether Strap Attachment Clip to the Anchor Fitting.

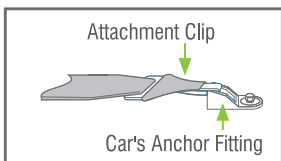

HOW TO INSTALL

Lengthen the strap by pressing the adjuster button (1) and pull the strap (2) so that the strap is ready to attach to the Capsule.

THE TOP TETHER STRAP MUST ALWAYS BE FITTED WHEN THE BABY CAPSULE IS USED IN THE CAR

Fully press Adjuster Button (1) while pulling Top Tether Strap (2) to lengthen.

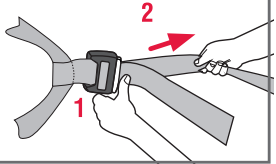

B. While the Baby Capsule is out of the car, store the top tether strap between the stabilising bar and the car seat back so that it will be ready for use when the Baby Capsule is put back in the car.

IMPORTANT :

Always secure the loose end of the top tether strap to prevent it hanging out of the car or being accessible by the child. Roll up and store loose strap in the pocket provided.

DO NOT USE THE CHILD RESTRAINT WHERE THE TOP TETHER STRAP MAY FALL INTO A SPLIT IN THE SEAT BACK OR OFF THE SIDE OF THE SEAT.

Always ensure that the car seatbelt and top tether strap are firmly restraining the restraint on the vehicle seat.

ALWAYS ATTACH TOP TETHER HOOK AND REMOVE SLACK IN THE TOP TETHER STRAP.

CAUTION:

CHILDREN CAN BE INJURED OR RESTRAINTS AND TOP TETHER STRAP DAMAGED BY UNSECURED CARGO IN A COLLISION. SECURE OR REMOVE HAZARDOUS CARGO BEFORE USING THIS CHILD RESTRAINT.

HOW TO USE

SETTING UP THE HARNESS

- A. Sit the Baby Capsule on flat ground with the handle rotated fully back to prevent rocking.
- B. Release the buckle and lengthen the Harness Straps. Press the Harness Adjuster (under the flap) while grasping both Shoulder Harness Straps and pull out the desired amount of slack.

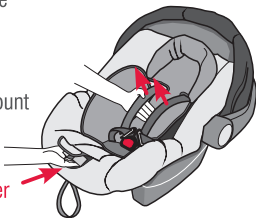

Lift the Harness Adjuster up and pull the Harness Straps to slacken.

- C. Move the two harness tongues to the sides of the Baby Capsule and store in the Buckle Tongue Holders (if fitted) (holders are on both sides of the cover). Move the harness buckle towards the Harness Adjuster.

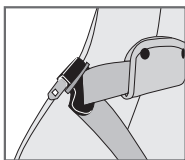

Buckle Tongue Holder (if fitted)

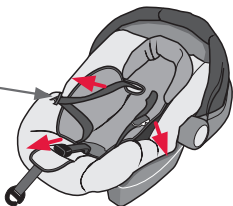

- D. Place baby into Baby Capsule lying on its back so that the buckle is between the baby's legs.

Correct fitment of the harness is very important as it restrains the baby in the Baby Capsule. The harness must fit firmly around upper torso of the baby and be positioned so as to leave the baby's arms and legs free.

This Baby Capsule needs to be used until the baby reaches the shoulder height marker. It is acceptable for the legs to be bent to fit.

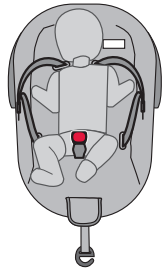

- E. The Baby Capsule is fitted with three shoulder strap positions. As the baby grows, the shoulder straps must be moved to higher slots.

The shoulder straps must be in the slots which are nearest to the child's shoulders, but not lower than the child's shoulders.

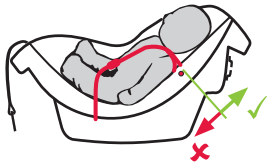

1. Upper shoulder strap slots
2. Medium shoulder strap slots
3. Lower shoulder strap slots
4. Shoulder harness strap
5. Harness tongues & buckle
6. Lap strap slot
7. Crotch strap slot
8. Maximum Shoulder Height Marker
9. Harness Adjuster (under cover flap)
10. Adjuster Strap

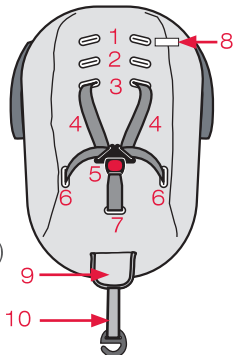

HOW TO USE

If the baby is new born you will need to use either slot 2 or 3. With the baby in the capsule, check that the slot is just above the baby's shoulder. If the strap is not in that slot then change the slot as described on the next page.

- F. At the rear of the Baby Capsule, remove one of the harness shoulder straps from metal Strap Connector by slipping strap through open slot. The Metal Strap Connector is shown in diagram right.

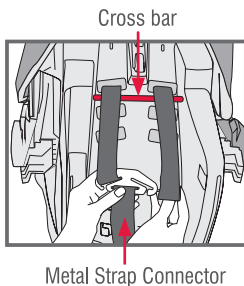

- G. Pull the shoulder strap through slot.
- H. Insert the shoulder strap through the Baby Capsule slot which will position the shoulder strap level with or above the baby's shoulder (see page 29). Ensure that the shoulder strap passes through matching slots in the cover and seat shell. If a Padded Insert is used then that will need to be re-positioned and the strap re-inserted when changing the slot position.

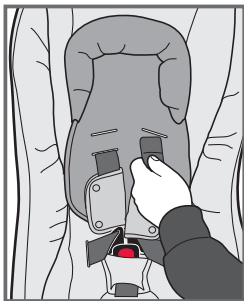

IMPORTANT:

Do not use the capsule with the harness shoulder straps set at different heights or fed through mismatching slots. Ensure the harness straps are not twisted and that all straps are secured by pulling each harness strap.

- I. Ensure there are no twists in the straps.
- J. Thread the shoulder strap over the bar and connect it to the Metal Strap Connector at rear of Baby Capsule.
- K. Repeat for the other shoulder strap. It is better to change one strap at a time so that the other strap will be a guide for re-assembly.

NOTE: Both straps must be over the cross bar to ensure that the straps will tighten fully on the baby.

FOR SMALLER
BABY

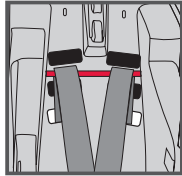

FOR GROWING
BABY

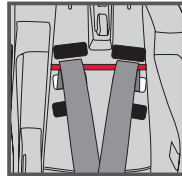

FOR LARGER
BABY

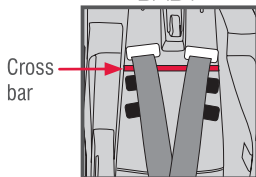

IMPORTANT :

- Always adjust the height of the shoulder straps as the child grows
- Do not use the capsule with the harness shoulder straps set at different heights or fed through mismatching slots.
- Ensure the harness straps are not twisted and that all straps are secured by pulling each harness strap.

HOW TO USE

PLACING BABY IN BABY CAPSULE

When positioning baby into Baby Capsule make sure baby's back is fully supported onto the flat section and the baby's nappy area (bottom) is resting in the bottom curvature as shown. It is recommended that bulky nappies are not used when baby is travelling in the Baby Capsule as they can cause incorrect positioning of the baby's back in the Baby Capsule.

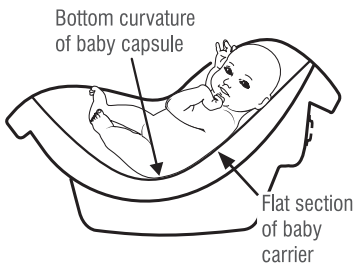

- A. Loosen Harness Straps by pressing the Harness Adjuster while grasping both the Shoulder Harness Straps and pulling out the desired amount of slack.

Press the Harness Adjuster and pull Harness Straps to loosen.



- B. Locate the harness tongues into the Buckle Tongue Holders (if fitted). Move the harness buckle towards the Harness Adjuster.

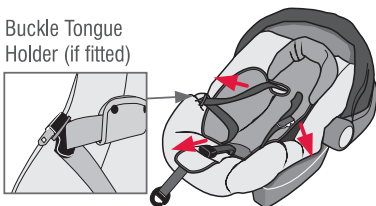

- C. Place baby into Baby Capsule lying on its back so that the buckle is between the baby's legs. Ensure that baby's arms and legs are free. Make sure baby is dressed to allow the Harness Buckle to be pulled up between baby's legs e.g. a jump suit.

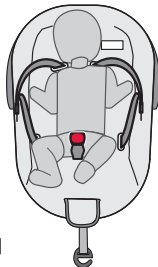

NOTE:

1. Discontinue using the Padded Insert when shoulder straps are in the top slots or if the Pad causes over heating, discomfort or you need more room for baby to grow.
2. Correct fitment of the harness is very important as it restrains the baby in the Baby Capsule. The harness must fit firmly around upper torso of the baby and be positioned so as to leave the baby's arms and legs free.

CAUTION:

Do not harness an infant wrapped in a blanket or swaddled as this increases the risk of ejection and injury or death in a crash. The harness needs to fit firmly to the baby, any blanket or other covering may be placed over the harness after the harness is adjusted. Arms and legs must be free and not bound. The legs must sit on each side of the crotch strap.

HOW TO USE

SECURING BABY IN BABY CAPSULE

- A. Place each arm through each shoulder strap of the harness. Position the buckle of the crotch strap as shown right.

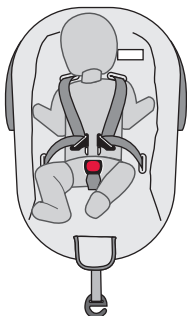

- B. Fit either harness tongue into the Harness buckle followed by the other tongue until a click is heard. If the second tongue does not engage - press the red button and re-insert the tongues. Check secure engagement by pulling harness straps.

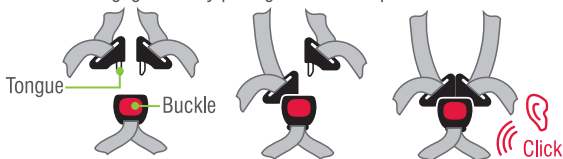

CAUTION:

The end of the harness adjustment strap is connected to the cover to avoid tripping over the end. Ensure the harness adjustment strap hook is attached when carrying the capsule (see page 33).



- C. Ensure slack is removed from the lap straps by pulling the shoulder harness straps through the buckle tongues, then pull the Harness Adjustment Strap to take up the slack in the harness, adjusting to a firm but comfortable fit. Make sure the baby's arms and legs are free and the crotch strap is between the legs. Check that the slack in straps is minimal.

Do not use the restraint if straps do not tighten. Contact your local authorised service agent for repair.

Pull Harness Straps through the buckle in direction of arrows

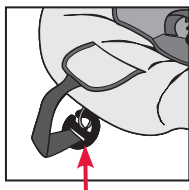

Hook Adjuster Strap on to the loop to prevent tripping over the strap.

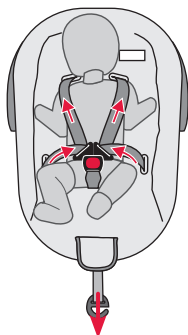

Pull Harness Adjustment Strap to remove slack.

WARNING: DO NOT LEAVE CHILDREN UNATTENDED IN THE CAR.

The end of the harness adjustment strap is connected to the cover to avoid tripping over the end when carrying the Capsule. Ensure the harness adjustment strap hook is attached when carrying the capsule.

CAUTION: A LOOSE HARNESS IS DANGEROUS

HOW TO USE

PLACING BABY & BABY CAPSULE IN BASE

- A. Position the Baby Capsule over the top of the base. Make sure the Harness Adjustment Strap is not caught between Baby Capsule and Base then lower the Baby Capsule into position.

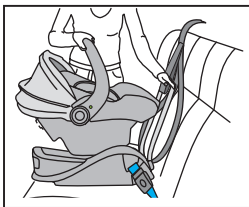

- B. Push down on the Baby Capsule until an audible click is heard. Pull on the Baby Capsule to ensure it is correctly locked into position.

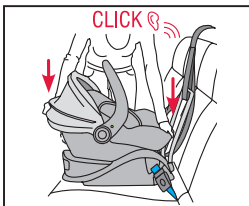

-  **IMPORTANT:**
Lift again to check engagement.

- C. The handle may be rotated and locked into other positions if needed.

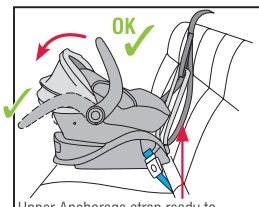

Upper Anchorage strap ready to be fitted to Capsule.

- D. Engage the top tether strap attachment clip to the car's anchor fitting, if not already connected.

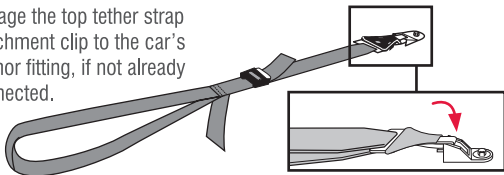

HOW TO USE

- E. Feed the top tether strap on the inside of the handle and through the locating slots in the front of the Baby Capsule.

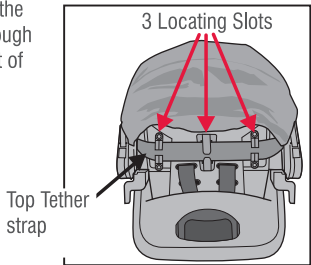

- F. Adjust the top tether strap by pulling as shown below to remove all slack in the straps. Do not tighten such that the base is lifted at the front.

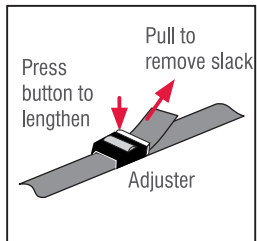

- G. Roll up excess strap and place into the storage pocket attached to the top tether.

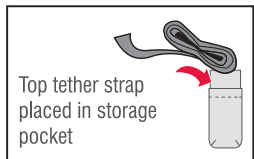

IMPORTANT:

The Top Tether strap must be fitted at all times when the baby is in the car.

HOW TO USE

If the car's child restraint anchor fitting is behind the vehicle seatback you may need to use an extension strap as part of the top tether installation.

IMPORTANT: If using an Extension Strap, positioning the attachment clip above the child may lead to injury in an accident therefore make sure that the attachment clip is not positioned in front of the vehicle seat. Use a shorter extension strap or no extension strap.

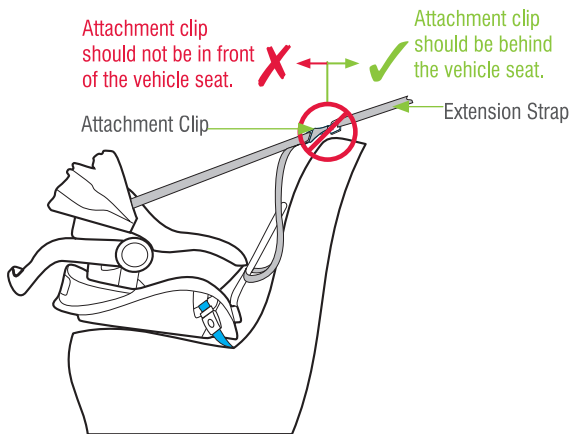

It is normal to have some sideways movement if the headrest end is pushed from the side. Ensure that the seatbelt is tight and the slack is removed from the tether strap. If the tether strap is over tightened, the angle of the child seat may be affected.



IMPORTANT :

The top tether strap must be fitted at all times when the restraint is used in the car when using either seatbelt installation.

Always secure the loose end of the top tether strap to prevent it hanging out of the car or being accessible by the child.

THIS RESTRAINT IS NOT SUITABLE FOR USE WHERE THE TOP TETHER STRAP MAY FALL INTO A SPLIT IN THE SEAT BACK OR OFF THE SIDE OF THE SEAT.

ALWAYS ATTACH TOP TETHER HOOK AND REMOVE SLACK IN THE TOP TETHER STRAP.

HOW TO USE

REMOVING BABY & BABY CAPSULE FROM BASE

- A. Loosen the upper anchorage strap by fully pressing the adjuster button while pulling the upper anchorage strap. Ensure that the adjuster does not fall on the baby.
- B. Remove the upper anchorage strap from the locating slots in the Baby Capsule. Store the upper anchorage strap behind the stabilising bar.
- C. Rotate the Carry Handle to the “carry” position and ensure it is locked correctly before lifting.
- D. Grasp the carry handle with one hand, then squeeze the base catch release button and pull out base release catch with the other hand. With the catch released, raise the Baby Capsule away from the base, you may need two hands to lift the capsule out of the car. Place feet apart and use bent legs to lift the capsule to avoid back injury.



Squeeze catch release button

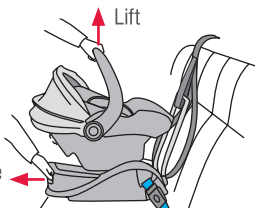

Then pull base release catch

- E. When the Baby Capsule is clear of the base, carefully remove it from the car.
- F. Always keep baby secure in the integral harness when carrying.

Ensure the adjustment strap hook is connected to the cover, see page 33.

CAUTION:

The end of the harness adjustment strap is connected to the cover to avoid tripping over the end when carrying the Capsule. Ensure the harness adjustment strap hook is attached when carrying the capsule.

REMOVAL OF BABY FROM BABY CAPSULE

- A. Rotate the carry handle to either the access or non-rocking position and ensure the Canopy is fully open.
- B. Press the Harness Adjuster while pulling shoulder straps to loosen the harness.
- C. Press the red button on Harness Buckle then both Harness Tongues will be released. Place Buckle Tongue Holders (if fitted) on each side of the cover.
- D. Feed the baby's arms through each side of the Harness and place the straps on each side of the capsule clear of the baby. Lift the baby out of the capsule.

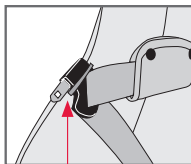

Buckle Tongue Holder
(if fitted)

NOTE: Once the baby gets heavier you may wish to leave the capsule in the car. In this case you will need to disconnect or loosen the top tether strap before removing the baby.

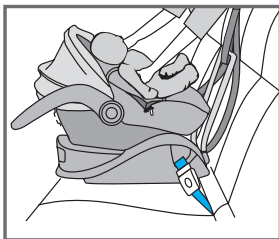
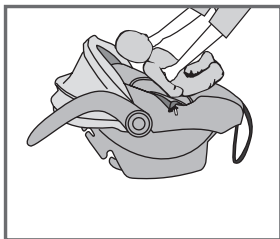

HOW TO INSTALL IN AN AIRCRAFT

HOW TO INSTALL USING AIRCRAFT LAP BELT

The Baby Capsule without base is suitable for use on aircraft in rear facing mode.

The Baby Capsule must be used in accordance with the aircraft operators procedures, and any directions from the aircraft operator, pilot or crew.

The Baby Capsule may not fit in smaller aircraft.

Inform the aircraft operator that a child restraint is intended to be used on the aircraft when booking the flight as the child restraint may not be suitable for use in that operator's specific aircraft.

Follow the instructions of the flight crew or pilot.

For use of the child restraint in cars in countries other than Australia and New Zealand, The user should consult the country's local authorities, car hire companies, car insurance companies, etc. for advice. The child restraint may not be acceptable for use in all cars.

FIT THE BABY CAPSULE TO THE AIRCRAFT SEAT

You do not need the base or top tether strap on an aircraft. We recommend that you check it in with your luggage.

- A. Position the Baby Capsule rearward facing, align it centrally within the allocated seating position. If possible, lift the armrests out of the way to improve access to installing the aircraft lap belt and to suit the width of the capsule.
- B. Place handle in "non-rocking" position, that is, fully backwards. Carefully remove cover on the side to reveal **AIRCRAFT REARWARD-FACING BELT PATH** label marked in green.

NOTE: Never use this path in a car. Always replace cover after use.

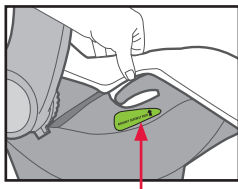

AIRCRAFT REARWARD-FACING BELT PATH
marked in green.

HOW TO INSTALL IN AN AIRCRAFT

- C. Fully lengthen lap belt. Thread the lap belt into **AIRCRAFT REARWARD-FACING BELT PATH** lap belt path (green marker) as shown, ensuring that lap part is below the hook as shown, on each side. Engage lap belt buckle and tongue.

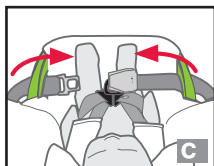

- D. Push down on the Baby Capsule and remove all slack from the lap belt. Pull belt strap to tighten, ensure a firm fit of the Baby Capsule to the seat.

Do not use this restraint with aircraft seatbelt that contain airbags unless they can be disabled.

Do not use with a seatbelt extender that causes the buckle to enter the hook area of the aircraft belt path.

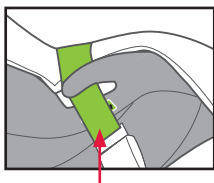

Ensure lap belt is under the hook on each side

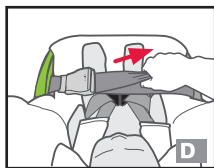

Remove slack

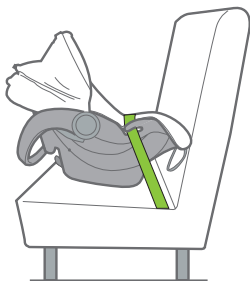

HOW TO INSTALL IN AN AIRCRAFT

The Baby Capsule base may be included with 'checked in' luggage (for use after flight). Aircraft label is located on the underneath of the Baby Capsule. It demonstrates suitability for use on aircraft.



This Child Restraint System meets the standards for use in aircraft as recommended by the Civil Aviation Safety Authority of Australia and the Civil Aviation Authority of New Zealand.

Only to be used on aircraft with the permission of the aircraft operator, pilot and crew.

SUITABLE FOR REAR FACING USE

The top tether strap is not required to be used onboard aircraft and should be stowed securely.

REPLACE COVER OVER AIRCRAFT BELT PATH

Refit cover and replace all clips.
Ensure belt path marker is covered after use.

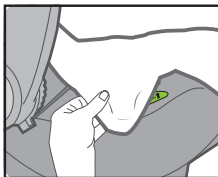

REGULAR CARE OF THIS RESTRAINT:

Please check the following items regularly to ensure the safety of your child:

- A. Check the webbing straps for fraying,
- B. Check there are no cracks in moulding,
- C. Check the harness adjuster is operating and is clamping the webbing,
- D. Ensure the buckle is free of fluff, liquid or other matter that may enter the buckle slots. Clean the buckle if it is sluggish to engage. See next page.
- E. If any part of the restraint is cracked, broken or not operating seek repair immediately - contact Britax Customer Service 1300 303 330

CLEANING CAR SEAT

HARDWARE: Use only mild soap to clean all metal and plastic parts of your child's restraint, using a damp sponge or cloth. Do not use chemicals or cleaning agents. Do not try and place any hardware into a washing machine.

STRAPS/HARNESS: We recommend spot cleaning straps and harness with a damp sponge or cloth using only cold or warm water. Never place any straps or harness into a washing machine or tumble dryer.

CARE AND MAINTENANCE

BUCKLE OPERATION

To ensure the buckle remains operational the inside of the buckle must be kept free of all foreign matter including: liquids, sand, dirt, fluff, food or similar substances. If the buckle is not operating or you do not hear a strong audible click when second tongue is inserted then the buckle needs to be washed or replaced. The buckle is fully engaged when both tongues are inserted. Contact Customer Service for assistance.

TO CLEAN HARNESS BUCKLE:

If sticky liquids such as baby formula, fruit juice, etc. get inside your harness buckle, it may become sluggish. An indication of a sluggish harness buckle is that you cannot hear a click when engaging the last harness tongue. To restore the harness buckle to good working order it needs to be cleaned as follows:

- A. Remove the harness buckle from the restraint: From the underside of the restraint pull each crotch strap 3-bar slide, turn the 3-bar slide on its side and push back through the slot.
- B. Place the harness buckle under warm (max. 40 degrees Celsius) running water as shown below. Let the water run through the mouth of the buckle for five minutes. Check the harness buckle is clean by engaging the harness tongues and buckle several times until you hear a click.
- C. If you still cannot hear a strong audible click then repeat the cleaning process several times.
- D. Refit the harness buckle to the restraint ensuring the red button faces outwards and the 3-bar slide is fed through the same slots.

If the Harness Buckle cannot be returned to its original working condition then contact BRITAX Customer Service for assistance.

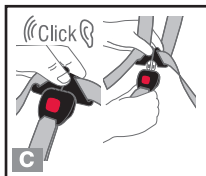
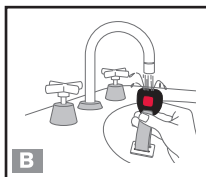
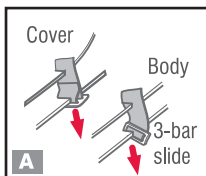

CARE AND MAINTENANCE

COVER (style may vary)

The restraint has a flame retardant cover which is removable for cleaning. Cleaning instructions are on the care label attached to the cover. If fluffy cover is fitted then washing the cover prior to use will remove excess fluff.

The cover has been designed to protect your child when seated in the restraint. Care should be taken if children either eat or drink while in the restraint as some food or drink products may cause damage or marking to the cover. Wash or clean immediately.

Do not pull sticky items from covers as the cover may be damaged - soak in water and gently remove.



IMPORTANT:

Do not pull sticky items from covers as the cover may be damaged - soak in water and gently remove.

The seat cover and accessories must not be replaced with any other than the one recommended by Steelcraft, because the cover is an integral part of the child Baby Capsule and how it performs. The child Baby Capsule must not be used without the cover and the padding provided.



VERY IMPORTANT:

Only replace the cover with Steelcraft supplied replacement cover with identical shoulder height markers or a replacement cover meeting AS/NZS 8005.

TO REMOVE THE COVER

- A. Remove the Canopy and Baby insert pad (if supplied) as described on page 20. Unclip the two Baby Capsule cover straps which are secured by plastic hooks under the handle attachment point.
- B. Disconnect the shoulder harness straps from the Metal Strap Connector and feed through shoulder slots in both Baby Capsule and cover. Refer to page 28.
- C. Feed the shoulder harness straps and tongues through lap strap slots in the Cover only. There is no need to remove the harness straps from the Baby Capsule.
- D. Lift the cover around the rim of the Baby Capsule at the harness adjuster end, feed the crotch buckle through the slot in cover and pull the harness adjuster strap out of the slots.
- E. Remove the cover for cleaning.

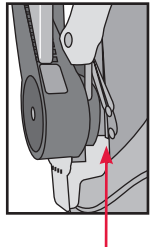

Unhook clips on either side of cover under the handle then remove cover

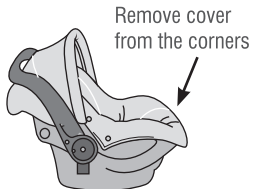

Remove cover from the corners

CARE AND MAINTENANCE

TO REPLACE THE COVER

- A. Place the cover over the Baby Capsule ensuring all slots in cover line up with slots in Baby Capsule.
- B. Ensure there are no twists in any straps underneath the Baby Capsule.
- C. Feed the shoulder harness straps through lap strap slots in cover.
- D. Feed the shoulder harness straps through the shoulder strap slots in cover and then in through the Baby Capsule (**ensure it is Over The Cross Bar**). Refer to page 29 for correct shoulder harness position for your baby. Attach the shoulder harness straps to the strap connector.
- E. Feed the crotch buckle and the harness adjuster strap through their respective slots in the cover.
- F. Refit all plastic attachment hooks and clips to the Baby Capsule.
- G. Engage shoulder harness tongues and crotch buckle. Pull to check harness is attached.

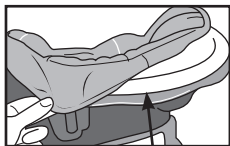

Fit elastic cover over Baby Capsule

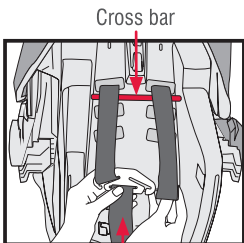

Strap Connector

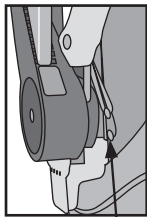

Plastic Hooks

- H. **Recheck to ensure the straps are not twisted.**

Use of aftermarket accessories, that is, accessories not provided with this child restraint can reduce the safety of the child restraint and may cause injury or death. Always follow the instructions covering the use of accessories in this section or the instructions provided with accessory. If an aftermarket accessory is used that is not recommended by Britax then ensure that the accessory is for this restraint compliant with AS/NZS 8005 and stated as suitable for use with this child restraint.

The following instructions apply to accessories that may be supplied with this restraint at point of purchase. If not, a variety of Safe-n-Sound accessories are available from various retailers of Safe-n-Sound products.

BOOT COVER (where fitted)

A Boot Cover (where fitted) provides shade from the sun and protection from wind whilst the Baby Capsule is installed on the Travel System Stroller.

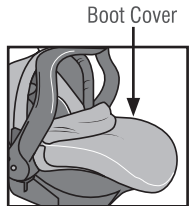

REMOVABLE BUCKLE PAD (where fitted)

- A. To fit the buckle pad, grasp the loop at the base of the buckle pad and pull over the harness buckle as shown right.
- B. To remove, simply slide the buckle pad off the harness buckle.

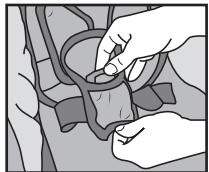

Some trim designs may incorporate a permanently attached buckle pad.

ACCESSORIES

SHOULDER PADS (where fitted)

The shoulder pads may require release by press studs. If fully fitted to the shoulder strap then you will need to disconnect the shoulder strap as described on page 28.

EXTRA BASE

There are Steelcraft Series 60/A/2013/1 Extra Bases available as a separate purchase for a second car. These bases allow the Capsule to be easily and quickly switched between cars. The Extra Base has the same installation requirements as the Base in these instructions.

OTHER ACCESSORIES

Only use accessories designed for this product and recommended by Britax Childcare Pty Ltd.

INSTALLATION OF CAR'S UPPER ANCHORAGE POINT

Consult the vehicle owner's handbook for location of anchorage fittings or anchorage points and the possible use of spacers. Some vehicles may have an anchor fitting installed by the vehicle manufacturer. If anchorage points cannot be found refer to car manufacturer or local child restraint fitting station or traffic authority for optimum position of upper anchorage point and the use of spacers.

TOP TETHER STRAP



IMPORTANT:

THE ATTACHMENT CLIP COVER MUST ALWAYS BE USED AS IT PREVENTS THE RISK OF INCORRECT FITMENT OF THE ATTACHMENT CLIP TO THE UPPER ANCHORAGE POINT. ALWAYS ENSURE THAT THE ATTACHMENT CLIP IS CORRECTLY ENGAGED TO THE UPPER ANCHORAGE POINT AND NOT HOOKED OR FITTED TO ANY OTHER OBJECT BEFORE EACH USE OF THE RESTRAINT. THIS IS ESPECIALLY IMPORTANT IN VEHICLES SUCH AS STATION WAGONS, VANS, HATCH BACKS OR VEHICLES WITHOUT A FIXED PARCEL SHELF, SINCE THE ANCHOR POINT IS USUALLY NOT VISIBLE.

IMPORTANT INSTALLATION NOTE:

In some vehicles the upper anchorage point in the rear vertical panel can only be installed in one way. Please refer to vehicle owner's handbook or a child restraint fitting station for correct method.

INSTALLATION OF CAR'S UPPER ANCHORAGE POINT

Extension Strap distance to be measured.

Length 300mm (Use Safe-n-Sound part 0035 or equivalent).

Length 600mm (Use Safe-n-Sound part 0036 or equivalent).

Available from all major child restraint retailers.

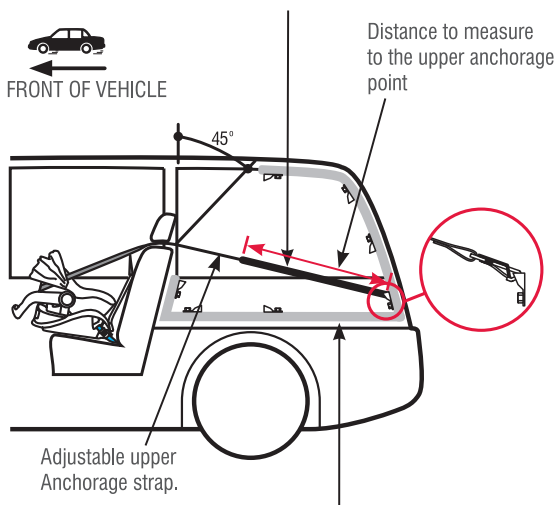

The shaded areas of this diagram illustrate the possible locations of the anchor fitting. Within each shaded area is an anchor fitting showing the correct way to install the fitting. Ensure the anchor fitting is aligned as illustrated unless stated otherwise in the vehicle owner's handbook.

INSTALLATION OF CAR'S UPPER ANCHORAGE POINT

IF THE CAR IS FITTED WITH CHILD RESTRAINT UPPER ANCHORAGE POINT

Locate the upper anchorage point behind the rear seating position. (Consult the car owners handbook for the location of the upper anchorage point). The upper anchorage point should be directly behind and central to the restraint. Remove thread plug from the parcel shelf/floor/roof, etc. and install attachment bolt and fitting as shown in Fig 1.

CAUTION: DO NOT OVERTIGHTEN ATTACHMENT BOLT. OVERTIGHTENING MAY FRACTURE OR BREAK BOLT. MAXIMUM TORQUE IS 20 Nm(14.75 ft.lb.)

Note: Minimum of five full turns of attachment bolt is required before tightening force is applied.

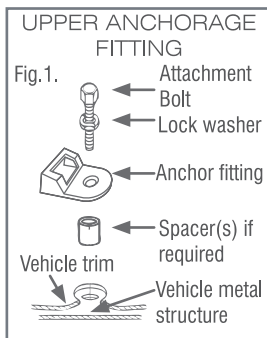

INSTALLATION OF CAR'S UPPER ANCHORAGE POINT

IF THE CAR IS NOT FITTED WITH CHILD RESTRAINT UPPER ANCHORAGE POINTS

For Sedans only - Drill 9mm diameter hole in the parcel shelf on the centre line of the seating position as shown in Fig 3. Before drilling the hole, check the underside for accessibility. Install the attachment bolt as shown in Fig 2. It is recommended that this installation be carried out by a child restraint fitting station or licenced motor mechanic.

For vehicles other than Sedans - In Australia, consult your nearest child restraint fitting station or traffic authority for vehicle inspection to find the best, correct position for the placement of the upper anchorage point, and for the correct attachment bolt length and use of spacers. In New Zealand, consult the agent for the vehicle. Note to Queensland purchasers: The installation of anchorage points must be approved by authorised officers appointed by Queensland Transport. Authorised officers can be sourced from all Queensland Transport Customer Service and Queensland Ambulance Service Centres.

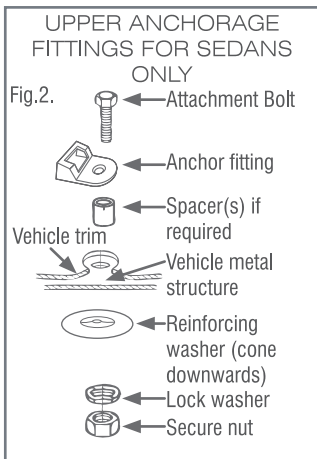

INSTALLATION OF CAR'S UPPER ANCHORAGE POINT

ONLY USE A 5/16 UNC GRADE 5 BOLT. IF THE BOLT IS NOT THE CORRECT LENGTH THE CAR MANUFACTURER'S HAND BOOK CAN PROVIDE ADVICE ON THE CORRECT LENGTH BOLT.

NOTE:

Marking on the top of a Grade 5 Bolt. Do not use any bolt without these marks.



WARNING

CHILD RESTRAINTS MUST NOT BE ATTACHED TO UNSOUND METAL OR TO WOOD, OR SYNTHETIC STRUCTURES. WHEN DRILLING 9 MM HOLE DO NOT DRILL THROUGH FUEL LINES, FUEL TANKS, ELECTRICAL WIRING, OR RADIO SPEAKERS.

WEBBING STRAPS MUST BE PROTECTED FROM SHARP CORNERS AND EDGES. THE ANCHOR FITTING MUST BE USED ONLY AS DESCRIBED ABOVE. IT MUST NOT BE HOOKED ONTO ANY OTHER OBJECT.

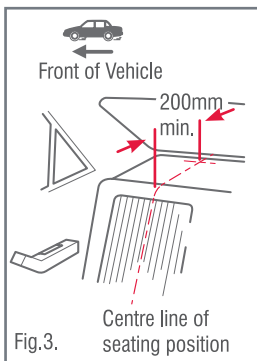

CAR INSTALLATION ACCESSORIES

(From retailers of Safe-n-Sound products)

EXTRA ANCHOR KITS: Available for using the restraint in additional cars. Re-order no: 0038

EXTENSION STRAPS: May be required for cars without a fixed parcel shelf. Re-order no: 0035 (length 300mm) or 0036 (length 600mm)

GATED 3-BAR SLIDE (Locking clip): For converting lap-sash seat belt to lap belt, and to obtain a better fit to the car where the fitted lock-off may not be suitable. Most cars will not need this. Re-order no: 0215.

ALTERNATIVE INSTALLATION IF SEATBELT LOOSENS

LAP-SASH SEAT BELT

If a seat belt will not stay tight, a Gated 3-Bar Slide may be used to prevent loosening.

Before installing the restraint, join the lap-sash seat belt by using the Gated 3-Bar Slide stored under the capsule.

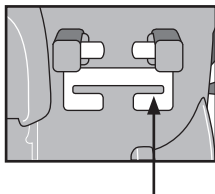

Gated 3-Bar Slide
under the capsule

- A. Hold the lap and sash straps together and fold as shown. Slide the inner strap into the Gated 3-Bar Slide followed by the outer strap.

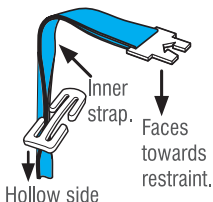

- B. The two straps should slide freely in the Gated 3-Bar Slide slot.

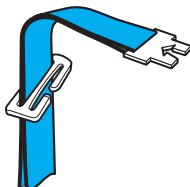

ALTERNATIVE INSTALLATION IF SEATBELT LOOSENS

C. Repeat previous step A for the other slot in the Gated 3-Bar Slide.

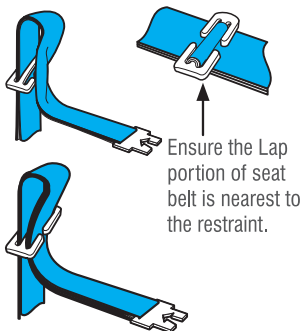

D. Feed the straps through the Gated 3-Bar Slide to remove any slack.

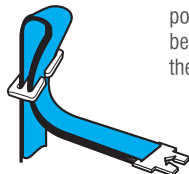

Use this seat belt configuration to install the child restraint according to the instructions on pages 23 to 24 using a converted lap belt. Locate the 3 bar slide low on the vehicle lap belt.

After engaging the tongue and buckle, remove all slack by tensioning the upper lap belt and feeding all slack through the gated 3 bar slide.

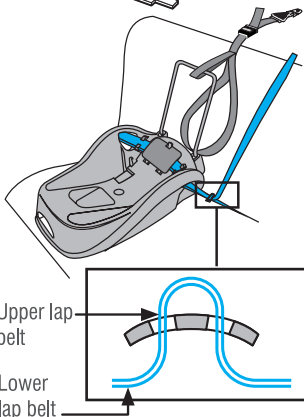

IMPORTANT:

Remove the gated 3 bar slide from the seat belt as soon as the child restraint is removed so that an adult can use the seat belt as a lap-sash seatbelt.

Do not allow slack seatbelt to remain on the converted lap belt.

TRAVEL SYSTEM-USE WITH STROLLER

This Baby Capsule is designed to be connected to compatible Steelcraft strollers. The following pages provide general instructions about using the Baby Capsule with a stroller. This which may differ slightly for some strollers. Preferably use the attachment instructions provided with your stroller. Use the stroller in accordance with the instructions supplied with the stroller.



WARNINGS

DO NOT LEAVE THE CHILD IN THE BABY CAPSULE FOR EXTENDED PERIODS.

THE BABY CAPSULE IS DESIGNED TO PROVIDE MOBILITY OUTSIDE OF THE CAR BUT IT SHOULD NOT BE USED IN PLACE OF AN APPROPRIATE COT.

THE BABY CAPSULE MUST ONLY BE USED WITH A STEELCRAFT STROLLER WITH COMPATIBLE ATTACHMENTS. DO NOT USE WITH ANY OTHER STROLLER.

IF IN DOUBT ABOUT THE METHOD OF INSTALLATION OR SUITABLE COMPATIBLE STROLLERS, CONTACT BRITAX CHILDCARE CUSTOMER SERVICE ON 1300 303 330.

Always ensure the baby is secured in the Capsule with the harness at all times.

TRAVEL SYSTEM-USE WITH STROLLER

TO INSTALL BABY CAPSULE ONTO STROLLER



IMPORTANT:

Only use Baby Capsule with compatible Steelcraft Stroller.

- A. Where applicable, remove the stroller seat or bassinet from the stroller frame (refer to stroller instructions). With the Baby Capsule handle in the carry position, engage the Baby Capsule tongue mouldings on each side directly over the stroller frame mouldings.

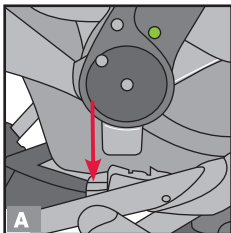

- B. Push down on the Baby Capsule and make sure it is located into the stroller frame mouldings. The Capsule is not yet fixed to the stroller.

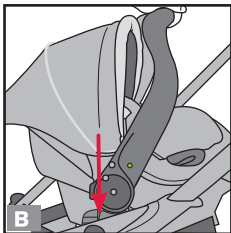

TRAVEL SYSTEM-USE WITH STROLLER

C. By pushing in and holding the release buttons on either side of the handle, rotate the handle backwards to the install position. The GREEN indicator will now turn RED.

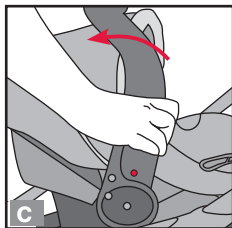

D. Release the handle latches. Then with one hand holding the front of the Baby Capsule, push the Baby Capsule handle all the way down until you hear it lock into the frame.

E. The handle indicator will now be GREEN and the Baby Capsule should be locked into the frame.

IMPORTANT:

F. Pull up on both sides of the Baby Capsule to confirm it is locked into the frame. If not locked in on both sides, repeat steps A to E.

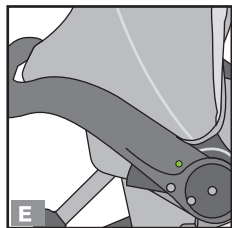

G. If the baby is not already in the Baby Capsule then secure your baby into the Baby Capsule by the harness (see page 26).

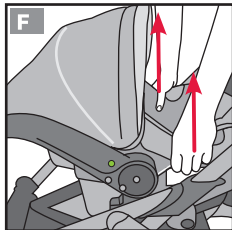

VERY IMPORTANT:

Always lock the Baby Capsule to the stroller frame by rotating the handle.

TRAVEL SYSTEM-USE WITH STROLLER

TO RELEASE BABY CAPSULE FROM STROLLER

- A. Squeeze both handle latches in to release the locks.

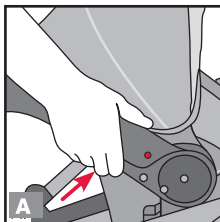

- B. Rotate the handle forward, towards the carry position.
The indicator will now be RED.

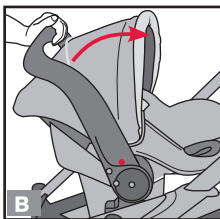

- C. Once in the carry position the indicator will be GREEN. Lift and remove the Baby Capsule away from the stroller frame.

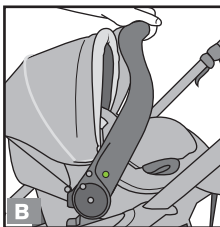

WARNING

Use the harness at all times.

TRAVELLING TIPS

SAFETY

Never hold a baby in arms when riding in a motor vehicle. In this position the baby could be thrown against the dashboard, windscreen or other occupant and suffer serious injury or death.

When riding in a motor vehicle never nurse a baby and use the same seat belt for both of you. In this position the baby or child could be crushed.

Never breast feed a baby while car is in motion.

Children must be secured in appropriate restraints at all times when the car is in motion. Children travelling unrestrained or standing up in the car are in danger of serious injury or death. Traffic regulations in all states require children to be secured in child restraints or adult seat belts where available.

Plan your trip with frequent comfort stops to reduce stress on babies, young children and driver. Keep the car well ventilated to reduce heat stress. Car windows should be kept open to maintain a good flow of fresh air.

Never leave babies or toddlers in a stationary car because of the risk of heat exhaustion.

Ensure babies and toddlers are adequately shaded from direct sunlight through side or rear windows.

Check the car is ventilated by opening windows or using the car's ventilation system taking in external air. Recirculation setting is not suitable for providing ventilation.

Be on guard against carbon monoxide poisoning which can occur through only a slight leak in the exhaust system while travelling in a closed car.

Securely stow all heavy objects, feeding bottles, etc. that could become missiles during an accident and cause injury to any occupant.

CLOTHING/BATHING

Since it is often warmer in the car, dress the baby in light clothing.

Do not harness an infant wrapped in a blanket or swaddled. Any blanket or wrap must only be placed over the harness and infant.

IN CASE OF ACCIDENT

If your restraint has been involved in a severe crash, you should destroy the restraint even if no damage is obvious. Some insurance companies offer car insurance which covers or partially covers the replacement of your child restraint. Contact your insurance company for further details. Your insurance company may require you to keep the child restraint for assessment, **but do not use the child restraint after a severe crash**. To assist you in making an accident insurance claim, cut out the following statement and include it with your claim.

NOTICE TO INSURANCE COMPANY CHILD RESTRAINT INVOLVED IN AN ACCIDENT

All Steelcraft child restraints are manufactured to Australian/New Zealand Standard AS/NZS1754-2013 which requires us to advise users of child restraints to "Destroy the entire restraint if it has been in use in a severe crash, even if no damage is obvious".

The joint Australian/New Zealand Standards committee CS/85, advise that this statement applies whether a child was in the child restraint or not. A severe crash, we consider as being one where the main body structure of the car is distorted.

There is no method of determining if the restraint has been damaged and we concur with the Australian/New Zealand Standard in recommending destruction of the child restraint. This notice is to advise you of the requirements of the Australian/New Zealand Standard and our obligation in complying with the standards.

Please assist the owner of this restraint in their claim.

Britax Childcare Pty. Ltd.

(Incorporated in Victoria)

A.B.N 55 006 773 600 Head office and registered address:

Level 4, 650 Lorimer Street, Port Melbourne, VIC 3207

P.O. Box 5119 Garden City VIC 3207

Telephone: 1300 303 330



WARRANTY

Our goods come with guarantees that cannot be excluded under the Australian Consumer Law. You are entitled to a replacement or refund for a major failure and compensation for any other reasonable foreseeable loss or damage. You are also entitled to have the goods repaired or replaced if the goods fail to be acceptable quality and the failure does not amount to a major failure.

For the full terms of the Warranty refer to the Britax website www.britax.com.au/service-support/warranty

Distributed by:



AUSTRALIA
BRITAX CHILDCARE PTY. LTD.
A Britax International company.
(Incorporated in Victoria) A.B.N.
55 006 773 600
Level 4, 650 Lorimer Street,
Port Melbourne, VIC 3207
Phone: 1300 303 330

NEW ZEALAND
BRITAX CHILDCARE NZ. Limited.
A Britax International company.
Phone: 0508 688 822

Due to our continuing program of development, Britax reserves the right to alter the specifications, color or design without any further notice.

The Steelcraft, Safe-n-Sound, Strider and Strider PLUS trademarks are the property of Britax Childcare Pty. Ltd Australia.

The Britax trademark are the property of Britax Childcare Holdings Ltd, UK.

Visit the Britax website at: www.britax.com.au or email us at au-custserv@britax.com

©2011-2018 Copyright Britax Childcare Pty Ltd. Australia. Patents Apply.

P/No. 2202631/E