

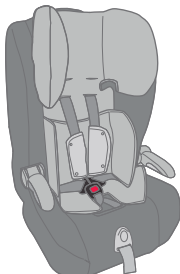

## Maxi Rider AHR with adjustable headrest

SERIES NO. 8000/B/2010



### Toddler Use

For children approximately 6 months to approximately 4 years of age, using the inbuilt harness.

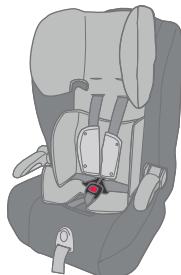

### Child Use

For children approximately 4 years of age to approximately 6 to 8 years of age when used as a booster seat with lap-sash seat belt or child harness and seat belt. (A child harness must be used in a position with a lap only seat belt).

Suitable for use only with the Safe-n-Sound™ Protecta PLUS™ Harness Series 220/2010 or Babylove EzyGo Harness™ Series BL220/2010 Child Harnesses.

# Instructions for Installation & Use



**IMPORTANT: KEEP THIS BOOKLET IN THE PLACE PROVIDED ON THE CHILD RESTRAINT**

# INDEX

## Page

- 3 INTRODUCTION
- 4 WARNINGS
- 6 SHOULDER MARKERS & A GROWING CHILD
- 8 SHOULDER HEIGHT LABELS & THE NEXT SEAT
- 10 SPECIAL FEATURES - TODDLER RESTRAINT
- 12 SUITABLE FOR USE
- 13 HOW TO SETUP
- 20 HOW TO INSTALL
- 24 HOW TO USE (WITH IN-BUILT HARNESS)
- 26 SPECIAL FEATURES - CHILD BOOSTER
- 28 HOW TO SETUP - BOOSTER SEAT
- 32 HOW TO USE - BOOSTER SEAT
- 39 HOW TO INSTALL WITH A CHILD HARNESS
- 53 RESTORING THE RESTRAINT
- 54 CARE AND MAINTENANCE
- 55 HOW TO CLEAN
- 58 ACCESSORIES & FEATURES
- 61 PRE-INSTALLATION ANCHOR FITTING
- 65 IN CASE OF ACCIDENT
- 67 FEATURES

Always store the instruction book in the pocket provided on the side or the back of the cover.

# INTRODUCTION

The Maxi Rider AHR is suitable for toddlers and older children as a convertible booster seat. This child restraint is fitted with our exclusive **VERSATETHER™** Catch that allows it to use the Safe-n-Sound™ Protecta PLUS™ child harness in booster seat mode for older children.

To be used in forward-facing position with built-in harness by children whose shoulders are above the lower shoulder height marker (approximately 6 months of age) until their shoulders reach the middle shoulder height marker (approximately 4 years of age). Then to be used with either a lap-sash seatbelt or an add-on accessory child harness until their shoulders reach the upper shoulder height marker (approximately 6 to 8 years of age).

Continue to use this child restraint until the child reaches this limit. Children are safest in a booster seat until their shoulders reach the upper shoulder height marker of the booster seat.

Do not use this restraint until child's shoulders are above the lower shoulder height marker.

Just using a seatbelt is not recommended for children that have outgrown this seat. Use a larger booster.

**WHEN USED WITH IN-BUILT HARNESS - TO BE USED WITH A LAP-SASH OR LAP ONLY SEAT BELT IN THE BACK OF MOST CARS WITH FORWARD FACING SEATS.**

**WHEN USED AS A BOOSTER SEAT - THIS RESTRAINT MUST BE USED IN CARS WITH FORWARD FACING SEATS WITH A LAP-SASH SEAT BELT OR WITH A SEAT BELT AND CHILD HARNESS.** When using a child harness with the seat it may be used in seating positions with either a lap or lap-sash seat belt.

Only the Safe-n-Sound™ Protecta PLUS™ Harness Series 220/2010 or Babylove EzyGo Harness™ Series BL220/2010 Child Harnesses are suitable for use with this product.

No child restraint can guarantee absolute protection from injury in every crash. However, to ensure that your child gets all the protection designed into the restraint **PLEASE READ AND FOLLOW THESE INSTRUCTIONS EXACTLY** and use only Safe-n-Sound recommended parts and accessories.

Carefully read all the instructions for installation in this book. If in doubt about the method of installation, consult Britax childcare or agent or a child restraint fitting station authorized by a relevant transport authority or, in New Zealand, the agent for the vehicle or authorized child restraint fitter.

**THIS RESTRAINT MUST BE ATTACHED TO A CHILD RESTRAINT ANCHORAGE POINT IN THE CAR. REFER TO CAR OWNER'S HANDBOOK FOR LOCATION OF ANCHORAGE POINTS. REFER TO A CHILD RESTRAINT FITTING STATION IF NO ANCHORAGE POINTS ARE IN THE MOTOR CAR.** Refer to pages 61 to 63.

## WARNINGS

### WHEN USED WITH THE 'BUILT-IN' HARNESS

- Fit the restraint firmly to the car seat.
- Fit the harness firmly to the child.
- A loose restraint or harness is dangerous.
- When used in this mode the restraint must be used in conjunction with a lap or lap-sash seat belt.

### WHEN USED AS A BOOSTER SEAT (with or without a separately supplied Child Harness)

- **DO NOT USE WITH JUST A LAP BELT.** You must use with a lap-sash belt or with a seat belt and child harness.
- The lap part of the seat belt must be firmly across the thighs and the sash straps fitted diagonally across the chest and on the shoulder.
- If used with a child harness, the lap strap of the seat belt must be adjusted firmly first and then the harness, so that the lap strap is not lifted off the child's lap when the harness is adjusted.
- Do not use with the integral harness when in booster mode. This built in harness must be stored.
- Use only with a lap-sash seat belt or with an add-on accessory child harness and either a lap or lap-sash seat belt.

### GENERAL WARNINGS - also see warnings on pages 12 and 28.

- Supervision of children is needed because they may be able to undo buckles and adjusters.
- Use the restraint exactly as shown in the instructions.
- **DO NOT LEAVE CHILDREN UNATTENDED IN THE CAR.**
- Do not alter or modify this restraint.
- Repairs must only be done by the manufacturer or agent. Use only recommended parts and accessories.
- Do not allow the restraint to come into contact with polishes, oils, bleach and other chemicals.
- Destroy the restraint if it has been in a severe crash, even if no damage is visible. See page 65.

## WARNINGS

- **DO NOT USE THIS RESTRAINT WITHOUT THE COVER.**
- Regularly check the restraint components, straps and other fitments for correct function and condition. Seek prompt repair.
- **IF AN AIRBAG IS FITTED IN THE SEATING POSITION WHERE THE CHILD RESTRAINT IS TO BE FITTED, FOLLOW THE VEHICLE MANUFACTURERS WARNINGS AND INSTRUCTIONS.**
- Straps may be damaged by unsecured cargo in a collision. Secure or remove hazardous cargo before using this restraint. Hatch-back or Wagon: Do not use the child restraint where this strap may fall into a split in the seat back. Always attach hook and remove slack.
- Protect all webbing from abrasion and cutting by sharp corners and edges.
- The restraint should not be purchased or sold as a second hand item. It is recommended not to use child restraints older than 10 years as the protection in an accident may be reduced.
- This restraint must be used in conjunction with a lap or lap-sash seat belt.
- **THIS RESTRAINT IS NOT SUITABLE FOR USE WHERE THE ANCHORAGE STRAP MAY FALL INTO A SPLIT IN THE SEAT BACK (E.G. HATCHBACK OR WAGON).**
- Seat belt extenders should not be used if the seat belt is not long enough to fit around the child. If a seat belt extender is used then the seat belt buckle must not be in contact with the child.

## WARNING:

**DO NOT LEAVE CHILDREN UNATTENDED IN THE CAR.**

## SHOULDER MARKERS & A GROWING CHILD

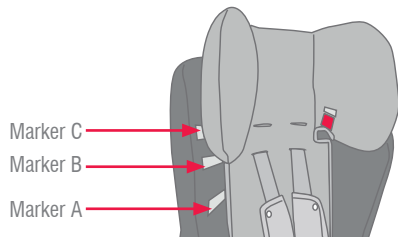

Shoulder height markers B and C are visible with the headrest in the upper positions.

### Young Toddler

Shoulders must not be below the lowest marker. Use the inbuilt harness.

From approximately 6 months of age.



### Older Toddler

When shoulders are in-line with middle marker, change to Booster Seat mode.

To approximately 4 years of age.

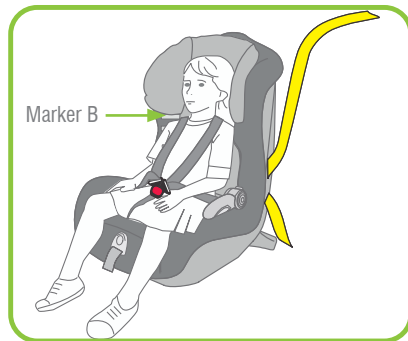

## SHOULDER MARKERS & A GROWING CHILD

### Older Child

**AS A BOOSTER SEAT with Lap sash seat belt**

To approximately 6 - 8 years of age.

Shoulders above middle marker but below upper shoulder height marker.

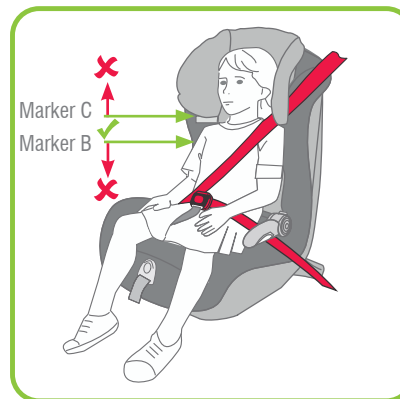

**AS A BOOSTER SEAT with Child Harness and Seat belt**

To approximately 6 - 8 years of age.

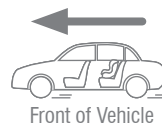
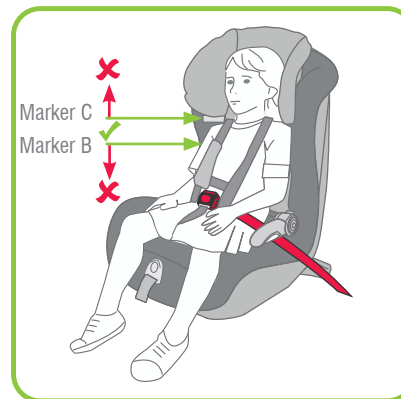

Change to the next type of booster seat or child restraint when shoulders reach the upper shoulder height marker when the headrest is in the highest position.

A child harness must be used if the car's seating position is fitted with a lap only seat belt. If a child no longer physically fits in the seat then move to the next form of child restraint.

## SHOULDER HEIGHT LABELS & THE NEXT SEAT

**⚠ IMPORTANT: Follow this advice.**

### Marker A Smaller Toddler - LOWER SHOULDER HEIGHT MARKER

Using the in-built harness, the child's shoulders must be in-line with this marker or above this marker. If the child's shoulders are below then the child should remain in their previous child restraint. Approximately 6 months.

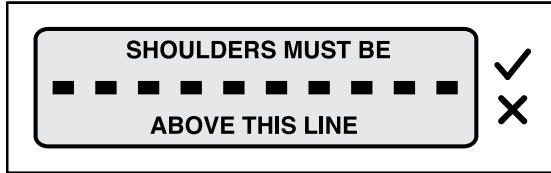

### Marker B Larger Toddler - MIDDLE SHOULDER HEIGHT MARKER

When the child's shoulders reach this marker, convert the child restraint to booster seat mode and use either a lap-sash seat belt or a child harness and lap-sash seat belt or lap only seat belt. Approximately 4 years.

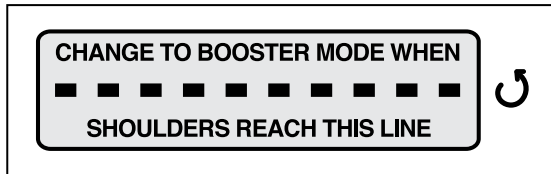

### Marker C Larger Child - UPPER SHOULDER HEIGHT MARKER

When the child's shoulders reach this upper marker, or the child no longer fits in the child restraint, approximately 6 to 8 years of age, then the child must be moved to the next form of child restraint, see next page.

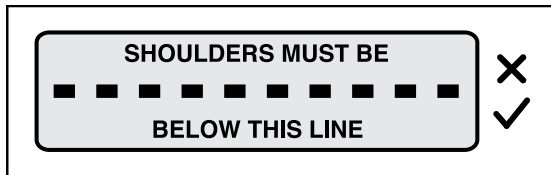

## SHOULDER HEIGHT LABELS & THE NEXT SEAT

**Next type of restraint that can be used in the car for your child.**

When your child has outgrown the seat, you can then either use:

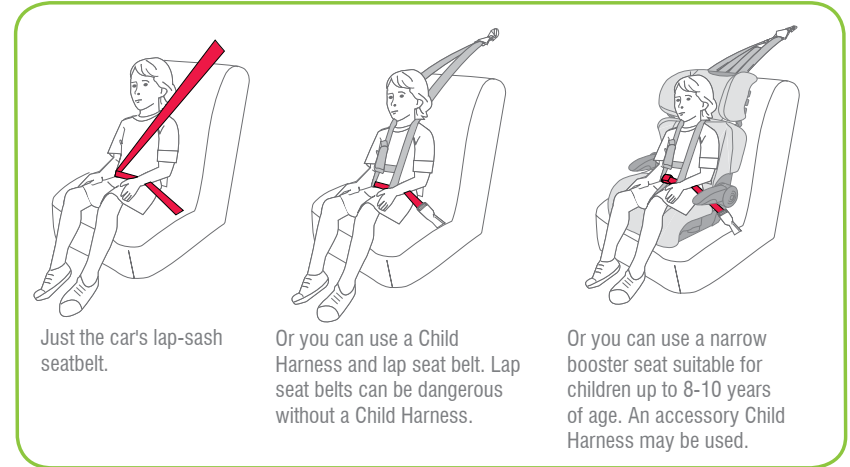

## SPECIAL FEATURES - TODDLER RESTRAINT

To be used only in a forward-facing position for a child approximately 6 months of age up to approximately 4 years of age using the in-built harness.

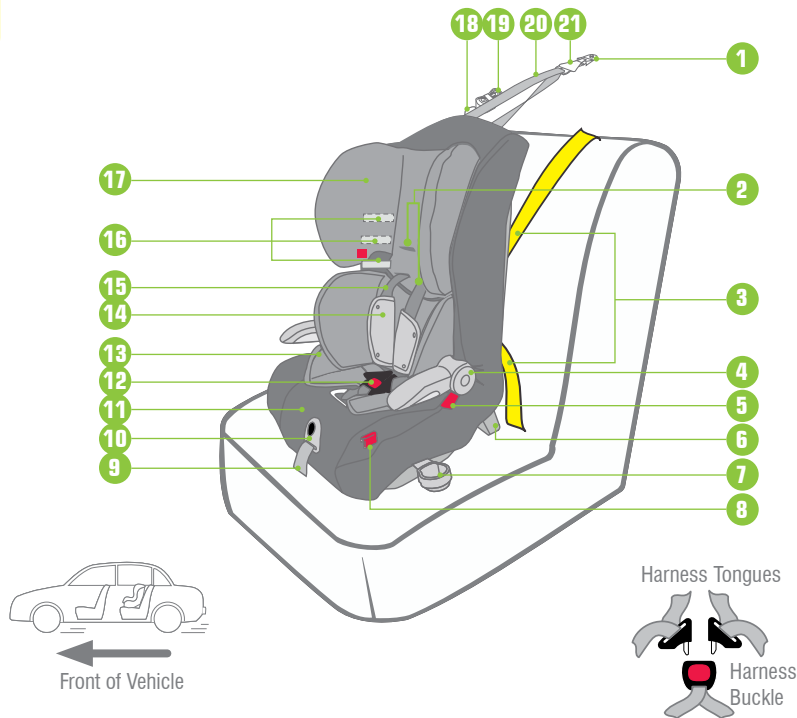

## SPECIAL FEATURES - TODDLER RESTRAINT

1. Car's Anchor Fitting
2. Top headrest slots (for Child Harness only) and Lower headrest slots (for Integral Harness and Child Harness)
3. Car's lap-sash seat belt or lap belt.
4. Armrests.
5. Red seatbelt path labels (Booster Seat) (1 each side)
6. Recline Foot in upright position.
7. Cup Holder 1 each side.
8. SLIDEGUARD™ converter for Booster mode. Shown in storage recess undercover. (See warning Page 31)
9. Harness Adjustment Strap
10. Harness Adjustment Button.
11. Padded cover for comfort
12. Quick release harness Buckle (Red button).
13. Padded insert (if fitted)
14. Shoulder Pads
15. Fully adjustable 6 point harness.
16. Shoulder Height Markers
17. Adjustable Headrest
18. Upper Anchorage Strap Adjuster
19. Upper Anchorage Storage Strap
20. Adjustable Upper Anchorage Strap
21. Attachment Clip

**NOTE:** Not all features are supplied on some models. "if fitted" is used to indicate some of the features that may not be on the seat supplied.

## SUITABLE FOR USE

TO BE USED WITH A LAP SASH OR LAP ONLY SEAT BELT IN THE BACK OF MOST CARS WITH FORWARD-FACING SEATS.

To be used in forward-facing position by children whose shoulders are above the lower shoulder height marker (approximately 6 months of age) until their shoulders reach the upper shoulder height marker (approximately 4 years of age).

Continue to use this infant restraint until the child reaches this limit.

Do not use this restraint until the child's shoulders are above the lower shoulder height marker.

Infants are at risk of serious injury if they face forward too early.

Children are at risk of serious injury if they move to booster seats too early.

The child should not sit in this forward facing child restraint until their neck muscles are able to support their head. Stay in a rear facing child restraint.

Regional Road Rules may prohibit the use of this restraint in the front seat until the child is 4 years of age. Check your Regional Rules for exemptions.

### WARNING

- Fit the restraint firmly to the car seat and then fit the harness firmly to the child.
- A loose restraint or harness is dangerous.
- Do not use in a front seat, unless it has a child restraint anchorage point i.e.: utilities.
- Do not use the restraint without the Upper Anchorage Strap correctly attached.
- Do not use on any vehicle seat which faces sideways or rearwards.
- WHERE AN AIRBAG IS FITTED IN THE SEATING POSITION WHERE THE CHILD RESTRAINT IS TO BE FITTED, FOLLOW THE VEHICLE MANUFACTURERS WARNINGS AND INSTRUCTIONS.
- Always use lap or lap-sash seat belt and upper anchorage strap to attach the child restraint to the vehicle seat.
- Ensure that the SLIDEGUARD™ clip is stored in the recess under the cover when the seat is used in Toddler mode, to avoid injury or discomfort.

## HOW TO SETUP

### INSTALLATION AND USE OF RESTRAINT

For Toddlers who have reached the shoulder height limit on their infant restraint refer to pages 10-25.

For Children who have reached the shoulder height marker and need to use a booster seat refer to Pages 26-52.

### HOW TO USE THE HEADREST

First remove both harness straps (Refer to page 17). Then rotate lever down to loosen headrest clamp (A). Slide the headrest up or down to suit the height of your child, (refer to pages 17-18 for toddler use or page 32 for child use). In toddler mode, move the headrest so that the bottom slots in the headrest line up with the top of the child's shoulders. Then move the headrest so that the slots line up with the nearest slots in the shell. Ensure that the shoulder slots are correctly aligned with the shoulders otherwise, move up to the next set of slots in the shell. Rotate the lever upward to tighten the headrest clamp (B). Then refit both harness straps, ensuring that there are no twists and that each strap is in the correct and matching slots in both the seat shell and headrest (Refer to page 14).

### UPPER ANCHORAGE

Refer to your vehicle owner's manual for the location of the anchor fitting in the car. If the vehicle is not fitted with a child restraint anchor fitting then refer to page 61 for the installation of the anchor fitting provided with this child restraint.

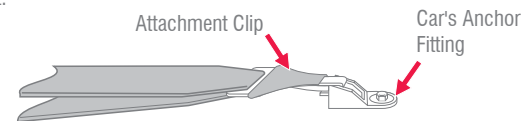
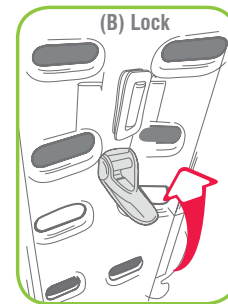
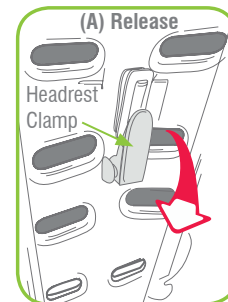

## HOW TO SETUP

### ADJUSTING SHOULDER HARNESS STRAPS HEIGHT

Correct fitment of the harness is very important as it restrains the child in the restraint. The harness must fit firmly around the upper torso of the child and be positioned so as to leave the child's arms and legs free.

1. Lower shoulder strap slots.
2. Mid shoulder strap slots.
3. Upper shoulder strap slots.
4. Top slots in seat back
5. Harness slots in headrest.
6. Top slots in headrest
7. Headrest clamp.
8. Shoulder harness straps.
9. Harness tongues & buckle.
10. Lap strap slots.
11. Crotch strap slots.
12. Harness adjustment strap.
13. Shoulder Height Markers.

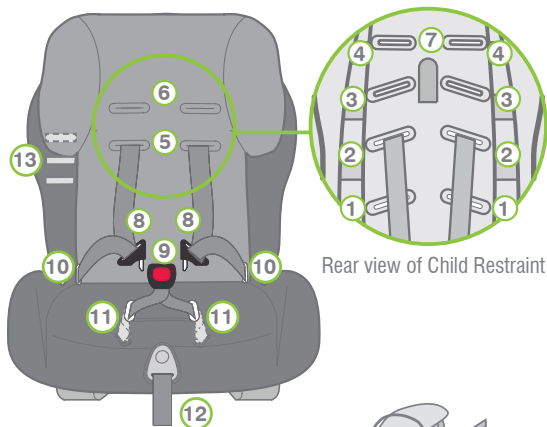

The shoulder straps must be in the slots which are nearest to the child's shoulders, but not more than 25mm below the child's shoulders. If shoulders are above the middle shoulder height marker then the child is too large for toddler use with the in-built harness and the restraint must then be converted for child use as a booster seat. (Booster Seat Mode - see pages 26 onwards).

Note: If child's shoulders touch the headrest side wings, raise the headrest to the next shoulder strap slot position.

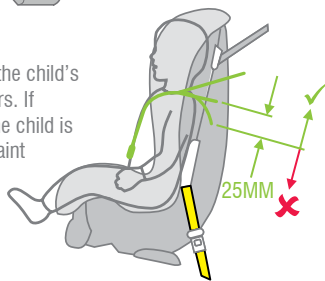

## HOW TO SETUP

### SETTING UP THE HARNESS

- A. Sit the restraint on a flat ground and supported from behind so that it will not tip over.
- B. Get the child to sit comfortably in position.
- C. Determine the desired shoulder strap position.
- D. Remove the child and adjust the shoulder straps using the following methods.
- E. Repeat steps A-C to confirm the correct set-up of the built-in harness.

### ADJUSTING THE BUCKLE POSITION

The buckle needs to be positioned as shown. If the buckle is too low it will be uncomfortable and needs to be lengthened. See next page for adjusting to a better position.



Buckle Position  
OK

Centre of button on buckle,  
level with top of child's  
thighs or just above (with  
all slack removed from  
crotch strap.)



### IMPORTANT :

You must adjust the crotch strap to the correct length for your child before installing the restraint as it cannot be adjusted in the car. The crotch strap should only be extended if the harness tongues are located low against your child's legs, thus creating discomfort.

Always return the crotch strap to its shorter length when using the seat with a smaller child.

The buckle should always be positioned low down on your child's abdomen.

DO NOT attempt to remove the crotch strap from the adjuster. Adjustment is made by feeding the crotch strap through the adjuster as shown on the next page and does not need to be removed from the seat.

## HOW TO SETUP

### ADJUSTING THE CROTCH BUCKLE HEIGHT

The crotch buckle height is adjusted by threading the 3 bar anchor plates into extra slots to shorten the buckle height. The seat has the crotch straps fitted in position when supplied. Position 1 is generally used with the inbuilt harness or toddler mode.

- Remove the seat from car.
- Lift trim cover to reveal crotch strap slot.
- Turn the crotch 3-bar slide and push through each slot as shown right until the Crotch strap assembly is free from the seat.
- Insert Crotch strap through restraint slot which will position Crotch strap level with the child's crotch and feed back through other slot as shown right.

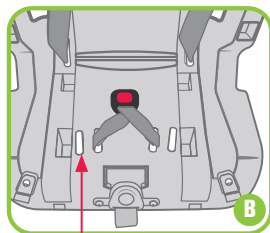

4 Slots

#### 1. Longest Length for Toddler mode and largest child in Booster

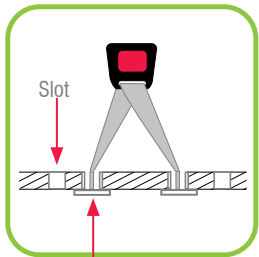

3 Bar Anchor

#### 2. Shortest Length for Booster Mode- Smallest Child

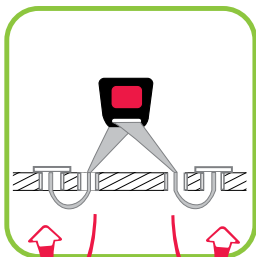

#### 3. Mid Length for Booster Mode- Mid size Child

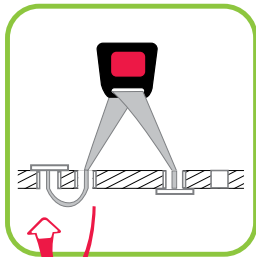

### IMPORTANT :

When replacing cover, ensure none of the harness straps are twisted and that all straps are secure by pulling each harness strap.

## HOW TO SETUP

### ADJUSTING HARNESS STRAP HEIGHT & HEADREST: - STEPS IN CHANGING SHOULDER STRAP SLOTS

- If installed in the vehicle, remove the restraint from vehicle as instructed on page 23.
- At the rear of the restraint, remove both harness shoulder straps from metal Strap Connector by slipping strap through open slot.
- Pull the shoulder straps through slots at the front of the restraint.
- To release the headrest, go to the back of the restraint and rotate lever down to loosen headrest clamp (1). Slide the headrest up or down to suit the height of your child. Ensure that the headrest slots align with the corresponding slots of the restraint body. Insert a finger to check alignment. (See illustration on page 18). Then, rotate the clamp upward to lock the headrest clamp (2). DO NOT lock the headrest in any other positions, otherwise the slots will not align correctly.

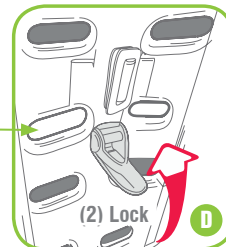
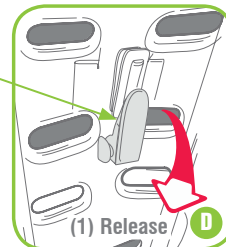
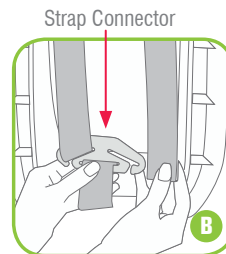

Headrest clamp

Align Slots

## HOW TO SETUP

- E. Insert shoulder straps through the desired headrest slots which will position shoulder strap level with or above the child's shoulder, see below. Ensure that the shoulder strap passes through matching slots in the restraint.
- F. Ensure there are no full twists in the harness strap and the buckle tongues face the correct way.
- G. Connect shoulder straps to metal strap connector at rear of restraint, as shown in (B) on page 17.



### IMPORTANT :

Do not use the restraint with harness shoulder straps set at different heights or fed through mismatching slots. Ensure harness straps are not twisted and that all straps are secure by pulling each harness strap.

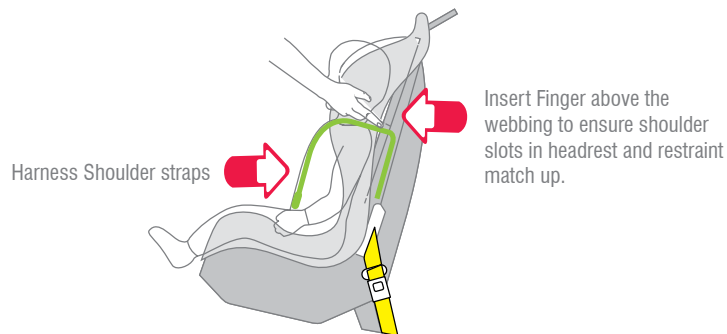

## HOW TO SETUP

### INSTALLING INTO VEHICLE (FORWARD FACING) (UPRIGHT OR RECLINED)

- A. Determine whether an upright or reclined installation is preferred as shown right.
- B. To move the Recline Foot from upright to reclined mode or vice versa. Pull the Foot outwards to unlock it, then rotate the foot. Push to lock in place. See diagrams below.

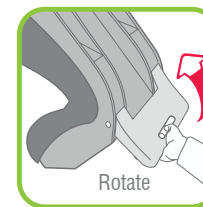
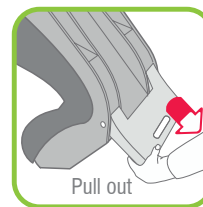
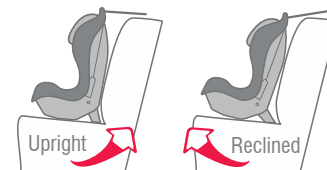

## HOW TO INSTALL

- C. Position restraint centrally to the chosen position in forward facing mode and align restraint centrally to the chosen seating position. Some vehicle seat fabrics (particularly velours) may be damaged by a child restraint used continuously. We recommend the use of the Safe-n-Sound™ Messy Mat or other protection to keep the vehicle seat in good condition.

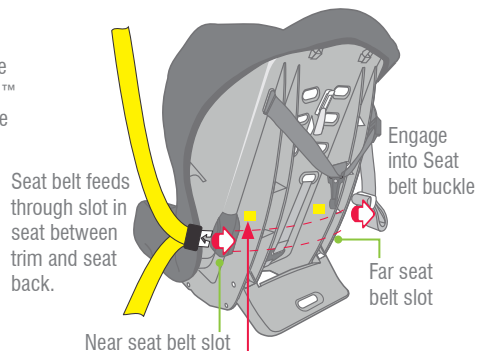

Yellow Belt Path label  
**FORWARD-FACING BELT PATH**

- D. Fully lengthen lap or lap sash seat belt and insert through near seatbelt slot. Ensure the seatbelt is between the trim and seat back as you push the seatbelt out through the far seatbelt slot.

- E. Engage car seat belt buckle and tongue. Push down on the restraint while pulling on the lap portion to remove all slack from the belt. Then, pull the remaining slack in the sash belt and allow excess belt to feed back into the retractor.

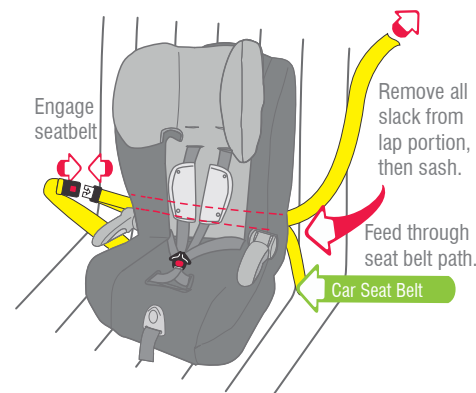

NOTE: Some car seats have more rearward slope than others. Use a rolled up towel or padding under the seat for contoured vehicle seats to prevent excessive recline.

If the car seat belt does not remain tight, then contact your local fitting station, or Safe-n-Sound customer service for a gated 3-bar slide (order No. 0215).

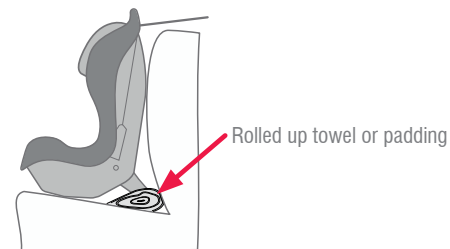

## HOW TO INSTALL

## HOW TO INSTALL

- F. To lengthen the Upper Anchorage Strap, fully press Adjuster Button (A) while pulling Upper Anchorage Strap (B) to slacken as shown right.

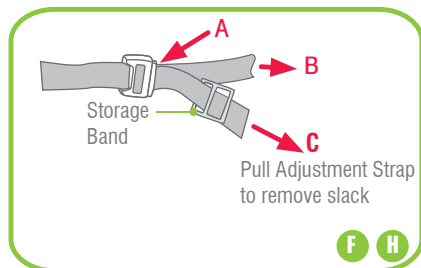

- G. Connect the Attachment Clip to the Anchor Fitting in the car making sure to remove as many twists as possible.

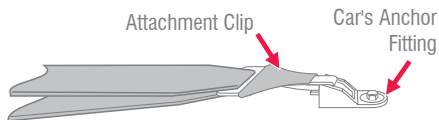

- H. Pull Upper Anchorage Adjustment Strap (c) to remove any slack but do not tighten so much that the restraint lifts off the car seat. Fold up excess strap and use storage strap to neatly store excess strap behind seat.

**WARNING**

Always attach hook and remove slack.

**IMPORTANT :**

Always ensure that the car seat belt and upper anchorage strap are firmly restraining the restraint on the vehicle seat.

Make sure Cup Holders (if fitted) do not interfere with closure of the car door.

## HOW TO INSTALL

## TO REMOVE TODDLER FROM RESTRAINT

- A. Press red button on Harness Buckle then both Harness Tongues will be released. Move each shoulder strap to the toddler's side, then remove the toddler.

## TO REMOVE RESTRAINT FROM VEHICLE

- A. Disengage seat belt tongue from buckle and remove from restraint.
- B. Fully press Upper Anchorage Strap Adjuster Button (A) while pulling Upper Anchorage Strap (B) to slacken as shown right. In some vehicles loosening of the Upper Anchorage Strap may be difficult. If so, try pushing the restraint against the vehicle seat back or slightly lifting the restraint to release the tension.
- C. Disengage Attachment Clip from the Car's Anchor Fitting. The child restraint is now disconnected.

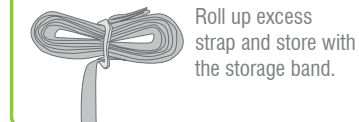
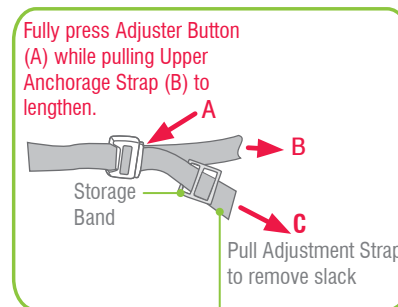

Roll up excess strap and store with the storage band.

## HOW TO USE

### PLACING TODDLER IN THE RESTRAINT

- A.** Lengthen harness by pressing Harness Adjustment button while pulling on either shoulder strap until the harness will accommodate the child.
- B.** Place child in the restraint and feed each arm through shoulder straps. Pull harness buckle up between child's legs.

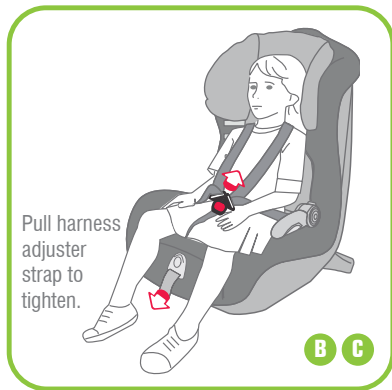
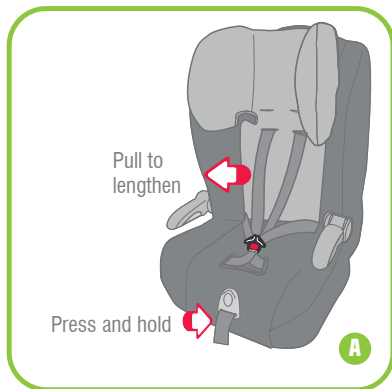

## HOW TO USE

- C.** Fit either harness buckle tongues into the harness buckle followed by the other tongue. A click is heard when the last tongue is fully engaged. Should the second tongue not insert - press the red button and reinsert the tongues. Ensure secure engagement by pulling harness straps. If the harness buckle does not engage correctly then it may require cleaning - refer to page 55.
- D.** Ensure slack is removed from harness lap strap by pulling shoulder straps then pull harness adjustment strap to adjust harness to a comfortable but firm fit. Ensure that any slack in harness straps is removed. Shoulder Harness Straps must fit firmly to the child. A loose harness could result in serious injury in an accident.
- E.** Pull the harness adjustment strap to remove slack so the harness fits the child with minimal slack. Do not over tighten.

**Do not use restraint if straps do not tighten and contact your local authorised service agent for repair.**

### TO REMOVE TODDLER

Press red button on harness buckle then both harness tongues will be released. Lift the shoulder straps from the child's shoulders and remove the child.

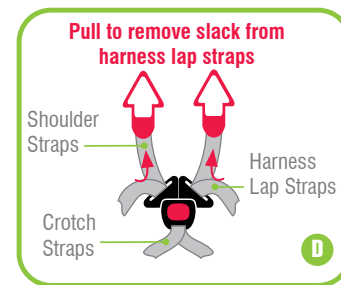
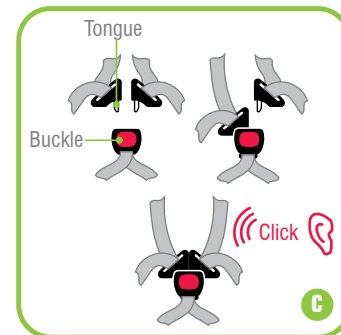

## SPECIAL FEATURES - CHILD BOOSTER

To be used with either a lap-sash seatbelt or an add-on accessory child harness by children whose shoulders are in-line with or above the middle shoulder height marker (approximately 4 years of age). This mode can be used until the child's shoulders reach the upper shoulder height marker (approximately 6 to 8 years of age).

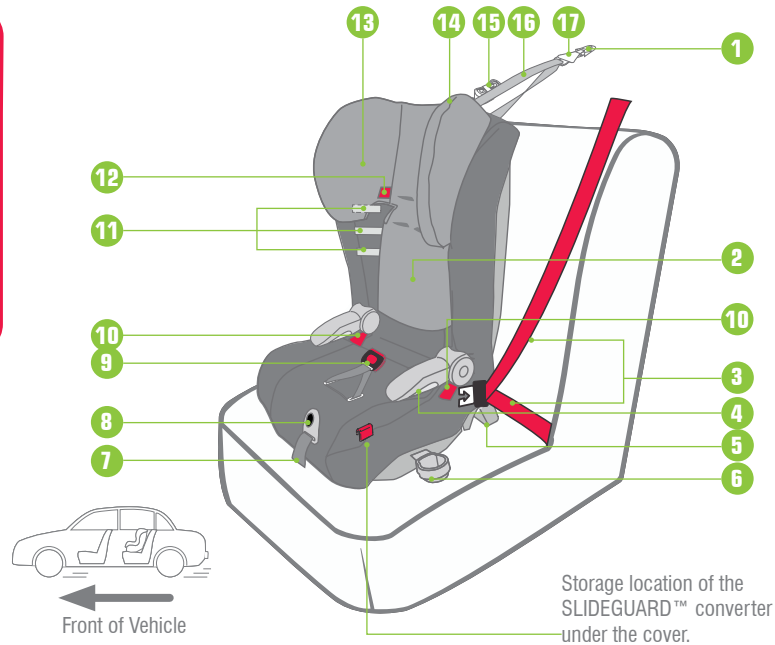

## SPECIAL FEATURES - CHILD BOOSTER

1. Car's Anchor Fitting
2. Harness stored under cover
3. Car's lap-sash seat belt or lap belt
4. Armrests
5. Recline Foot in upright position
6. Cup Holder 1 each side
7. Harness Adjustment strap
8. Harness Adjustment button
9. Lap belt SLIDEGUARD™ clip (with the harness buckle)
10. Red Booster Seat belt path labels. (one on each side)
11. Shoulder Height Markers
12. Sash guide in headrest (Red seat belt path Label)
13. Adjustable Headrest (with speakers if fitted)
14. Upper Anchorage Strap Adjuster
15. Upper Anchorage Storage Strap
16. Adjustable Upper Anchorage Strap
17. Attachment Clip & Cover

**NOTE:** Not all features are supplied on some models. "if fitted" is used to indicate some of the features that may not be on the seat supplied.

CHILD USE  
(BOOSTER SEAT MODE)

## HOW TO SETUP

To be used with either a lap-sash seatbelt or an add-on accessory child harness by children whose shoulders are above the lower shoulder height marker with the head restraint in the lowest position (approximately 4 years of age) until their shoulders reach the upper shoulder height marker with the head restraint in the highest position (approximately 6 to 8 years of age).

Continue to use this child restraint until child reaches the limit. Children are safest in a booster seat until their shoulders reach the upper shoulder height marker of the booster seat.

Do not use in this mode until the shoulders reach the middle shoulder height marker.

THIS RESTRAINT MUST BE USED IN CARS WITH FORWARD-FACING SEATS WITH A LAP-SASH SEAT BELT OR WITH A SEAT BELT AND CHILD HARNESS.

THIS BOOSTER SEAT MAY ONLY BE SUITABLE FOR USE WITH A CHILD HARNESS IN THE UPRIGHT POSITION. IN THE RECLINE POSITION, THE CAR'S SEATBELT MAY NOT BE LONG ENOUGH.

### WARNING

Suitable only for use with Safe-n-Sound™ Protecta PLUS™ harness series 220/2010 or Babylove Ezygo Harness™ series BL220/2010 child harnesses.

DO NOT USE WITH JUST A LAP BELT. You must use with a lap-sash belt or with a seat belt and child harness. If used with a child harness, the lap strap of the seat belt must be adjusted firmly first and then the harness, so that the lap strap is not lifted off the child's lap when the harness is adjusted.

ALWAYS USE THE SLIDEGUARD™ CLIP IN BOOSTER SEAT MODE.

Do not use the restraint without the Upper Anchorage Strap correctly attached.

Do not use with the integral harness when in booster mode.

This integral harness must be stored (see page 30-31).

Do not use in a front seat, unless it has a child restraint anchorage point.

Do not use on any vehicle seat which faces sideways or rearwards.

WHERE AN AIRBAG IS FITTED IN THE SEATING POSITION WHERE THE CHILD RESTRAINT IS TO BE FITTED, FOLLOW THE VEHICLE MANUFACTURERS WARNINGS AND INSTRUCTIONS.

Do not use with just a lap seat belt (unless using a Child Harness - refer to page 39-52).

## HOW TO SETUP

### CONVERTING THE TODDLER RESTRAINT INTO BOOSTER SEAT

To use this child restraint as a booster seat the harness needs to be stored under the cover. Disengage and remove the seat belt from the restraint.

You will need to remove the upper anchorage strap from the anchor fitting when converting to a booster seat.

Upper anchorage strap must always be used in this booster position when re installed.

If fitted, remove all comfort accessories from the restraint.

### STORING ACCESSORIES IN SEAT RECESS

When used as a Booster seat, the SLIDEGUARD™ converter is found in storage recesses under the cover, as shown below and is connected to the buckle to form the SLIDEGUARD™ Clip.

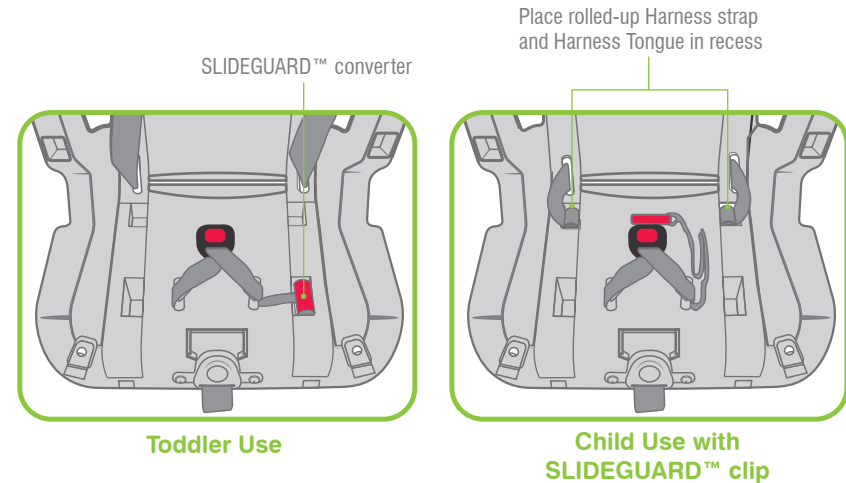

## HOW TO SETUP

### STORING THE HARNESS

- A. Disengage harness buckle. Fully lengthen the harness by pressing the Harness Adjustment lever and pulling the harness shoulder straps.
- B. At the rear of the restraint, remove both of the harness shoulder straps from metal Strap Connector by slipping strap through open slot. The metal Strap Connector is shown in diagram right.
- C. Pull the shoulder straps through slots in the seat back.
- D. Remove the Elastic loops holding the cover in place at the lower front of the seat. Lift the cover to expose the storage inserts in the seat base.
- E. Feed the straps with harness buckle tongues through the bottom rear of the seat cover. Roll up the harness straps with harness buckle tongue and place them into the left and right rear recess in the seat base (underneath the cover).



Strap Connector

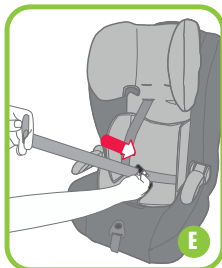
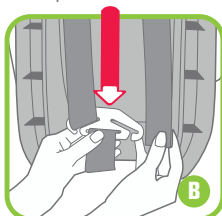

## HOW TO SETUP

- F. Remove SLIDEGUARD™ converter from storage recess and engage into harness buckle to create the SLIDEGUARD™ clip.
- G. Adjust the crotch strap length if necessary. See page 34.
- H. Align cover and re-engage elastic loops at the front of the cover.
- I. Extend and roll up the harness adjustment strap and metal strap connector, then store inside the recline foot.
- J. Store shoulder pads and Padded Insert (if fitted) in a safe place, for future use.

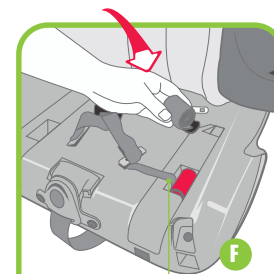
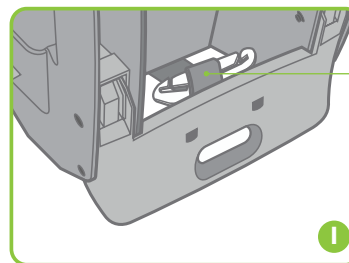

Remove SLIDEGUARD™ converter and engage in harness buckle.



Store metal connector in recline foot

## HOW TO USE

### ADJUSTING THE SLIDEGUARD™ CLIP POSITION AND HEADREST

Adjust headrest so that the integral Sash Guide is level with or just above the child's shoulder. Unlock the headrest by rotating the lever at the back of the restraint using the method explained on page 17. If using with a Protecta PLUS™ Child Harness, then the headrest must be in the top position, (see page 39).

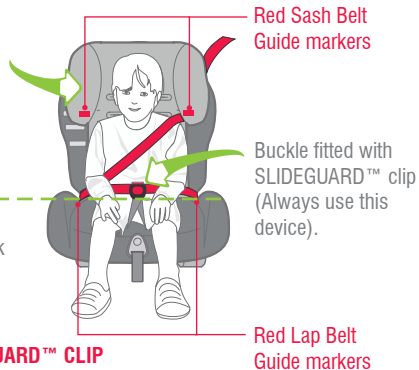

Bottom edge of buckle, level with top of thighs. To adjust buckle height, see page 34. Note: All slack removed from crotch strap when buckle is in the correct position.

**IMPORTANT: ALWAYS USE THE SLIDEGUARD™ CLIP**

**IMPORTANT:**

You must adjust the crotch strap to the correct length for your child before installing the restraint as it cannot be adjusted in the car.

The crotch strap should only be extended if the buckle and SLIDEGUARD™ clip are located too low against your child's legs, causing discomfort.

Always return the crotch strap to its original shorter length when using the seat with a smaller child. The buckle SLIDEGUARD™ clip should always be positioned low down on your child's body. DO NOT attempt to remove the crotch strap from the adjuster.

**WARNING :**

**A sash belt under the arm or behind the back is dangerous.**

## HOW TO USE

### SETTING UP THE SLIDEGUARD™ CLIP POSITION

**NOTE:** The SLIDEGUARD™ clip ensures that the child does not slump and ensures the lap belt is always positioned on the child's hips and thighs. If the seat belt rides up on to the stomach then a child can be seriously injured in a crash.

- Sit the restraint against a wall for stability and get the child to sit comfortably in position.
- Determine the correct buckle position. The bottom edge of the buckle needs to be level with the top of the legs.



- Remove the child and adjust the buckle strap length as on page 34.

## HOW TO USE

### ADJUSTING THE CROTCH BUCKLE HEIGHT

The crotch buckle SLIDE GUARD™ clip height adjustment is by threading the 3 bar anchor plates into extra slots to shorten the buckle height. The seat has the crotch straps fitted in position when supplied.

- A. Lift trim cover to reveal crotch strap slot.
- C. Turn the crotch 3-bar slide and push through each slot as shown right until the Crotch strap assembly is free from the seat.
- D. Insert Crotch strap through restraint slot which will position Crotch strap level with the child's crotch and feed back through other slot as shown right.

Use Position 2 for smaller children and Position 1 and 3 for larger children.

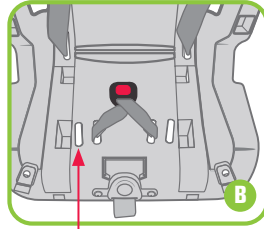

4 Slots

**1. Longest Length  
for Toddler mode and  
largest child in Booster**

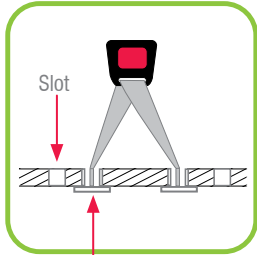

3 Bar Anchor

**2. Shortest Length  
for Booster Mode-  
Smallest Child**

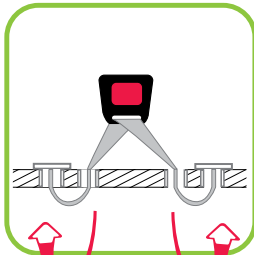

**3. Mid Length  
for Booster Mode-  
Mid size Child**

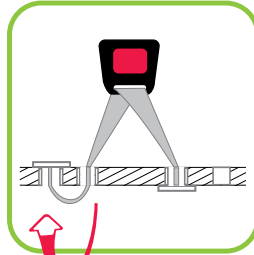

#### IMPORTANT :

When replacing cover, ensure none of the harness straps are twisted and that all straps are secure by pulling each harness strap.

## HOW TO USE

### PLACING CHILD IN THE RESTRAINT USING LAP SASH SEAT BELT & UPPER ANCHORAGE STRAP

- A. Determine whether an upright or reclined installation is preferred as shown right.
- B. To move the Recline Foot from reclined to upright mode or vice versa pull the Foot outwards to unlock it, then rotate the foot. Push to lock in place. Swing the seat back until it sits firmly on the vehicle seat.

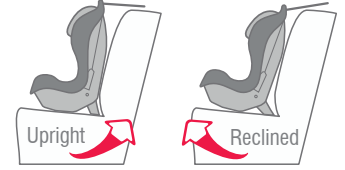

CHILD USE  
(BOOSTER SEAT MODE WITH SEAT BELT)

## HOW TO USE

- C. The restraint is now ready for use as a child booster, ensure the upper anchorage strap is still engaged into the anchor fitting (as shown right) and tighten if necessary. Do not overtighten causing the seat to lift.

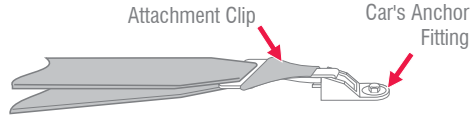

### **WARNING**

Always attach hook and remove slack.

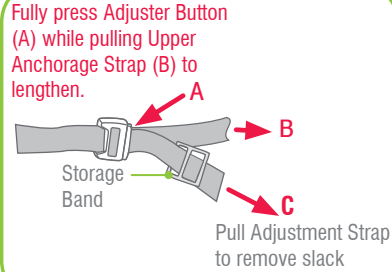

- D. Sit the child on the seat.

Red seat belt path labels  
**BOOSTER SEATBELT PATH**

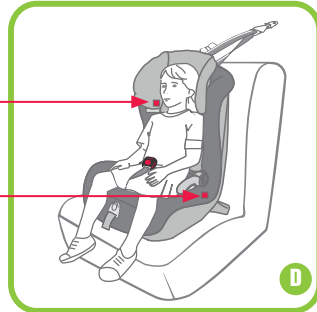

## HOW TO USE

- E. Position the lap-sash belt over the child ensuring the lap portion is positioned into the lap recess area under the armrest and on the child's thighs. The seat belt should follow the red Seat Belt path labels marked -BOOSTER SEATBELT PATH

Fit the SLIDEGUARD™ clip to the lap belt as shown below. The SLIDEGUARD™ clip must be used at all times in Booster mode, to position the lap belt on the child's thighs and prevent your child from submarining in the event of an impact. If the lap belt is not on the child's thighs then shorten the length of the crotch strap, see page 34.

- F. Engage seat belt buckle and tongue ensuring there are no twists in the belt. If the seat belt buckle is adjustable, adjust the buckle as low as possible away from the child.

**IMPORTANT:**  
A SASH BELT UNDER THE ARM OR BEHIND THE BACK IS DANGEROUS.

**NOTE:** Some vehicle seats have more rearward slope than others. Use a rolled up towel or padding under the seat for contoured vehicle seats to prevent excessive recline.

Remove SLIDEGUARD™ converter from recess area and engage into harness buckle.



Hook the Lap Belt SLIDEGUARD™ clip over the lap belt with the Red button (of the buckle) facing forward.

Lap part of seat belt in recess area (under armrests).

E

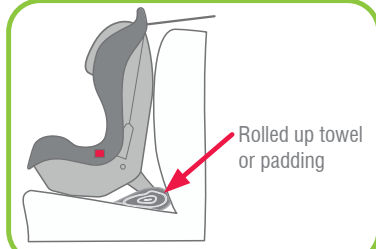

CHILD USE  
(BOOSTER SEAT MODE WITH SEAT BELT)

## HOW TO USE

- G. Place the sash belt across the child's chest and through the sash guide in the headrest.

The Sash Guide built in to the headrest is used to position the sash portion of the lap-sash seat belt across the child's shoulders and chest.

### Always use this sash guide.

- H. Adjust lap and sash portion of seat belt firmly but comfortably across the child's lap and chest.
- I. If using the Inertia Reel Retractor seat belt, adjust the lap portion of the seat belt firmly around the child and restraint, then let the slack sash portion retract up into the sash retractor.

### IMPORTANT:

The SLIDEGUARD™ clip must be used when the child is using the Booster Seat. Always ensure the seat belt is across the child's thighs and across the chest.

### TO REMOVE CHILD

Disengage seat belt tongue and buckle, remove the lap portion of seat belt from the SLIDEGUARD™ clip and remove belt from child.

When Booster is not being used, secure in position, by engaging seat belt over the booster seat.

**NOTE:** Stop using this Booster Seat if the child's shoulders are above the Upper Shoulder Height Marker.

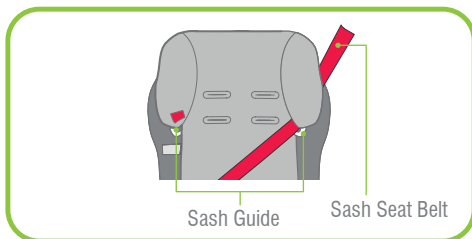
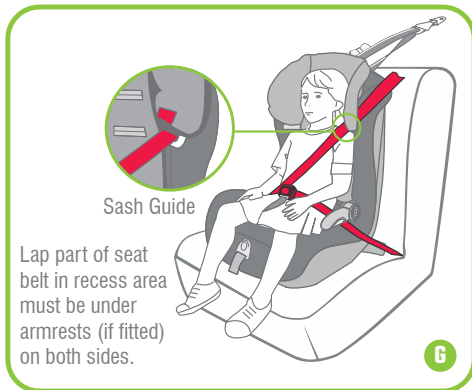

## HOW TO INSTALL WITH A CHILD HARNESS

### Using with Safe-n-Sound™ Protecta PLUS™ Harness Series 220/2010

VERSATETHER™ compatible child harnesses are suitable with this child restraint and are sold separately. Refer to the Harness instructions for full details of using and installing the Child Harness. When installing the harness, connect its attachment clip to the VERSATETHER™ Catch on the Booster Seat's upper tether strap (as shown in pages 41 and 42).

Use the extension strap (supplied with the Protecta Plus™) for all other instances to attach the harness to anchor points in the luggage area such as the vehicle floor or ceiling.

This Booster Seat is not suitable for child harnesses that are not VERSATETHER™ compatible.

### HEADREST POSITION:

Before installation ensure that the headrest is set to the correct height for your child (refer to page 8). Headrest should be just above the child's shoulders.

The Child Harness shoulder straps must be in the slots which are nearest to the child's shoulders, but not lower than the child's shoulders.

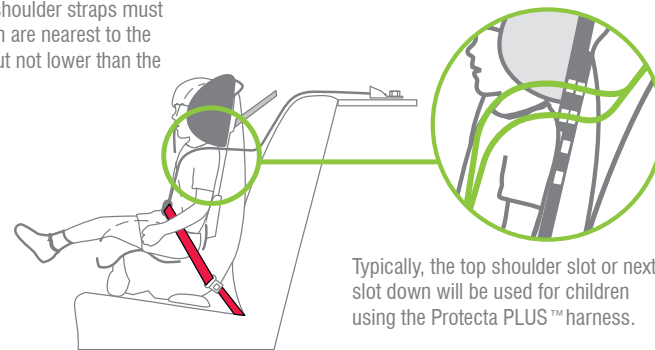

## HOW TO INSTALL WITH A CHILD HARNESS

### INSTALLING CHILD HARNESS INTO SEAT

A. If the seat is fitted to the car, remove it as it will be easier to fit the child's harness.

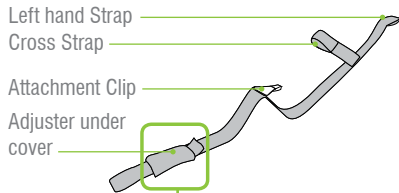

B. Prepare the child harness by lengthening the child harness by pressing the adjuster button (1) and pulling the shoulder strap (2).

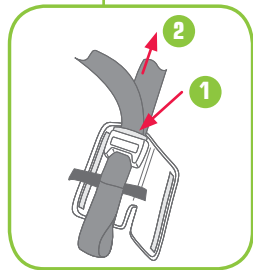

## HOW TO INSTALL WITH A CHILD HARNESS

C. Adjust headrest to the appropriate height. Ensure that the headrest slots align with the shoulder slots in the restraint (refer to page 14) and lock in position. Feed the left hand Harness Strap & Cross Strap through the appropriate shoulder slot.

Feed left hand Harness Strap & Cross Strap through right hand slot.

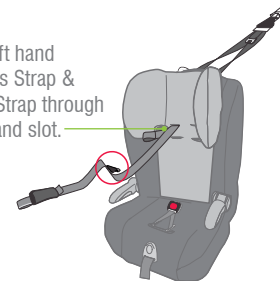

D. Pull the left hand Harness Strap & Cross Strap through the opposite shoulder slot. Make sure that the Anchor Clip also feeds through to the back of the restraint. Hook the Attachment Clip onto the Harness **VERSATETHER™** Catch and ensure that the straps line up to an equal length. See next page.

Hook the Attachment Clip onto **VERSATETHER™** Catch.

Pull left hand harness strap through the opposite slot until the straps are of equal length.

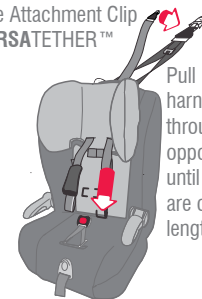

## HOW TO INSTALL WITH A CHILD HARNESS

### Installing into vehicle without extension strap

Hook the Child Harness attachment clip (1) onto **VERSATETHER™** Catch (2). Then hook attachment clip (3) onto anchor fitting. Ensure that none of the straps are twisted and not passing over any sharp edges.

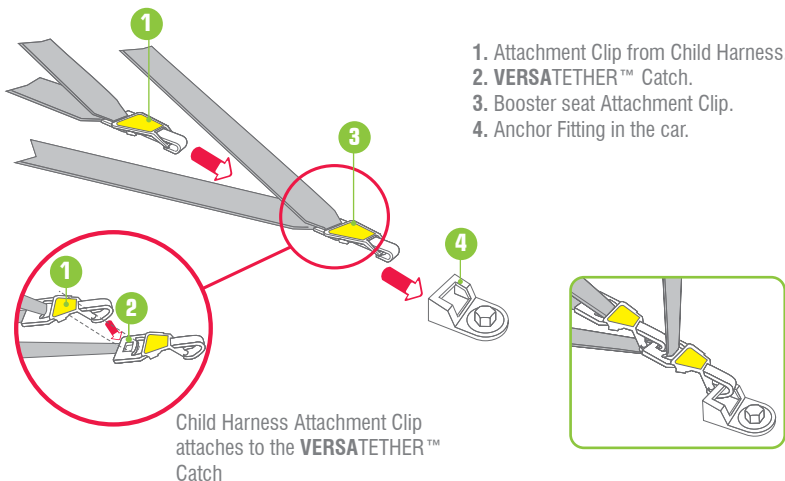

## HOW TO INSTALL WITH A CHILD HARNESS

### Installing into vehicle with an extension strap

Hook the Harness clip first onto the extension strap catch, then hook the extension strap hook onto the **VERSATETHER™** Catch on the Booster Seat's upper anchorage strap as shown below. Ensure that none of the straps are twisted or catching on sharp edges. Tighten the Booster Seat's upper anchorage strap (refer to page 36) then remove excess slack from the extension strap by pulling the adjuster strap as illustrated below.

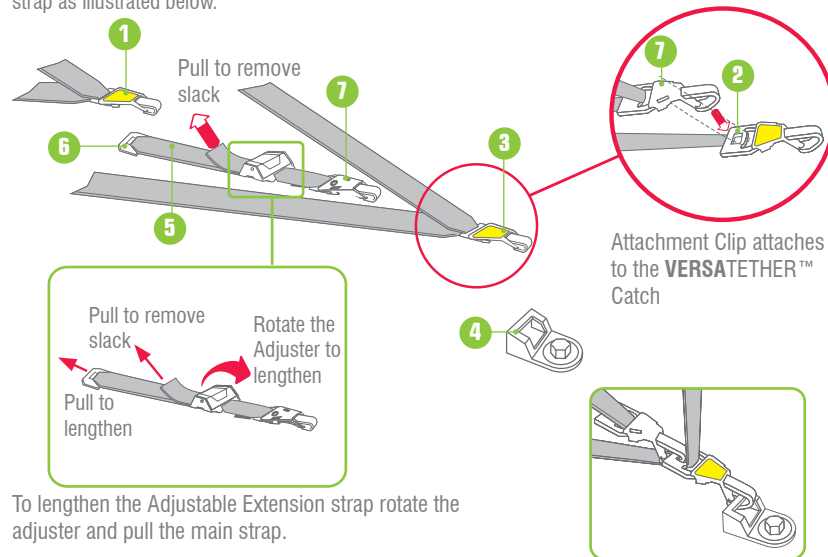

**WARNING**

Always attach the hook and remove the slack.

CHILD USE  
(BOOSTER SEAT MODE WITH CHILD HARNESS)

CHILD USE  
(BOOSTER SEAT MODE WITH CHILD HARNESS)

## HOW TO INSTALL WITH A CHILD HARNESS

### CHOOSING METHOD OF INSTALLATION

The Child Harness can be installed using either of the following methods.

**METHOD 1 :** Using a lap sash seat belt in conjunction with Gated 3-bar Slide (provided with the Child Harness) to convert to lap belt plus upper anchorage strap.

**METHOD 2 :** Using lap seat belt plus upper anchorage strap.

Before installing the Child Harness determine which method of installation is required and follow instructions carefully.

When using the Child Harness, ensure the 'built-in' shoulder harness is and stored. Set up the SLIDEGUARD™ clip. Refer to pages 30-34.

Right shoulder strap with tongue      Left shoulder strap with tongue

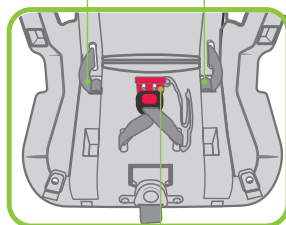

SLIDEGUARD™ converter not yet engaged.

## HOW TO INSTALL WITH A CHILD HARNESS

### METHOD 1: USING LAP-SASH SEAT BELT WITH CHILD HARNESS. (Using Gated Slide provided with Child Harness.)

Refer to Child Harness instruction to fit gated slide.

Adjust the headrest to align with the top shoulder slots of the restraint. Fit the Child Harness as shown above. Then connect the cross strap as shown below. Thread the converted lap-sash seat belt through the harness strap loops as shown right.

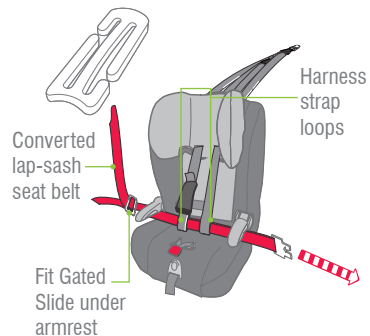

### METHOD 2: USING LAP SEAT BELT WITH CHILD HARNESS.

Adjust the headrest to align with the top shoulder slots of the restraint. Fit the Child Harness as shown above. Then connect the cross strap as shown below. Thread the lap seat belt through the harness strap loops as shown right.

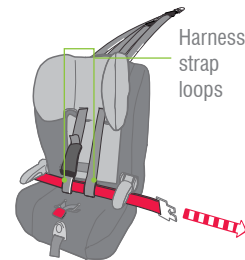

**THIS BOOSTER SEAT MAY ONLY BE SUITABLE FOR USE WITH A CHILD HARNESS IN THE UPRIGHT POSITION. IN THE RECLINE POSITION, THE CAR'S SEATBELT MAY NOT BE LONG ENOUGH.**

**Note:** Some vehicle seat belts are too short and you may experience some difficulty fitting the converted lap-sash around your child. If so, adjust the gated slide nearer to your child, ideally under the armrest and lap belt recess area, (ensure the slide does not touch your child). This should provide more belt length to fit your child, but if the belt still will not fit, try another location in the vehicle, e.g. side seat. If the vehicle belts are still too short, then contact the vehicle manufacturer for advice on longer seat belts.

## HOW TO INSTALL WITH A CHILD HARNESS

### USING LAP-SASH SEAT BELT WITH BOOSTER SEAT & CHILD HARNESS

There may be one of two types of Gated Slides available as shown below provided with the Child Harness. Only use the Gated Slide provided with the Child Harness. If curved Gated Slide, then the belt route through this can only go one way as shown.

Before using the Protecta PLUS™ Harness with a Lap-Sash Seat Belt, you need to convert the seat belt to a Lap Seat Belt by using the Gated Slide provided.

**IMPORTANT:** Face the hollow side of the Gated Slide towards the child. Do not use Gated Slide for any other purpose.

A. Hold the lap and sash straps together and fold as shown below. Slide the inner strap into the Gated Slide followed by the outer strap.

B. The two straps should slide freely in the Gated Slide slot.

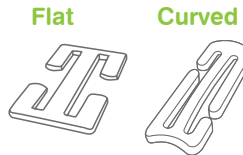

**Always ensure the Hollow side is towards child**

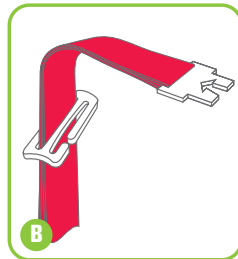
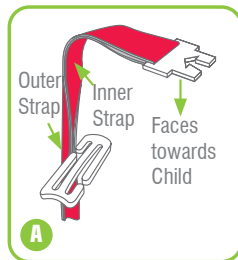

## HOW TO INSTALL WITH A CHILD HARNESS

C. Repeat previous step A for the other slot in the Gated Slide.

D. Feed the straps through the Gated Slide to remove any slack. This has now converted the lap-sash seat belt so it will act like a lap only seat belt.

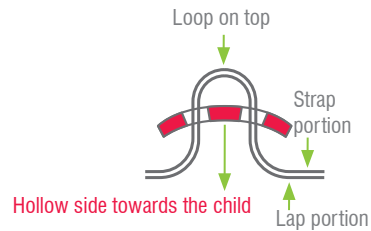

**TO ENSURE CORRECT CONVERSION OF LAP-SASH SEAT BELT TO LAP SEAT BELT FOLLOW THESE STEPS.**

**! IMPORTANT:**

The Gated Slide must be removed from the seat belt if the booster seat and child harness are no longer used in the car so that other users can use the seat belt as a lap sash seat belt.

A seat belt extender should not be used if the seat belt is not long enough to secure the child. If a seat belt extender is used then the buckle must not be in contact with the child.

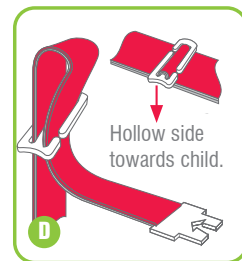
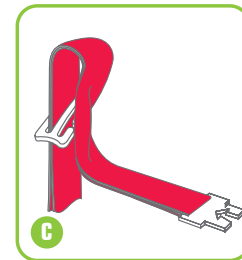

## HOW TO INSTALL WITH A CHILD HARNESS

### HARNESING THE CHILD INTO THE BOOSTER SEAT

These instructions apply to fitting with a lap only seatbelt or a converted lap-sash seatbelt. Connect the Child Harness to the **VERSATETHER™** Catch as detailed on pages 42 and 43.

- 1. Attachment Clip
- 2. Left Hand Harness Strap
- 3. Right Hand Harness Strap
- 4. Storage strap
- 5. Cover Pad (Not shown)
- 6. Right Hand Harness Strap Loop
- 7. Cross Strap Loop
- 8. Cross Strap

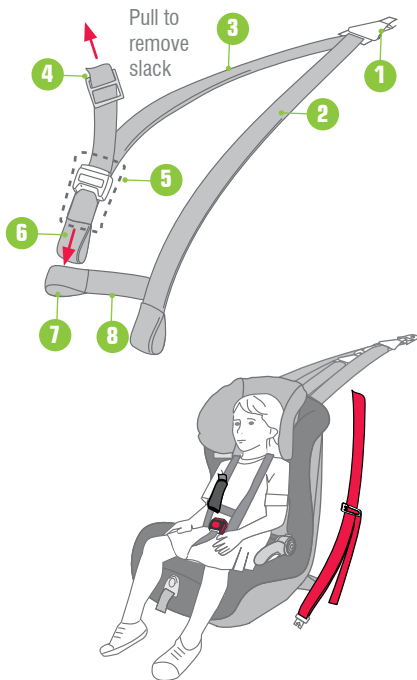

- A. With the child seated, place each of the harness straps over each shoulder.
- B. Feed the Right hand strap (loop end) into the cross strap loop to connect the two sides.

## HOW TO INSTALL WITH A CHILD HARNESS

- C. Feed the adult belt (lap belt or converted lap/sash) through the harness loops, ensuring that the cross strap loop does not disconnect. Also ensure there are no twists in the harness, cross strap and seat belt.

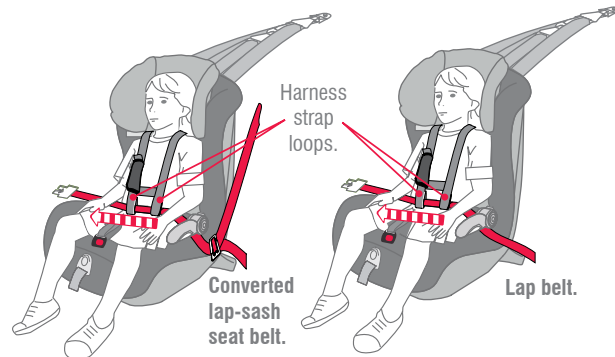

Thread the converted lap-sash seat belt or lap seat belt through the harness strap loops as shown.

CHILD USE  
(BOOSTER SEAT MODE WITH CHILD HARNESS)

## HOW TO INSTALL WITH A CHILD HARNESS

D. Engage the seat belt tongue to the buckle and adjust the seat belt to sit firmly around the child's hips and thighs. The seat belt buckle should be located as low as possible below the child's hip. If using a lap-sash seatbelt and Gated Slide you will need to adjust it so that the seatbelt is firm on the child's thighs and the Gated Slide is close to the Child but not touching the child.



The Gated Slide needs to be close to the child but not touching the child. The Gated Slide needs to be under the armrest.

E. Remove SLIDEGUARD™ converter from recess area (refer to page 31 to 34), then engage into harness buckle.

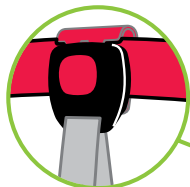

Fit the SLIDEGUARD™ clip to the lap belt, centrally between the shoulder straps of the harness loops, ensuring that the Red button of the crotch buckle is facing forward.

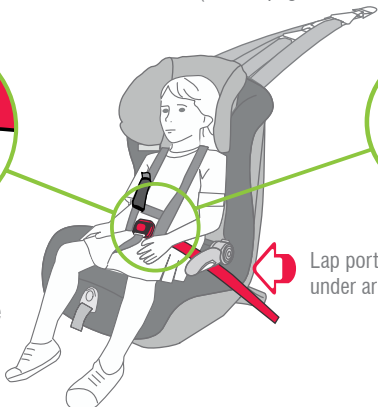

Lap portion of belt must be under armrest on both sides

**IMPORTANT: ALWAYS USE THE SLIDEGUARD™ CLIP**

## HOW TO INSTALL WITH A CHILD HARNESS

F. With the lap belt (or converted lap/sash) adjusted to be a firm fit on the child's thighs, then adjust the Child Harness to remove slack in the shoulder straps. Pull the Adjuster Strap (C) to remove slack. Once adjusted, further adjustments are necessary only to the upper extension straps and to accommodate the growth of the child. Press (A) and pull the shoulder strap (B) to lengthen. Press (A) and pull the shoulder strap (B) to lengthen.

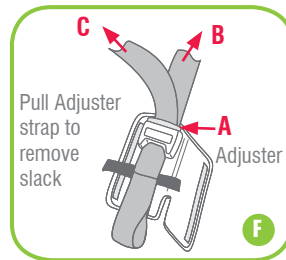

Pull Adjuster strap to remove slack

Adjuster

**NOTE:** The shoulder straps must be in the slots which are nearest to the child's shoulders but no lower than the child's shoulders. This is achieved with the headrest slightly above the child's shoulders.

Fully press adjuster button (A) while pulling the Upper Anchorage Strap (B) to lengthen.

**CAUTION:**

The lap portion of the belt must be adjusted firmly first, and then the harness, so that the belt is not lifted off the child's lap when the harness is adjusted.

G. Finally, roll up the free end of the adjuster strap, secure using the storage strap, then place it into the top of the adjuster cover as shown right.

Fold the adjuster strap and secure with Storage Strap.

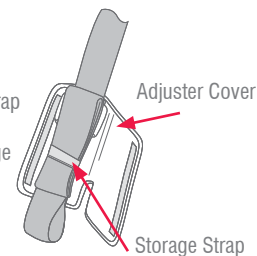

## HOW TO INSTALL WITH A CHILD HARNESS

### TO REMOVE CHILD FROM HARNESS AND SEAT

- H. Disengage seat belt tongue and buckle, remove the lap portion of seat belt from the SLIDEGUARD™ clip and remove the Child Harness and seatbelt from child.

NOTE: It may be easier to unthread the car seat belt out of the loops before lifting the child harness over the child's head.

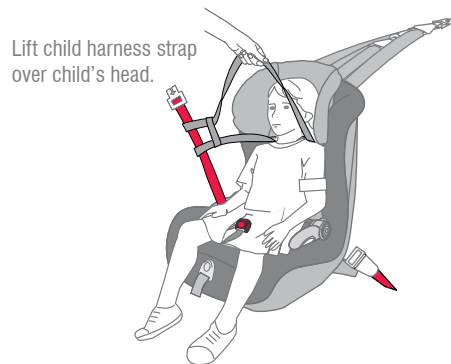

### FOR LARGE CHILDREN

NOTE: Do not pass the child harness over the headrest once the child has outgrown the top most shoulder slots as this can damage the headrest parts.

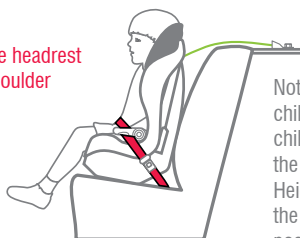

Note: Cease using this child restraint when the child's shoulders reach the Upper Shoulder Height Marker with the headrest in the top position.

## RESTORING THE RESTRAINT

### RESTORING THE RESTRAINT FOR TODDLER USE

- Disengage seat belt tongue from buckle and pull seat belt out of harness strap loops.
- Disconnect the Harness attachment clip from the VERSATETHER™. Catch and feed the left hand Harness Strap out the shoulder slot. Pull the right hand harness Strap to remove the harness off the seat. (Store the Protecta PLUS™ Child Harness in a safe place for later use).
- Remove the built-in harness from the storage recess under the cover. Feed crotch strap and shoulder straps through seat cover.
- Feed shoulder straps through appropriate shoulder slots in the seat back and attach to metal Strap Connector as shown right.
- When child harness is no longer being used, disconnect the gated slide so that the seat belt can be correctly used as a lap-sash seat belt for other users.

Strap Connector

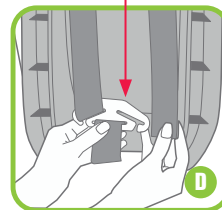

## CARE & MAINTENANCE

### REGULAR CARE OF THIS RESTRAINT:

Please check the following items regularly to ensure the safety of your child:

- A. Check the webbing for fraying.
- B. Check that the buckle clicks and is not sluggish or sticky in operation.
- C. Ensure there are no cracks in moulding or the plastic moulding.
- D. Check the harness adjuster is operating and is clamping the webbing.
- E. If any part of the restraint is cracked or broken, seek repair immediately or replace the child restraint.
- F. Use only mild soap and water to clean all metal and plastic parts of the restraint. Do not use chemicals or cleaning agents.

## HOW TO CLEAN

### TO CLEAN HARNESS BUCKLE

If sticky liquids such as baby formula, fruit juice, etc. get inside your Harness Buckle, it may become sluggish. An indication of a sluggish Harness Buckle is that you cannot hear a click when engaging the Harness Tongues. To restore the Harness Buckle to good working order it needs to be cleaned as follows:

- A. From the underside of the restraint pull each crotch 3-bar slide then turn 3-bar slide and push through each slot to remove the Harness Buckle from the restraint.
- B. Place the Harness Buckle under warm (max. 40 degrees Celsius) running water as shown below. Let the water run through the mouth of the buckle for five minutes.
- C. Engage and disengage the Harness Tongues and Buckles several times until a strong audible click is heard when the last tongue is inserted.
- D. If you still cannot hear a strong audible click after engaging the Harness Tongues & Buckle, then repeat cleaning several times. If the Harness Buckle cannot be returned to its original working condition then contact Safe-n-Sound or Britax Childcare Customer Service.
- E. Refit the harness buckle to the restraint with the red button facing out & feeding each 3-bar slide through previous used slots, refer to the following pages if you need to recheck the slots used.
  - Pages 15 and 16 Toddler Mode - In-built harness
  - Pages 33 to 34 Booster Seat Mode.

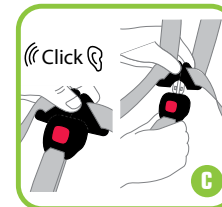
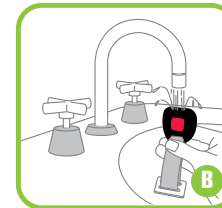
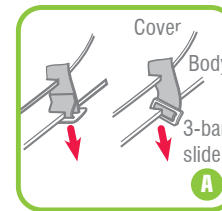

### TO CLEAN THE COVER

The restraint has a flame retardant cover which is removable for cleaning. Cleaning instructions are on the care label attached to the cover. When washing cover engage hook & loop strips together to eliminate other garments being caught. Ensure to keep strips free of lint to work effectively.

## HOW TO CLEAN

### TO REMOVE COVER

You do not have to remove the shoulder harness assembly from the restraint. However, you do need to disconnect the shoulder harness straps from the metal connector at the back of the restraint (refer to Page 18). Then follow the sequence below A to J to remove the cover.

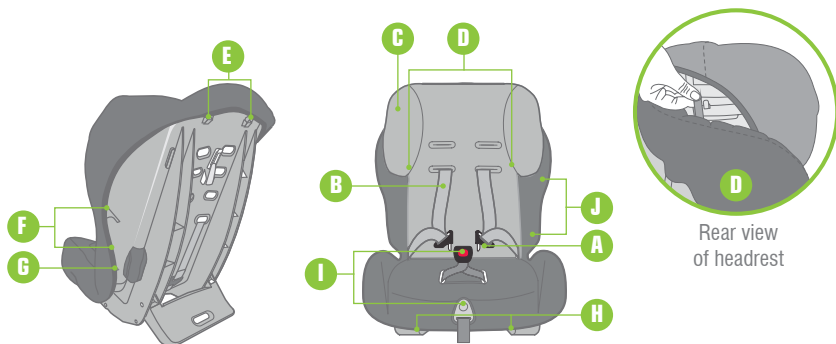

- A. Disengage Harness Tongues from Harness Crotch Buckle.
- B. Feed the Shoulder & Lap Harness Straps through the slots in the restraint and headrest.
- C. Unhook Elastic Loops from sash guides.
- D. Unclip elastic loop from behind headrest then peel headrest cover away from shell.
- E. Unhook Elastic Loops from Trim.
- F. Undo Plastic Clips.
- G. Unclip Trigger Hook on each side.
- H. Unhook Elastic Loops.
- I. Feed Crotch Buckle & harness adjustment button through slot in cover.
- J. Peel cover away from shell and over the headrest shell.

## HOW TO CLEAN

### TO REPLACE COVER:

- A. Fit cover over restraint starting at top, ensure that both back and bottom elastics are at the back of restraint.
- B. Align cover over restraint.
- C. Fit and align headrest cover over headrest shell.
- D. Feed shoulder Harness Straps through matching cover slots on the restraint and re-attach to strap connector at the back of the seat.
- E. Feed Crotch Buckle through slot in cover.
- F. Feed Harness Adjustment Button through cutout in cover.
- G. Re-attach all Plastic Hooks and Elastic Loops on the restraint and headrest, as shown on the previous page.
- H. If refitting for Booster Seat mode fit the cover with the harness in a stored position.

If you are not sure of the slot to be used for the harness then refer to the shoulder slot positioning page 14-18 Toddler Seat Mode with In-built harness and pages 39 to 41 for Booster Seat Mode and Child Harness.

**ONLY USE SAFE-N-SOUND SEAT COVERS THAT ARE DESIGNED AND TESTED FOR USE WITH THIS PRODUCT.**



### VERY IMPORTANT:

**Only use this child restraint with the cover supplied or a manufacturer-  
authorised replacement cover with identical shoulder height markers.**

## ACCESSORIES & FEATURES

The following instructions apply to accessories that may be supplied with this restraint at point of purchase. If not, a variety of accessories are available from various retailers of Safe-n-Sound products.

### POCKET (IF FITTED)

The pocket sewn on the trim is designed for your convenience. It can hold those necessary items that you need at a moments notice. e.g. Bottle, face washer, toy etc.

Caution: If using the pocket to store filled bottles, please ensure contents are not contaminated due to prolonged storage.

### CROTCH PAD (IF FITTED)

The Crotch Pad is designed to provide extra comfort for baby or child and is fitted to the restraint as follows: Feed Crotch Buckle through the slot in crotch pad as shown.

### PADDED INSERT (IF FITTED)

The Padded Insert is designed to snugly support the baby for extra comfort. Simply place the padded insert on the restraint between Harness straps and the restraint back. Ensure padded insert is lined up with or below the shoulder straps.

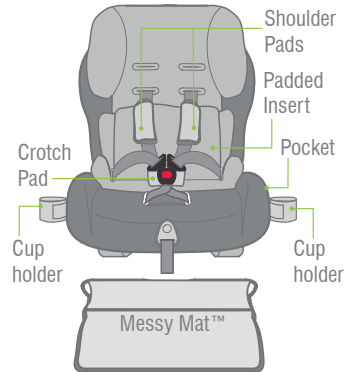

## ACCESSORIES & FEATURES

### MESSY MAT™ SEAT PROTECTOR INSTRUCTIONS (IF SUPPLIED)

Place ribbed or pocket end of the Messy Mat seat protector on edge of car seat, smooth back toward seat join ('A') and fit in any excess Messy Mat into the join of the car seat ('A').

**CAUTION:** The pocket is only for small, light items. DO NOT overload the pocket with heavy, bulky items as this may damage the pocket or cause passengers to trip over them.

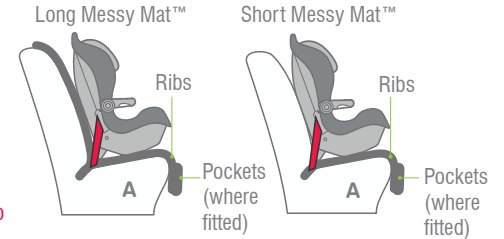

### SHOULDER PADS (IF FITTED)

Shoulder Pads are designed to provide extra comfort for baby or child and are easily fitted to the shoulder harness straps by:

- Pull apart fasteners and remove shoulder pads from harness.
- Re-fit shoulder pads to harness and attach fasteners for use.

### COVER (STYLE MAY VARY)

The cover has been designed to protect your child when seated in the restraint. Care should be taken if children either eat or drink while in the restraint as some food or drink products may cause damage or marking to the cover.

**IMPORTANT:** Do not pull sticky items from covers as the cover may be damaged - soak in water and gently remove.

### ARMREST (IF FITTED)

The armrest can be raised to make it easier to place the child in the seat and can be in the down position when the child is seated and secured.

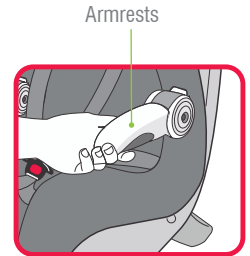

## ACCESSORIES & FEATURES

### CUP HOLDERS (IF FITTED)

The Seat has a cup holder on either side of the seat. Swing the cup holder out from the seat to use. Ensure the cup holder and its contents can not be crushed by the car door. Fold away when not in use.

**IMPORTANT:** Only use for holding cups, bottles and drink cartons. Do not use for hot drinks

### STEREO SPEAKERS (IF FITTED)

Speakers have been supplied to provide enjoyment for your child. Portable CD players and radio's (not included) are recommended for use with these speakers. Recommended storage locations for the music player are in the side pocket/s or messy mat pocket (if supplied). The cable is fitted to the headrest and is stored in the pocket at the back of the cover.

### CAUTION:

Speaker cable must always be stored using the plastic loops on either side of trim and out of reach of children. The cable has the potential to cause strangulation.

The music player must be stored safely as any loose items have the potential to cause injury in an accident. The pocket in the trim is a suitable place.

Music player volume should be turned to low or off before connecting speaker cable.

Hearing experts advise against constant use of personal stereo played at high volume. Constant high volume use can lead to hearing loss.

Ensure that volume adjustment does not cause discomfort to your child. The volume may be louder to your child than you think.

Discontinue use if any part of the speaker, cable and/or connections are damaged in any way.

Technical Details: Speaker System: Stereo - 32 Ohm

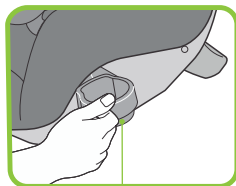

Cup Holder

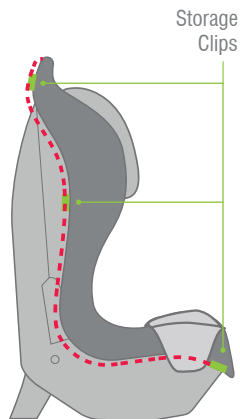

Storage Clips

## PRE-INSTALLATION ANCHOR FITTING

Consult the vehicle owner's handbook for location of anchorage fittings or anchorage points and the possible use of spacers. Some vehicles may have an anchor fitting fitted by the vehicle manufacturer. If anchorage points cannot be found refer to car manufacturer or local child restraint fitting station or traffic authority for optimum position of anchorage point and the use of spacers.

### UPPER ANCHORAGE STRAP

 **IMPORTANT:** THE ATTACHMENT CLIP COVER MUST ALWAYS BE USED AS IT PREVENTS THE RISK OF INCORRECT FITMENT OF THE ATTACHMENT CLIP TO THE ANCHOR FITTING. ALWAYS ENSURE THAT THE ATTACHMENT CLIP IS CORRECTLY ENGAGED TO THE ANCHOR FITTING AND NOT HOOKED OR FITTED TO ANY OTHER OBJECT BEFORE EACH USE OF THE RESTRAINT. THIS IS ESPECIALLY IMPORTANT IN VEHICLES SUCH AS STATION WAGONS, VANS, HATCH BACKS OR VEHICLES WITHOUT A FIXED PARCEL SHELF, SINCE THE ANCHOR POINT IS USUALLY NOT VISIBLE.

### IMPORTANT INSTALLATION NOTE:

In some vehicles the anchor fitting in the rear vertical panel can only be installed in one way. Please refer to vehicle owner's handbook or a child restraint fitting station for correct method.

Extension Strap distance to be measured.  
Length 300mm (Use Safe-n-Sound part 0035).  
Length 600mm (Use Safe-n-Sound part 0036).  
Available from all major child restraint retailers.

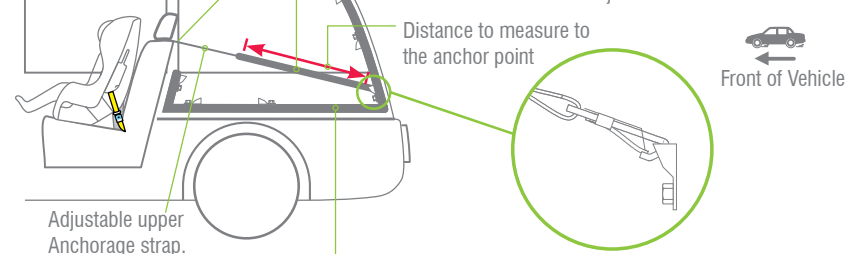

The shaded areas of this diagram illustrate the possible locations of the anchor fitting. Within each shaded area is an anchor fitting showing the correct way to install the fitting. Ensure the anchor fitting is aligned as illustrated unless stated otherwise in the vehicle owner's handbook.

## PRE-INSTALLATION ANCHOR FITTING

### IF THE CAR IS FITTED WITH CHILD RESTRAINT ANCHORAGE POINT

Locate the anchorage point behind the rear seating position. (consult the car owners handbook for the location of the anchorage point). The anchorage point should be directly behind and central to the restraint. Remove thread plug from the parcel shelf/floor/roof, etc. and install anchor bolt and fitting as shown in Fig 1.

**CAUTION: DO NOT OVERTIGHTEN ANCHOR BOLT. OVERTIGHTENING MAY FRACTURE OR BREAK BOLT. MAXIMUM TORQUE IS 20 N.M. (14.75 ft.lb.)**

Note: Minimum of five full turns of anchor bolt is required before tightening force is applied.

### IF THE CAR IS NOT FITTED WITH CHILD RESTRAINT ANCHORAGE POINTS

**For Sedans only** - Drill 9mm diameter hole in the parcel shelf on the centre line of the seating position as shown in Fig 3. Before drilling the hole, check the underside for accessibility. Install the anchor bolt as shown in Fig 2.

**For vehicles other than Sedans** - In Australia, consult your nearest child restraint fitting station or traffic authority for vehicle inspection to find the best, correct position for the placement of the anchorage point, and for the correct attachment bolt length and use of spacers. In New Zealand, consult the agent for the vehicle.

Note to Queensland purchasers: The installation of anchorage points must be approved by authorised officers appointed by Queensland Transport. Authorised officers can be sourced from all Queensland Transport Customer Service and Queensland Ambulance Service Centres.

#### UPPER ANCHORAGE FITTING

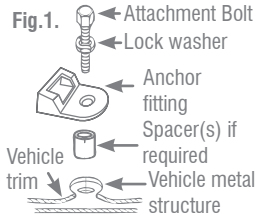

#### UPPER ANCHORAGE FITTINGS FOR SEDANS ONLY

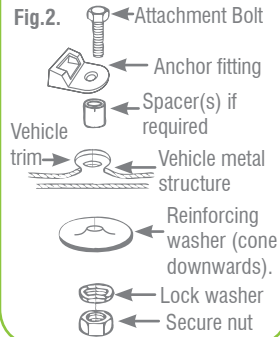

## PRE-INSTALLATION ANCHOR FITTING

ONLY USE A 5/16 UNC GRADE 5 BOLT. IF THE BOLT IS NOT THE CORRECT LENGTH THE CAR MANUFACTURER'S HAND BOOK CAN PROVIDE ADVICE ON THE CORRECT LENGTH BOLT.

### WARNING

CHILD RESTRAINTS MUST NOT BE ATTACHED TO UNSOUND METAL OR TO WOOD, OR SYNTHETIC STRUCTURES. WHEN DRILLING 9 MM HOLE DO NOT DRILL THROUGH FUEL LINES, FUEL TANKS, ELECTRICAL WIRING, OR RADIO SPEAKERS. WEBBING STRAPS MUST BE PROTECTED FROM SHARP CORNERS AND EDGES. THE ANCHOR FITTING MUST BE USED ONLY AS DESCRIBED ABOVE. IT MUST NOT BE HOOKED ONTO ANY OTHER OBJECT.

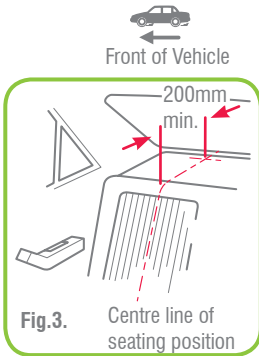
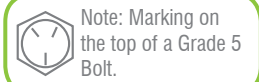

### CAR INSTALLATION ACCESSORIES (From retailers of Safe-n-Sound products)

**EXTRA ANCHOR KITS:** Available for using the restraint in additional cars.

Re-order no: 0038

**EXTENSION STRAPS:** May be required for cars without a fixed parcel shelf.

Re-order no: 0035 (length 300mm) or  
0036 (length 600mm)

**GATED 3-BAR SLIDE (Locking clip):** For converting lap-sash seat belt to lap belt for the child harness (supplied with the child harness) Re-order no: 0215.

### **Precautions to prevent reducing the safety offered by this booster seat.**

#### **With In-built Harness**

1. Ensure seatbelt is fitted to the seat and is tight.
2. Ensure upper anchorage strap is attached to the car's anchor fitting and slack is removed.
3. Ensure the in-built harness is fitted firmly to the child. A loose harness is dangerous.

#### **As a Booster Seat**

1. Ensure seatbelt is fitted to the seat.
2. Ensure the seatbelt is used and fitted correctly. The lap belt must be on thighs and not the abdomen and the sash belt must always be across the chest.
3. Ensure the child does not slouch or slump and the sash belt is across the chest.
4. A sash belt under the arm or behind the back is dangerous. (A child harness can resolve this).
5. Ensure that if you are using a child harness that the lap belt is firm on the child's thighs and not on the abdomen. Do not tighten the child harness tether strap, just remove slack.
6. Always use the Sash Guide in the headrest. Always use the SLIDEGURAD™ clip.
7. Ensure you advise the child not to undo the seat belt buckle unless told to do so.

If your restraint has been involved in a severe crash, you should destroy the restraint even if no damage is obvious. Some insurance companies offer vehicle insurance which covers or partially covers the replacement of your child restraint. Contact your insurance company for further details. Your insurance company may require you to keep the child restraint for assessment, **but do not use the child restraint after a severe crash.** To assist you in making an accident insurance claim cut the following statement and include it with your claim.

#### **NOTICE TO INSURANCE COMPANY CHILD RESTRAINT INVOLVED IN AN ACCIDENT**

- All Safe-n-Sound child restraints are manufactured to Australian/New Zealand Standards AS/NZS1754-2010 which require us to advise users of child restraints to "Destroy the entire restraint if it has been in use in a severe crash, even if no damage is obvious". The joint Australian/New Zealand Standards committee CS/85, advise that this statement applies whether a child was in the child restraint or not. A severe crash, we consider as being one where the main body structure of the vehicle is distorted.
- There is no method of determining if the restraint has been damaged and we concur with the Australian/New Zealand Standards in recommending destruction of the child restraint.
- This notice is to advise you of the requirements of the Australian/New Zealand Standards and our obligation in complying with the standards.
- Please assist the owner of this restraint in their claim.

#### **Britax Childcare Pty. Ltd.**

(Incorporated in Victoria)

A.B.N 55 006 773 600

Head office and registered address:  
99 Derby Road Sunshine Victoria 3020  
PO Box 147 Sunshine Victoria 3020  
Telephone: 1300 303 330

New Zealand Office:  
Britax Childcare NZ Limited.  
PO Box 100-247 Auckland 9  
Telephone: 0800 688 822



## IN CASE OF ACCIDENT

### CRASH EXCHANGE

We would never want you to experience an accident, but unfortunately accidents do happen. If you experience an accident you may be eligible for a free replacement.

The Safe-n-Sound Crash Exchange Program is a voluntary program designed to ensure that our children are safe and that any seat that may have experienced a severe crash is taken out of the market.

There is no method of determining if the restraint has been damaged in a severe crash, so the restraint should be destroyed as the crash may reduce the child restraints ability to perform.

Since its inception in 2006, the Crash Exchange program has helped 100's of families ensure that their children have new restraints and that the restraints are not sold second hand placing others at risk.

Our Crash Exchange Terms and Application form are accessible on our website. Please visit [www.britax.com.au](http://www.britax.com.au) for further information.



## FEATURES

- AHR Headrest features deep side wings that shield and contain your child's head in a side impact crash.
- The Unique AHR adjusts in height to provide head protection as your child grows.
- Grows with child, converting from a forward facing car seat with in-built harness to a booster seat
- Forward facing the Maxi Rider AHR is suitable for an approximate 6 month old child through to a 4 year old
- In-built harness features easy push button adjuster
- Remove in-built harness and use as a booster seat (from 4 years to 6-8 years approx.)
- In booster seat mode use the exclusive Safe-n-Sound™ SLIDEGUARD™ clip to prevent slumping and the lap belt rising onto your child's abdomen
- In booster seat mode the AHR™ Headrest features a Sash Guide which ensures that the sash part of the seat belt is across the shoulder protecting vulnerable soft tissues and organs in abdomen and neck
- Protecta PLUS™ harness compatible (sold separately)
- Protecta PLUS™ harness provides additional torso support
- Attaches to the via tether strap, providing better security and stability
- Padded Insert provides support for a smaller body
- Speakers in headrest for audio pleasure
- 2 recline positions to offer additional comfort for a sleeping child
- Soft plush fabrics and shoulder pads for superior comfort
- Handy storage pocket
- 2 rotating cup holders
- 2 pivoting arm rests provide further comfort



## AUSTRALIA

Britax Childcare Pty. Ltd.  
A.B.N 55 006 773 600

### Head office and registered address

99 Derby Road, Sunshine, Victoria 3020.  
PO Box 147 Sunshine, Victoria 3020.

**Customer Service** 1300 303 330

**Email** [au-custserv@britax.com](mailto:au-custserv@britax.com)

**www.britax.com.au**

## NEW ZEALAND

Britax Childcare (NZ) Ltd.

**Customer Service** 0508 688 822

**Email** [nz-custserv@britax.com](mailto:nz-custserv@britax.com)

**www.britax.co.nz**

## INTERNATIONAL ENQUIRIES

Contact your local Distributor.

The Safe-n-Sound, Versa-Tether & Protecta PLUS trademarks are the property of Britax Childcare Pty. Ltd. (Australia).

The Britax trademark is the property of Britax Excelsior Limited (UK).

The Babylove & EzyGo Harness trademarks are the property of Nursery Elegance Pty. Ltd. (Australia).

We reserve the right to alter this product without notice.

© 1995-2011 Britax Childcare Pty. Ltd. This product is covered by Australian and overseas patent applications. Patents pending.