



Warranty

Each Steelcraft unit is thoroughly inspected in our Quality Assurance department prior to delivery. In the unlikely case that you find any material or workmanship that affects the units normal operation, we will repair the unit free of charge within 12 months of purchase. You are required to present your receipt as proof of purchase. For all concerns with your product please contact our Customer Service team.

CUSTOMER SERVICE

1300 303 330 - Australia
0508 688 822 - New Zealand

Please read all the information carefully before using this product. This warranty does not apply to failure due to improper care, or normal wear and tear caused by product use. We reserve the right to inspect the unit. You may be charged for repairs if the product has been damaged accidentally.

Distributed by:

AUSTRALIA

BRITAX CHILDCARE PTY.LTD.
A Britax International company.
(Incorporated in Victoria)
A.B.N. 55 006 773 600
99 Derby Road, Sunshine,
Victoria 3020, Australia
Phone: (03) 9288 7288
Fax: (03) 9311 5798

NEW ZEALAND

BRITAX CHILDCARE NZ. Limited.
A Britax International company.
101 Diana Drive, Glenfield,
Auckland 9, New Zealand.
Phone: (09) 443 0102
Fax: (09) 443 0120

Due to our continuing program of development, Britax reserves the right to alter the specifications, colour or design without any further notice.

The Steelcraft trademark is the property of Britax Childcare Pty. Ltd-Australia.
Visit the Britax website at: <http://www.britax.com.au> or email us at custserv@britax.com.au

Due to the variations in the style and design of our products the illustrations used in this instruction booklet are generic.

24/03©2010 Copyright Britax Childcare Pty. Ltd. Australia.

INSTRUCTION MANUAL



KEEP INSTRUCTIONS IN A SAFE PLACE FOR FUTURE REFERENCE



READ ALL INSTRUCTIONS CAREFULLY BEFORE ASSEMBLY AND USE OF THE WALKER. ALWAYS FOLLOW THE INSTRUCTIONS. THE CORRECT USE AND MAINTENANCE OF THIS PRODUCT IS ESSENTIAL.

⚠ SAFETY WARNINGS

STAIR HAZARD Avoid serious injury or death. Block stairs/ steps securely before using the walker.

- Do not use walker until baby can sit up by itself.
- To prevent injuries, always ensure the child is well clear of any moving parts when folding or unfolding the baby walker.
- Never adjust or carry the walker with the child in it.
- Ensure that the child can touch the floor with both feet, after adjusting the height of the walker.
- Double check assembly before using the baby walker.
- To avoid burns, keep the Child away from hot liquids, ranges radiators, space heaters, fireplaces, etc
- Use only on flat surfaces free of objects that could cause walker to tip over.
- Never leave your child unattended, always keep child in view whilst in walker.
- Clean grip pads regularly to maintain stopping performance.
- Do not allow children to stand on the seat.
- The baby walker should not be used by children who can walk unaided.
- The weight of the child should be less than 13kg and the height should be 81cm, or less.
- Discontinue use of the walker should any part become damaged or broken.
- Do not use accessories other than those supplied or approved by Britax.
- Do not store outdoors.
- Do not leave your child exposed to the sun.
- If used on carpets, the safety grip pads may reduce the walker speed.
- This product is not intended for commercial use.

7. TO DISASSEMBLE THE SEAT FRAME AND LEG SUPPORT TUBES

NOTE: For safety, this product is not designed to be easily disassembled.

- A Remove the plastic cap with a screwdriver or other tool.
- B Use a screwdriver or other tool to press in the locking pin. At the same time, lift the seat frame off the leg tube.
- C To remove the leg support tubes, squeeze the tabs and pull the support legs up out of the base.

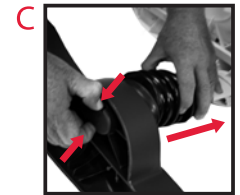
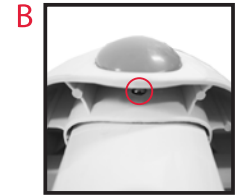
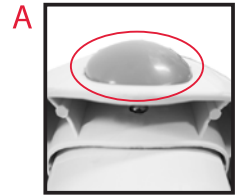

8. TO REMOVE THE SOFT SEAT

NOTE: For safety, the seat is designed to be secured to the frame.

- A Use a screwdriver or other tool to lever open the tray moulding slot. Then either push through from underside, or pull from the top, the webbing straps out of the seat frame.

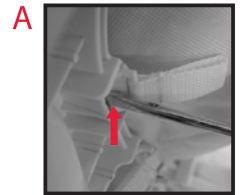

6. TOY TRAY FUNCTION

- E Right side dial is on/off and volume. When rotated clockwise from the off position, the Toy Tray will be on. The white dot indicates the maximum volume point.

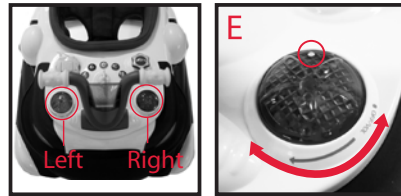

Make sure the dial clicks into the off position when not in use.

- F Left side dial changes music function from music tunes to “piano” mode. Turn the dial completely from one side or the other to change modes. Depending on the mode set, by pushing the music buttons, either music will play or it will be in “piano” mode.



- G Push down on the handle to activate music tunes.



- H The Gear knob can be rotated 360 degrees. This activates various sounds and music.



- I If you turn the key, it will create sound like starting an engine.

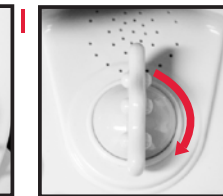

- J The green button makes a squeaky sound when pushed down. The attached yellow toy is a rattle.



CARE AND MAINTENANCE

To prolong the life of your nursery product keep it clean and do not leave it in the direct sunlight for extended periods of time.

Removable fabric covers and trims may be cleaned using warm water with a household soap or a mild detergent. Allow it to dry fully, preferably away from direct sunlight..

DO NOT DRY CLEAN, OR USE BLEACH.

Do not machine wash, tumble or spin dry, unless the care labeling on the product permits these methods. Non removable fabric covers and trims may be cleaned using a damp sponge with soap or mild detergent. Allow it to dry completely before folding or storing it away.

Always check parts regularly for tightness of screws, nuts and other fasteners - tighten if required. To maintain the safety of your nursery product, seek prompt repairs for bent, torn, worn or broken parts. Use only those parts and accessories approved by Britax.

WARNING: Clean safety grip pads regularly, using warm water with a household soap or mild detergent to maintain stopping performance.

Remove batteries before storing for a prolonged period of time. Check the condition of batteries periodically for fluid leakage. Do not use the walker if batteries are leaking.

If the wheels squeak - use silicon based spray ensuring it penetrates the wheel and axle assembly.

In some climates the covers and trims may be affected by mould and mildew. To help prevent this occurring, do not fold or store the product if it is damp or wet. Always store the product in a well ventilated area.

PARTS LIST

- A 1 X Lower base frame
- B 1 X Upper seat frame
- C 1 X Soft seat
- D 2 X Adjusting support legs
- E 4 X Castor wheels
- F 1 X Toy tray

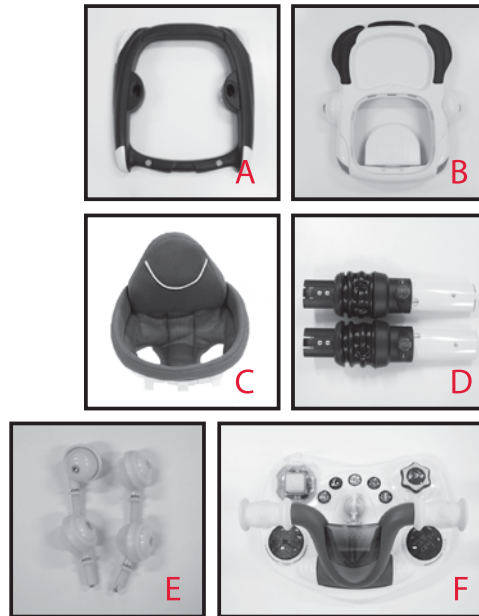

1. ASSEMBLY - WHEELS

NOTE: For easier assembly, turn the lower base frame upside down. Turn right side up after wheels have been assembled.

- A Insert the wheel posts fully into the holes located at each corner of the base using moderate force.
- B Insert all 4 wheels.

NOTE: Clean grip pads regularly, using warm water with a household soap or mild detergent to maintain stopping performance.

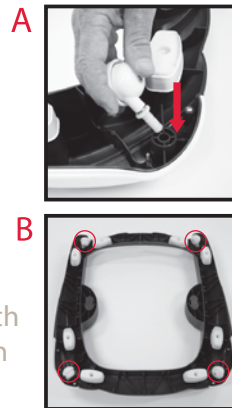

6. TO USE THE TOY TRAY

NOTE: You will need 3 x AA batteries to operate the lights and sounds. Batteries are NOT included.

WARNINGS:

Non-rechargeable batteries are not to be recharged. Adult supervision is required when charging rechargeable batteries. Used and new or different types of batteries should not be mixed. Remove the batteries as soon as they become exhausted. Supply terminals for batteries are not to be short circuited.

NOTE: All music buttons when pushed will stop other functions and return to music mode.

- A Locate the battery section lid on the underside of the Toy Tray. Undo the screw with a screwdriver. You may need a screwdriver or tool to open the cover. Insert 3 x AA batteries following the orientation indicated.
- B Replace the lid, replace the screw, tighten screw to lock the battery lid.
- C Insert the Toy Tray into the seat tray cavity. Push forward and down to engage into the seat frame.
- D To remove Toy Tray, pull up from the finger recess.

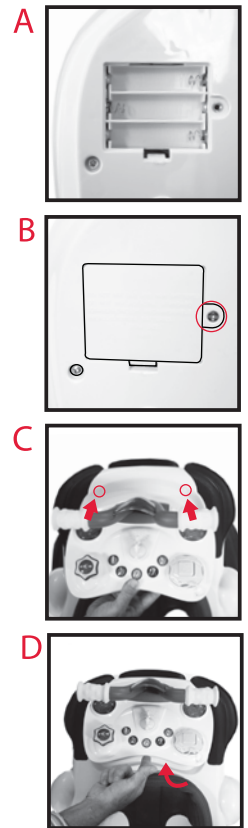

5. WALKER FUNCTION

WALKER MODE(FIXED SEAT POSITION):

NOTE: To lock the support legs from Bounce into Walker mode, select one of the 3 height positions.

- A If in number 1 position Bounce mode, push in and turn the RED button towards the LOCK position. Do this for each support leg.
- B To lower the seat to number 2 or 3 position, push in and turn the RED button from Lock towards Jump mode.
- C Now push down on the seat frame until you see the number 2 or 3 appear. Push in the RED button and turn towards the LOCK position. Repeat for both leg tubes. The seat frame should now be locked into this position.

NOTE: You might need to adjust the leg tube up or down a little to allow the LOCK pin to engage the support leg.

- D To release back to Bounce mode, push in and turn the RED button (on both sides) towards Jump indicator. The seat frame will return to Bounce mode.



2. INSTALLING THE ADJUSTING SUPPORT LEGS

NOTE: There is a left and right support leg.

- A Identify the hole in the leg moulding and align this with the small post on the base. Make sure the RED button is facing to the outside.
- B Position the support leg over the lower base cavity as shown. Make sure the RED button is facing to the outside. Push down with some force until the support leg locks into the base cavity.
- C Install both support legs.
- D Pull up to make sure it is engaged. If not repeat B.

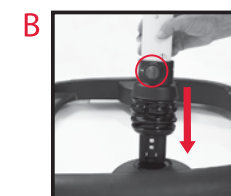
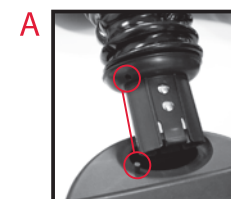

3. INSTALLING THE UPPER SEAT FRAME

NOTE: At the top of each support leg, you will notice a spring loaded pin.

- A The Seat frame needs to be locked onto each of the spring loaded pins.
- B Locate the Seat frame cavities over the support legs.
- C Press down on the Seat frame until both sides lock onto the pins.
- D Pull up on each side to make sure the Seat frame is locked onto the support legs. If not locked repeat steps.

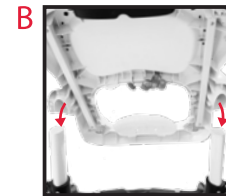

4. INSTALLING AND ATTACHING THE SOFT SEAT TO THE SEAT FRAME

NOTE: The soft seat must be secured to the frame by the webbing straps.

- A Firstly, raise the plastic backrest support up and lock it into position.
- B Position the soft seat onto the seat frame by lowering the soft seat pocket over the plastic moulding.
- C One by one, thread each of the webbing straps through the locating holes in the seat frame.
- D From the underside, pull the webbing straps all the way through until the plastic moulding locks through the hole.
- E Pull up on the soft seat to make sure all webbing straps are locked into the Seat frame. If not, repeat D.

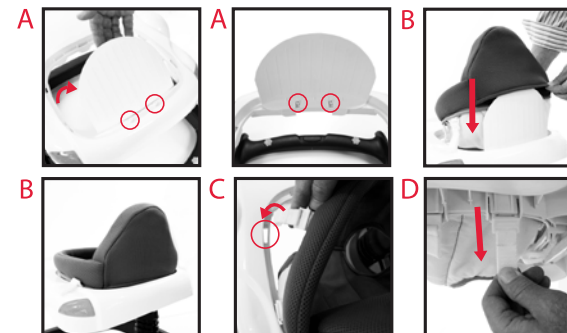

5. BOUNCE FUNCTION

NOTE: The Walker has one Bounce function & 3 height adjusting positions.

BOUNCE MODE:

- A If the support legs are locked into a fixed height position, by pushing in the RED buttons and turning them towards the Jump indicator, this will put the support legs into Bounce mode.

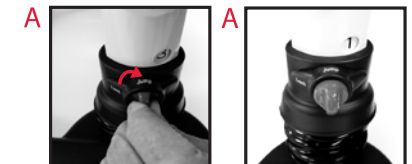

The Bounce mode will sit in the highest seat position, '1', when not locked.