



Warranty

Each Steelcraft unit is thoroughly inspected in our Quality Assurance department prior to delivery. In the unlikely case that you find any material or workmanship that affects the units normal operation, we will repair the unit free of charge within 12 months of purchase. You are required to present your receipt as proof of purchase. For all concerns with your product please contact our Customer Service team.

CUSTOMER SERVICE
1300 303 330 - Australia
0508 688 822 - New Zealand

Please read all the information carefully before using this product. This warranty does not apply to failure due to improper care, or normal wear and tear caused by product use. We reserve the right to inspect the unit. You may be charged for repairs if the product has been damaged accidentally.

Distributed by:

AUSTRALIA
BRITAX CHILDCARE PTY.LTD.
A Britax International company.
(Incorporated in Victoria)
A.B.N. 55 006 773 600
99 Derby Road, Sunshine,
Victoria 3020, Australia
Phone: (03) 9288 7288
Fax: (03) 9311 5798

NEW ZEALAND
BRITAX CHILDCARE NZ. Limited.
A Britax International company.
101 Diana Drive, Glenfield,
Auckland 9, New Zealand.
Phone: (09) 443 0102
Fax: (09) 443 0120

Due to our continuing program of development, Britax reserves the right to alter the specifications, colour or design without any further notice.

The Steelcraft trademark is the property of Britax Childcare Pty. Ltd-Australia.
The Britax trademark is the property of Britax Excelsior Limited - UK.
Visit the Britax website at: <http://www.britax.com.au> or email us at custserv@britax.com.au

Due to the variations in the style and design of our products the illustrations used in this instruction booklet are generic.

12/06 ©2007 Copyright Britax Childcare Pty. Ltd. Australia.

INSTRUCTION MANUAL



Beepa 4 in 1 Walker

KEEP INSTRUCTIONS IN A SAFE PLACE FOR FUTURE REFERENCE



READ THESE INSTRUCTIONS CAREFULLY BEFORE ASSEMBLY AND USE OF THE WALKER. FOLLOW THE MANUFACTURER'S INSTRUCTIONS. THE CORRECT USE AND MAINTENANCE OF THIS PRODUCT IS ESSENTIAL.

SAFETY WARNINGS

DO NOT LEAVE YOUR CHILD EXPOSED TO THE SUN.
THIS PRODUCT IS NOT INTENDED FOR COMMERCIAL USE.

- Never leave your child unattended, always keep child in view whilst in the walker.
- Never adjust or carry the walker with the child in it.
- Do not store outdoors.
- Do not allow children to stand on the seat.
- Ensure the child can touch the floor or foot pedal with both feet, after adjusting the height of the walker.
- Do not use accessories other than those supplied and approved by Britax.
- Discontinue using the baby walker should any part become damaged or broken.
- Double check assembly before child is allowed to use the baby walker.
- To avoid burns or injuries ensure, electrical cords, heaters, barbecues, fireplaces and other hot objects are guarded or out of reach.
- To prevent injuries, always ensure the child is well clear of any moving parts when adjusting the baby walker.
- The baby walker seat should not be used by children who can walk unaided.
- Do not use walker until baby can sit up by itself.
- To avoid serious injury or death, block stairs and steps securely before using the walker.
- Use only on flat surfaces free of objects that could cause the walker to tip over.
- Maximum weight or height for child using walker seat is 13kg or 81cm tall.
- If used on carpets, the safety grip pads may reduce the walker speed.
- Clean safety grip pads regularly to maintain stopping performance

(see Care & Maintenance).

CARE AND MAINTENANCE

To prolong the life of your nursery product keep it clean and do not leave it in the direct sunlight for extended periods of time.

Removable fabric covers and trims may be cleaned using warm water with a household soap or a mild detergent. Allow it to dry fully, preferably away from direct sunlight.

DO NOT DRY CLEAN, OR USE BLEACH.

Do not machine wash, tumble or spin dry, unless the care labeling on the product permits these methods. Non removable fabric covers and trims may be cleaned using a damp sponge with soap or mild detergent. Allow it to dry completely before folding or storing it away.

Always check parts regularly for tightness of screws, nuts and other fasteners - tighten if required. To maintain the safety of your nursery product, seek prompt repairs for bent, torn, worn or broken parts. Use only those parts and accessories approved by Britax.

WARNING: Clean safety grip pads regularly, using warm water with a household soap or mild detergent to maintain stopping performance.

Remove batteries before storing for a prolonged period of time. Check the condition of batteries periodically for fluid leakage. Do not use the walker if batteries are leaking.

If the wheels squeak - use silicon based spray ensuring it penetrates the wheel and axle assembly.

In some climates the covers and trims may be affected by mould and mildew. To help prevent this occurring, do not fold or store the product if it is damp or wet. Always store the product in a well ventilated area.

5. TO ADJUST HEIGHT AND USE BOUNCE FUNCTION

NOTE: The support legs can be adjusted to three heights to allow for child's growth.

- A To adjust seat height turn support leg knobs to 'Lock' position. Press the buttons in whilst pushing down on the upper tray. Find the desired height indicated by the numbers 1 to 3 and release the buttons to lock into position.
- B To use bounce function turn the leg knobs to 'Jump'.



6. TO ADJUST FOOT PEDAL

NOTE: There are 3 foot pedal positions. 1. Front beneath car bonnet, 2. Centre under seat and 3. Rear behind seat.

- A Push button on foot pedal and slide to adjust to desired position.

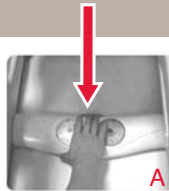

7. TO INSTALL AND REMOVE SEAT FABRIC

- A Raise the seat back rest and cover with rear flap of seat cloth.
- B Insert 6 plastic seat slots into corresponding upper plate holes.
- C Turn upper plate upside down, pull plastic seat slots over plastic molding to hold seat in place. Reverse steps A, B and C to remove seat fabric.

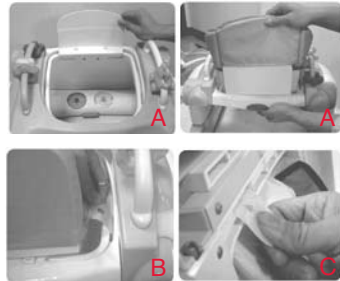

PARTS LIST

- A 1 x Upper plate includes seat
- B 1 x Walker Car Bonnet
- C 2 x Support Legs
- D 1 x Lower base includes foot pedal
- E 1 x Car windscreen
- F 4 x Swivel Wheels
- G&H 2 x Handrails
- I 1 x Toy Fan
- J 1 x Toy Horn

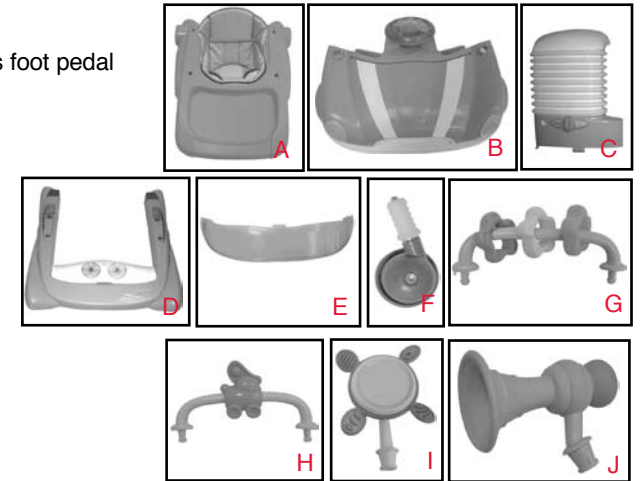

1. ASSEMBLY

- A Push the button on the foot pedal and pull backward and engage in furthest location at the rear of the lower base.
- B Align and insert the support legs into corresponding holes on the lower base, push down until engaged.
- C Align and insert the support legs into the corresponding hole of the sides of upper plate and press until engaged.



1. ASSEMBLY CONT...

- E Open seat by pulling release button on upper plate.
- F Slide open until engaged.
- G Raise seat backrest and click into rear of seat moulding.
- H To slide seat away release back-rest of seat by pushing upwards and forwards from moulding. Fold seat cloth forward until flat. Pull seat release button on upper tray, and slide seat forward until hidden beneath car bonnet.

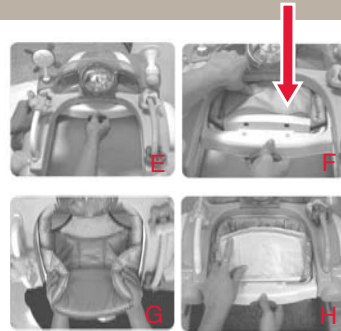

2. TO INSTALL SWIVEL WHEELS

- A Turn lower base upside down and insert the end of the swivel wheel posts all the way into the holes located in each of the four corners.



3. TO INSTALL BATTERIES

NOTE: There are two individual battery housings. You will need 5 x AA batteries for lights and sounds. (Batteries not included)



FOOT PEDAL BATTERIES

- A Turn over lower base to locate battery housing in foot pedal. Remove the Phillips head screw in battery lid with a screwdriver. Install the 3 x AA batteries taking care to install in correct positive and negative directions. Cover with housing lid and tighten the screw. Test correct installation by turning over foot pedal and pressing light and sound buttons.

3. TO INSTALL BATTERIES CONT...

CAR BONNET BATTERIES

- B Locate battery housing underneath car bonnet. Remove the Phillips head screw in battery lid with a screwdriver. Install the 2 x AA batteries taking care to install in correct positive and negative directions. Cover with housing lid and tighten the screw. Test correct installation by turning over and pressing light and sound buttons on steering wheel.

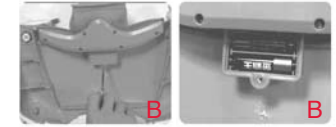

4. TO INSTALL BATTERIES

WARNING: Non-rechargeable batteries are not to be recharged. Adult supervision is required when charging rechargeable batteries. Used and new or different types of batteries should not be mixed. Remove the batteries as soon as they become exhausted. Supply terminals for batteries are not to be short circuited.

5. TO INSTALL CAR WINDSCREEN, CAR BONNET, TOYS AND HANDRAILS

- A Insert car windscreen into slot provided in car bonnet.
- B Insert the toy fan and horn in corresponding holes found on the left and right side of car bonnet.
- C Place car bonnet over front end of upper plate, push down to lock into place.
- D To remove car bonnet gently pull front wheels away from either side of upper plate moulding. Release and lift away.
- E Insert the handrails into corresponding holes found on left and right sides of upper plate.

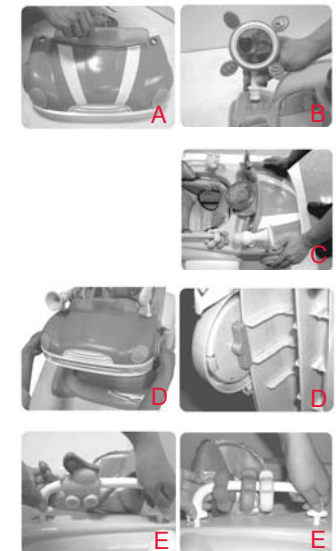

NOTE: The car bonnet can remain uninstalled to use convenient snack tray.