

Britax

Safe-n-Sound™

Child Booster Seat

Series No. 4300/A/2010

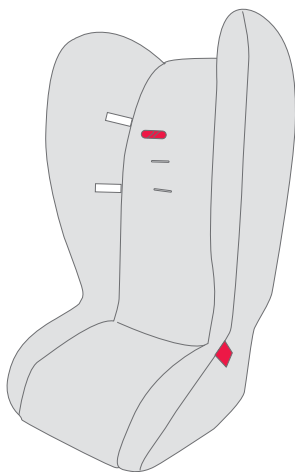

Instructions for Installation & Use



IMPORTANT: KEEP THIS BOOKLET IN THE PLACE PROVIDED ON THE CHILD RESTRAINT

Page

- 3 INTRODUCTION
- 4 WARNINGS
- 6 SHOULDER HEIGHT MARKERS AND A GROWING CHILD
- 7 SHOULDER HEIGHT MARKERS AND THE NEXT STEP
- 8 SPECIAL FEATURES
- 9 SUITABLE FOR USE
- 10 HOW TO SETUP
- 12 HOW TO USE
- 15 HOW TO USE WITH A CHILD HARNESS
- 28 TO REMOVE CHILD
- 29 CARE & MAINTENANCE
- 30 ACCESSORIES
- 31 IN CASE OF ACCIDENT

This Booster Seat is designed for use by children from approximately 4 years of age up to approximately 6 to 8 years of age in vehicles using a lap-sash seat belt or with a seat belt and Child Harness. It must not be used with just a lap only seat belt as the upper body of the child is not restrained.

A child that is not tall enough to reach the lowest shoulder height marker in their seat with in-built harness will be too small for this booster seat. This booster seat should be used until the child no longer fits in the Booster Seat or the child can sit in the car's seat with their lower leg able to hang over the seat cushion.

Only the Safe-n-Sound™ Protecta PLUS™ Harness Series 220/2010, Safe-n-Sound™ Defenda™ Harness Series 217/2010, Babylove™ EzyGo Harness™ Series BL220/2010 and Babylove™ Travel™ Harness Series BL217/2010 child harnesses are suitable for use with this Booster Seat. No other Harness is suitable with this booster seat unless advised by Safe-n-Sound.

CAREFULLY READ ALL THE INSTRUCTIONS FOR INSTALLATION.

IN THE EVENT OF DOUBT ABOUT THE METHOD OF INSTALLATION, CONSULT SAFE-N-SOUND OR A CHILD RESTRAINT FITTING STATION AUTHORISED BY A RELEVANT TRANSPORT AUTHORITY. IN NEW ZEALAND, CONTACT THE AGENT FOR THE VEHICLE.

THIS RESTRAINT MUST BE USED IN CARS WITH FORWARD FACING SEATS WITH A LAP-SASH SEAT BELT OR WITH A SEAT BELT AND CHILD HARNESS. When used with a Child Harness either lap only seat belt or lap-sash seatbelt may be used.

No child restraint can guarantee absolute protection from injury in every crash. However, to ensure that your child gets all the protection designed into the restraint **PLEASE READ AND FOLLOW THESE INSTRUCTIONS EXACTLY.**

Always store the instruction book under the base in the pocket attached to the trim, for future reference.

Seat belt extenders should not be used if the seat belt is not long enough to fit around the child. If a seat belt extender is used then the seat belt buckle must not be in contact with the child.

WARNINGS

- Use the restraint exactly as shown in the instructions.
- Supervision of children is needed because they may be able to undo buckles.
- **DO NOT LEAVE CHILDREN UNATTENDED IN THE CAR.**
- Do not alter or modify this restraint. Use only recommended parts and accessories.
- Repairs must only be done by the manufacturer or agent.
- Do not allow the restraint to come into contact with polishes, oils, bleach and other chemicals.
- Destroy the restraint if it has been in a severe crash, even if no damage is visible.
- **DO NOT USE WITH JUST A LAP BELT.** You must use with lap-sash seat belt, or with a seat belt and child harness.
- The lap part of the seat belt must be firmly across the thighs and the sash straps fitted diagonally across the chest and on the shoulder.
- If used with a child harness, the lap strap of the seatbelt must be adjusted firmly first, and then the harness, so that the lap-strap is not lifted off the child's lap when the harness is adjusted.
- **DO NOT USE THIS RESTRAINT WITHOUT THE COVER.**
- **IF AN AIRBAG IS FITTED IN THE SEATING POSITION WHERE THE CHILD RESTRAINT IS TO BE FITTED, FOLLOW THE VEHICLE MANUFACTURER'S WARNINGS AND INSTRUCTIONS.**
- Regularly check the restraint components, straps and other fitments for correct function, cracking & condition. Seek prompt repair.

WARNINGS

- Securely stow all heavy objects, feeding bottles, cup holders, etc that could become missiles during an accident and cause injury to any occupant.
- The restraint should not be purchased or sold as a second hand item. It is recommended not to use child restraints older than 10 years as the protection in an accident may be reduced. This seat is made of foam and incorrect use or storage may make this seat last less than 10 years.
- Do not store in areas that may get hot, like in car boots, roof space, beside shed walls which get hot in summer. Do not place heavy items on top of the seat as this may break the moulding. Children must not play with the seat as inappropriate use may break the main moulding.

WARNING:

DO NOT LEAVE CHILDREN UNATTENDED IN THE CAR.

CAUTION:

This seat is constructed of foam and will protect occupants in a crash but rough handling in everyday use may break the foam.

SHOULDER HEIGHT MARKERS AND A GROWING CHILD

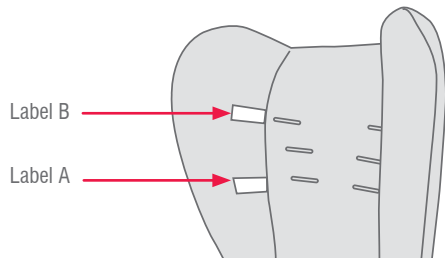

SMALLER CHILD

From approximately 4 years of age.

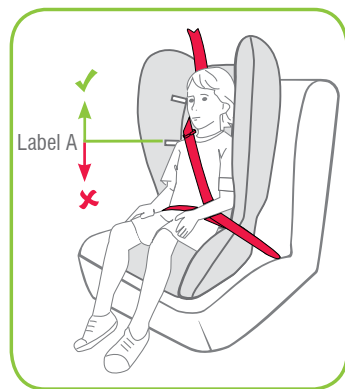

TALLER CHILD

To approximately 6 to 8 years of age.

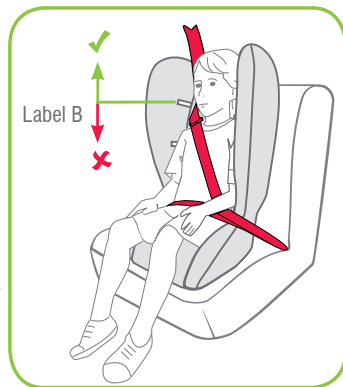

Note: These heights also apply if you are using a Child Safety Harness with the Booster Seat.

SHOULDER HEIGHT MARKERS AND THE NEXT STEP

! IMPORTANT: Follow this advice.

LOWER SHOULDER HEIGHT MARKER : Label A

Using the in-built harness, The child's shoulders must be in-line with this marker or above this marker. If the child's shoulders are below then the child should remain in their previous child restraint.

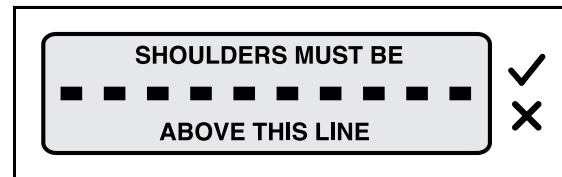

UPPER SHOULDER HEIGHT MARKER : Label B

When the child's shoulders reach this upper marker, approximately 6 to 8 years of age, then the child must be moved to the next form of child restraint.

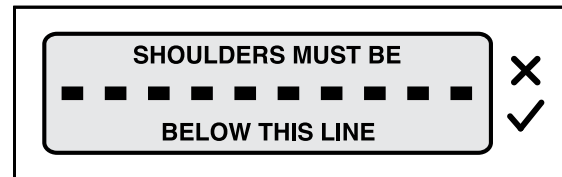

Next type of restraint that can be used in the car for your child.

When your child has outgrown the seat, you can then either use:



Just the car's lap-sash seatbelt.*



Or you can use a Child Harness and lap seat belt. Lap seat belts can be dangerous without a Child Harness.*



Or you can use a narrow booster seat suitable for children up to 8-10 years of age. An accessory Child Harness may be used.

* Lower leg should hang over the seat.

SPECIAL FEATURES

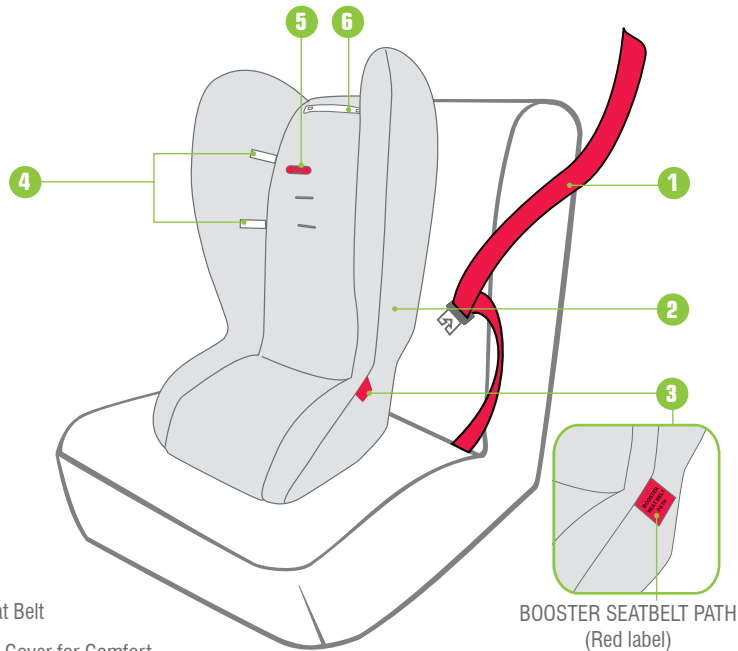

1. Car Seat Belt
2. Padded Cover for Comfort
3. Booster Seat Belt path label (each side)
4. Shoulder Height Markers
5. Sash Guide
6. Child harness guide (if fitted)

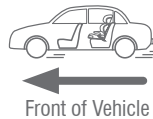

SUITABLE FOR USE

To be used with either a lap-sash seatbelt or an add-on accessory child harness by children whose shoulders are above the lower shoulder height marker (approximately 4 years of age) until child's shoulders reach the upper shoulder height marker (approximately 6 to 8 years of age).

Continue to use this child restraint until child reaches the limit. Children are safest in a booster seat until their shoulders reach the upper shoulder height marker of the booster seat.

Do not use this restraint until child's shoulders are above the lower shoulder height marker.

Just using a seatbelt is not recommended for children that have outgrown this seat. Use a larger booster seat.

THIS RESTRAINT MUST BE USED IN CARS WITH FORWARD-FACING SEATS WITH A LAP-SASH SEAT BELT OR WITH A SEAT BELT AND CHILD HARNESS.

WARNING

- **DO NOT USE WITH JUST A LAP BELT.** You must use with lap-sash seat belt, or with a seat belt and Child Harness.
- Do not use in a front seat, unless your child is over 4 years of age or in accordance with the applicable Road Rules in your region.
- Do not use on any vehicle seat which faces sideways or rearwards.
- Only use Safe-n-Sound™ replacement covers for this Booster seat to ensure all safety information is provided.
- The child in the seat must not slump or slouch such that the lap belt is on the abdomen. The lap belt on the abdomen is dangerous.

HOW TO SETUP

ADJUSTING THE SASH GUIDE POSITION

A. Unzip the trim at the back of the booster seat at the top rear of the restraint, then pull the cover forward to reveal the Sash Guide which is attached to a strap at the back of the seat cover.

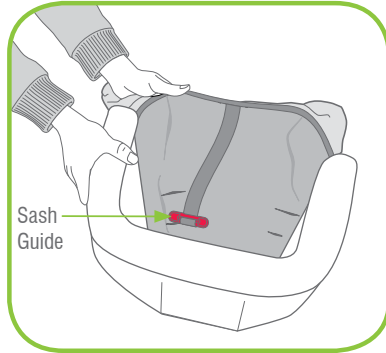

B. Align the sash guide strap with the chosen slot so that the slot is above the child's shoulder. Thread the Sash guide through the slot in the seat cover that corresponds to the seatbelt configuration. Then refit the seat cover to the restraint. For smaller children use the lowest slot.

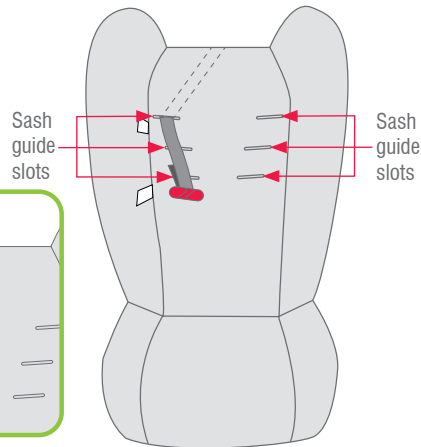

Thread the sash guide through the chosen slot in the seat cover.

HOW TO SETUP

The Sash Guide should be used to correctly position the sash portion of the lap-sash seat belt across the child's shoulder and chest.

Feed the adjusting strap into the slot on the cover that is just above the child's shoulder. Adjust the height of the Sash Guide so that the guide is above the child's shoulder.

To Lengthen

Hold the strap, rotate and pull the sash guide to lengthen

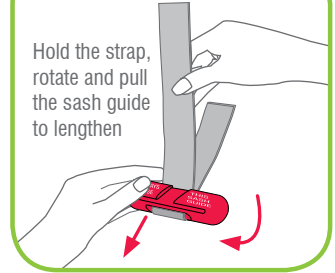

To Shorten

Hold the Sash Guide and pull strap to shorten

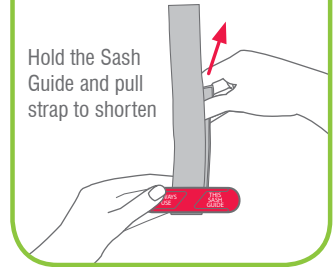

HOW TO USE

WITH LAP-SASH SEAT BELT

1. Place the Booster Seat in the desired seating position.
2. Seat the child in the seat. The child's shoulders must be between the Lower and Upper Shoulder Height Markers.
3. Pull the seat belt out fully and place the lap belt over the child's hips and thighs, across the red BOOSTER SEATBELT PATH label, engage seat belt buckle and tongue, ensure there are no twists in the belt. If the seat belt buckle is adjustable, adjust the buckle as low as possible away from the child.
4. Feed the sash-belt across the child's chest and through the Sash Guide. The sash guide should be used to correctly position the sash portion of the lap-sash seat over the child's shoulder and across the chest. To adjust the height of the Sash Guide see page 11. Adjust the height of the sash guide so that the guide is above the child's shoulder. The slot in the cover will always be above the shoulder for the Sash Guide to be adjusted correctly.

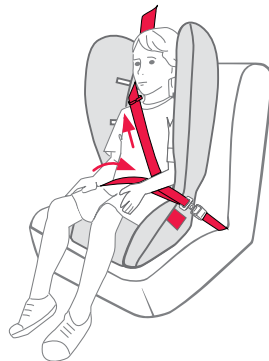

 **IMPORTANT: ALWAYS USE THIS SASH GUIDE**

HOW TO USE

5. Tighten the lap belt and then the sash belt. If using an Inertia Reel Retractor seat belt, adjust lap portion of the seat belt firmly around the child and Child Booster Seat through the sash guide and then let the slack sash portion retract up into sash retractor.
6. The seat belt must fit firmly but comfortably across the thighs and chest. If possible, adjust the vehicle seat to improve the position of the sash on the child's chest.
7. Always ensure the lap belt is on the child's hips and thighs at all times. The lap belt must not be on the child's abdomen as this is dangerous.

Sash belt across the chest and through the sash guide

Lap belt must always be firm on the thighs. The child should not slump or slouch.

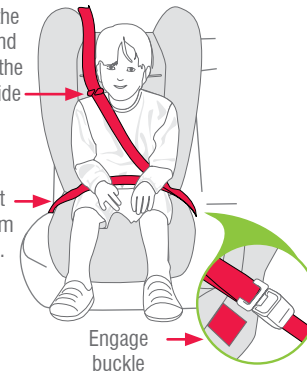

IMPORTANT:

Always ensure the seat belt is firmly fitted to the hips and thighs and the sash belt is diagonally across the chest.

A loose or poorly positioned lap belt can allow the lap belt to ride up into the abdomen and can cause serious injuries in a crash.

Do not place seat belt sash under the arm or behind the back. It is dangerous.

HOW TO USE



WARNING :

A sash belt under the arm or behind the back is dangerous.

SEAT BELT UNDER THE ARM IS DANGEROUS



SEAT BELT BEHIND THE BACK IS DANGEROUS



TO REMOVE CHILD

Disengage seat belt tongue and buckle. Remove the belt from the child. When Booster is not being used, secure in position, by engaging seat belt over the booster seat or store in a safe place.



Seat belt fitting closely across the chest and through the sash guide.



Lap belt must always be firm on the thighs. The child must not slump or slouch.

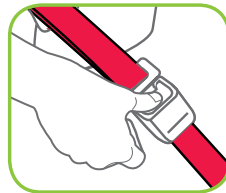

HOW TO USE WITH A CHILD HARNESS

USING THE BOOSTER SEAT WITH A CHILD HARNESS

A child harness **MUST** be used with this Booster seat if the seating position chosen has a Lap only seat belt. A child harness can also be used in a position with a lap-sash seatbelt and is useful if the occupant does not always wear the seat belt correctly.

When using this Booster Seat with a child harness the Sash guide is not needed, and can be stored in the Sash guide storage pocket moulded into the back of the seat (near top). Once the Booster Seat is to be re-used with a lap-sash seatbelt only, then ensure the Sash guide is removed from the storage pocket and repositioned into the correct position (refer to page 10).

The Booster Seat can be used with a child harness in a seating position where a child anchor fitting is fitted in the vehicle. Refer to the car's owners manual for the location of the child restraint anchorage fitting and for any precaution related to airbags in selected seating position. If there is no fitting then you will need to refer to the instruction book for the child harness which will provide information about fitting an anchor fitting into the car.



CAUTION:
ALWAYS FOLLOW THE CHILD HARNESS INSTRUCTIONS.

If the seating position has a lap only seat belt then no other preparation is required but if the seating position has a lap-sash seatbelt then it must be converted into a lap belt. If you have a lap-sash seatbelt then you need to fit a Gated Slide.

There may be one of two types of Gated Slides available as shown flat or curved, provided with this harness. Only use Gated Slides recommended for this Harness.

If curved Gated Slide, then the belt route through this can only go one way as shown.

Before using the Child Harness with a Lap-Sash Seat Belt, you need to convert the seat belt to a Lap Seat Belt by using the Gated Slide provided.

Curved

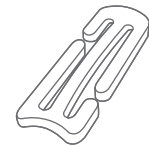

Flat

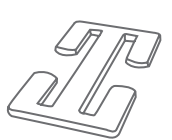

Always ensure the Hollow side is towards child

HOW TO USE WITH A CHILD HARNESS

- A. Hold the lap and sash straps together and fold as shown. Slide the inner strap into the Gated Slide followed by the outer strap.



IMPORTANT:

Face the hollow side of the Gated Slide towards the child. Do not use Gated Slide for any other purpose.

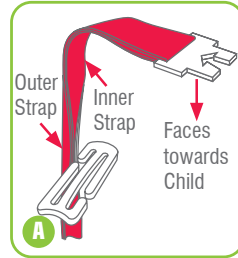

- B. The two straps should slide freely in the Gated Slide slot.

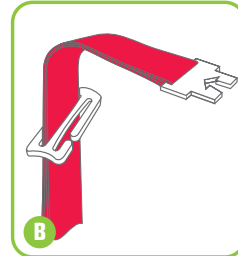

- C. Repeat previous step A for the other slot in the Gated Slide.

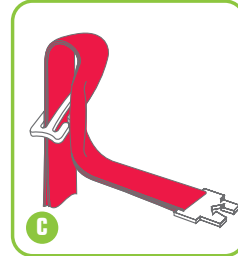

HOW TO USE WITH A CHILD HARNESS

- D. Feed the straps through the Gated Slide to remove any slack. This has now converted the lap-sash seat belt so it will act like a lap only seat belt.

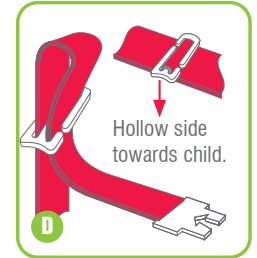
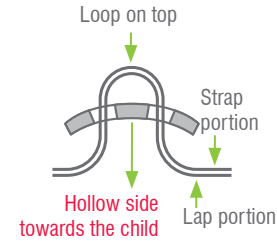

NOTE: TO ENSURE CORRECT CONVERSION OF LAP-SASH SEAT BELT TO LAP SEAT BELT FOLLOW THESE STEPS.



IMPORTANT:

The Gated Slide must be removed from the seat belt if the booster seat and child harness are no longer used in the car so that other users can use the seat belt as a lap-sash seat belt.

A seat belt extender should not be used if the seat belt is not long enough to secure the child. If a seat belt extender is used then the buckle must not be in contact with the child.

HOW TO USE WITH A CHILD HARNESS

USING THE BOOSTER SEAT WITH A BASIC CHILD HARNESS

The Safe-n-Sound Defenda Harness Series 217/2010 and Babylove Travel Harness Series BL217/2010 child harnesses have no adjuster in the shoulder strap. The harness may be used with either a lap only seat belt or a lap-sash seat belt.

NOTE: See page 23 if you are using a harness with front adjuster.

The harness features two sets of loops to take the car's seat belt.

Smaller children on booster seats.

The upper loops must be used, if the cross strap is positioned too close to the child's throat, these loops may also be used if the vehicle anchorage point is located too close to the vehicle seat back, provided the back of child's neck is not contacting the webbing.

Larger children

The lower loops must be used, when the back of child's neck is contacting the webbing of the child harness when using the upper loops.

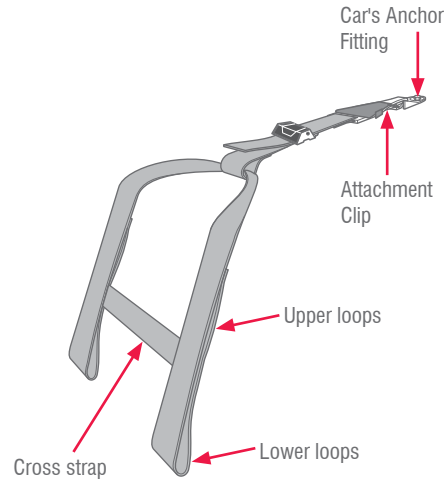

WARNING:

The lap portion of the belt must be adjusted firmly first, and then the harness, so that the belt is not lifted off the child's lap when the harness is adjusted. The shoulder strap does not need to be tight.

HOW TO USE WITH A CHILD HARNESS

INSTALLING INTO VEHICLE

Hook the Child Harness attachment clip (1) onto anchor fitting in the car. Ensure that none of the straps are twisted and not passing over any sharp edges.

1. Attachment Clip from Child Harness.
2. Anchor Fitting in the car.
3. Adjuster
4. Adjuster Strap
5. Upper Anchorage Strap

The Child Harness can be adjusted by pulling on the Adjuster Strap (4) but only do this after the seat belt has been adjusted. To slacken the Child Harness, rotate the adjuster upwards and pull the Upper Anchorage Strap (5)

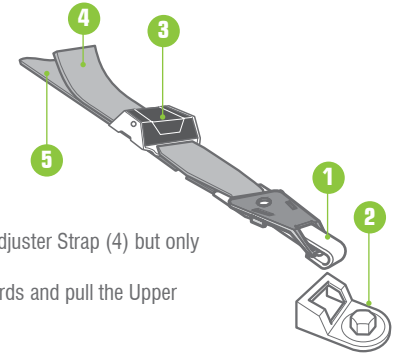

Pull to adjust

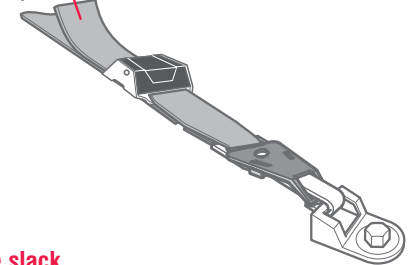

WARNING:

Always attach the hook and remove the slack.

HOW TO USE WITH A CHILD HARNESS

HARNESSING THE CHILD INTO THE BOOSTER SEAT

These instructions apply to fitting with a lap only seatbelt or a converted lap-sash seatbelt.

- Create slack in the Upper Anchorage Strap and ensure the child harness is threaded through the child harness guide at the top of the seat.
- Hook the Attachment Clip to the car's Anchor Fitting.
- With the child seated, place each of the harness straps over each shoulder.
- Feed the adult belt (lap belt or converted lap/sash) through either the Upper Harness Strap Loops (if provided) for smaller children or the Lower Harness Strap Loops for larger children. The top of the harness must not be a tight fit on the back of the child's neck, if so, use the Lower Harness Strap Loops. Ensure there are no twists in the harness or seat belt.

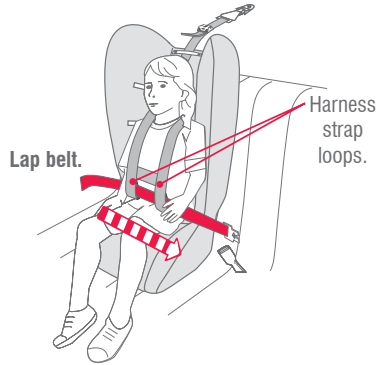
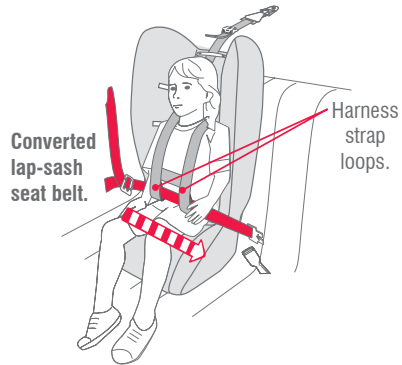

HOW TO USE WITH A CHILD HARNESS

- Engage the car's seat belt tongue to the buckle and adjust the seat belt to sit firmly around the child's hips and thighs. The seat belt buckle should be located as low as possible below the child's hip. If using a lap-sash seatbelt and Gated Slide you will need to adjust it so that the seatbelt is firm on the child's thighs and the Gated Slide is close to the child but not touching the child.

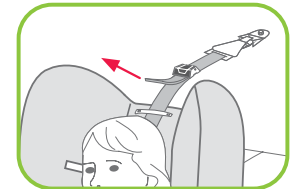
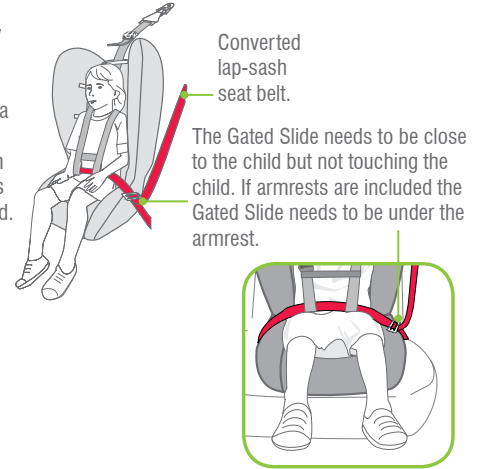

HOW TO USE WITH A CHILD HARNESS

USING LAP SASH SEATBELT

Thread the converted lap-sash seat belt through the harness strap loops as shown.

Tighten the converted Lap belt over the child's hips and thighs then remove the slack from the Child Harness so that the Lap belt is not lifted off the thighs.

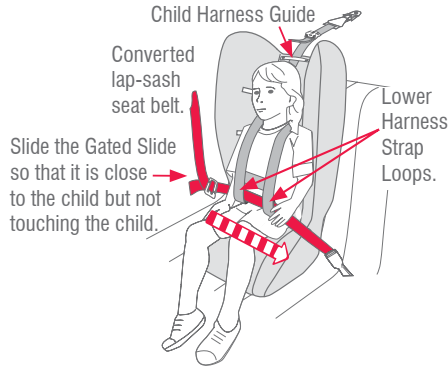

USING LAP ONLY SEATBELT

Thread the lap seat belt through either the Upper Harness Strap Loops or Lower Harness Strap Loops.

Tighten the Lap belt over the child's hips and thighs then remove the slack from the Child Harness so that the Lap belt is not lifted off the thighs.

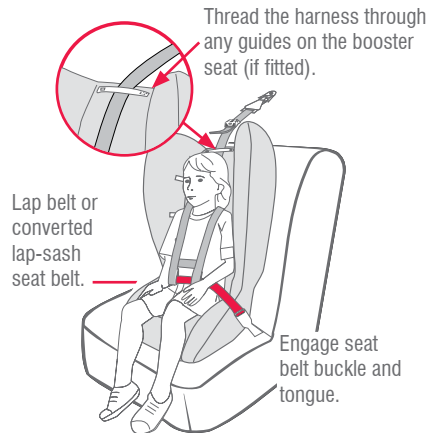

WARNING:

DO NOT LEAVE CHILDREN UNATTENDED IN THE CAR.

HOW TO USE WITH A CHILD HARNESS

USING THE BOOSTER SEAT WITH A CHILD HARNESS WITH A FRONT ADJUSTER

The Safe-n-Sound Protecta PLUS harness Series 220/2010 and Babylove EzyGo harness Series BL220/2010 Child Harnesses include an adjuster in the front of the harness. The harness may be used with either a lap only seat belt or a lap-sash seat belt.

1. Attachment Clip
2. Car's Anchor Fitting
3. Right Hand Harness Straps
4. Storage strap
5. Adjuster Cover
6. Right Hand Harness Strap Loop
7. Cross Strap Loop
8. Cross Strap

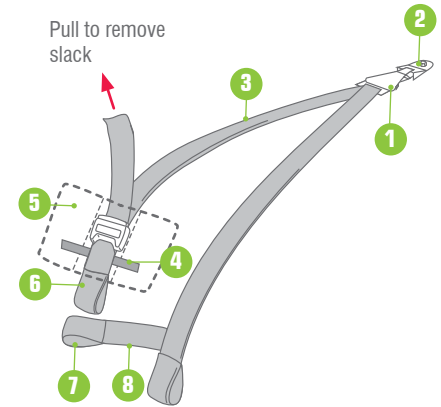

WARNING:

The lap portion of the belt must be adjusted firmly first, and then the harness, so that the belt is not lifted off the child's lap when the harness is adjusted. The shoulder strap does not need to be tight.

HOW TO USE WITH A CHILD HARNESS

- A. Lengthen the shoulder strap by pressing the adjuster button (1) and pulling the strap (2).

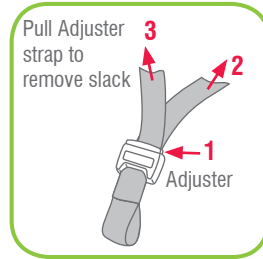

Fully press adjuster button (1) while pulling the Upper Anchorage Strap (2) to lengthen.

- B. Thread the anchorage strap through the child harness guide at the top of the seat. Attach the attachment clip to the car's anchor fitting (see illustration).

An adjustable extension strap supplied with the Child Harness may be required for hatchbacks or wagons.

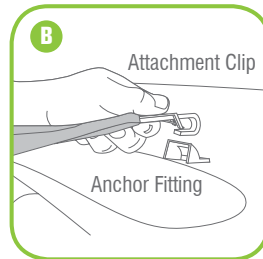

HOW TO USE WITH A CHILD HARNESS

- C. With the child seated, place each of the harness straps through the guide on the top of the seat and then over each shoulder.

- D. Feed the right hand strap (loop end) into the cross strap loop to connect the two sides.

- E. Feed the adult belt (lap belt or converted lap/sash) through the harness loops, ensuring that the cross strap loop does not disconnect. Also ensure there are no twists in the harness, cross strap and seat belt.

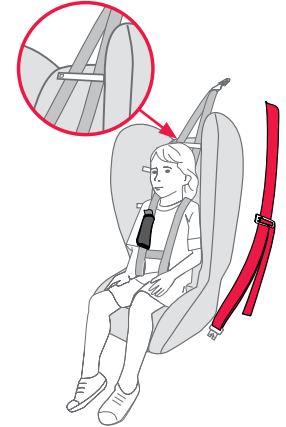

Thread the converted lap-sash seat belt or lap seat belt through the harness strap loops as shown below.

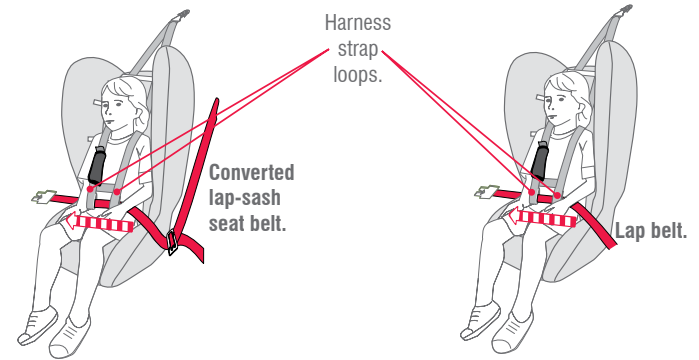

HOW TO USE WITH A CHILD HARNESS

F. Engage the seat belt tongue to the buckle and adjust the seat belt to sit firmly around the child's hips and thighs. The seat belt buckle should be located as low as possible below the child's hip. If using a lap-sash seatbelt and Gated Slide you will need to adjust it so that the seatbelt is firm on the child's thighs and the Gated Slide is close to the Child but not touching the child.

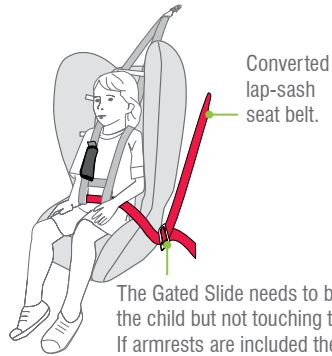

G. Then adjust the Protecta PLUS™ Harness by pulling the adjuster strap (3) to remove all slack in the shoulder straps. Do not over tighten so as to cause the seatbelt to lift off the child's thighs. As the child grows this front adjuster will need to be adjusted.

The Gated Slide needs to be close to the child but not touching the child. If armrests are included the Gated Slide needs to be under the armrest.



H. Finally, roll up the excess adjuster strap, secure using the storage strap, then close the adjuster cover.

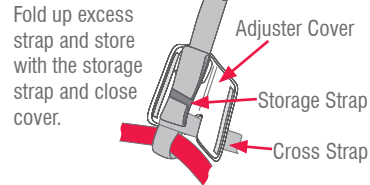

HOW TO USE WITH A CHILD HARNESS

USING LAP SASH SEATBELT

Thread the converted lap-sash seat belt through the harness strap loops as shown.

Tighten the converted Lap belt over the child's hips and thighs then remove the slack from the Child Harness so that the Lap belt is not lifted off the thighs.

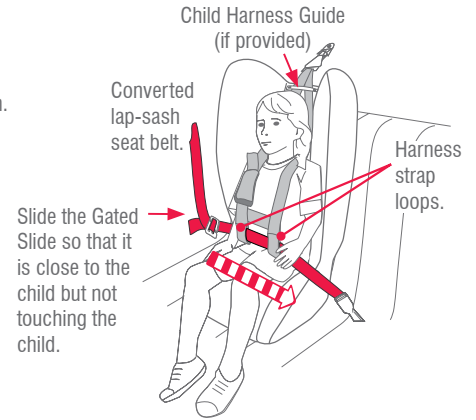

USING LAP ONLY SEATBELT

Thread the lap seat belt through either the Upper Harness Strap Loops or Lower Harness Strap Loops.

Tighten the Lap belt over the child's hips and thighs then remove the slack from the Child Harness so that the Lap belt is not lifted off the thighs.

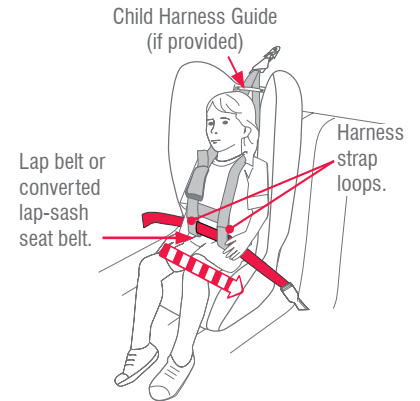

WARNING:

DO NOT LEAVE CHILDREN UNATTENDED IN THE CAR.

TO REMOVE CHILD

TO REMOVE CHILD FROM HARNESS AND SEAT

Disengage seat belt tongue and buckle and remove Child Harness and seatbelt from child.

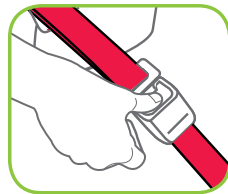

Lift child harness strap over child's head.

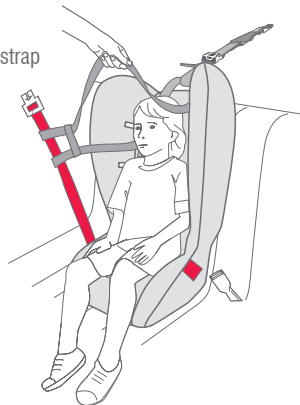

CARE & MAINTENANCE

MAINTENANCE

Check that the foam is not broken or the cover damaged. Seek repair or replace the whole booster seat.

HOW TO CLEAN

Use only mild soap and water with a moist cloth to clean metal and plastic parts of the booster seat. Only use water for wiping the white foam structure.

Do not use harsh cleaners, polishes, oils, bleach or other chemicals.

COVER

The booster seat has a cover made from flame retardant fabric and is removable for cleaning. Washing and care instructions are on the care label attached to the cover.

TO REMOVE COVER

Remove the cover by unzipping body, feeding the sash guide through the slot in the cover.

TO REPLACE COVER

Reposition the cover so that the cover foam faces the base and the backrest of seat. Fit the cover over the backrest first and then the base. Feed the sash guide back through the previous slot in cover.



VERY IMPORTANT:

Only use this child restraint with the cover supplied or a manufacturer-authorized replacement cover with identical shoulder height markers.

ACCESSORIES

HEAD PILLOW (IF SUPPLIED)

The head pillow (if fitted) is designed to provide extra comfort.

Position the bottom of the head pillow level with the top of the child's shoulders. Feed the upper and lower headrest straps through the nearest slots available (see illustrations). Always use the sash guide in the correct position.

Note: Do not place pillow too close to the sash belt so that it does not stop the retraction of the seat belt.

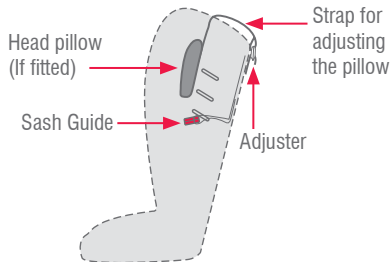
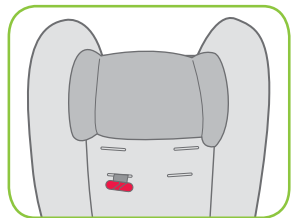

COMFORT PAD (IF SUPPLIED)

The comfort pad (if fitted) provides extra cushioning for your child. The elastic holds the comfort pad in the position as shown.

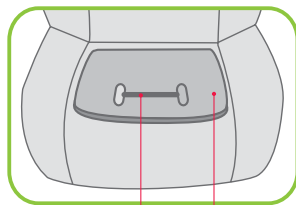

Elastic holds comfort pad in position Comfort pad

IN CASE OF ACCIDENT

If your restraint has been involved in a severe crash, you should destroy the restraint even if no damage is obvious. Some insurance companies offer vehicle insurance which covers or partially covers the replacement of your child restraint. Contact your insurance company for further details. Your insurance company may require you to keep the child restraint for assessment, **but do not use the child restraint after a severe crash.** To assist you in making an accident insurance claim cut the following statement and include it with your claim.

NOTICE TO INSURANCE COMPANY CHILD RESTRAINT INVOLVED IN AN ACCIDENT

All Safe-n-Sound child restraints are manufactured to Australian/New Zealand Standards AS/NZS1754-2010 which requires us to advise users of child restraints to "Destroy the entire restraint if it has been in use in a severe crash, even if no damage is obvious". The joint Australian/New Zealand Standards committee CS/85, advise that this statement applies whether a child was in the child restraint or not. We consider a "severe crash" as being one where the main body structure of the vehicle is distorted.

There is no method of determining if the restraint has been damaged and we concur with the Australian/New Zealand Standards in recommending destruction of the child restraint.

This notice is to advise you of the requirements of the Australian/New Zealand Standards and our obligation in complying with the standards.

Please assist the owner of this restraint in their claim.

AUSTRALIA

Britax Childcare Pty. Ltd.

A.B.N 55 006 773 600

Head office and registered address

99 Derby Road, Sunshine, Victoria 3020.

PO Box 147 Sunshine, Victoria 3020.

Customer Service 1300 303 330

Email au-custserv@britax.com

www.britax.com.au

NEW ZEALAND

Britax Childcare (NZ) Ltd.

Customer Service 0508 688 822

Email nz-custserv@britax.com

www.britax.co.nz





AUSTRALIA

Britax Childcare Pty. Ltd.
A.B.N 55 006 773 600

Head office and registered address

99 Derby Road, Sunshine, Victoria 3020.
PO Box 147 Sunshine, Victoria 3020.

Customer Service 1300 303 330

Email au-custserv@britax.com

www.britax.com.au

INTERNATIONAL ENQUIRIES

Contact your local Distributor.

The Safe-n-Sound trademark and other trademarks are the property of Britax Childcare Pty. Ltd. (Australia).

The Britax trademark is the property of Britax Excelsior Limited (UK).

We reserve the right to alter this product without notice.

© 1995-2011 Britax Childcare Pty. Ltd. This product is covered by Australian and overseas Patents pending.